

PLAN "A"
SCALE 1" = 10'

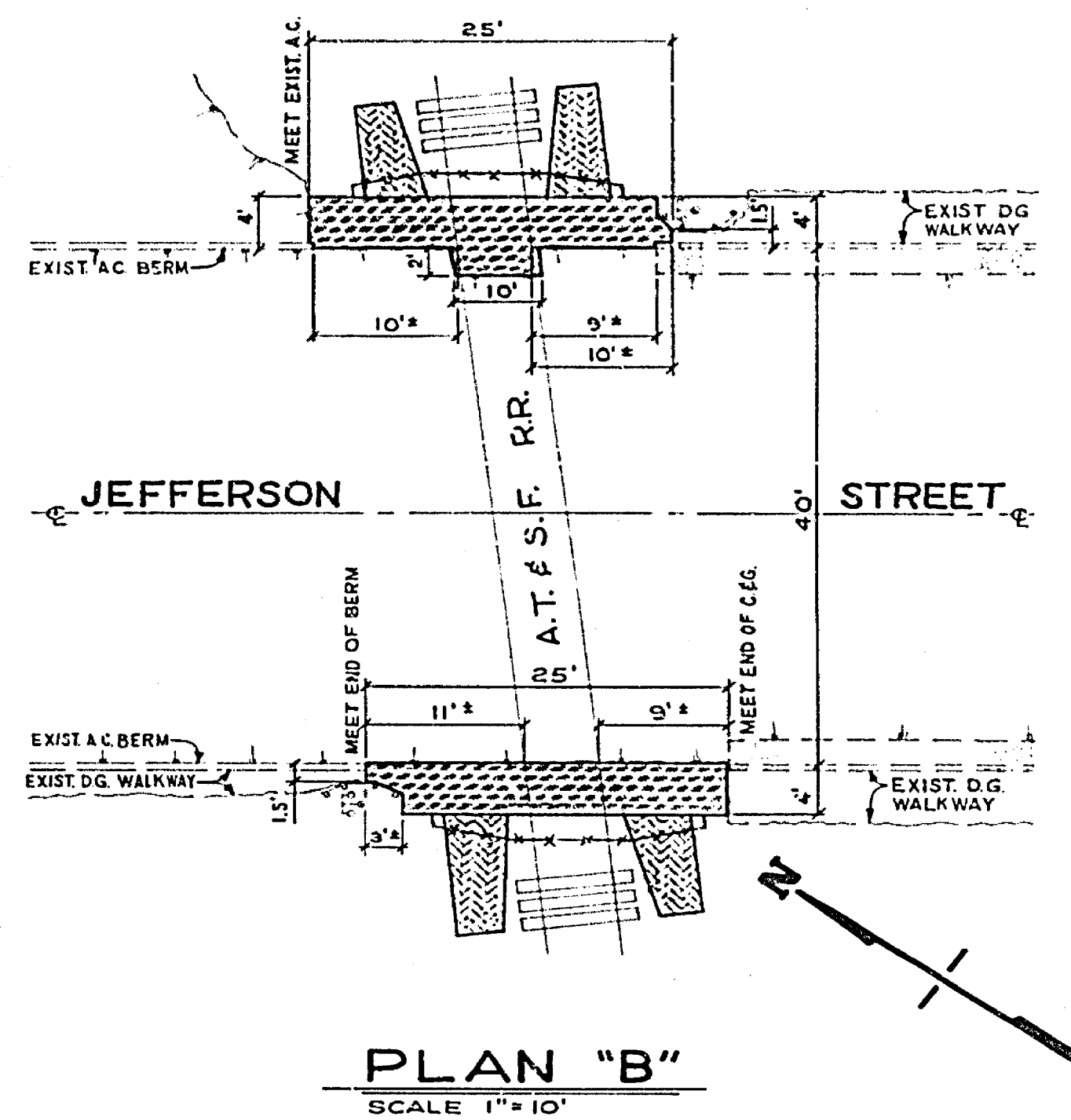

PLAN "B"
SCALE 1" = 10'

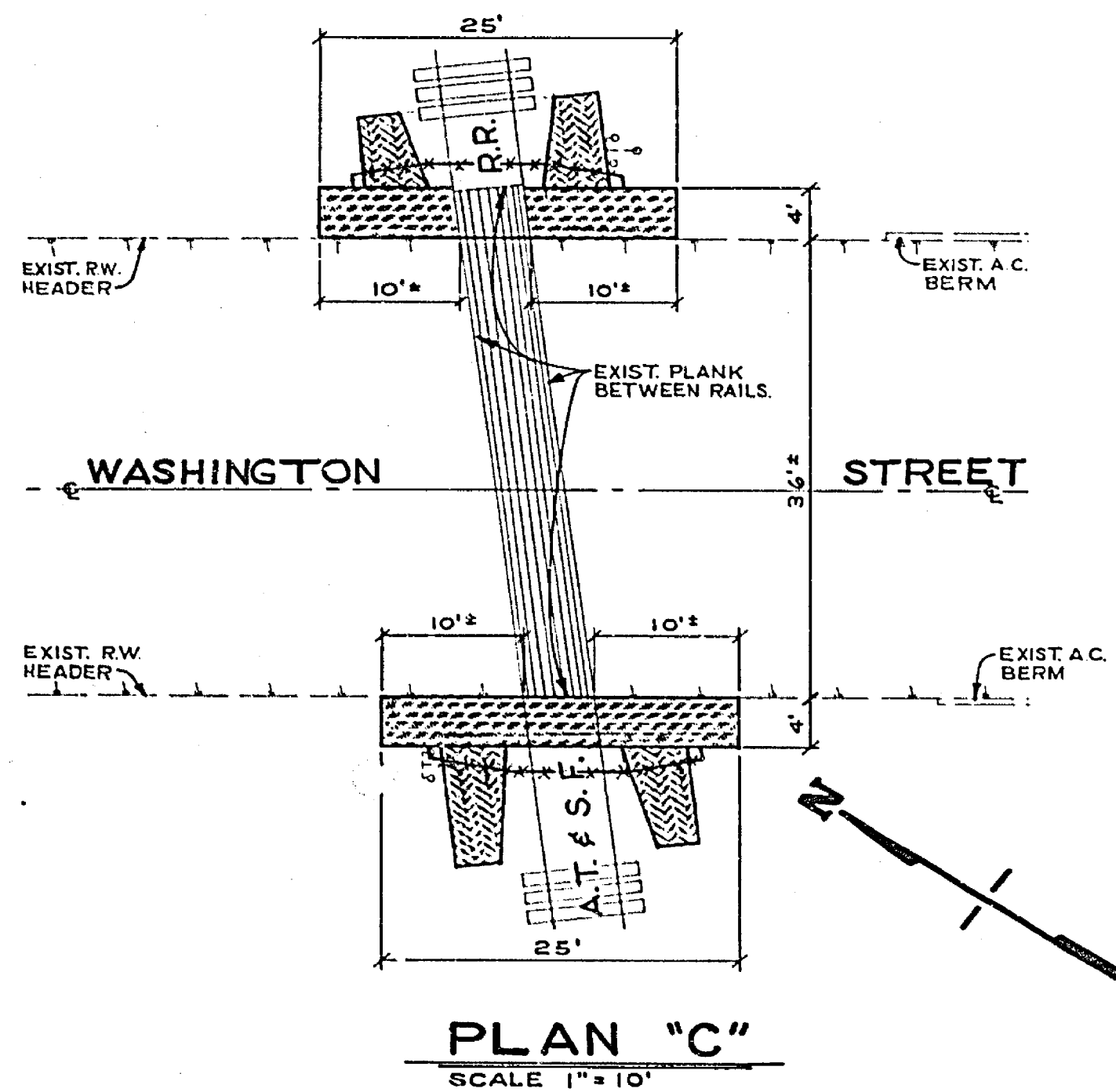

PLAN "C"
SCALE 1" = 10'

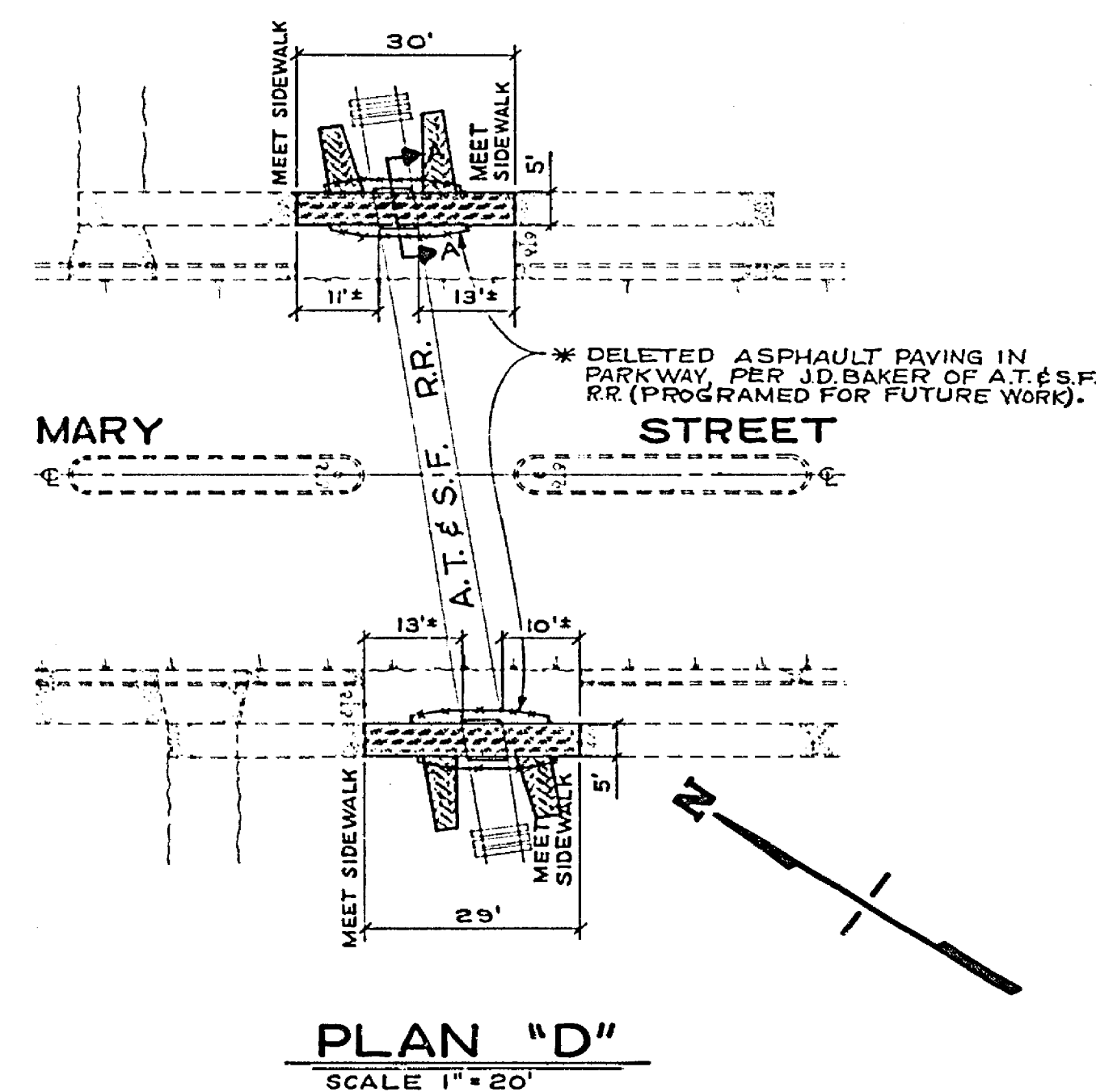

PLAN "D"
SCALE 1" = 20'

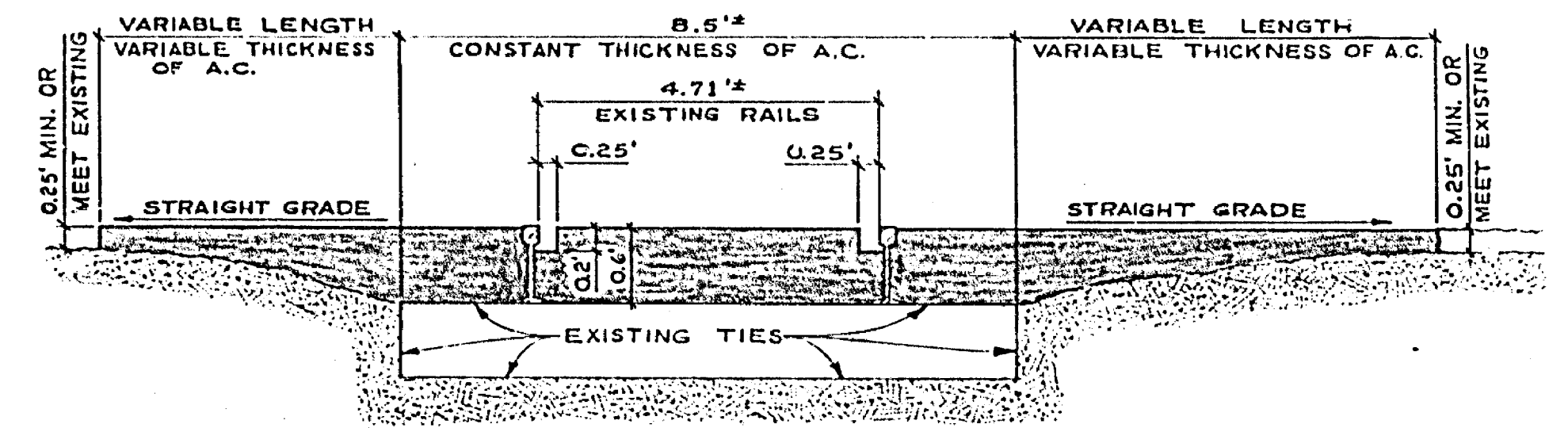

TYPICAL SECTION

SCALE HOR. 1" = 2'
VERT. 1" = 1'

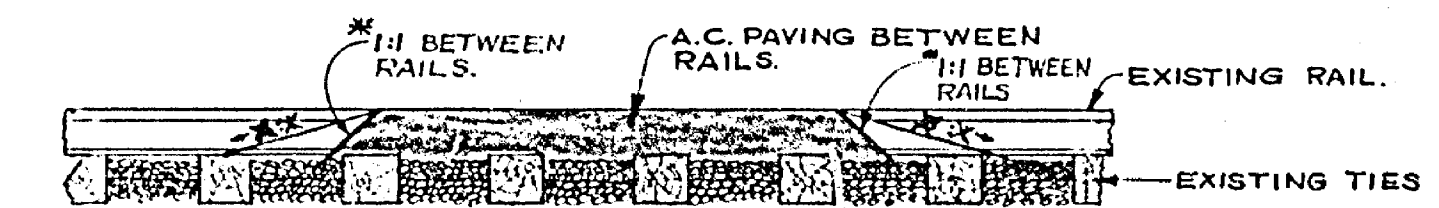

SECTION A-A

SCALE: 1" = 2'

GENERAL CONSTRUCTION NOTES:

1. THE CONTRACTOR SHALL BE RESPONSIBLE TO REPAIR OR REPLACE IN KIND AT HIS OWN EXPENSE ANY IMPROVEMENTS DAMAGED BY HIS OPERATIONS DURING CONSTRUCTION.
2. TRAFFIC SIGNS REMOVED DURING CONSTRUCTION SHALL BE SALVAGED BY THE CONTRACTOR AND RELOCATED AS DIRECTED BY THE INSPECTOR.
3. CONSTRUCTION OF PEDESTRIAN CROSSINGS IN THE TRACK AREA IS TO BE UNDER AT & S.F. SUPERVISION. CONTRACTOR IS TO NOTIFY THE RAILROAD FIVE DAYS PRIOR TO PERFORMING THIS WORK.

CONSTRUCTION LEGEND:

- [Pattern] A.C. PAVING BETWEEN RAILS AND OUT TO LIMITS AS SHOWN ON THE "PLANS" TO THE DEPTH AS NOTED ON THE "TYPICAL SECTION."
- [Pattern] *CONSTRUCTED ACCESS RAMPS WITH 3/4" SLAG MATERIAL AT A 8H SLOPE, PER RUC. 6.0.#118 AT ALL LOCATIONS.(6' WIDE).

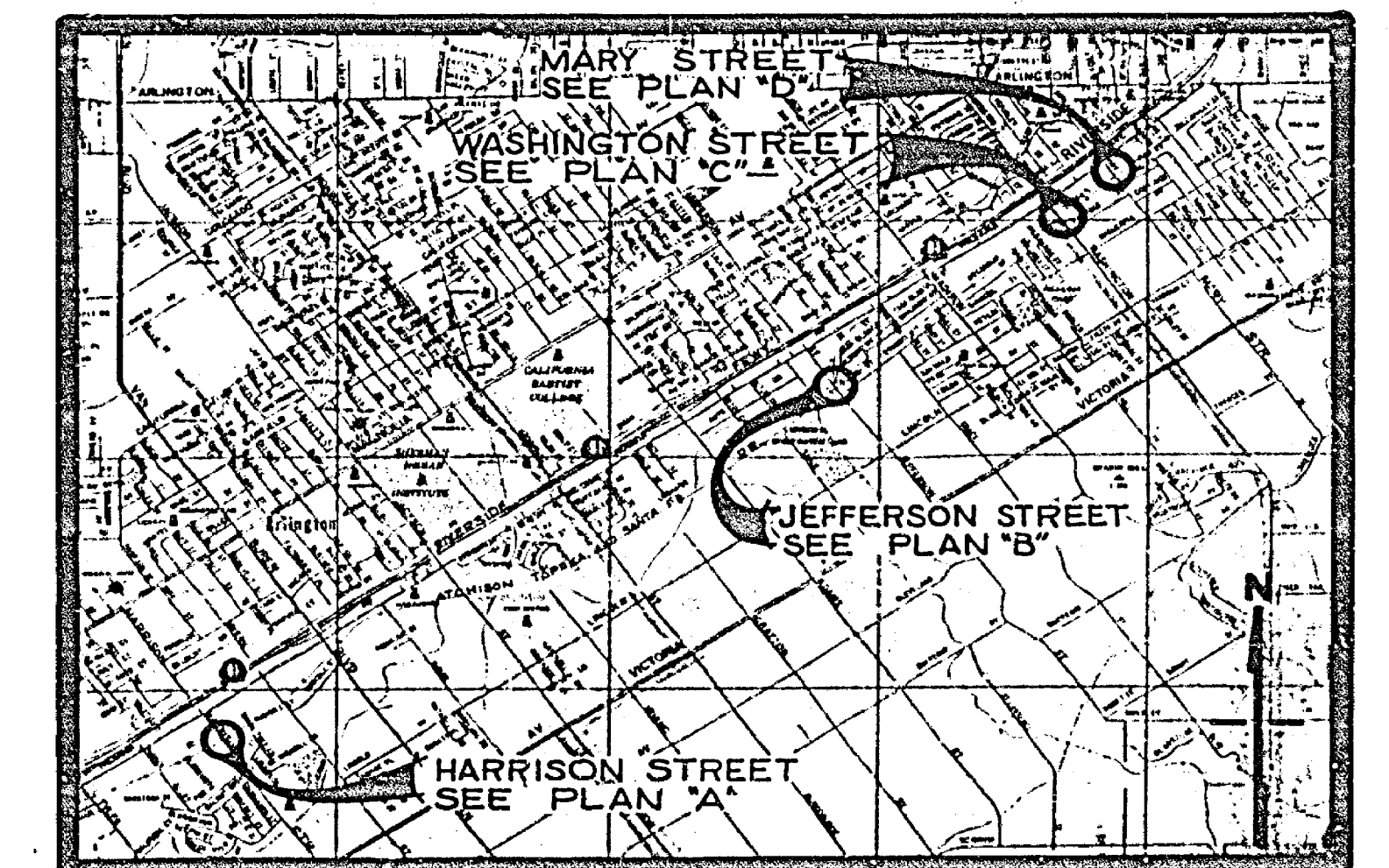

PROJECT LOCATION PLAN

SCALE 1" = 3000'

*"AS BUILT" 1-29-75 L.P.C. ACCOUNT NO. 201,203,204,205

CITY OF RIVERSIDE, CALIFORNIA PUBLIC WORKS DEPARTMENT		PEDESTRIAN CROSSINGS AT A.T. & S.F. R.R.		ACCOUNT NO. 201,203,204,205
APPROVED BY PRINCIPAL ENGINEER PARK DEPARTMENT	BY DATE 6/24	APPROVED BY DIRECTOR OF PUBLIC WORKS	DATE 6-24-74	DRAWING NUMBER R-1735
DESIGNED BY DF	REVISIONS	APP'D DATE	CHECKED BY WLL	SHEET 1 OF 1

SCALE: AS SHOWN