

**BENCH MARK**

(Cont'd from sheet R-1742-A)

**GENERAL NOTES**

1. Construction shall be in accordance with the standard specifications for public works construction 1973 edition and per City of Riverside standard drawings.
2. Curb and gutter, sidewalk, drainage work, earth retaining and traffic signal work by developer.
3. From edge of curb pavement shall be maintained with a 4" concrete curb and gutter as shown on drawings and as detailed in the field to provide a smooth section.
4. CURB AND GUTTER, SIDEWALK, DRAINAGE WORK, EARTH RETAINING AND TRAFFIC SIGNAL WORK BY DEVELOPER.

**TRAFFIC SIGNAL CONSTRUCTION NOTES**

- (Ref. Signal Plan R-458)
- All work shall conform to the January 1972 provisions of section 65.411 of the California Vehicle Code and the January 1972 provisions of section 65.412 of the California Vehicle Code and the January 1972 provisions of section 65.413 of the California Vehicle Code and the January 1972 provisions of section 65.414 of the California Vehicle Code and the January 1972 provisions of section 65.415 of the California Vehicle Code and the January 1972 provisions of section 65.416 of the California Vehicle Code and the January 1972 provisions of section 65.417 of the California Vehicle Code and the January 1972 provisions of section 65.418 of the California Vehicle Code and the January 1972 provisions of section 65.419 of the California Vehicle Code and the January 1972 provisions of section 65.420 of the California Vehicle Code.
1. All existing and new traffic signals shall be installed in accordance with the traffic signal manual.
  2. Verify the field engineer representative of contractor agrees with the traffic signal representative.
  3. Install new conductors as shown on drawings.
  4. Live detectors shall be installed with 3 lanes and 2 lanes over the top intersection.
  5. Intersect existing conductors shall be installed with 2 lanes and 2 lanes over the top intersection.
  6. Package and relocate existing standards and equipment to meet standards and equipment as shown on drawings.
  7. Install new standards and equipment as shown on drawings.
  8. Install new signal pole, box, base and conductors with new signal cabinet for the collector as shown.
  9. All conductors shall be installed as shown.

**-CAUTION-  
HIGH PRESSURE GAS**

**THIS CONTRACT  
(WITHIN HEAVY BOUNDARY)**

**ARLINGTON AVENUE**

**ARLINGTON AVENUE**

**VICTORIA AVENUE**

**THIS CONTRACT**

**TYPICAL SECTION  
ARLINGTON AVENUE**

7.1 = 3.0

**ALBERT A. WEBB ASSOCIATES**  
CIVIL ENGINEERS  
RIVERSIDE, CALIFORNIA

APPROVED BY: *[Signature]* DATE: 1/17/74  
R.E. No. 287C

DESIGNED BY: *[Signature]* DRAWN BY: *[Signature]*

**CITY OF RIVERSIDE, CALIFORNIA  
PUBLIC WORKS DEPARTMENT**

APPROVED BY: *[Signature]* DATE: 1/23/74  
TRAFFIC DIVISION

**STREET PLAN AND PROFILE  
ARLINGTON AVENUE  
CITY PARTICIPATION  
TRACT NO. 5311**

**INDEXED - RA**  
DRAWING NUMBER: **R-1742-A**  
SHEET: **1 OF 2**

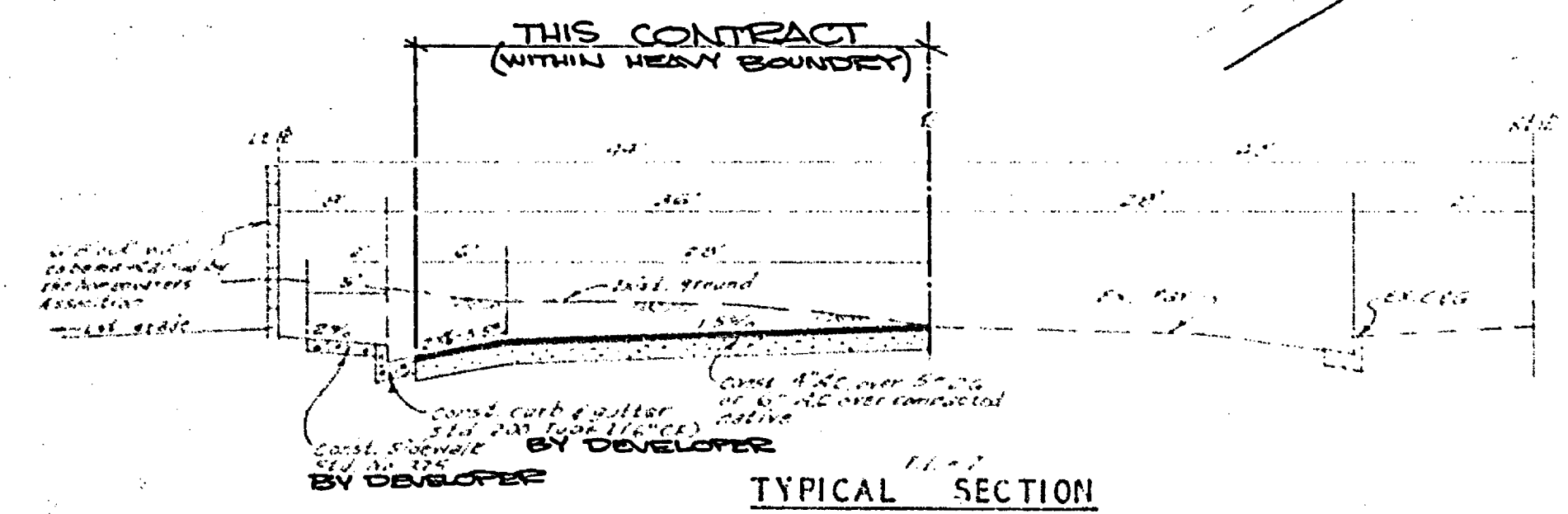
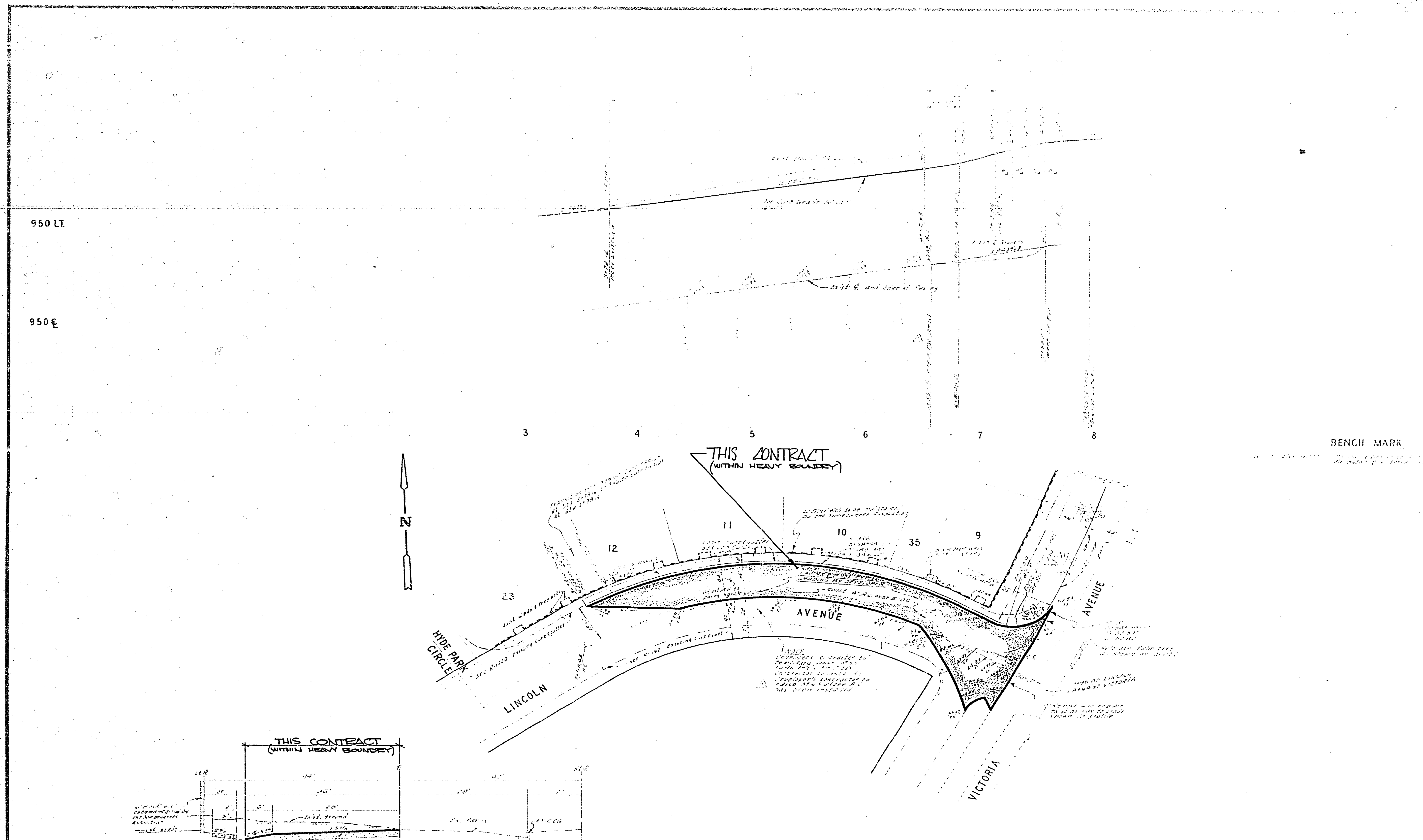

<p>ALBERT A. WEBB ASSOCIATES CIVIL ENGINEERS RIVERSIDE, CALIFORNIA</p> <p>APPROVED BY: <i>D. H. Webb</i> DATE: 9/15/76 R.E. NO. 2876</p> <p>WB 225 FOR CIVIL ENGINEERS CO. 10-177</p>	<table border="1"> <tr><td>DESIGNED BY: <i>STZ</i></td><td>REVISIONS:</td></tr> <tr><td>DRAWN BY: <i>MEZ</i></td><td>CHECKED BY: <i>MEZ</i></td></tr> </table>	DESIGNED BY: <i>STZ</i>	REVISIONS:	DRAWN BY: <i>MEZ</i>	CHECKED BY: <i>MEZ</i>	<p>CITY OF RIVERSIDE, CALIFORNIA PUBLIC WORKS DEPARTMENT</p> <p>APPROVED BY: <i>[Signature]</i> DATE: 1-2-76 DIRECTOR OF PUBLIC WORKS</p>	<p>STREET PLAN AND PROFILE LINCOLN AVENUE CITY PARTICIPATION TRACT NO. 5311</p>	<p>ACCOUNT NO. 30-975-505-07 DRAWING NUMBER: <b>R-1742A</b> SHEET <b>2</b> OF <b>2</b> 73-9-A</p>
DESIGNED BY: <i>STZ</i>	REVISIONS:							
DRAWN BY: <i>MEZ</i>	CHECKED BY: <i>MEZ</i>							

ADAPTED FROM PLAN R-1742