

**CURVE DATA**

| RADIUS | DELTA     | TANGENT | LENGTH |
|--------|-----------|---------|--------|
| 10'    | 97°41'55" | 11.44'  | 14.97' |
| 10'    | 82°18'09" | 8.74'   | 14.36' |

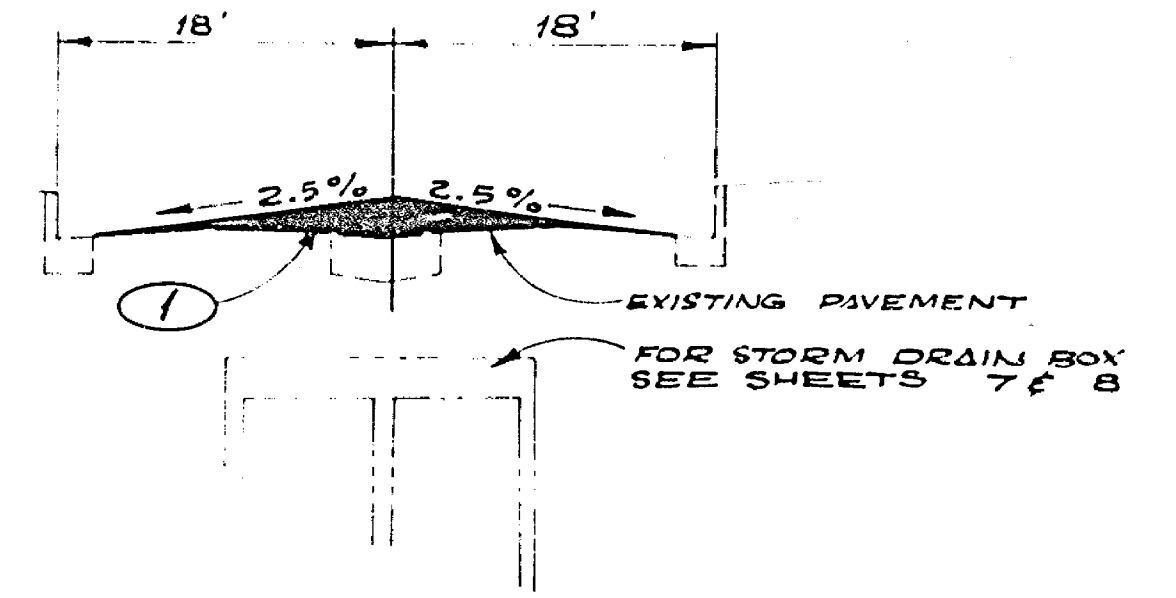
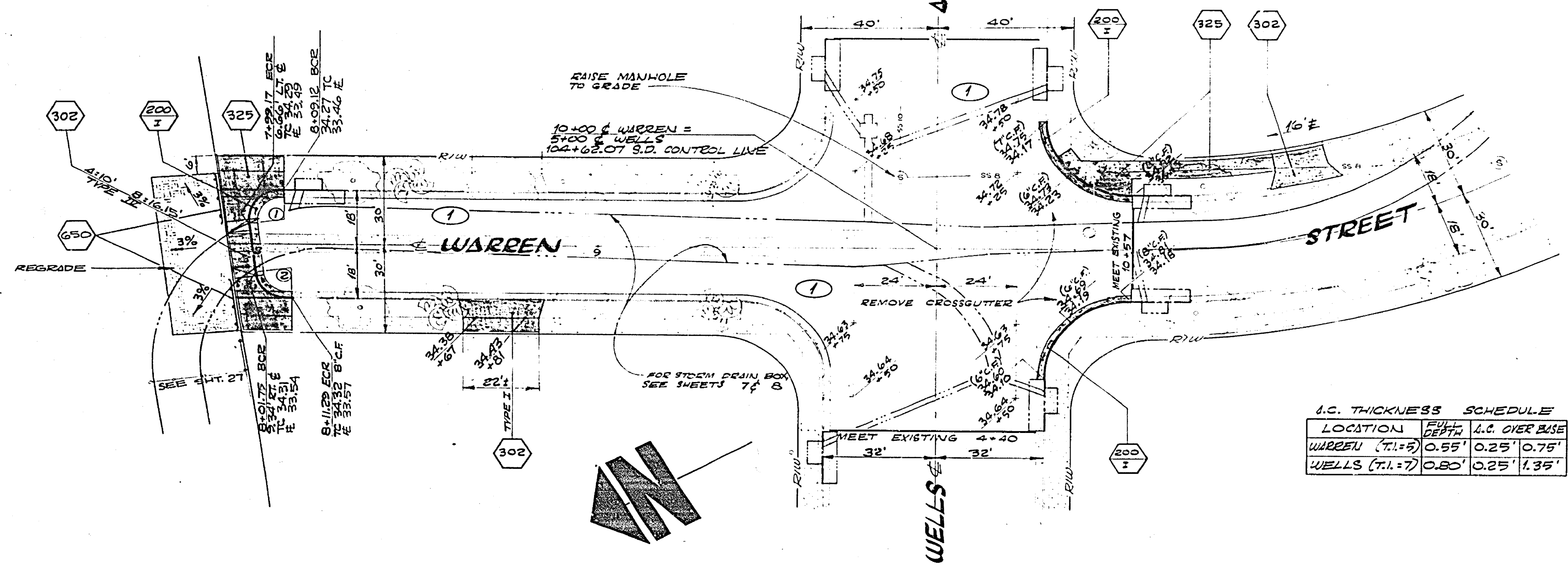

**A.C. THICKNESS SCHEDULE**

| LOCATION        | FULL DEPTH | A.C. OVER BASE |
|-----------------|------------|----------------|
| WARREN (T.I.=6) | 0.55'      | 0.25' 0.75'    |
| WELLS (T.I.=7)  | 0.80'      | 0.25' 1.35'    |

- CONSTRUCT PER CITY OF RIVERSIDE STANDARD DRAWING NUMBER AS SHOWN ON PLAN.
- CURB RETURNS ARE 25' RADIUS
- WHERE PAVEMENT EXISTS, OVERLAY WITH VARIABLE THICKNESS OF A.C. TO LIMITS AND GRADES SHOULD WHERE PAVEMENT HAS BEEN REMOVED OR IS UNSATISFACTORY, REMOVE AND REPLACE TO LIMITS AND GRADES ON THE PLANS AND TO THE THICKNESSES FROM THE SCHEDULE AT LEFT.
- ALL NEW PAVEMENT, DRIVEWAYS, AND CURB & GUTTER ELEVATIONS SHOWN ON PLAN SHALL BE STAMPED.

CITY/RIVERSIDE NUMBER R-1758

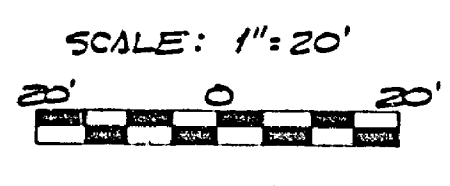

**CITY OF RIVERSIDE PUBLIC WORKS DEPARTMENT**

APPROVED BY: [Signature] DATE: 10-9-74

DESIGNED BY: [Signature] DATE: MAY 1974

TRAFFIC DIVISION: [Signature]

CHIEF ENGINEER: [Signature]

| REVISIONS | DESCRIPTION | APPR. DATE | DESIGNED BY | DATE DRAWN | CHECKED BY | APPROVED BY | DATE |
|-----------|-------------|------------|-------------|------------|------------|-------------|------|
|           |             |            |             |            |            |             |      |

RIVERSIDE COUNTY FLOOD CONTROL AND WATER CONSERVATION DISTRICT

ANZA CHANNEL STAGE I

1970 STORM DRAIN BOND ISSUE PROJECT NO. 18

PROJECT NO. 1-0-150  
DRAWING NO. R-1758  
SHEET NO. 1 OF 1