

741 E

741 E

741 RT.

741 RT.

R.M. HOUSE DUE IN ONE FOOT 42 FT. EAST OF TRAIL, 65' SOUTH OF MANHOLE IN GAS STATION. E.L. 741.243

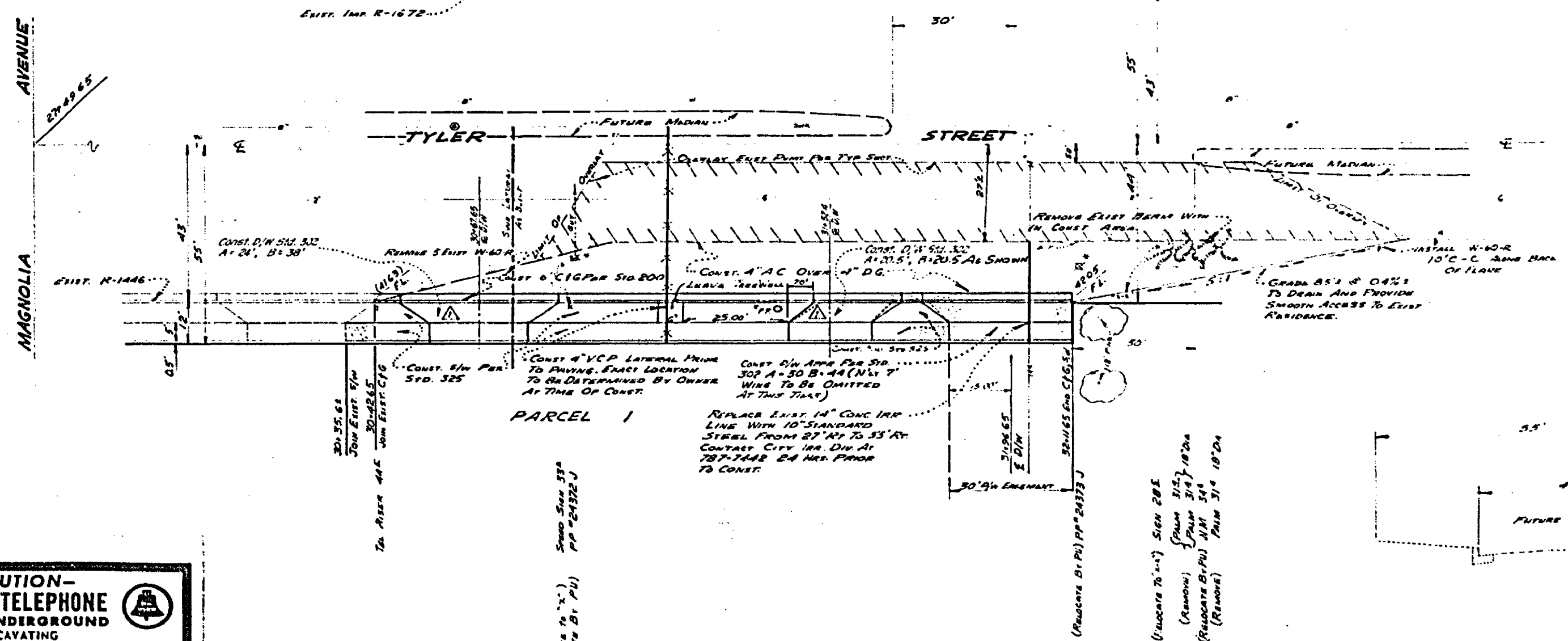

- GENERAL NOTES
1. It shall be the responsibility of the Contractor to clear the right-of-way in accordance with the provisions of law as it affects each utility, including irrigation lines and appurtenances, and at no cost to the City.
 2. Construction shall be in accordance with the City of Riverside, Department of Public Works, Standard Drawings and the Standard Specifications for Public Works Construction, 1971 Edition.
 3. Prime coat, seal coat, and paint binder are required.
 4. All flagged elevations shall be staked in the field by the Engineer.
 5. Trim edge of existing pavement where pavement joins to a smooth straight line. Construct match-up paving as shown on plan and overlay paving as directed in the field to produce a smooth section. Engineer estimates overlay to be 40 tons.
 6. Curb and gutter shall be staked with 1-foot offsets at 2-foot intervals. To show, use the 20' offset at the curbline shown in the curb and gutter.

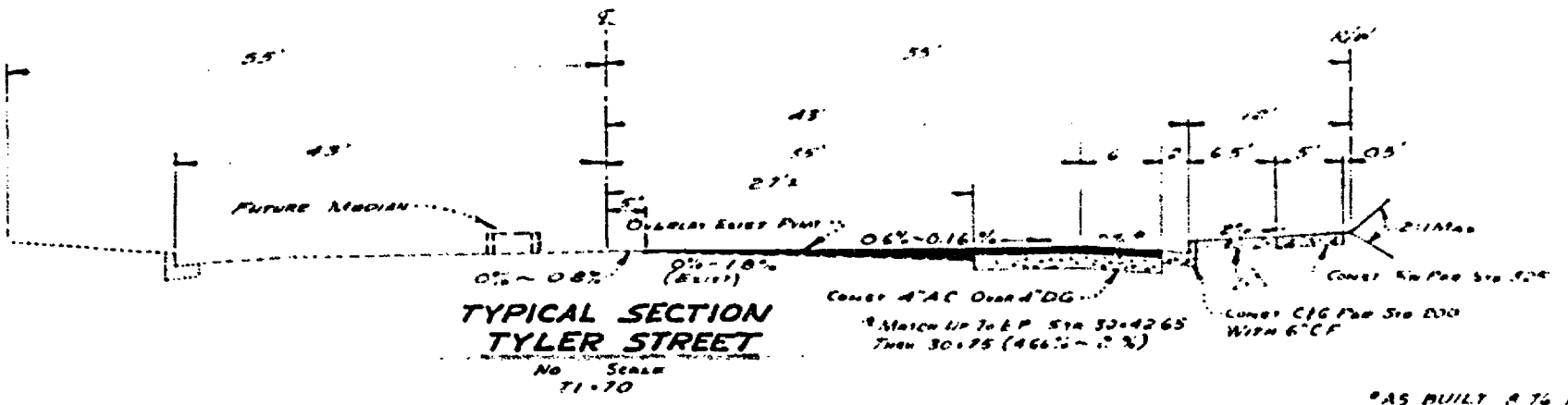

CAUTION - PACIFIC TELEPHONE CABLES UNDERGROUND BEFORE EXCAVATING

CALL COLLECT: 1-800-4-A-PACIFIC

Orange County 714-432-0211 714-347-0404
 Riverside County 714-480-0271 714-347-0404
 Inyo County 714-480-0271 714-347-0404
 San Bernardino County 714-480-0271 714-347-0404
 San Diego County 714-432-3113 714-347-0404
 San Jose County 714-780-3113 714-347-0404

FOR FREE CABLE LOCATING SERVICE

J. F. DAVIDSON ASSOCIATES
 CIVIL ENGINEERS - SURVEYORS - PLANNERS
 RIVERSIDE, CALIFORNIA

APPROVED BY: *[Signature]* DATE: 4-75

CITY OF RIVERSIDE, CALIFORNIA
 DEPARTMENT OF PUBLIC WORKS

APPROVED BY: *[Signature]* DATE: 4-75

STREET PLAN AND PROFILE
 TYLER STREET
 220' TO 396' N.W. OF MANHOLE AVE
 DIST. 214

PROJECT NO. R-1818
 SHEET 1 OF 1
 FILE NO. 4-1818