

**BENCH MARK:**  
 P.M. 201-12-08 18" DIA. IRON PIPE IN CONG. PILE  
 50' IN DIAMETER WELLS 55' S.E. OF SE. CORNER  
 RAV. AT WASHINGTON ST. ELEV. 866.97

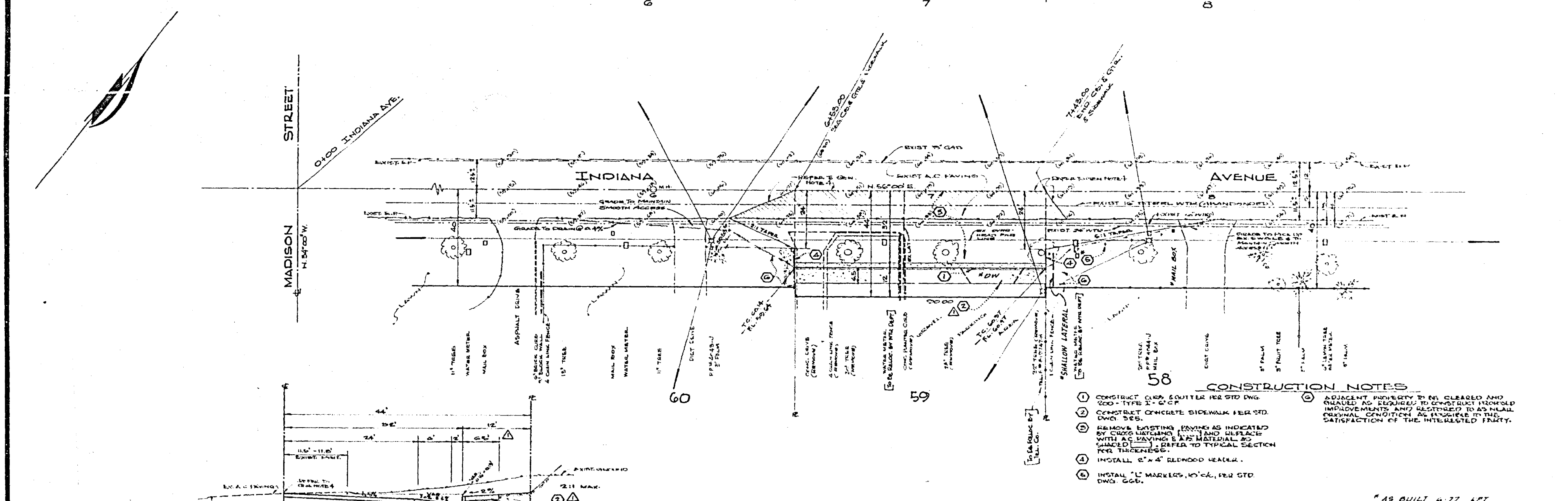

- GENERAL NOTES**
- CONSTRUCTION SHALL BE IN ACCORDANCE WITH THE STANDARD SPECIFICATIONS FOR PUBLIC WORKS CONSTRUCTION, 1978 EDITION AND PER CITY OF RIVERSIDE STANDARD DRAWING.
  - IT SHALL BE THE RESPONSIBILITY OF THE CONTRACTOR TO OBTAIN THE RIGHT OF WAY IN ACCORDANCE WITH THE PROVISIONS OF LAW AND TO MAINTAIN ALL UTILITIES INCLUDING UTILITIES UNDER AND ABOVE GROUND, AND AT ALL COSTS TO THE CITY.
  - THE DEVELOPER SHALL ARRANGE FOR A SOIL TEST TO BE MADE BY A SOILS ENGINEER TO DETERMINE THE STRENGTH, DEGREE OF COMPACTNESS, PERCENTAGE OF MOISTURE, AND ALL OTHER DATA WHICH SHALL BE DETERMINED BY CITY OF RIVERSIDE DESIGN ENGINEER AND TEST PROCEDURES.
  - TOIN EDGE OF EXISTING PAVEMENT WHERE NEW PAVEMENT IS TO BE PLACED, A SMOOTH STRIPPER LINE, CONSTRUCTED BY SOILS ENGINEER TO DETERMINE THE STRENGTH, DEGREE OF COMPACTNESS, PERCENTAGE OF MOISTURE, AND ALL OTHER DATA WHICH SHALL BE DETERMINED BY CITY OF RIVERSIDE DESIGN ENGINEER AND TEST PROCEDURES.
  - CURB AND GUTTER SHALL BE INSTALLED WITH 2" OFFSET AT 10' INTERVALS, UNLESS OTHERWISE INDICATED BY PUBLIC WORKS DEPT. CITY OF RIVERSIDE.
  - ALL FACILITY SIGNAGE SHALL BE STAGED IN THE FIELD BY THE CONTRACTOR.
  - LOCATION OF EXISTING UTILITIES HAS NOT BEEN DETERMINED AT TIME OF CONSTRUCTION AND APPROPRIATE TO BE DETERMINED BY THE CONTRACTOR.
  - EXISTING PLANTINGS AND INDICATED THUSLY (TYPED).

- CONSTRUCTION NOTES**
- CONSTRUCT CURB AND GUTTER PER STD DWG 74-126-A.
  - CONSTRUCT CONCRETE SIDEWALK PER STD DWG 74-126-A.
  - REMOVE EXISTING DRIVE AS INDICATED BY CURB AND GUTTER, EXISTING DRIVE TO BE RECONSTRUCTED PER TYPICAL SECTION SEE THEREAFTER.
  - INSTALL 12" 4" SLENDRO HEAVY.
  - INSTALL 12" MARKERS 10' ON CENTER PER STD DWG 74-126-A.
  - ADJUSTMENT PERMITTED BY THE CONTRACTOR AND AS LONG AS THE RESULTING CONSTRUCTION IS IN ACCORDANCE WITH THE STANDARD SPECIFICATIONS FOR PUBLIC WORKS CONSTRUCTION, 1978 EDITION AND PER CITY OF RIVERSIDE STANDARD DRAWING.

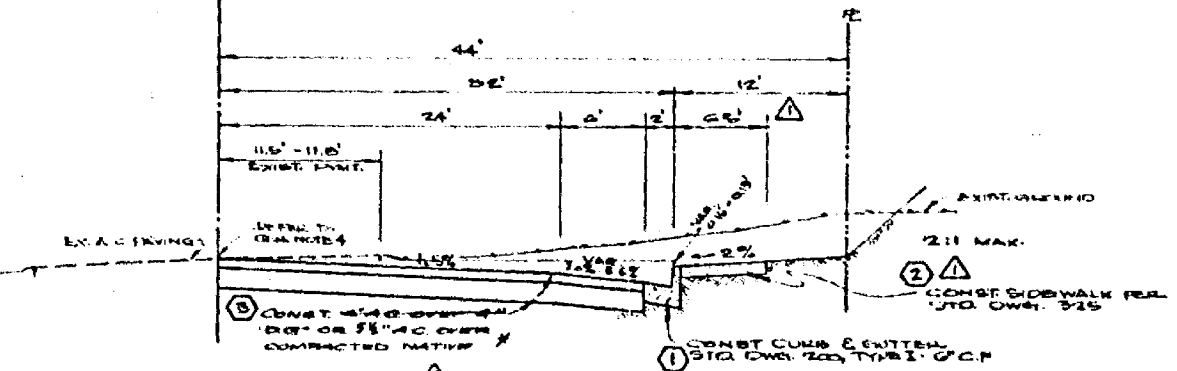

<b>ALBERT A. WEBB ASSOCIATES</b> CIVIL ENGINEERS RIVERSIDE, CALIFORNIA APPROVED BY: <i>[Signature]</i> R.E. No. 2475 W-74-126 FOR: C.L. SMITH COMPANY		<b>CITY OF RIVERSIDE, CALIFORNIA</b> PUBLIC WORKS DEPARTMENT APPROVED BY: <i>[Signature]</i> DIRECTOR OF PUBLIC WORKS DATE: 11-16-74		<b>STREET IMPROVEMENT PLAN</b> <b>INDIANA AVENUE</b> SELY SIDE FROM 625' TO 745' NELY OF MADISON STREET ZONING CASE H-24-724 SCALE: 1" = 20' HORIZ. 1" = 2' VERT.		ACCOUNT NO. DRAWING NUMBER <b>R-1033</b> SHEET 1 OF 1 <b>74-126 A</b>	
--	--	--	--	--	--	---	--