

NO.	DATE	BY	REVISION
1			AS SHOWN

B.M. ELEV. 855.95 R.R. SPIKE IN E 2202 SE. COR. EVANS & JEFFERSON.  
 B.M. ELEV. 846.07 ON E.H.W. COR. INDIANA & JEFFERSON.  
 F.S. 636/02-07 L/1-8  
 SCALE: VERT. 1" = 5'  
 HOR. 1" = 50'  
 B.M. ELEV. 852.24 U.S.G.S. Q 38 1924 - 1 IN W.H.W. OF CULVERT NO. B-15 ON AT & S.F. RR 120 W. OF JEFFERSON ST.  
 B.M. ELEV. 839.81 SPK. IN POLE 12208 J N. COR. JEFF. & INDIANA

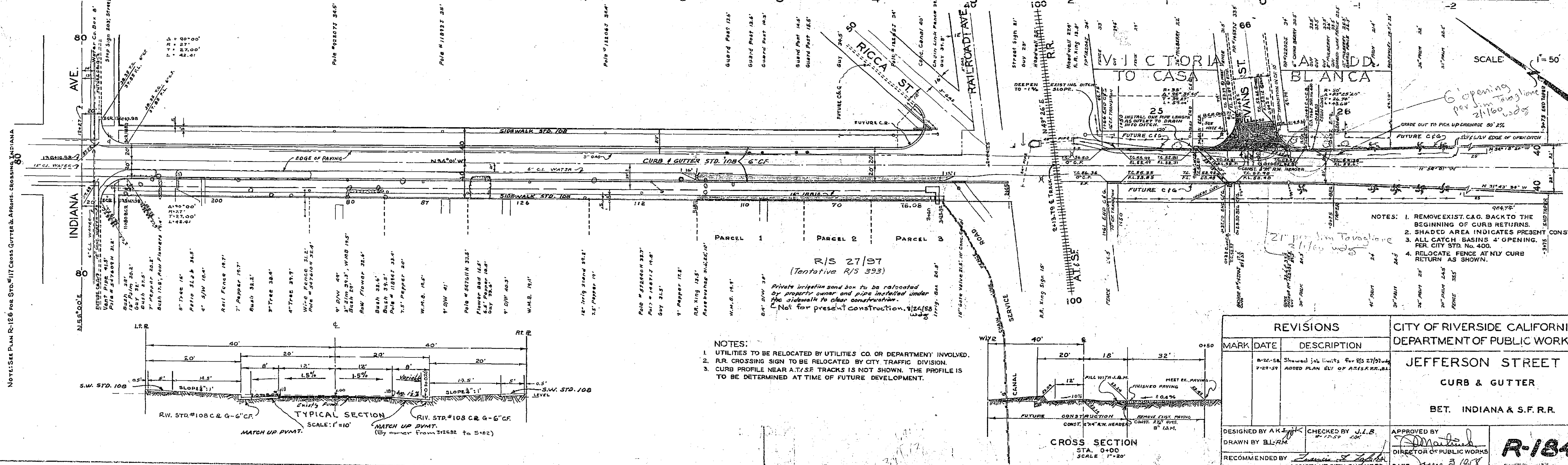

NOTE: SET PLAN R/126 FOR ST. WITH CURBS CURVED & ADJUST. CORNER INDIANA

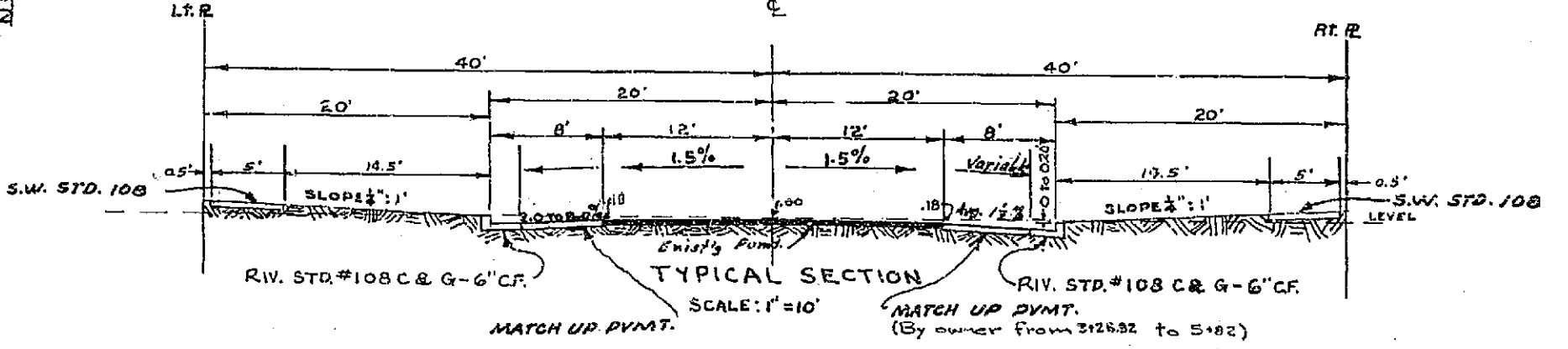

- NOTES:
1. UTILITIES TO BE RELOCATED BY UTILITIES CO. OR DEPARTMENT INVOLVED.
  2. R.R. CROSSING SIGN TO BE RELOCATED BY CITY TRAFFIC DIVISION.
  3. CURB PROFILE NEAR A.T.&S.F. TRACKS IS NOT SHOWN. THE PROFILE IS TO BE DETERMINED AT TIME OF FUTURE DEVELOPMENT.

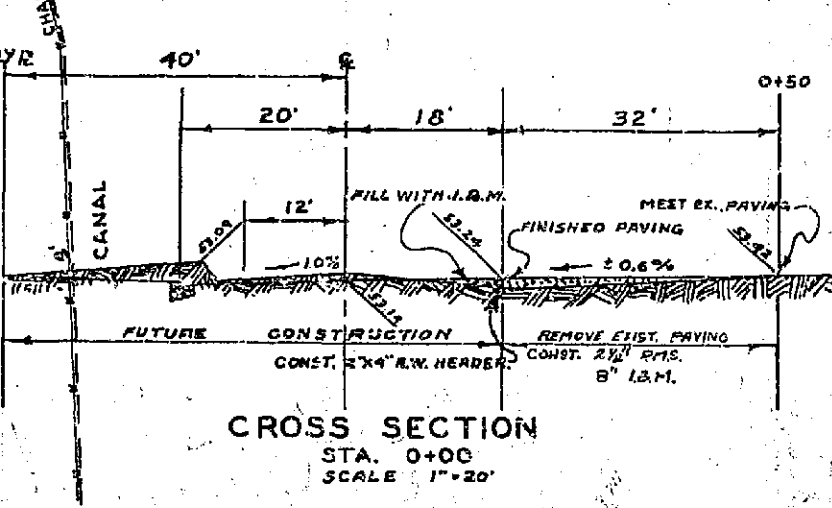

REVISIONS			CITY OF RIVERSIDE CALIFORNIA DEPARTMENT OF PUBLIC WORKS
MARK	DATE	DESCRIPTION	
			JEFFERSON STREET CURB & GUTTER BET. INDIANA & S.F. RR.

DESIGNED BY AK	CHECKED BY J.L.B.	APPROVED BY	R-184
DRAWN BY BL/RM		DIRECTOR OF PUBLIC WORKS	
RECOMMENDED BY	ASSISTANT CITY ENGINEER	DATE June 3, 1918	

