

870 LT

870 CL

860 LT

860 CL

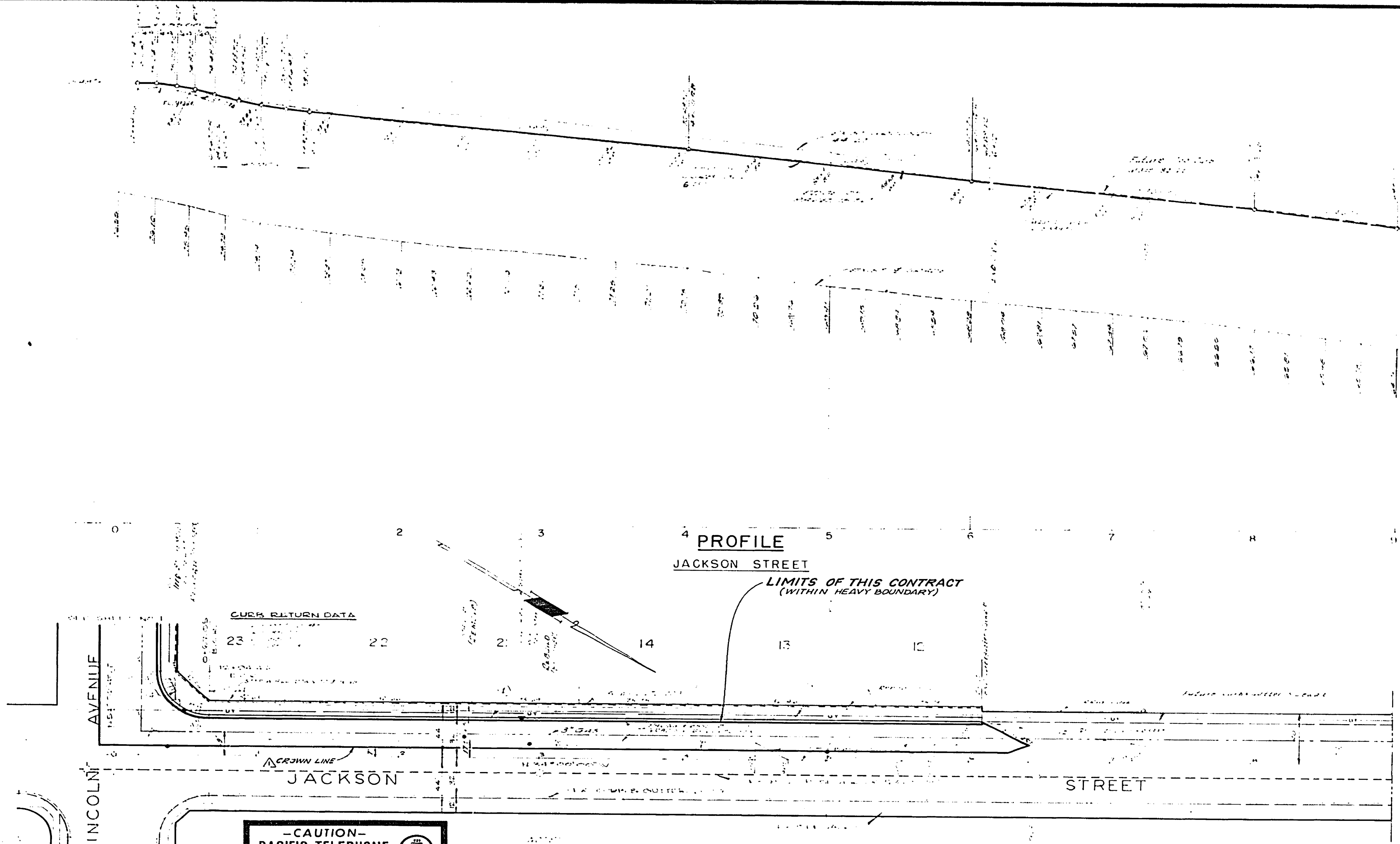

LINCOLN AVENUE

JACKSON STREET

STREET

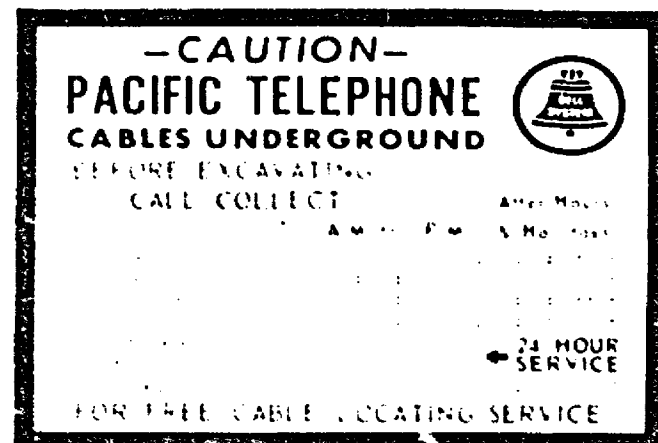

PLAN JACKSON STREET

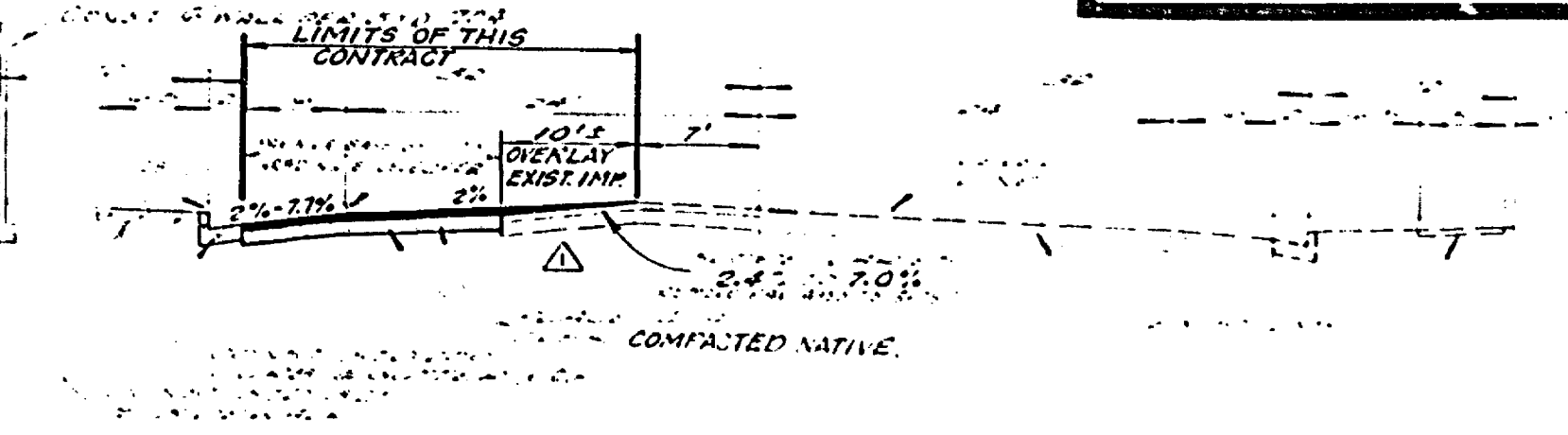

TYPICAL SECTION JACKSON STREET

BENCH MARK

ALBERT A. WEBB ASSOCIATES CIVIL ENGINEERS RIVERSIDE, CALIFORNIA APPROVED BY: [Signature] DATE: 11/11/71 R.E. No. 2472		CITY OF RIVERSIDE, CALIFORNIA PUBLIC WORKS DEPARTMENT APPROVED BY: [Signature] DATE: 11/23/71 DIRECTOR OF PUBLIC WORKS		TRACT NO. 5486-1 CITY PARTICIPATION JACKSON STREET ACCOUNT NO. 30-575-370-07 DRAWING NUMBER R-1860-A SHEET 2 OF 2
DESIGNED BY: [Signature] DRAWN BY: W.L.C. CHECKED BY: [Signature]		SCALE: HORIZ. 1" = 40' VERT. 1" = 4' AS BUILT 3-27-1971		ADAPTED FROM PLAN R-1860

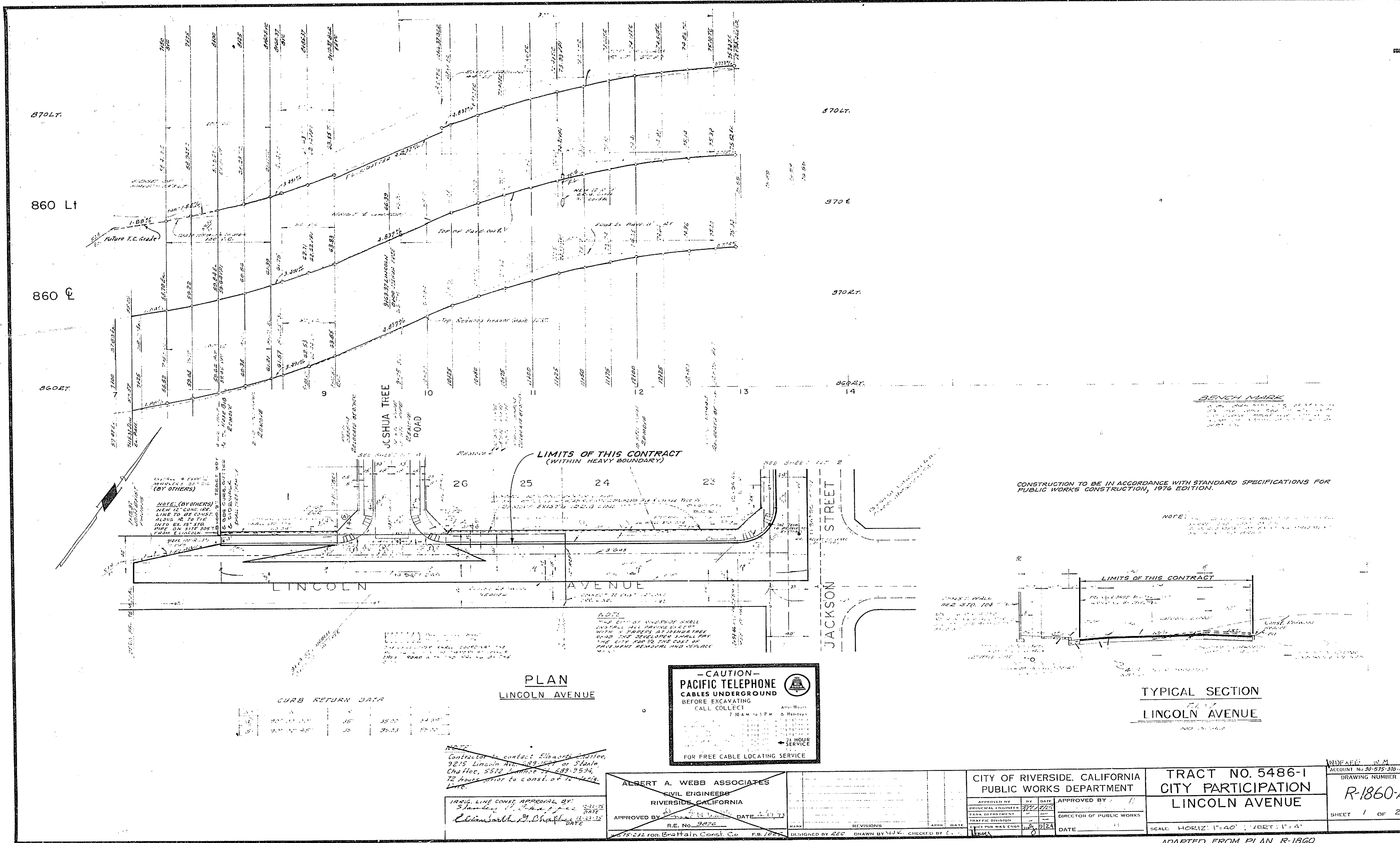

BENCH MARK
 1. 1976
 2. 1976
 3. 1976
 4. 1976
 5. 1976
 6. 1976
 7. 1976
 8. 1976
 9. 1976
 10. 1976
 11. 1976
 12. 1976
 13. 1976
 14. 1976

CONSTRUCTION TO BE IN ACCORDANCE WITH STANDARD SPECIFICATIONS FOR PUBLIC WORKS CONSTRUCTION, 1976 EDITION.

NOTE: ...

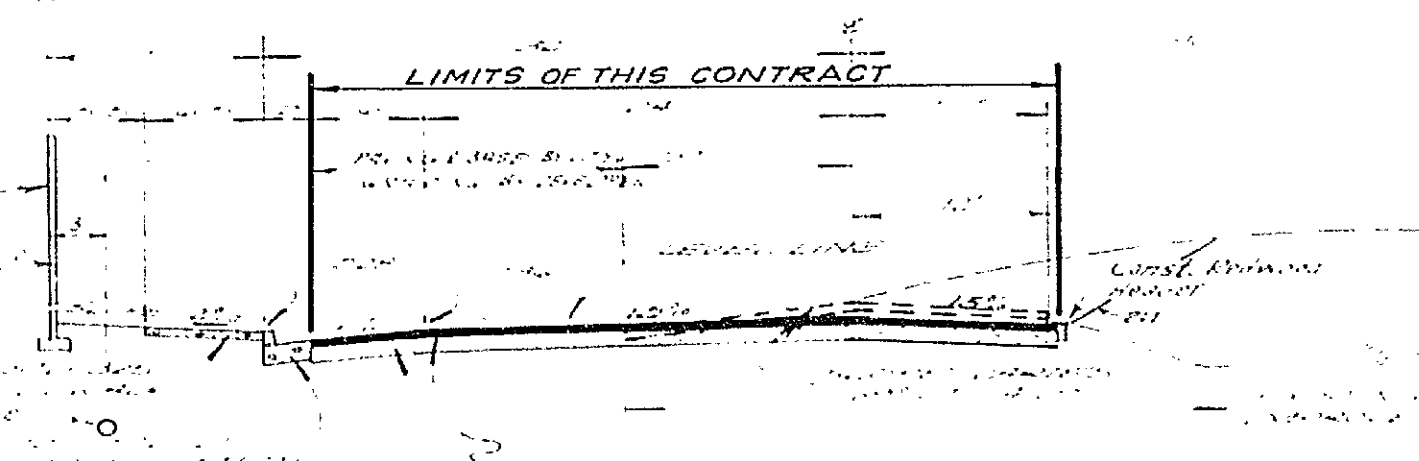

NOTE: (BY OTHERS)
 NEW 12" CONC. INK LINE TO BE CONSP. ALONG 16' TO THE INFO EX. 1ST SYS. LINE ON SITE 100' FROM LINCOLN

PLAN LINCOLN AVENUE

CURB RETURN DATA

STATION	DATE	TIME	REMARKS
1+00	12-22-75	10:00	...
1+25	12-22-75	10:00	...

CAUTION - PACIFIC TELEPHONE CABLES UNDERGROUND BEFORE EXCAVATING CALL COLLECT

7:30 AM - 5:30 PM & Holidays
 24 HOUR SERVICE

FOR FREE CABLE LOCATING SERVICE

NOTE: Contractor to contact Elsworth Utilities, 9215 Lincoln Ave., 92504 or Sdalan, Chaffee, 5572 Lincoln, 689-9534, 72 hours prior to const. of 12/22/75.

IRREG. LINE CONST. APPROVAL BY: *Shamley P. ...* DATE: 12-22-75
Elsworth Utilities DATE: 12-22-75

ALBERT A. WEBB ASSOCIATES CIVIL ENGINEERS RIVERSIDE, CALIFORNIA

APPROVED BY: *[Signature]* DATE: 12/22/75
 R.E. No. 9025

NO.	REVISIONS	DATE

CITY OF RIVERSIDE, CALIFORNIA PUBLIC WORKS DEPARTMENT

APPROVED BY: *[Signature]* DATE: 12/22/75
 TRAFFIC DIVISION

TRACT NO. 5486-1 CITY PARTICIPATION LINCOLN AVENUE

SCALE: HORIZ: 1"=40' VERT: 1"=4'

WDAFE: W.M.
 ACCOUNT No 30-975-310-07
 DRAWING NUMBER **R-1860-A**
 SHEET 1 OF 2