

55.0

11.0

11.0

82.0

8.8

11.1

11.1

55.0

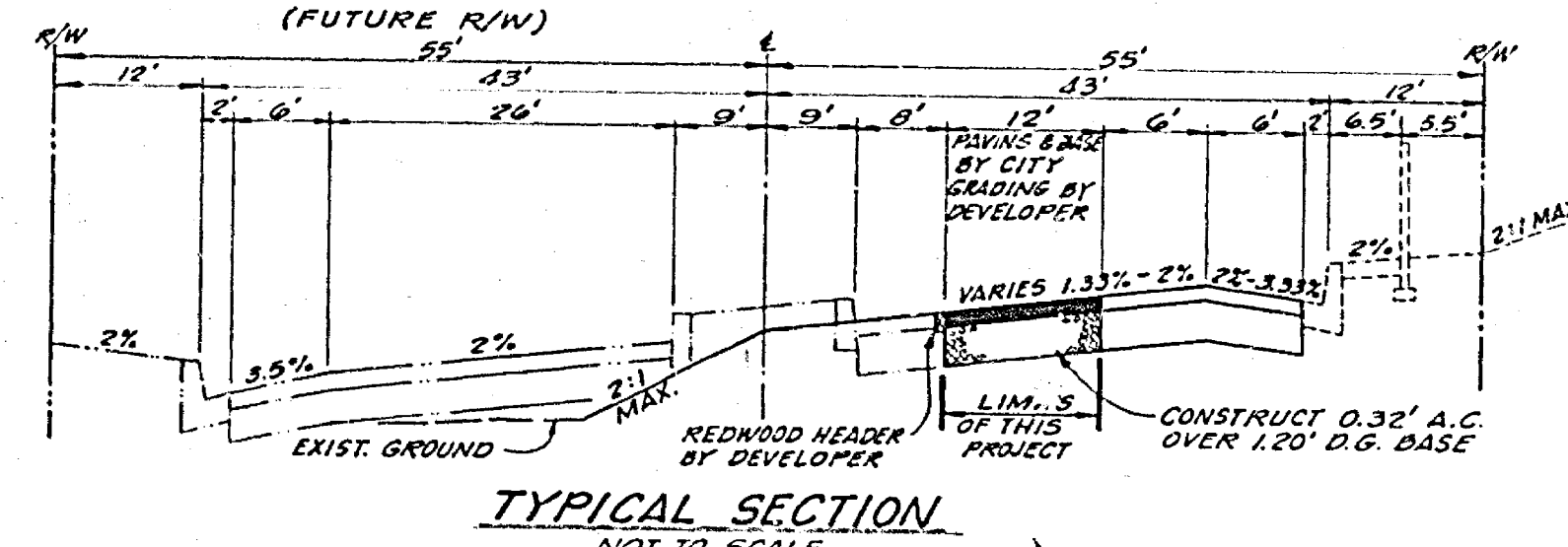
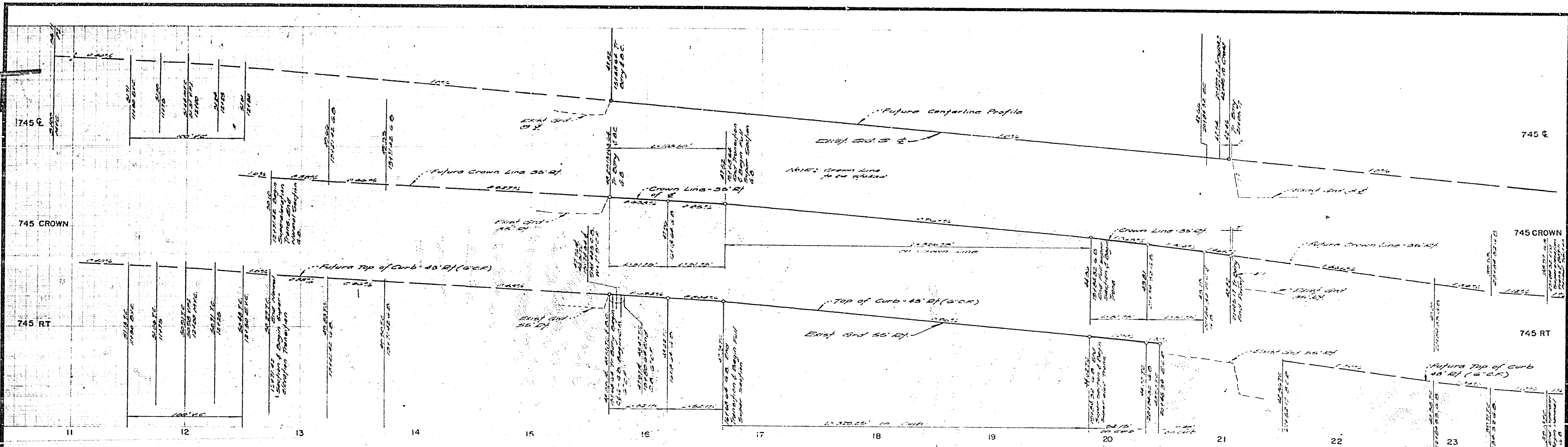

**CONSTRUCTION NOTES**  
 1. CONSTRUCTION SHALL BE IN ACCORDANCE WITH STANDARD SPECIFICATIONS FOR PUBLIC WORKS CONSTRUCTION, 1976 EDITION.

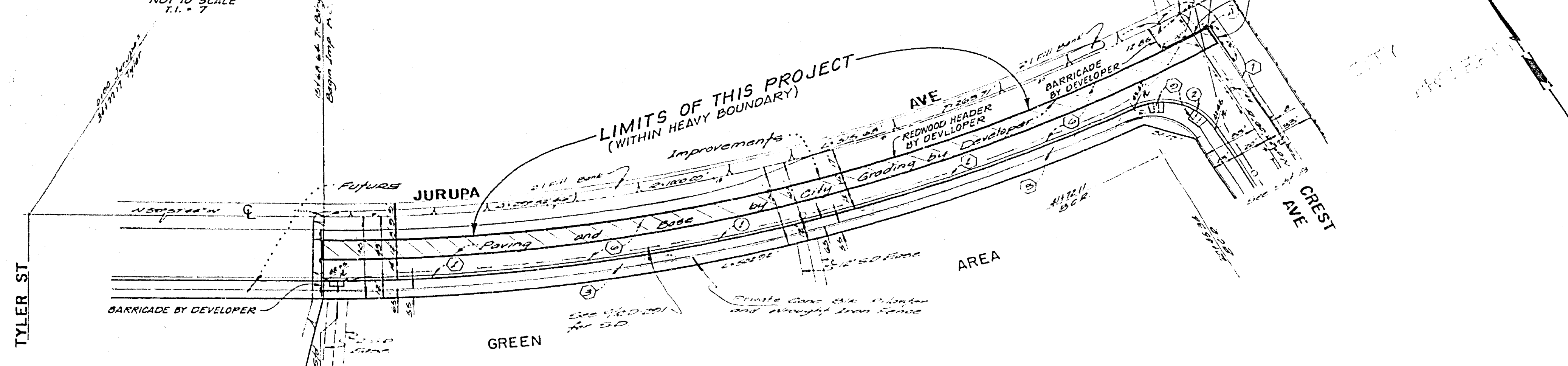

**CURB CURVE DATA**

Station	PC	PT	LC	EC
11+00	11+00.00	11+00.00	11+00.00	11+00.00
12+00	12+00.00	12+00.00	12+00.00	12+00.00
13+00	13+00.00	13+00.00	13+00.00	13+00.00

**BENCH MARK**  
 24.101 in 5000' Curb on Tyler St, on E. Gayland, located near City of Riverside P.O. Well - Elev. 172.21 (adjusted to Sea Datum Elev. 72.00 in May 1973)

<b>ALBERT A. WEBB ASSOCIATES</b> CIVIL ENGINEERS RIVERSIDE CALIFORNIA		<b>CITY OF RIVERSIDE, CALIFORNIA</b> PUBLIC WORKS DEPARTMENT		ACCOUNT NO. 30-575-355-07 DRAWING NUMBER <b>R-1884-A</b>
APPROVED BY: <i>[Signature]</i> DATE: 4-6-76 R.E. No. 12020	DESIGNED BY: <i>[Signature]</i> DRAWN BY: <i>[Signature]</i> CHECKED BY: <i>[Signature]</i>	APPROVED BY: <i>[Signature]</i> DATE: 4-12-76 DIRECTOR OF PUBLIC WORKS	SHEET 1 OF 1 SCALE: Horiz. 1"=40' Vert. 1"=4'	ADAPTED FROM PLAN R-1884