

**Note:**  
 IF IMPROVEMENTS ARE CONSTRUCTED CONCURRENTLY WITH IMPROVEMENTS FOR TRACT 3111, SEE CIVIL PLAN R-144 FOR PROFILE FROM 31100 TO 32100

CURVE DATA				
No.	R	Δ	T	L
1	782.00	115°22'05"	78.78	247.83

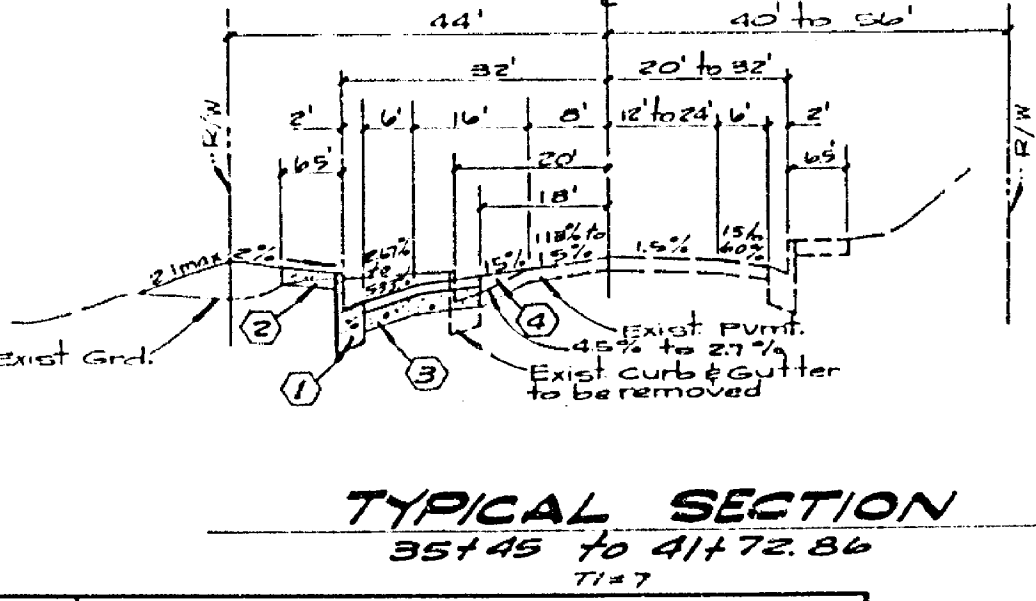
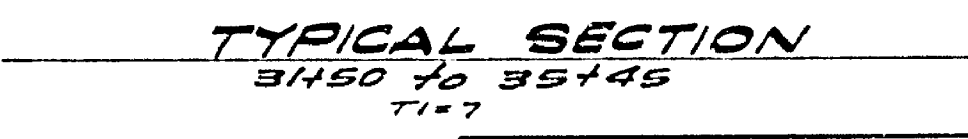
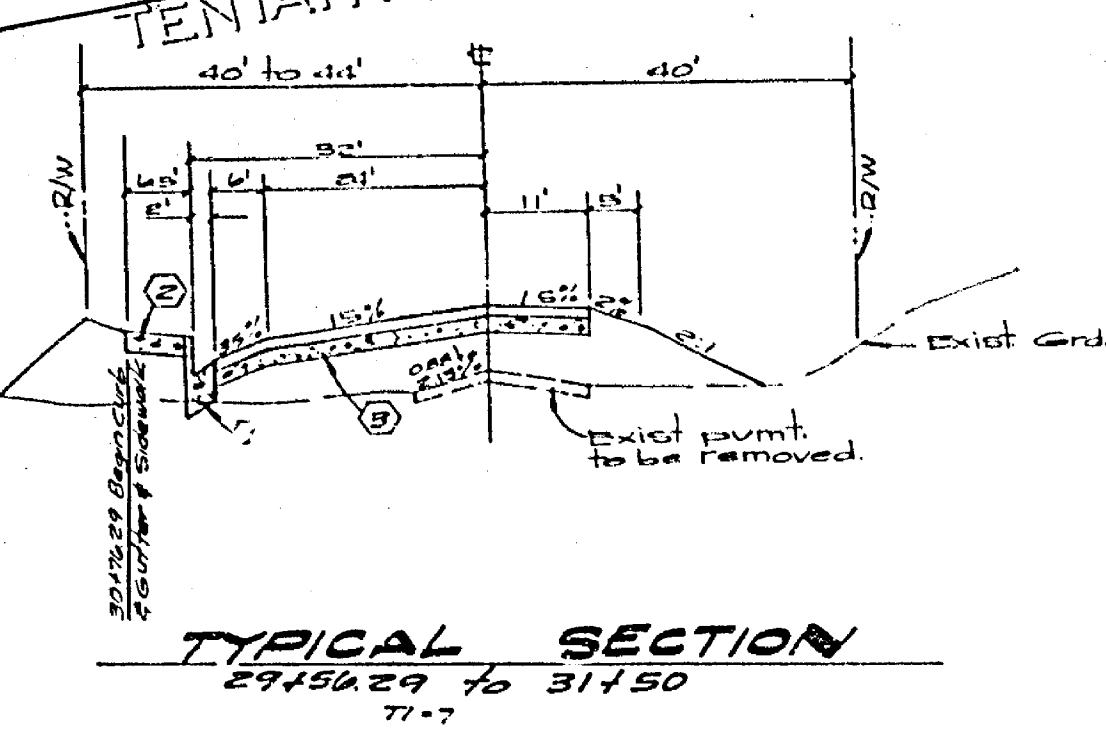
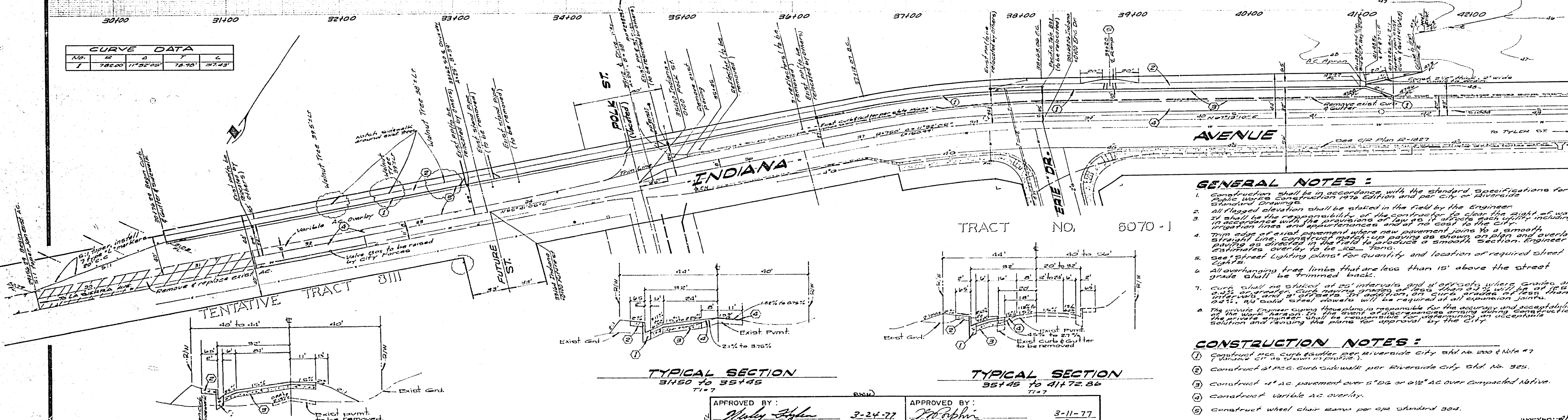

**BENCH MARK:**  
 81850 d.p.c. T. et in concrete, stamped 20-25-68 on west side of Tyler St, 250' N. of Indiana and 1/2' Northeast of Bridge No. 52-414.  
 Elev. 756.645

- GENERAL NOTES:**
- Construction shall be in accordance with the standard specifications for Public Works Construction 1976 Edition and per City of Riverside Standard Drawings.
  - All flagged elevations shall be staked in the field by the Engineer.
  - All flagged elevations shall be the responsibility of the contractor to clear the right of way in accordance with the provisions of law to all depths each utility including irrigation lines and appurtenances and at no cost to the City.
  - Top edge of existing pavement where new pavement joins to a smooth straight line. Construct match-up paving as shown on plan and overlay existing as directed in the field to produce a smooth section. Engineer estimates overlay to be 20 tons.
  - See "Street Lighting Plans" for quantity and location of required street lights.
  - All overhanging tree limbs that are less than 15' above the street grade shall be trimmed back.
  - Curb shall be staked at 25' intervals and 4' offsets where grades are 0.4% or greater. Curb marking grades of less than 0.4% will be at 10' intervals and 4' offsets. For addition, on curb grades of less than 0.4% 3/4" o.d. steel dowels will be required at all expansion joints.
  - The private engineer during this project is responsible for the accuracy and acceptability of the work proposed. The owner and contractor are responsible during construction. The private engineer shall be responsible for coordinating an acceptable solution and securing the plans for approval by the City.

- CONSTRUCTION NOTES:**
- Construct 200' curb and gutter per Riverside City Std. No. 200 & Note #7
  - Construct 18" P.C.C. curb sidewalk per Riverside City Std. No. 325.
  - Construct 4" AC pavement over 5" DC or 6" AC over compacted native.
  - Construct variable AC overlay.
  - Construct wheel chair ramps per ADA standard 304.

APPROVED BY: <i>Albert A. Webb</i> Chief Utilities Engineer, Water Date: 3-24-77	APPROVED BY: <i>John P. Rubin</i> Public Utilities Elect. Date: 3-11-77
ALBERT A. WEBB ASSOCIATES CIVIL ENGINEERS RIVERSIDE, CALIFORNIA	
APPROVED BY: <i>Robert L. Bell</i> R.E. No. 7876 DATE: 3/2/76	
W.D. 76-144 FOR	DESIGNED BY: L.D. DRAWN BY: R.P. CHECKED BY: J.S.

CITY OF RIVERSIDE, CALIFORNIA PUBLIC WORKS DEPARTMENT		STREET PLAN & PROFILE - INDIANA AVENUE 320' ELY. OF ERIE DRIVE to 420' WLY. OF POLK ST. for R-59-756		ACCOUNT NO. 76-144 DRAWING NUMBER R-1885 SHEET 1 OF 2 NO. 76-144
APPROVED BY: <i>John P. Rubin</i> DIRECTOR OF PUBLIC WORKS DATE: 3-13-77	BY: <i>R.P.</i> DATE: 3-13-77	DATE: 3-13-77	DATE: 3-13-77	DATE: 3-13-77
SCALE: HORIZ. 1"=40', VERT. 1"=4'				