

B.M. (N-7F)
 BRASS IN CONC. IN 8" I.P. CARRIED AT
 INTERSECTION OF W. HIGH ST. AND
 E. PENNSYLVANIA AVE. C.R.F.B. 735/40
 EL. 909.655

T.B.M. (THIS PROJECT ONLY)
 P.K. NAIL M.C.C. N.E. CURB RET. PRINCE
 ALBERT & SEDGWICK. U.T.O. FB. 1103/118
 EL. 938.70

GENERAL NOTES:

1. It shall be the responsibility of the Contractor to clear the right of way in accordance with the provisions of law as it affects each utility, including irrigation lines and appurtenances and at no cost to the City.
2. Construction shall be in accordance with the City of Riverside, Department of Public Works, Standard Drawings and Standard Specifications for Public Works Construction, 1973 Edition.
3. Trim edge of existing pavement as shown on Plans to a smooth straight line. Construct overlay and match-up paving as shown on Plan and as directed in field to produce a smooth section. Engineer estimates overlay to be tons.
4. Prime coat, seal coat, and paint binder are required.
5. Curb and gutter shall be staked with 3.0-foot offsets at 25-foot intervals and all flagged elevations shown on Plans shall have 3-foot offsets.
6. Construct driveway approaches per Standard 302. -Exact-number, -size, and -location-to-be-determined-by-Owner-as-approved-by-the-City-of-Riverside, -Traffic-Engineer-

NOTICE TO CONTRACTOR: The existence and location of any underground utility pipes or structures shown on these Plans were obtained by a search of the available records. To the best of our knowledge there are no existing utilities except as shown on these Plans. The Contractor is required to take due precautionary measures to protect the utility lines shown and any other lines not of record or not shown on these Plans.

7. The subdivider shall arrange for a soil test to be made by a Soils Engineer after the streets have been prepared to rough grade. Depth of base material and A.C. paving shall be determined by the City of Riverside design standards and test procedures.

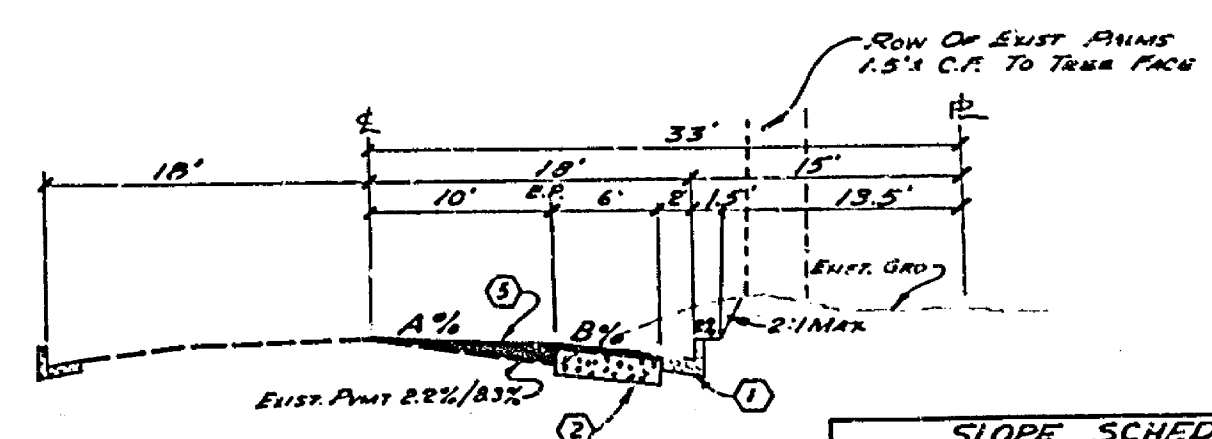
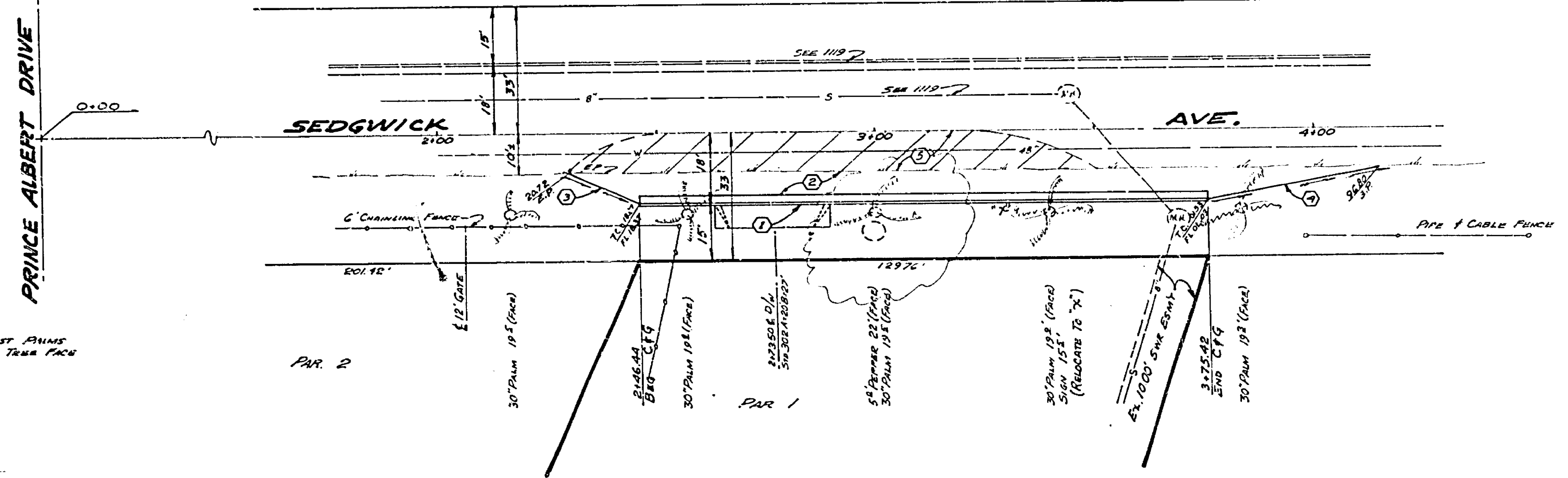

TYPICAL SECT.
 SEDGWICK AVE.
 T.L. +5.0

STATION	A%	B%	REMARKS
2+50	1%	2.67%	OVERLAY TO E
+75	2%	3%	"
3+00	2%	4.5%	"
+25	2%	4.33%	"
+50	0.9%	4.00%	"
+75	(2.7%)	2.03%	JOIN E.P.

- LEGEND
1. CONST. C&G FOR STD. 800 W/6" C.F.
 2. CONST. 2 1/2" A.C. OVER "D.G. OR "A.C. OVER COMPACTED NATIVE
 3. CONST. 2 1/2" FLARE & GRADE 20' TO PROVIDE DRAINAGE
 4. CONST. 5 1/2" FLARE WITH 3 TYPE 'L' REFLECTORS @ 20' C-C AND GRADE 50' TO DRAIN.
 5. OVERLAY EXIST. PAVT. PER TYP. SECTION AND SCHEDULE AT LEFT.

J. F. DAVIDSON ASSOCIATES
 CIVIL ENGINEERS - SURVEYORS - PLANNERS
 RIVERSIDE, CALIFORNIA
 APPROVED BY: *[Signature]* DATE: 6-11-76
 R.E. No. 13683/11

NO.	REVISIONS	DATE

CITY OF RIVERSIDE, CALIFORNIA
 DEPARTMENT OF PUBLIC WORKS
 APPROVED BY: *[Signature]* DATE: 9-23-76
 DIRECTOR OF PUBLIC WORKS

STREET PLAN & PROFILE
SEDGWICK AVE.
 WEST SIDE
 240' TO 380' SLY OF
 PRINCE ALBERT DRIVE
 R.M. 266

INDEXED PROJECT NO. R-1900
 SHEET 1 OF 1
 FILE NO. 55012

HORIZ. SCALE: 1" = 20'
 VERT. SCALE: 1" = 4'

W.O. 4693 FOR SAM - ROSTRONG F.B. 11/2/76

DESIGNED BY: *[Signature]* DRAWN BY: *[Signature]* CHECKED BY: *[Signature]*