

PROFILE
SCALE: VERT. 1" = 40'
PLAN
SCALE: 1" = 40'

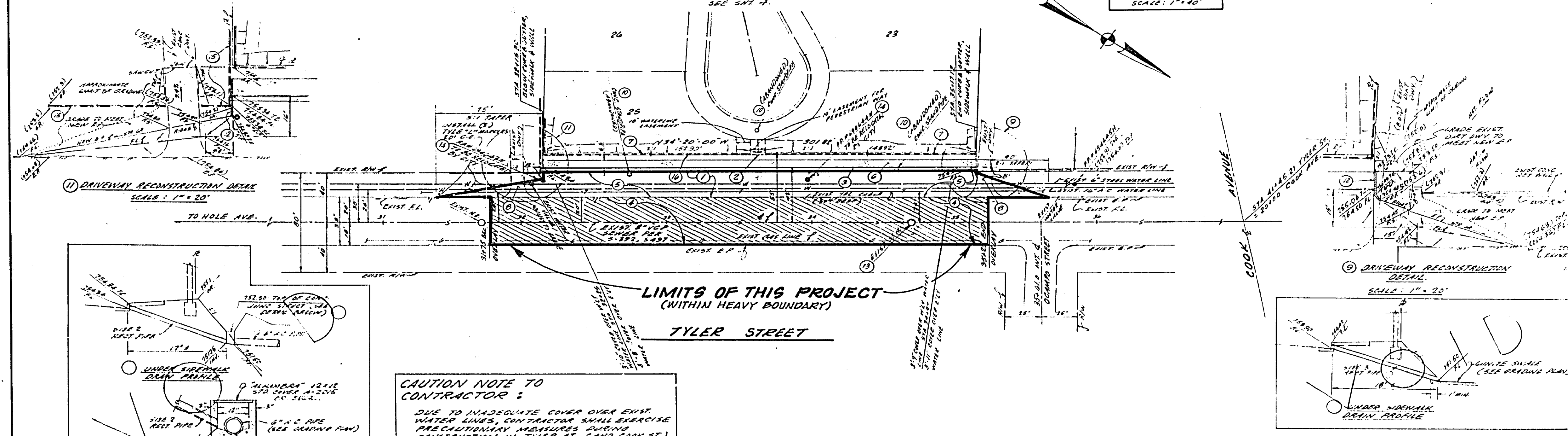

- CONSTRUCTION NOTES**
- 1 - PAVING & RISE BY CITY, GRADING, CLEARING, ETC. BY DEVELOPER.
 - 2 - INSTALL 12\"/>
 - 3 - CONSTRUCT DRIVEWAY RECONSTRUCTION DETAIL.
 - 4 - OVERLAY AND FEATHER OVER EXIST. A.C. PAVEMENT BY CITY PER TYPICAL SECTION, 1/2\"/>
 - 5 - CONST. A.C. PAVEMENT PER TYPICAL SECTION.
 - 6 - CONST. CONC. DRIVEWAY PER TYPICAL SECTION.
 - 7 - CONST. 3\"/>
 - 8 - REMOVE EXISTING DRIVEWAY RECONSTRUCTION DETAIL.
 - 9 - REMOVE EXISTING DRIVEWAY RECONSTRUCTION DETAIL.
 - 10 - ADJUST TO FINISHED GRADE.
 - 11 - EXISTING DRIVEWAY RECONSTRUCTION DETAIL TO BE RECONSTRUCTED BY CITY.
 - 12 - EXISTING DRIVEWAY RECONSTRUCTION DETAIL TO BE RECONSTRUCTED BY CITY.

CAUTION NOTE TO CONTRACTOR:
DUE TO INADEQUATE COVER OVER EXIST. WATER LINES, CONTRACTOR SHALL EXERCISE PRECAUTIONARY MEASURES DURING CONSTRUCTION IN TYLER ST. (AND COOK ST.) TO PROTECT THEM FROM DAMAGE.

PLANNING DEPT. APPROVED BY: J. CURTIS DATE: 5-23-78		PUBLIC UTILITIES DEPT. PER. DIV. DATE WELLS AVE. 9/17/77 TYLER ST. 9/17/77		BENCH MARK 1/4\"/>		C.E.L.S. Corporation 4570 Campus Drive, Suite 3 Newport Beach, California 92680 APPROVED BY: [Signature] DATE: 9/17/77 R.E. No. 21926		CITY OF RIVERSIDE, CALIFORNIA PUBLIC WORKS DEPARTMENT APPROVED BY: [Signature] DATE: 1/4/78		TYLER STREET PAVEMENT PARTICIPATION WITH TRACT 7689 1000' SOUTHEASTERLY OF COOK AVENUE TO OCAMPO STREET SHEET 1 OF 1	
--	--	--	--	------------------------------	--	---	--	--	--	---	--

ADAPTED FROM PLAN R-1981