

THE PRIVATE ENGINEER SIGNING THESE PLANS IS RESPONSIBLE FOR THE ACCURACY AND ACCEPTABILITY OF THE WORK HEREON. IN THE EVENT OF DISCREPANCIES ARISING DURING CONSTRUCTION THE PRIVATE ENGINEER SIGNING THE PLANS SHALL BE RESPONSIBLE FOR DETERMINING AN ACCEPTABLE SOLUTION AND REVISING THE PLANS FOR APPROVAL BY THE CITY.

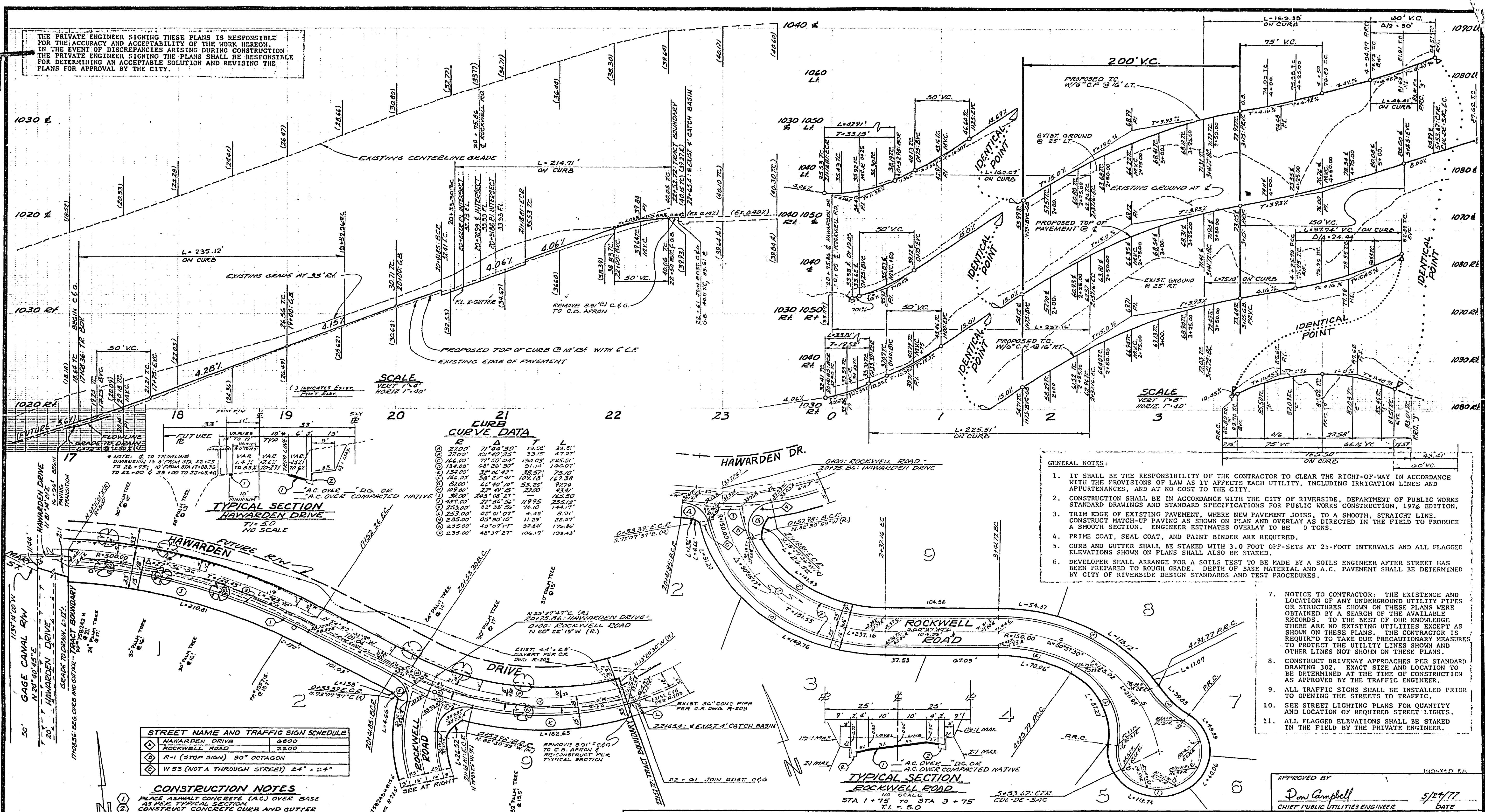

SCALE
VERT. 1" = 4'
HORIZ. 1" = 40'

SCALE
VERT. 1" = 4'
HORIZ. 1" = 40'

CURVE DATA

R	Δ	T	L
2700'	71°04'30"	19.56'	33.81'
2700'	101°40'25"	33.15'	47.31'
144.00'	71°50'04"	134.03'	225.51'
134.00'	68°20'30"	91.14'	160.07'
142.00'	28°04'48"	38.57'	75.10'
8100'	27°14'40"	109.18'	181.58'
8100'	46°40'10"	55.25'	97.74'
192.00'	27°49'55"	22.00'	43.34'
8100'	28°18'21"	165.50'	283.52'
47.00'	71°56'52"	19.95'	35.12'
253.00'	82°38'58"	74.10'	144.17'
253.00'	82°01'07"	4.45'	8.91'
235.00'	05°30'10"	11.29'	22.57'
235.00'	43°07'17"	32.46'	176.82'
235.00'	48°37'27"	106.17'	193.43'

STREET NAME AND TRAFFIC SIGN SCHEDULE

HAWARDEN DRIVE	3200
ROCKWELL ROAD	2200
R-1 (STOP SIGN) 30" OCTAGON	
W 53 (NOT A THROUGH STREET) 24" x 24"	

CONSTRUCTION NOTES

- PLACE ASPHALT CONCRETE (A.C.) OVER BASE AS PER TYPICAL SECTION.
- CONSTRUCT CONCRETE CURB AND GUTTER TYPE "B" WITH 6" CURB FACE PER RIVERSIDE CITY STANDARD NO. 200.
- CONSTRUCT CONCRETE CROSS GUTTER PER RIVERSIDE CITY STANDARD NO. 220.
- CONSTRUCT 18" CONC. CHAMBER DEPRESSION PER RIVERSIDE CITY STANDARD NO. 300.
- TO BE RELOCATED BY OTHERS.
- TO BE REMOVED.
- INSTALL NO PARKING SIGNS ON STREET LIGHT POSTS ON ROCKWELL ROAD. SEE STREET LIGHT PLAN FOR LOCATION.

BENCH MARK
FD SPIRE AND LEAD IN N.E. END OF SW/4 CORNER OF WASHINGTON STREET AND GAGE CANAL. PRECISE BM FG-7 PER C.I.E. PRECISE DATUM 442 FB 846/21 EL. = 1010.553

GENERAL NOTES:

- IT SHALL BE THE RESPONSIBILITY OF THE CONTRACTOR TO CLEAR THE RIGHT-OF-WAY IN ACCORDANCE WITH THE PROVISIONS OF LAW AS IT AFFECTS EACH UTILITY, INCLUDING IRRIGATION LINES AND APURTENANCES, AND AT NO COST TO THE CITY.
- CONSTRUCTION SHALL BE IN ACCORDANCE WITH THE CITY OF RIVERSIDE, DEPARTMENT OF PUBLIC WORKS STANDARD DRAWINGS AND STANDARD SPECIFICATIONS FOR PUBLIC WORKS CONSTRUCTION, 1976 EDITION.
- TRIM EDGE OF EXISTING PAVEMENT, WHERE NEW PAVEMENT JOINS, TO A SMOOTH, STRAIGHT LINE TO PRODUCE A SMOOTH SECTION. ENGINEER ESTIMATES OVERLAY TO BE 0 TONS.
- PRIME COAT, SEAL COAT, AND PAINT BINDER ARE REQUIRED.
- CURB AND GUTTER SHALL BE STAKED WITH 3.0 FOOT OFF-SETS AT 25-FOOT INTERVALS AND ALL FLAGGED ELEVATIONS SHOWN ON PLANS SHALL ALSO BE STAKED.
- DEVELOPER SHALL ARRANGE FOR A SOILS TEST TO BE MADE BY A SOILS ENGINEER AFTER STREET HAS BEEN PREPARED TO ROUGH GRADE. DEPTH OF BASE MATERIAL AND A.C. PAVEMENT SHALL BE DETERMINED BY CITY OF RIVERSIDE DESIGN STANDARDS AND TEST PROCEDURES.
- NOTICE TO CONTRACTOR: THE EXISTENCE AND LOCATION OF ANY UNDERGROUND UTILITY PIPES OR STRUCTURES SHOWN ON THESE PLANS WERE OBTAINED BY A SEARCH OF THE AVAILABLE RECORDS. TO THE BEST OF OUR KNOWLEDGE THERE ARE NO EXISTING UTILITIES EXCEPT AS SHOWN ON THESE PLANS. THE CONTRACTOR IS REQUIRED TO TAKE DUE PRECAUTIONARY MEASURES TO PROTECT THE UTILITY LINES SHOWN AND OTHER LINES NOT SHOWN ON THESE PLANS.
- CONSTRUCT DRIVEWAY APPROACHES PER STANDARD DRAWING 302. EXACT SIZE AND LOCATION TO BE DETERMINED AT THE TIME OF CONSTRUCTION AS APPROVED BY THE TRAFFIC ENGINEER.
- ALL TRAFFIC SIGNS SHALL BE INSTALLED PRIOR TO OPENING THE STREETS TO TRAFFIC.
- SEE STREET LIGHTING PLANS FOR QUANTITY AND LOCATION OF REQUIRED STREET LIGHTS.
- ALL FLAGGED ELEVATIONS SHALL BE STAKED IN THE FIELD BY THE PRIVATE ENGINEER.

J. F. DAVIDSON ASSOCIATES
CIVIL ENGINEERS - SURVEYORS - PLANNERS
RIVERSIDE, CALIFORNIA
APPROVED BY: *John W. Warty* DATE: 1/14/77
R.E. No. 17550

CITY OF RIVERSIDE, CALIFORNIA
DEPARTMENT OF PUBLIC WORKS
APPROVED BY: *Paul Campbell* DATE: 5/24/77
PRINCIPAL ENGINEER
TRAFFIC DIVISION
DATE: 7-14-77

STREET PLAN AND PROFILE
TRACT NO. 8116-1
HAWARDEN DRIVE
200' x 250' x 250' x 250'
ROCKWELL ROAD
SHEET 1 OF 1
FILE NO. 5510