

**BENCH MARK**  
 (GRAMERCY RESET) PK. NAIL &  
 CR. TAG IN MOST W'LY CURB  
 RETURN OF GRAMERCY AND LA  
 SIERRA AVE. C.R.A.B. 985/37  
 ELEV. 740.706'

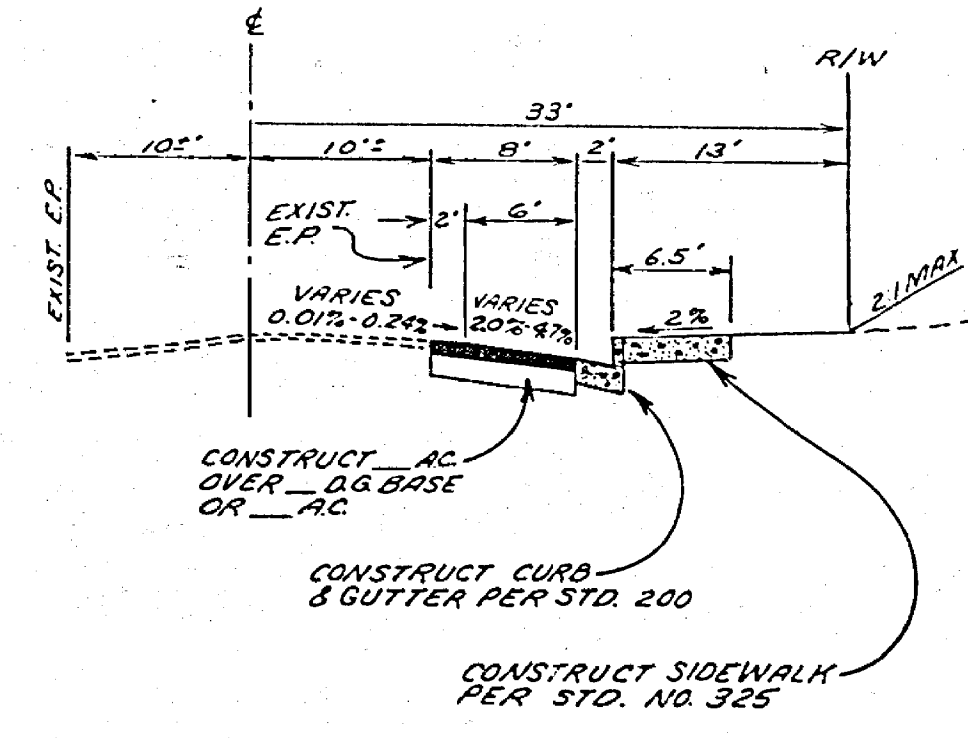
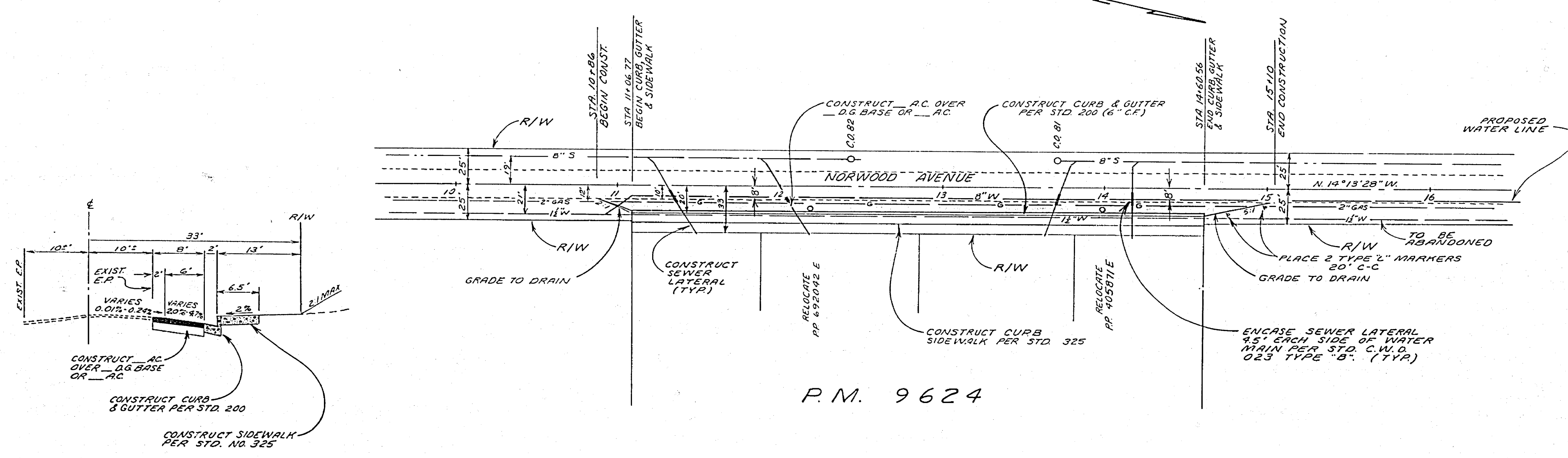

- GENERAL NOTES**
- IT SHALL BE THE RESPONSIBILITY OF THE CONTRACTOR TO CLEAR THE RIGHT OF WAY IN ACCORDANCE WITH THE PROVISIONS OF LAW AS IT AFFECTS EACH UTILITY INCLUDING IRRIGATION LINES AND APPURTENANCES AND AT NO COST TO THE CITY.
  - CONSTRUCTION SHALL BE IN ACCORDANCE WITH THE CITY OF RIVERSIDE DEPT. OF PUBLIC WORKS STANDARD DRAWINGS, AND THE STANDARD SPECIFICATIONS FOR PUBLIC WORKS CONSTRUCTION, 1976 EDITION.
  - TRIM EDGE OF EXISTING PAVEMENT WHERE NEW PAVEMENT JOINS TO A SMOOTH, STRAIGHT LINE. CONSTRUCT MATCH-UP PAVING AS SHOWN ON PLAN AND OVERLAY PAVING AS DIRECTED IN THE FIELD TO PRODUCE A SMOOTH SECTION. ENGINEER ESTIMATES OVERLAY TO BE 0.0 TONS.
  - CONSTRUCT DRIVEWAY APPROACH PER STD. DWG. 302. EXACT SIZE AND LOCATION TO BE DETERMINED AT THE TIME OF CONSTRUCTION AS APPROVED BY THE TRAFFIC ENGINEER.
  - CURB AND GUTTER SHALL BE STAKED WITH 3' OFFSETS AT 25' INTERVALS.
  - ALL FLAGGED ELEVATIONS SHALL BE STAKED IN THE FIELD BY THE PRIVATE ENGINEER.
  - THE PRIVATE ENGINEER SIGNING THESE PLANS IS RESPONSIBLE FOR ASSURING THE ACCURACY AND ACCEPTABILITY OF THE WORK HEREON. IN THE EVENT OF DISCREPANCIES ARISING DURING CONSTRUCTION AS A RESULT OF ERRORS OR OMISSIONS, THE PRIVATE ENGINEER SHALL BE RESPONSIBLE FOR DETERMINING AN ACCEPTABLE SOLUTION AND REVISING THE PLANS FOR APPROVAL BY THE CITY.

**NORWOOD AVE**  
 T.I. - 6  
**TYPICAL SECTION**  
 NO SCALE

CITY OF RIVERSIDE DOMESTIC WATER SYSTEM APPROVED BY: <i>[Signature]</i> DATE: 10-24-77 CHIEF UTILITIES ENGINEER WATER DATE		APPROVED BY: <i>[Signature]</i> DATE: 10-19-77 CHIEF UTILITIES ENGR-ELECTRIC		LYNN A. TERRY & ASSOCIATES CIVIL ENGINEERING CORONA-NORCO, CALIFORNIA APPROVED BY: <i>[Signature]</i> DATE: 7/1/77 R.E. NO. 19640 W.D. 77381 FOR BOB SMITH CONTRACTOR		CITY OF RIVERSIDE, CALIFORNIA DEPARTMENT OF PUBLIC WORKS APPROVED BY: <i>[Signature]</i> DATE: 12/16/77 CHIEF P.W. ENGR.		INTER. R.A. PLAN & PROFILE STREET IMPROVEMENTS <b>NORWOOD AVE.</b> EASTERLY SIDE STA. 11+06.77 TO STA. 14+60.56 P.M. 9624		PROJECT NO. <b>R-2019</b> SHEET 1 OF 1	
---	--	---	--	--	--	---	--	---	--	--	--

