

TYPICAL SECTION
NO SCALE
MAGNOLIA AVENUE

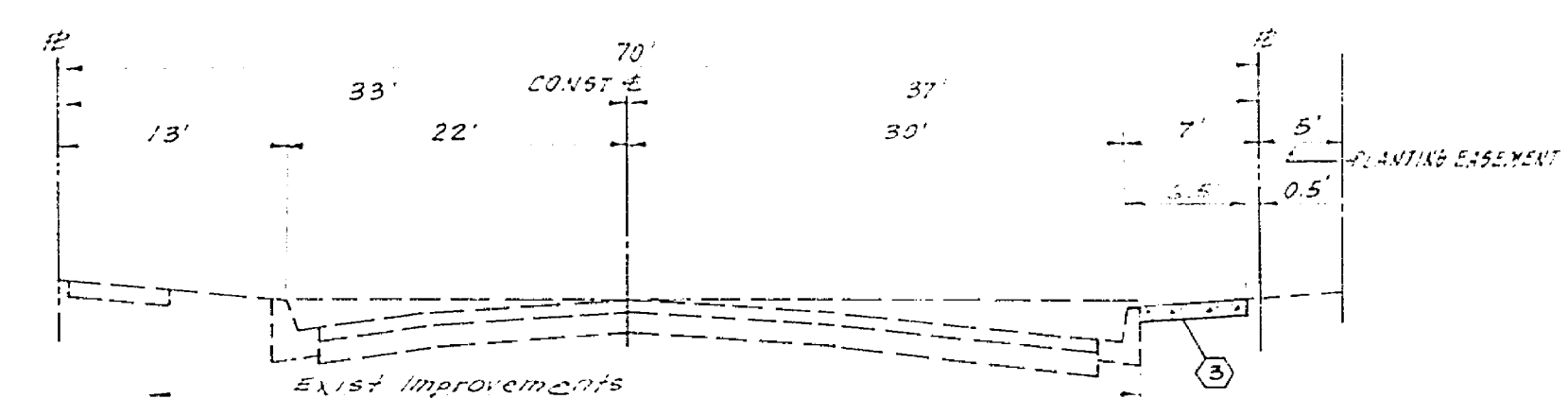

TYPICAL SECTION
NO SCALE
HUGHES ALLEY

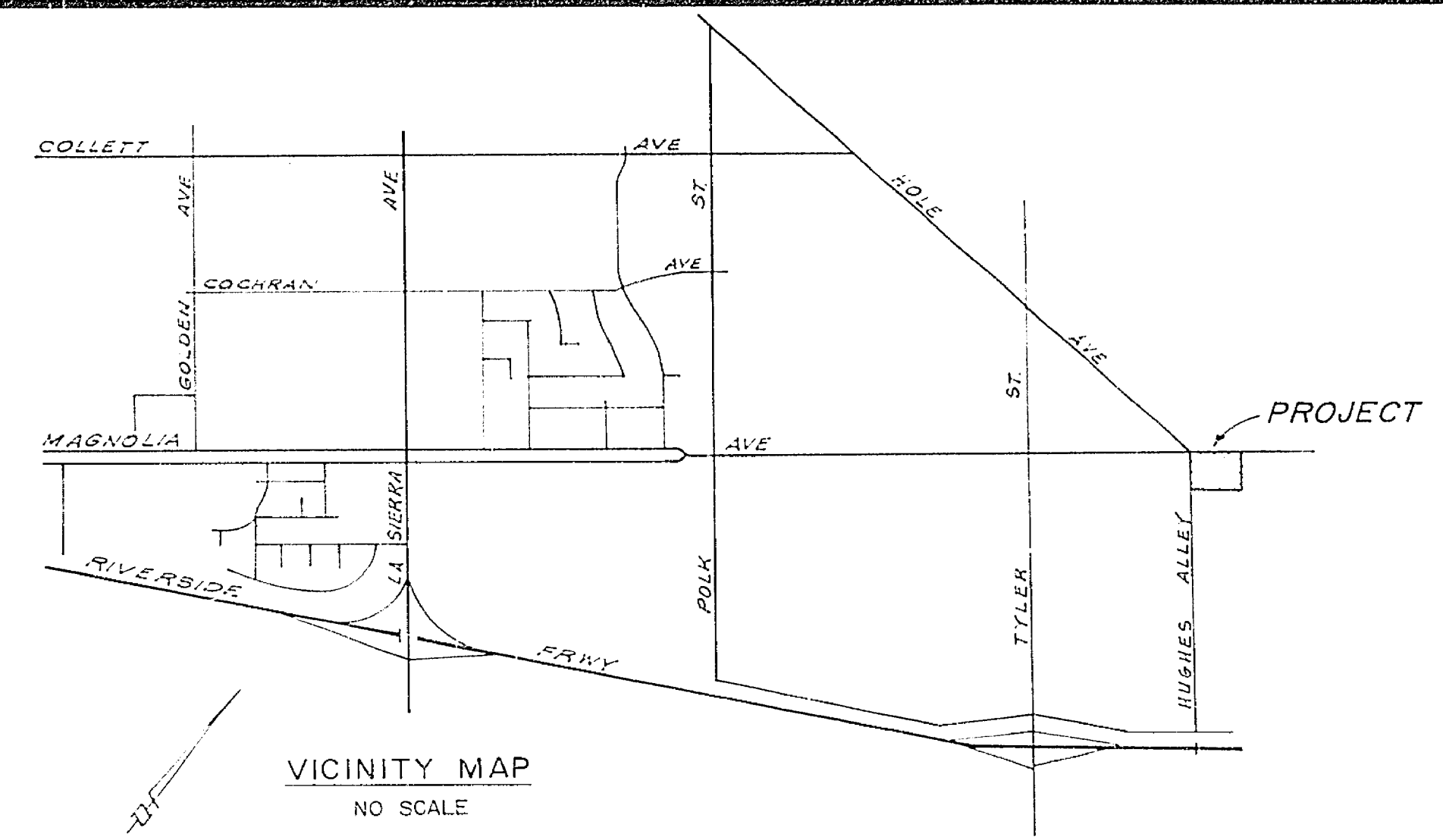

VICINITY MAP
NO SCALE

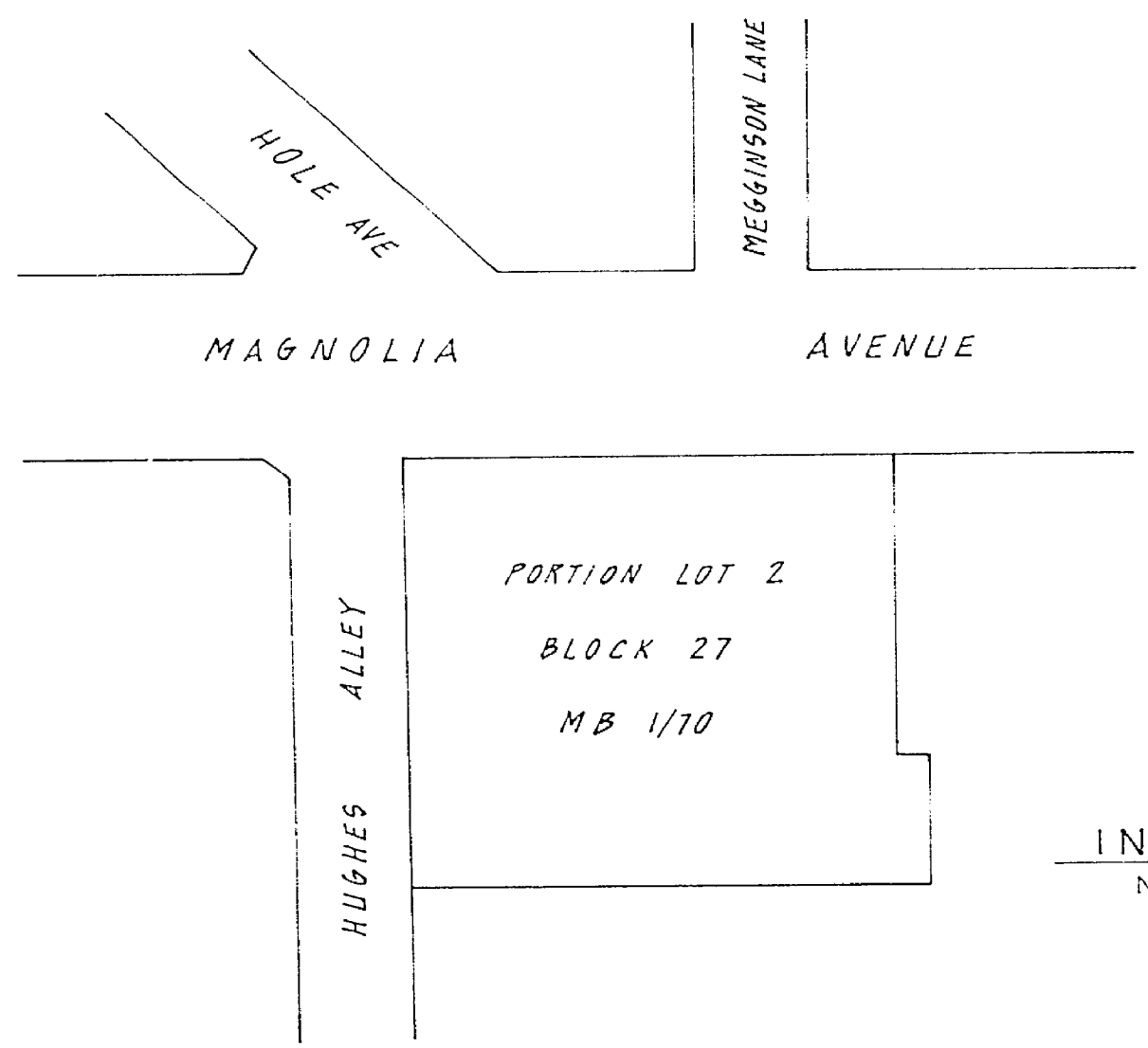

INDEX MAP
NO SCALE

GENERAL NOTES

- CONSTRUCTION SHALL BE IN ACCORDANCE WITH THE STANDARD SPECIFICATIONS FOR PUBLIC WORKS CONSTRUCTION, 1972 EDITION, AND PER CITY OF RIVERSIDE STANDARD DRAWINGS.
- ALL FINISHED ELEVATIONS SHALL BE STAKED IN THE FIELD BY THE ENGINEER.
- THE SUPERVISOR SHALL ARRANGE FOR A SOIL TEST TO BE MADE BY A SOIL ENGINEER AFTER THE STREETS HAVE BEEN IMPROVED TO ROUGH GRADE. DEPTH OF BASE MATERIAL AND A.C. PAVING SHALL BE DETERMINED BY THE CITY OF RIVERSIDE DESIGN STANDARDS AND TEST PROCEDURES.
- LOCATION OF DRIVEWAY APPROACHES (STD. N° 302) TO BE DETERMINED AT THE TIME OF CONSTRUCTION, AS APPROVED BY THE TRAFFIC ENGINEER.
- TRAFFIC CONTROL SIGNS MUST BE IN PLACE PRIOR TO OPENING STREETS TO TRAFFIC.
- CONES WILL BE STAKED AT 5' OFFSET AND 25' INTERVALS, EXCEPT WHERE SHOWN OTHERWISE.
- IT SHALL BE THE RESPONSIBILITY OF THE CONTRACTOR TO CLEAR THE RIGHT OF WAY IN ACCORDANCE WITH THE PROVISIONS OF LAW AS IT AFFECTS EACH UTILITY INCLUDING IRRIIGATION LINES AND APPURTENANCES AND AT NO COST TO THE CITY.
- FROM EDGE OF EXISTING PAVEMENT WHERE NEW PAVEMENT JOINS TO A SMOOTH STRAIGHT LINE, CONTRACTOR MATCH UP PAVING AS SHOWN ON PLAN AND OVERLAY PAVING AS DIRECTED IN THE FIELD TO PRODUCE A SMOOTH SECTION.
- SEE "STREET LIGHTING PLAN" FOR QUANTITY AND LOCATION OF REQUIRED STREET LIGHTS.
- THE PRIVATE ENGINEER SIGNING THESE PLANS IS RESPONSIBLE FOR ASSURING THE ACCURACY AND ACCEPTABILITY OF THE WORK HEREON. IN THE EVENT OF DISCREPANCIES ARISING DURING CONSTRUCTION AS A RESULT OF ERRORS OR OMISSIONS, THE PRIVATE ENGINEER SHALL BE RESPONSIBLE FOR DETERMINING AN ACCEPTABLE SOLUTION AND REVISING THE PLANS FOR APPROVAL BY THE CITY.
- SEE PLAN X-313 FOR NOTES REGARDING TRAFFIC SIGNAL MODIFICATIONS.

CONSTRUCTION NOTES

- CONSTRUCT P.C.C. CURB AND GUTTER PER RIVERSIDE CITY STANDARD N° 208 (4" C.C.)
- CONSTRUCT 3 1/2" P.C.C. SIDEWALK PER RIVERSIDE CITY STANDARD N° 325 AND PLAN.
- CONSTRUCT 4" A.C. OVERLAY PER RIVERSIDE CITY STANDARD N° 302. SEE GENERAL NOTE 3.
- CONSTRUCT WHEEL CHAIR RAMP PER RIVERSIDE CITY STANDARD N° 304
- CONSTRUCT P.C.C. DRIVE APPROACH PER CITY OF RIVERSIDE STANDARD N° 302
- CONSTRUCT CATCH BASIN PER CITY OF RIVERSIDE STANDARD N° 405, W=4', V=4'
- CONSTRUCT J.S. N° 2 PER RCFCO STD. DNG. N° JS 227
- CONSTRUCT 18" RCP-2000 D
- CONSTRUCT VARIABLE THICKNESS A.C. OVERLAY
- REMOVE EXIST. CONC. CURB & GUTTER
- REMOVE EXIST. CONC. SIDE WALK
- REMOVE EXIST. CONC. DRIVE APPROACH
- CONST. BACK OF WALK PER RIVERSIDE CITY STD. N° 120.
- SEE PLAN X-313 FOR NOTES REGARDING TRAFFIC SIGNAL MODIFICATIONS

BENCH MARK

Bronze disk in conc. about 1.0 mile southwest along the Atchafon, Topeka and Santa Fe Railway from the station at Arlington, to the Tyler Street crossing, thence 0.6 mile northwest along Tyler Street to Magnolia Avenue, about 1.0 mile southwest along Magnolia Avenue from the Riverside Public Library, Arlington Branch, to the back of the sidewalk on the easterly corner of Magnolia Avenue and Tyler Street, 65.9 ft. southeast & Magnolia Ave., 52.0 ft. northeast & Tyler Street. A 5" disk in conc. post in A.C. parking lot of Gasoline Station.
ELEV. 742.243 (1970)

J.P. KAPP & ASSOCIATES, INC.
17742 IRVINE BOULEVARD SUITE 203
TUSTIN, CALIFORNIA 92680
(714) 838-0350
R.C.E. NO. 22015 DATE 5/31/77

DESIGNED BY	DRAWN BY	CHECKED BY

CITY OF RIVERSIDE, CALIFORNIA
DEPARTMENT OF PUBLIC WORKS
APPROVED BY: [Signature]
PRINCIPAL ENGINEER: [Signature]
TRAFFIC DIVISION: [Signature]
CHIEF P. W. ENGINEER: [Signature]

STREET PLAN & PROFILE
HUGHES ALLEY & MAGNOLIA AVENUE
12-70-767

PROJECT NO. R-2022
SHEET 1 OF 2
FILE NO.

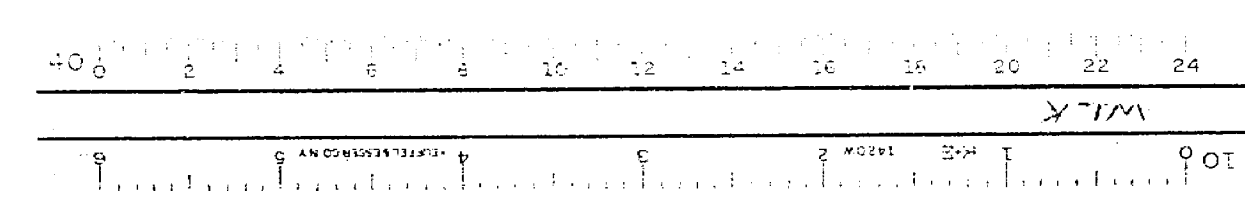

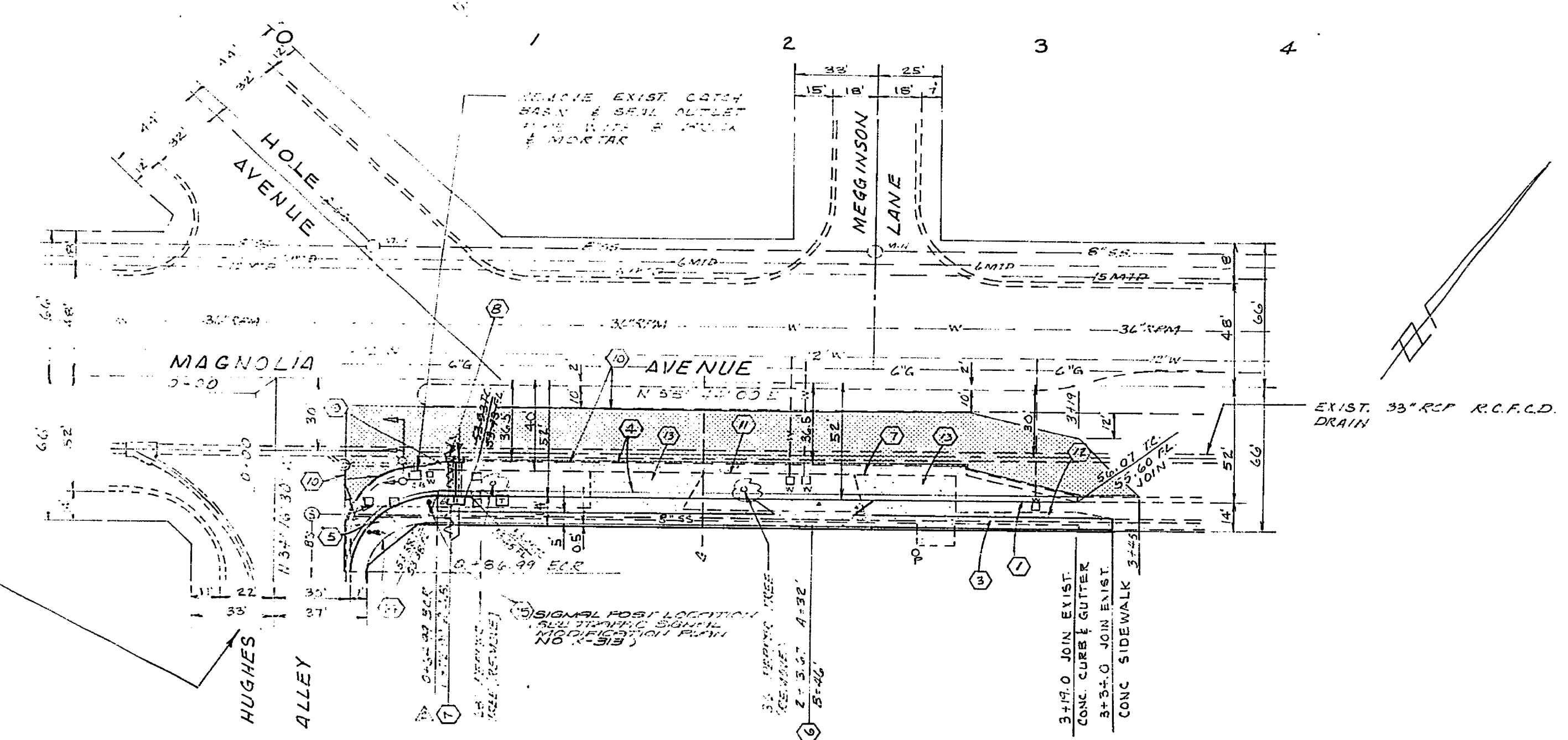
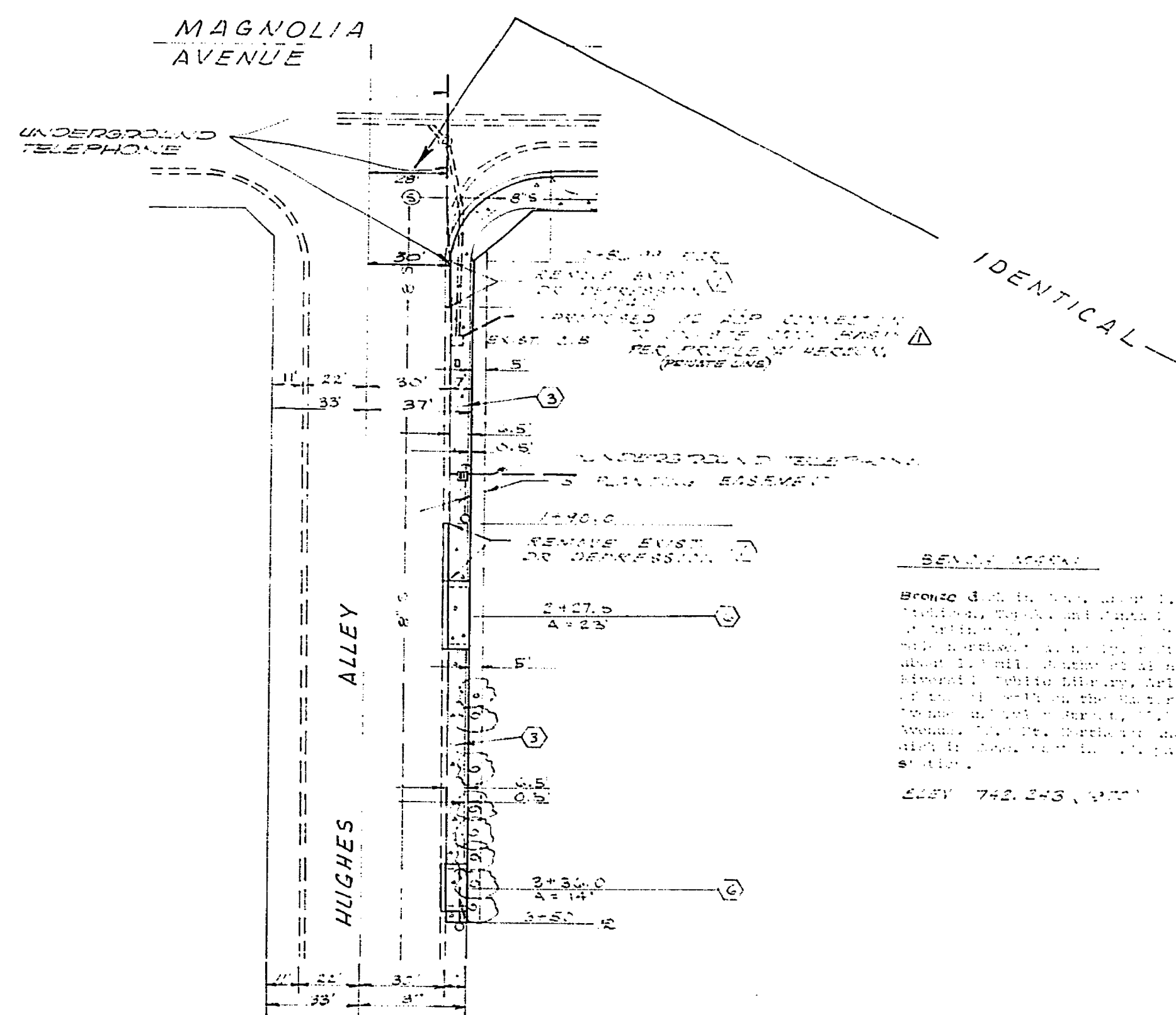
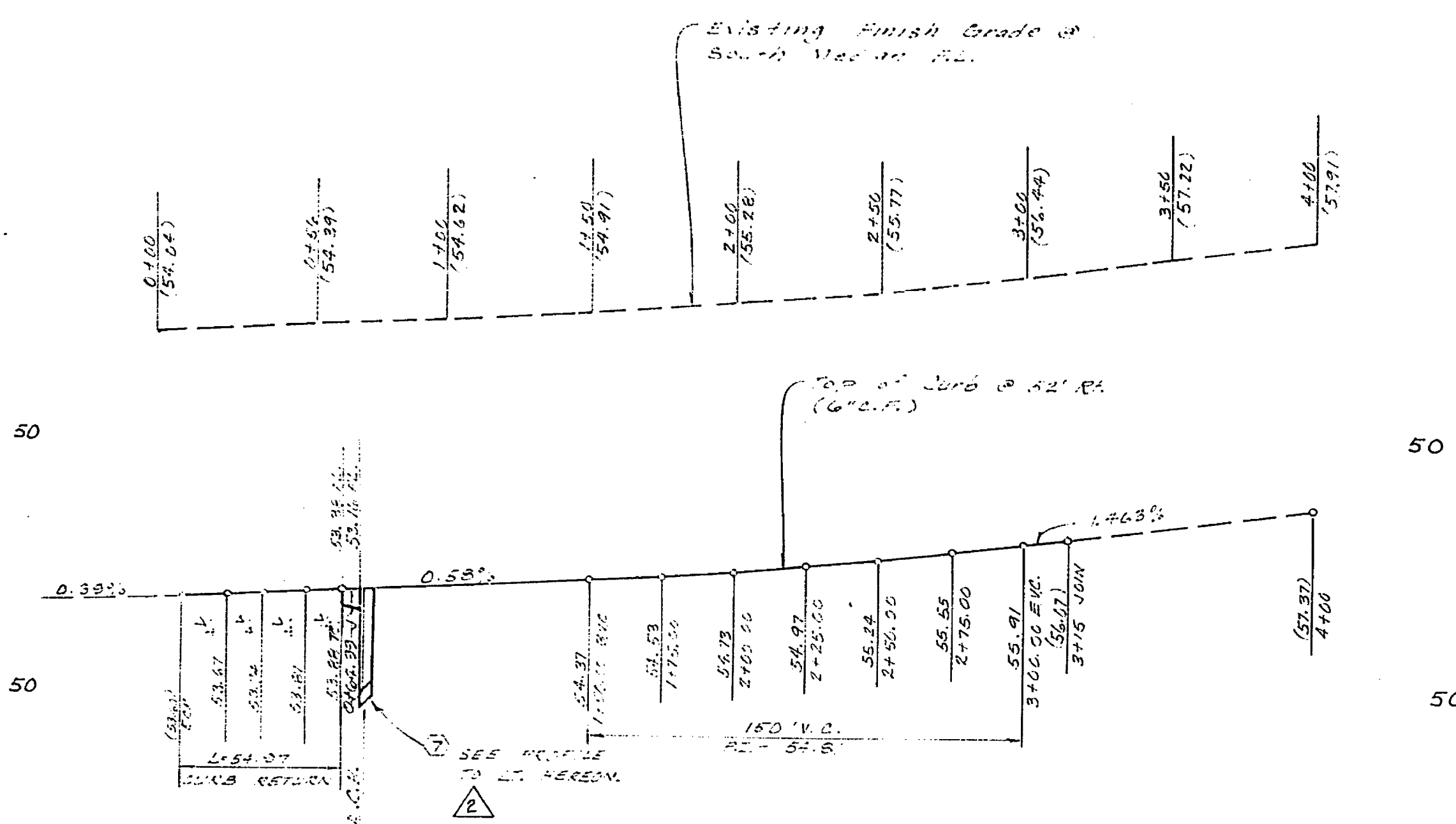
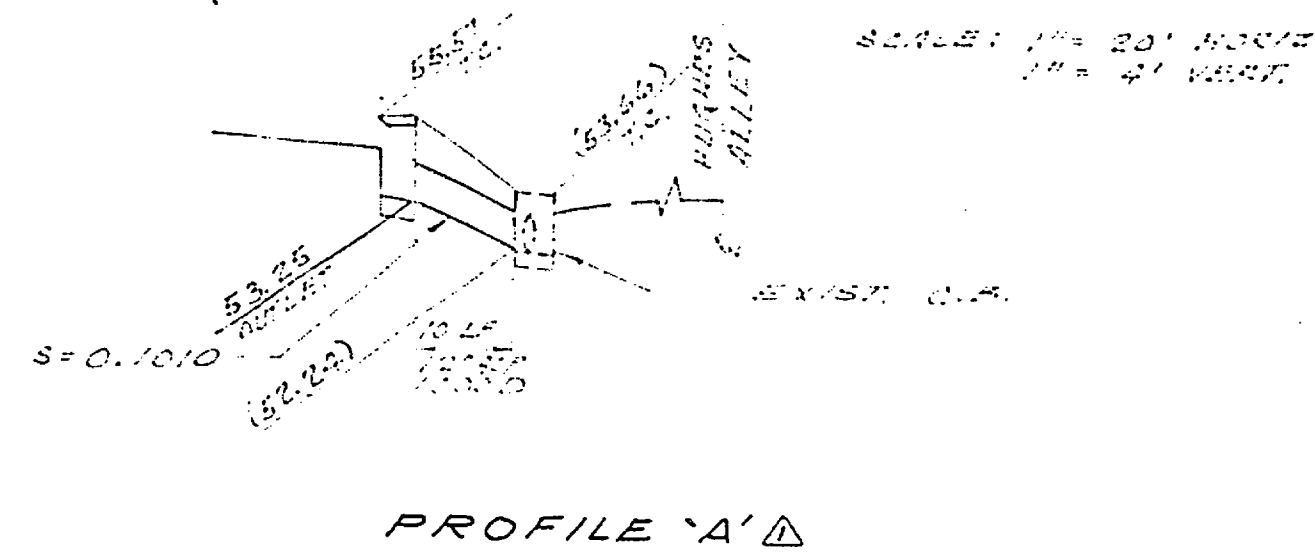
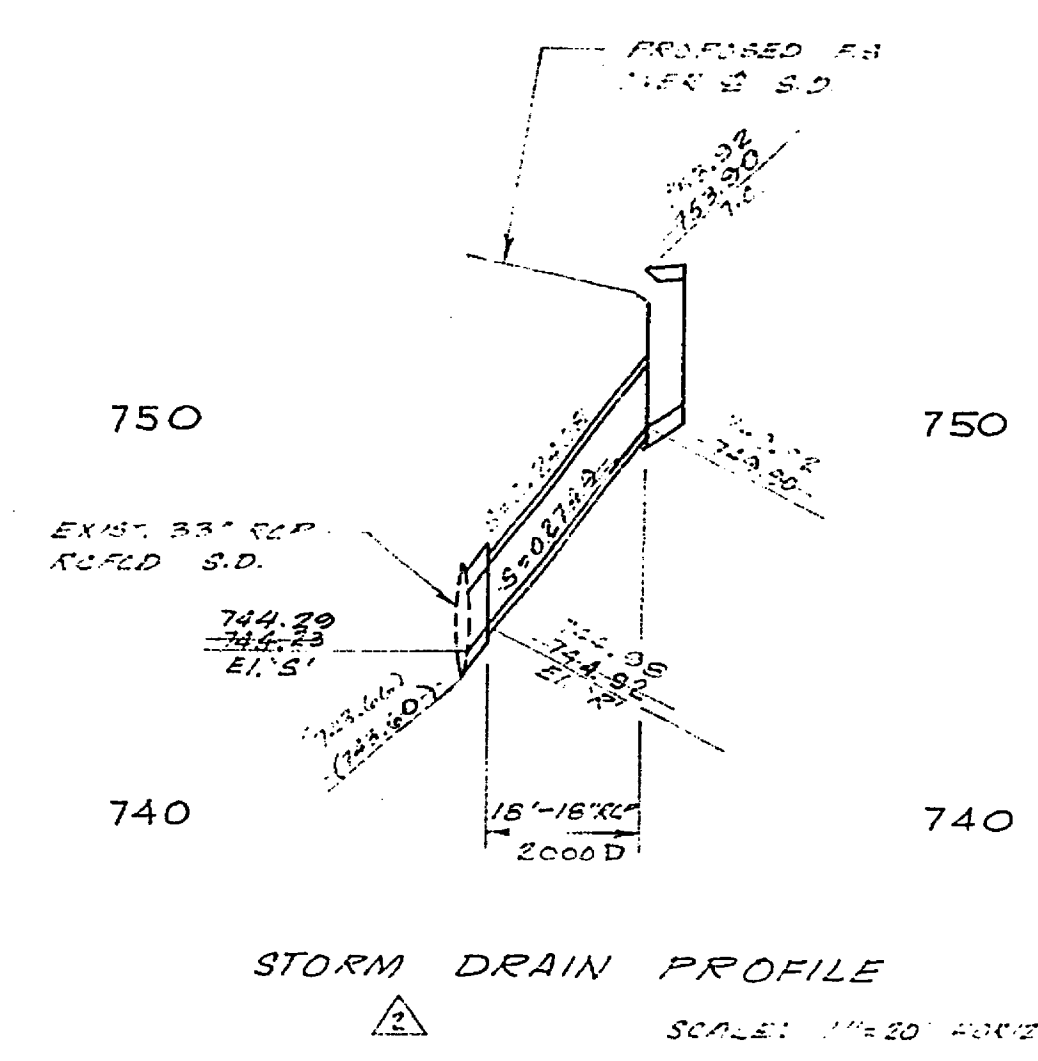

SEWER NOTES

Branch 4.0 to 4.5 ft. dia. pipe. 100' length. 12\"/>

4.5 = 89° 57' 30"

4.0 = 35.00'

4.5 = 54.97'

7 = 32.99'

SEE PLAN 742, 743, 744

CURB CURVE DATA

1 = 89° 57' 30"

2 = 35.00'

3 = 54.97'

4 = 32.99'

U.S. ROAD FOR R.C.F.C.D. STD. DWG. NO. 13-217

A = 90°

D = 18"

OD = 2'-6"

D = 18"

TR = 1'-11 1/2"

CF = 0'-8"

CF = 1'-2"

EL. S = 744.98

EL. S = 744.29

18 LF. - 18" RCP 2000 D

DESIGNED BY: DRAWN BY: CHECKED BY:	REVISIONS:	APPROVED BY: DATE:	CITY OF RIVERSIDE, CALIFORNIA DEPARTMENT OF PUBLIC WORKS		STREET PLAN AND PROFILE MAGNOLIA AVENUE AND HUGHES ALLEY R-70-767	PROJECT NO. R-2022
			APPROVED BY: DATE:			
HORIZ. SCALE: 1" = 40' VERT. SCALE: 1" = 4'			FILE NO.			

