

705 LT.

705 E

705 RT.

705 LT.

705 E

705 RT.

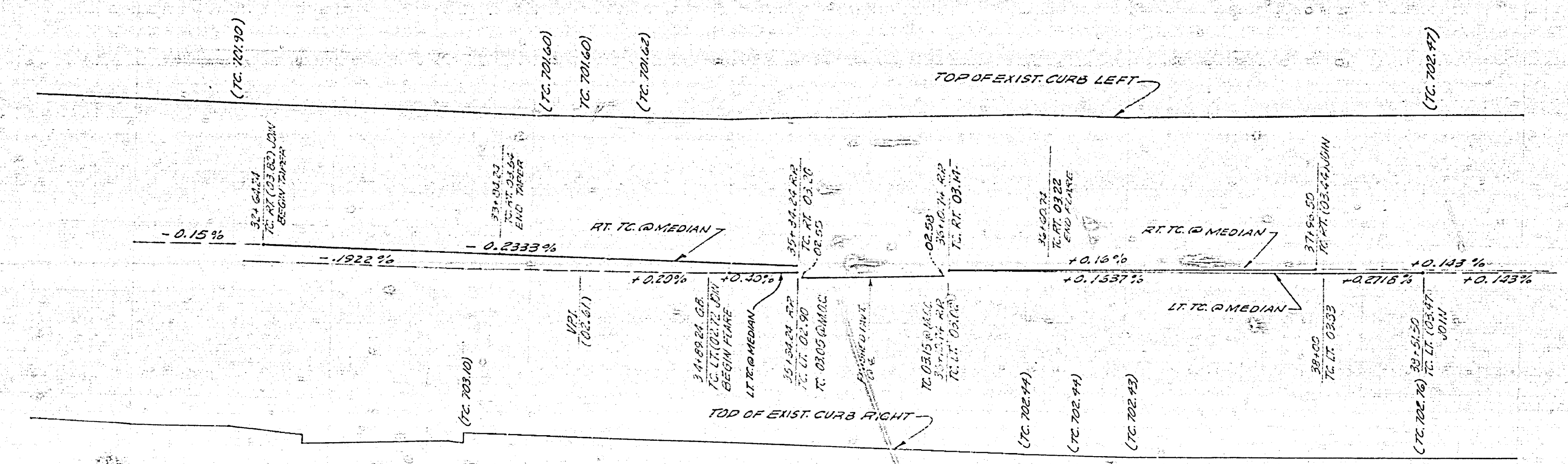

31 32 33 34 35 36 37 38 39

TRINITY CHRISTIAN CENTER

RANCHO LA SIERRA

LA SIERRA AVENUE

E COLLETT AVENUE

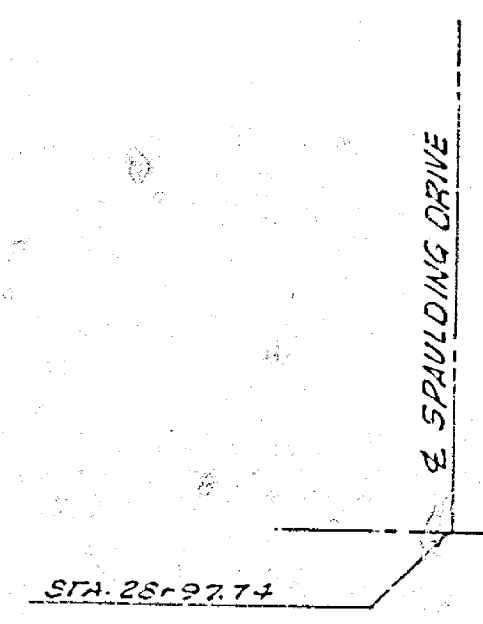

GENERAL NOTES

1. THE PRIVATE ENGINEER SIGNING THESE PLANS IS RESPONSIBLE FOR THE ACCURACY AND ACCEPTABILITY OF THE WORK HEREON. IN THE EVENT OF DISCREPANCIES ARISING DURING CONSTRUCTION THE PRIVATE ENGINEER SIGNING THESE PLANS SHALL BE RESPONSIBLE FOR DETERMINING AN ACCEPTABLE SOLUTION AND REVISIONS TO THE PLANS FOR APPROVAL BY THE CITY.
2. CONSTRUCTION SHALL BE IN ACCORDANCE WITH THE STANDARD SPECIFICATIONS FOR PUBLIC WORKS CONSTRUCTION 17% EDITION AND PER CITY OF RIVERSIDE STANDARD DRAWING.
3. ALL FLAGGED ELEVATIONS SHALL BE STAKED IN THE FIELD BY THE PRIVATE ENGINEER.
4. CURBS AND GUTTER TO BE STAKED AT 25' INTERVALS.
5. EXISTING TREES AND OR SPRINKLER SYSTEMS SHALL BE PLACED TO REQUIREMENTS OF THE PARKS AND RECREATION DEPT.
6. THE PARKS AND RECREATION DEPARTMENT SHALL BE CONSULTED 24 HOURS IN ADVANCE OF ANY CONSTRUCTION AT THIS SITE. PA 787-2593
7. ALL WATERS CUT TO SPRINKLER SYSTEM WILL HAVE TO BE SCOTCH COATED AFTER SPLICING.
8. REPLACE GROUND COVER WITH SAME ROOTED CUTTING 12" O.C.
9. EXISTING SIGNS SHALL BE REMOVED OR RELOCATED TO THE SATISFACTION OF THE TRAFFIC DEPARTMENT.

WITHIN THIS AREA 4 TREES SHALL BE RELOCATED OR REPLACED WITH NEW TREES. (MIN. 15 GAL.)
RELOCATE METER AND SPRINKLER SYSTEM TO EACH OF CURBS.

NOTE
SEE LANDSCAPING AND SPRINKLER SYSTEM PLAN PREPARED BY THOMAS R WEBB

- CONSTRUCTION NOTES**
1. REMOVE EXIST AC PAVEMENT
 2. REMOVE EXIST CURB & GUTTER
 3. CONST. CURB & GUTTER (6" GA) PER STD. NO. 200
 4. CONST. DRIVEWAY APPROACH PER STD. NO. 302
 5. RE-CONST. CURB & GUTTER PER STD. NO. 303
 6. CONST. SIDEWALK PER STD. NO. 305
 7. CONST. 6" AC (FULL DEPTH)
 8. CONST. TULEP PER STD. NO. 425
 9. INSTALL R/C (RT)

S.M. P.P. SPIKE IN RR # 24589J AT 36 COR LA SIERRA & COLLETT EL. 704.25 PER CITY FB. 975 PG. 5

HAWKINS, ROBERTSON & ASSOC.
ENGINEERS SURVEYORS
RIVERSIDE CALIFORNIA
APPROVED BY: *[Signature]* DATE: 7/23/17
R.E. No. 15016
W.O. 2425-A FOR TRINITY CHRISTIAN CENTER

CITY OF RIVERSIDE, CALIFORNIA
PUBLIC WORKS DEPARTMENT
APPROVED BY: *[Signature]* DATE: 9/26/17
PRINCIPAL ENGINEER
TRAFFIC DIVISION
CHIEF PUB. WORKS ENGR.

ISLAND OPENING RELOCATION
LA SIERRA AVENUE
FROM STA. 32+6.424 TO STA. 38+51.50

INDEXED & A
ACCOUNT NO.
DRAWING NUMBER
R-2042
SHEET 1 OF 1
2645-A

