

CURB RETURN DATA

| # | A' | B' | C' | D' |
|---|--------|-----------|--------|--------|
| 1 | 35.00' | 50'11.20' | 57.25' | 3.00' |
| 2 | 39.50' | 23'22.11" | 15.31' | 1.75' |
| 3 | 25.00' | 60'11.20' | 37.00' | 23.33' |

| # | A' | B' | C' | D' |
|---|--------|-----------|--------|--------|
| 1 | 35.00' | 50'11.20' | 57.25' | 3.00' |
| 2 | 39.50' | 23'22.11" | 15.31' | 1.75' |
| 3 | 25.00' | 60'11.20' | 37.00' | 23.33' |

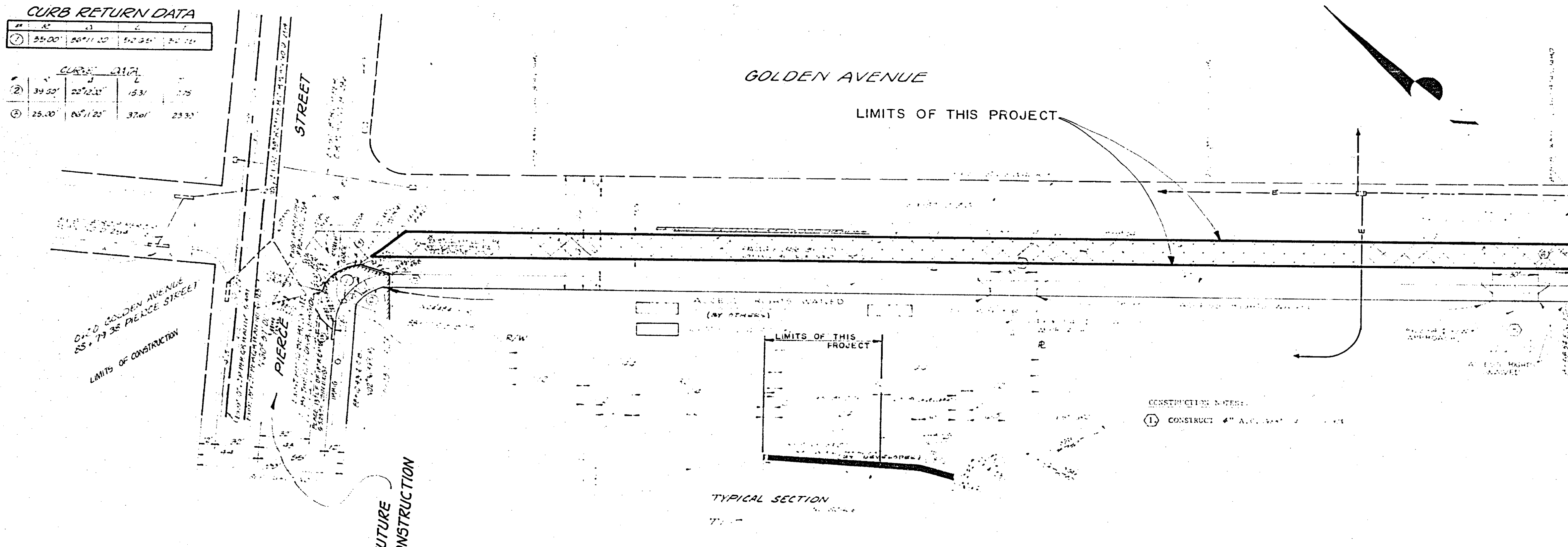

- GENERAL NOTES:**
1. IT SHALL BE THE RESPONSIBILITY OF THE CONTRACTOR TO CLEAR THE RIGHT OF WAY IN ACCORDANCE WITH THE PROVISIONS OF LAW AS IT AFFECTS EACH UTILITY INCLUDING TELEPHONE LINES, AND AT NO COST TO THE CITY.
 2. CONSTRUCTION SHALL BE IN ACCORDANCE WITH THE CITY OF RIVERSIDE, DEPARTMENT OF PUBLIC WORKS, STANDARD DRAWINGS AND SPECIFICATIONS FOR PUBLIC WORKS, CONSTRUCTION, 1976 EDITION.
 3. PRIME COAT, SEAL COAT, AND PAINT BINDER ARE REQUIRED.
 4. NOTIFY CONTRACTOR THE EXISTENCE AND LOCATION OF ANY UNDERGROUND UTILITY PIPES OR STRUCTURES SHOWN ON THESE PLANS WERE OBTAINED BY A SEARCH OF THE AVAILABLE RECORDS. TO THE BEST OF OUR KNOWLEDGE THERE ARE NO EXISTING UTILITIES EXCEPT AS SHOWN ON THESE PLANS. THE CONTRACTOR IS REQUIRED TO TAKE PRECAUTIONARY MEASURES TO PROTECT THE UTILITY LINES SHOWN AND ANY OTHER LINES, NOT OF RECORD OR NOT SHOWN ON THESE PLANS.

Contractor agrees that he shall assume sole and complete responsibility for job site conditions during the course of construction of this Project, including safety of all persons and property; that this requirement shall apply continuously and not be limited to normal working hours; and that the Contractor shall defend, indemnify and hold the Owner and the Engineer harmless from any and all liability, real or alleged, in connection with the performance of work on this Project, excepting for liability arising from the sole negligence of the Owner or the Engineer.

CROSS FALL CHART

| STA | DRIVING LANE RIGHT SIDE DROP | PARKING LANE RIGHT SIDE DROP |
|------|------------------------------|------------------------------|
| 1+00 | 15% | 3.0% |
| 1+25 | 15% | 3.0% |
| 1+50 | 15% | 2.8% |
| 1+75 | 15% | 4.2% |
| 2+00 | 15% | 4.6% |
| 2+25 | 15% | 4.0% |
| 2+50 | 15% | 4.8% |
| 2+75 | 15% | 5.2% |
| 3+00 | 15% | 5.8% |
| 3+25 | 15% | 5.8% |
| 3+50 | 15% | 4.5% |
| 3+75 | 15% | 4.5% |
| 4+00 | 15% | 4.3% |
| 4+25 | 15% | 4.7% |
| 4+50 | 15% | 5.8% |
| 4+75 | 15% | 4.7% |

TRM
 CHECKED IN ON SE CURB RETURN AT 1/2" SECTION OF 1/2" SCALE OF GOLDEN AVE. & PIERCE ST. SIDE W/ 1/2" SIDE ELEVATION = 21.485'

REVISION MARK
 PA. 1/2" SECTION OF CURB RETURN AT 1/2" SECTION OF 1/2" SCALE OF GOLDEN AVE. & PIERCE ST. SIDE W/ 1/2" SIDE ELEVATION = 21.485'

CITY OF RIVERSIDE
 PUBLIC UTILITIES
 ELECTRICAL DIVISION
 For: *[Signature]* 7-28-78
 Chief Electrical Engineer

PACIFIC TELEPHONE
 APPROVED BY: *[Signature]*
 PUBLIC IMPROVEMENT DIV.

J. F. DAVIDSON ASSOCIATES
 CIVIL ENGINEERS - SURVEYORS - PLANNERS
 RIVERSIDE, CALIFORNIA
 APPROVED BY: *[Signature]* DATE: 8-18
 I.R.E. No. 113 021

APPROVED BY: *[Signature]* DATE: 8-18
 PRINCIPAL ENGINEER
 PUBLIC DEPARTMENT
 TRAFFIC DIVISION
 CHIEF OF DIVISION
 DESIGNED BY: D.E. DRAWN BY: A.J.M. CHECKED BY: M.P.

CITY OF RIVERSIDE, CALIFORNIA
 DEPARTMENT OF PUBLIC WORKS
 APPROVED BY: *[Signature]* DATE: 8-18
 DIRECTOR OF PUBLIC WORKS

STREET PLAN & PROFILE
 GOLDEN AVENUE PAVING
 PARTICIPATION WITH R-84-778
 PIERCE STREET TO 860' S'LY
 HORIZ. SCALE: 1" = 40' VERT. SCALE: 1" = 4'
 PROJECT NO. 80-875-200
 R-2142 A
 SHEET 1 OF 1
 FILE NO. 5589

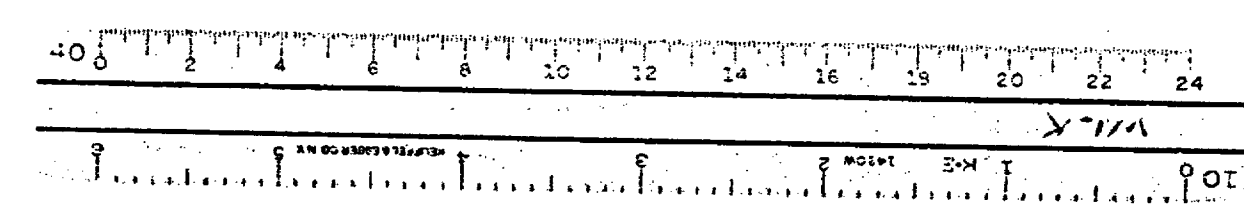

ADAPTED FROM PLAN R-2142