

NOTE:
THIS PROFILE TO BE
STAKED IN THE FIELD.

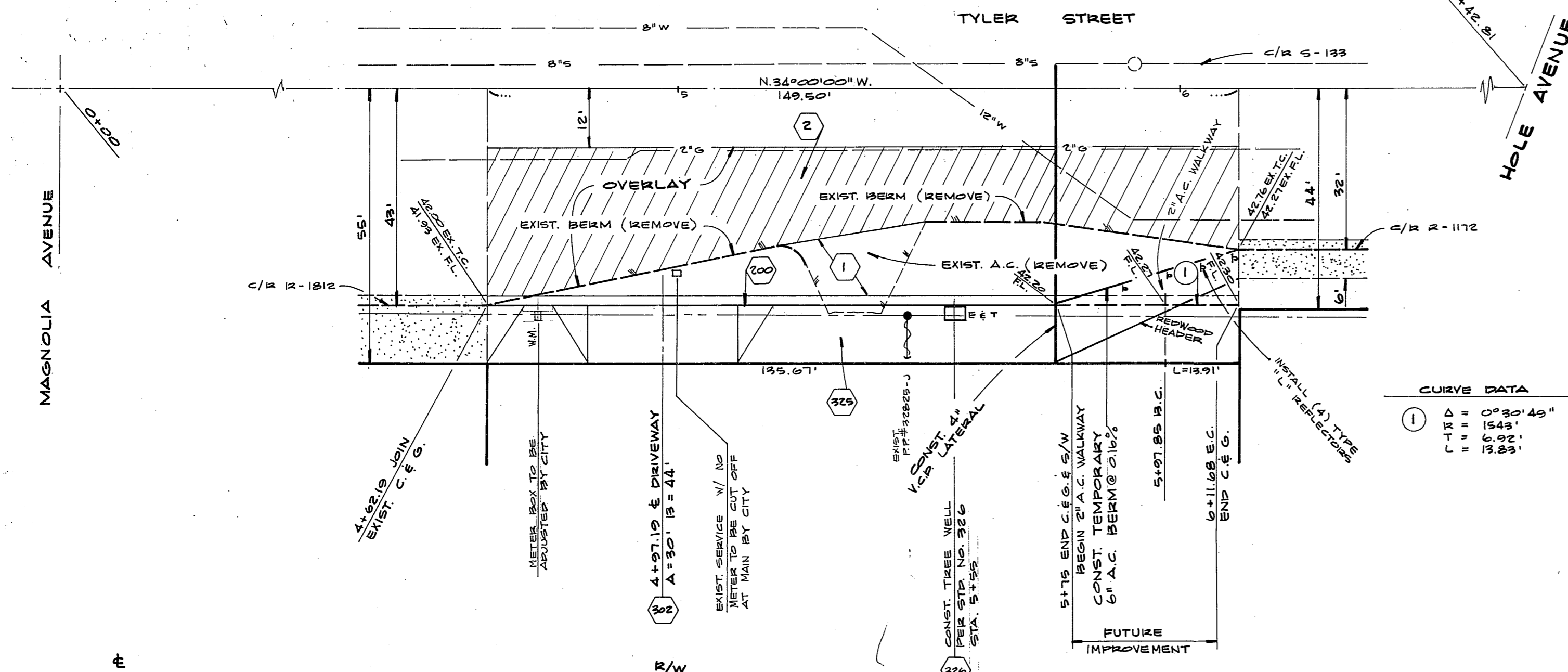

SCALE: HORIZ. 1" = 20'
VERT. 1" = 4'

CURVE DATA

1	Δ = 0° 30' 49"
	L = 154.9'
	E = 6.92'
	P = 13.83'

CONSTRUCTION NOTES

- IT SHALL BE THE RESPONSIBILITY OF THE CONTRACTOR TO CLEAR THE RIGHT OF WAY IN ACCORDANCE WITH THE PROVISIONS OF LAW AS IT AFFECTS EACH UTILITY INCLUDING IRRIGATION LINES AND APPURTENANCES AND AT NO COST TO THE CITY.
- CONSTRUCTION SHALL BE IN ACCORDANCE WITH THE CITY OF RIVERSIDE, DEPARTMENT OF PUBLIC WORKS, STANDARD DRAWINGS, AND THE STANDARD SPECIFICATIONS FOR PUBLIC WORKS CONSTRUCTION, 1976 EDITION.
- TRIM EDGE OF EXISTING PAVEMENT WHERE NEW PAVEMENT JOINS TO A SMOOTH, STRAIGHT LINE. CONSTRUCT MATCH-UP PAVING AS SHOWN ON PLAN AND OVERLAY PAVING AS DIRECTED IN THE FIELD TO PRODUCE A SMOOTH SECTION. ENGINEER ESTIMATES OVERLAY TO BE 15 TONS.
- CURB AND GUTTER SHALL BE STAKED WITH 3' OFFSETS AT 12.5' INTERVALS.
- ALL FLAGGED ELEVATIONS SHALL BE STAKED IN THE FIELD BY THE PRIVATE ENGINEER.
- DEVELOPER TO GIVE CITY WATER DIVISION FIVE (5) WORKING DAYS WRITTEN NOTICE PRIOR TO START OF CONSTRUCTION AND TO ALLOW CITY TEN (10) WORKING DAYS FOR COMPLETION OF WORK. (PHONE 787-7611)
- THE PRIVATE ENGINEER SIGNING THESE PLANS IS RESPONSIBLE FOR THE ACCURACY AND ACCEPTABILITY OF THE WORK HEREON. IN THE EVENT OF DISCREPANCIES ARISING DURING CONSTRUCTION, THE PRIVATE ENGINEER SIGNING THESE PLANS SHALL BE RESPONSIBLE FOR DETERMINING AN ACCEPTABLE SOLUTION AND REVISING THE PLANS FOR APPROVAL BY THE CITY.

LEGEND

- 1 — CONSTRUCT 4 1/2" A.C. OVER 4" D.G. PER R-1312
- 2 — CONSTRUCT VARIABLE THICKNESS A.C. OVERLAY PAVEMENT.
- 200 — CONSTRUCT CURB & GUTTER, TYPE I (6" C.F.) PER STD. NO. 200.
- 302 — CONSTRUCT DRIVEWAY APPROACH, TYPE II PER STD. NO. 302.
- 325 — CONSTRUCT 11" CURB SIDEWALK, PER STD. NO. 325.
- 326 — CONSTRUCT TREE WELL, PER STD. NO. 326.

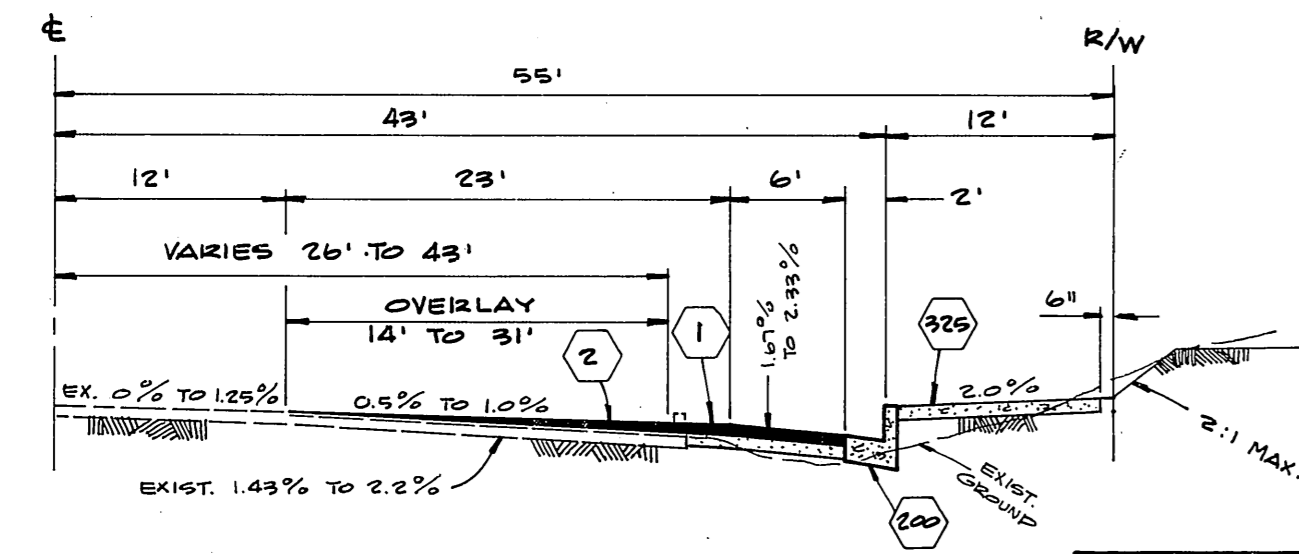

TYPICAL SECTION
NO SCALE T.I. = 5.0

PACIFIC TELEPHONE CO.
James P. Mares 4/26/79
DATE

BENCH MARK:
BRASS DISK STAMPED 601-26-68, FLUSH WITH SIDEWALK AT S.E. CORNER OF MAGNOLIA AVE. AND TYLER ST. ELEV. 742.243

CITY OF RIVERSIDE
OVERHEAD & UNDERGROUND
Bob Porphy 5-3-79
CHIEF UTILITIES ENGINEER - ELECTRIC DATE

CITY OF RIVERSIDE
DOMESTIC & IRRIGATION SYSTEM
John Fred Lamb 5/3/79
CHIEF UTILITIES ENGINEER - WATER DATE

ALBERT A. WOOD ARCHITECT
CITY OF RIVERSIDE, CALIFORNIA
DEPARTMENT OF PUBLIC WORKS
Paul H. Woble 7/25/79
9876
78-279 MAIRK C. BLOOME 1042 REC 418 7A

CITY OF RIVERSIDE, CALIFORNIA
DEPARTMENT OF PUBLIC WORKS
Robert A. Ubbels
5/16/79

STREET PLAN & PROFILE
TYLER STREET
ZONING CASE 12-16-789
HORIZ. 1" = 20' VERT. 1" = 4'
78-279 A

Indexed RMP