

GENERAL NOTES

1. IT SHALL BE THE RESPONSIBILITY OF THE CONTRACTOR TO CLEAR THE RIGHT OF WAY IN ACCORDANCE WITH THE PROVISIONS OF LAW AS IT AFFECTS EACH UTILITY INCLUDING IRRIGATION LINES AND APPURTENANCES AND AT NO COST TO THE CITY.
2. CONSTRUCTION SHALL BE IN ACCORDANCE WITH THE CITY OF RIVERSIDE DEPARTMENT OF PUBLIC WORKS, STANDARD DRAWINGS, AND THE STANDARD SPECIFICATIONS FOR PUBLIC WORKS CONSTRUCTION, 1979 EDITION.
3. TRIM EDGE OF EXISTING PAVEMENT WHERE NEW PAVEMENT JOINS TO A SMOOTH, STRAIGHT LINE. CONSTRUCT MATCH-UP PAVING AS SHOWN ON PLAN AND AS DIRECTED IN THE FIELD TO PRODUCE A SMOOTH SECTION.
4. THE PRIVATE ENGINEER SIGNING THESE PLANS IS RESPONSIBLE FOR THE ACCURACY AND ACCEPTABILITY OF THE WORK HEREON. IN THE EVENT OF DISCREPANCIES ARISING DURING CONSTRUCTION THE PRIVATE ENGINEER SIGNING THESE PLANS SHALL BE RESPONSIBLE FOR DETERMINING AN ACCEPTABLE SOLUTION AND REVISING THE PLANS FOR APPROVAL BY THE CITY.

CONSTRUCTION NOTES

- ① CONST. 4" A.C. OVER COMPACTED NATIVE, PER S.R. 772, R=58.
- ② CONST. "V" GUTTER PER STD. 110 WITH MODIFIED WIDTH AS INDICATED ON PLAN.
- ③ REMOVE EXISTING A.C. - REPLACE WITH 4" A.C. OVER COMPACTED NATIVE, PER S.R. 772, R=58.

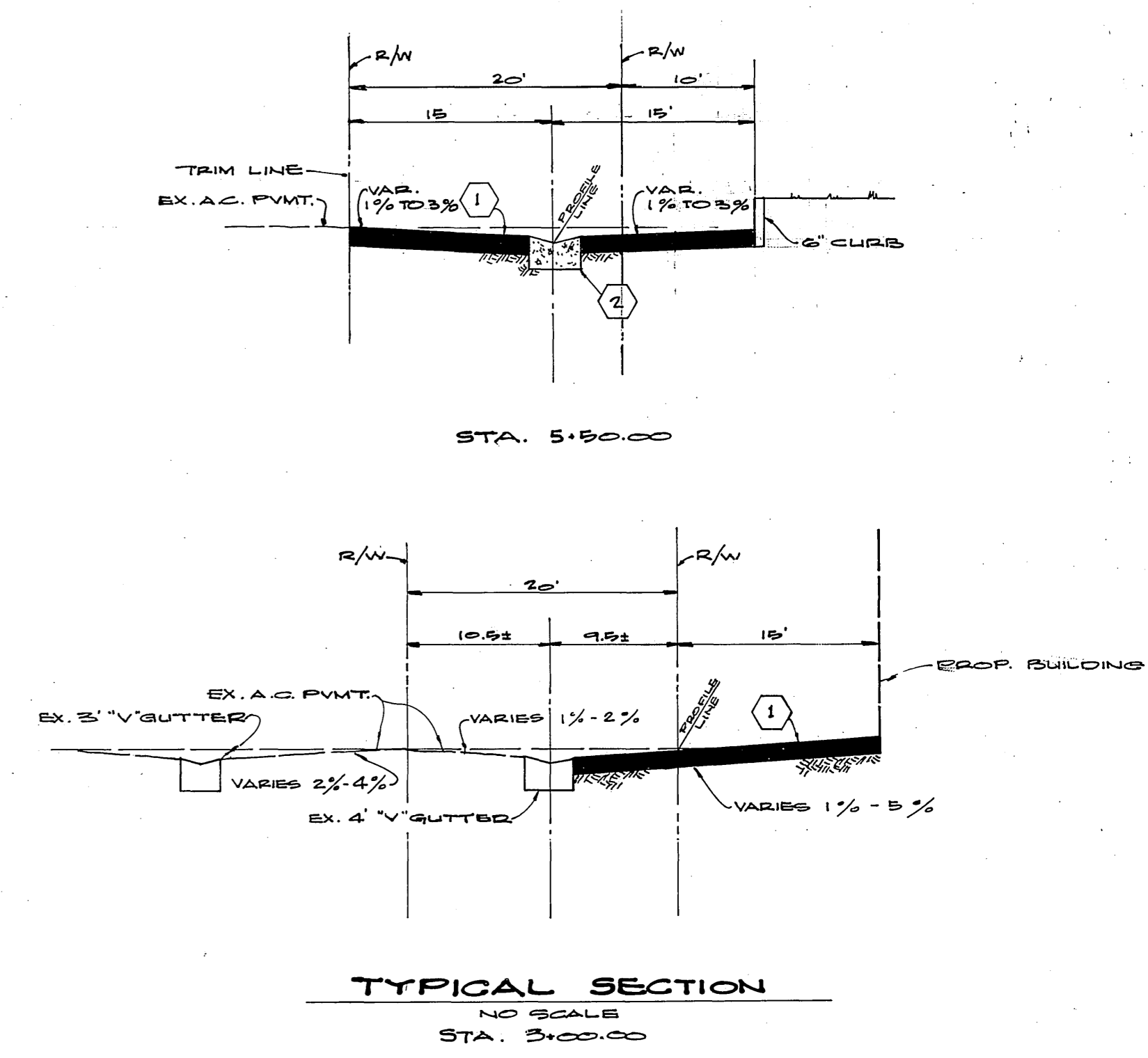
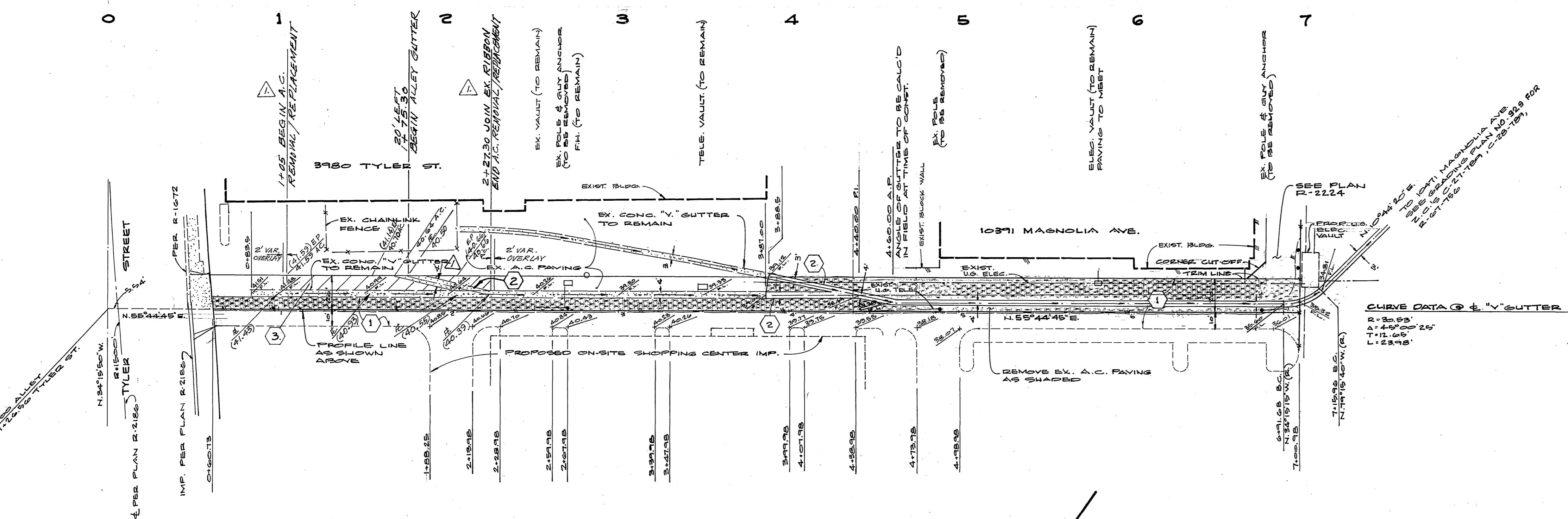
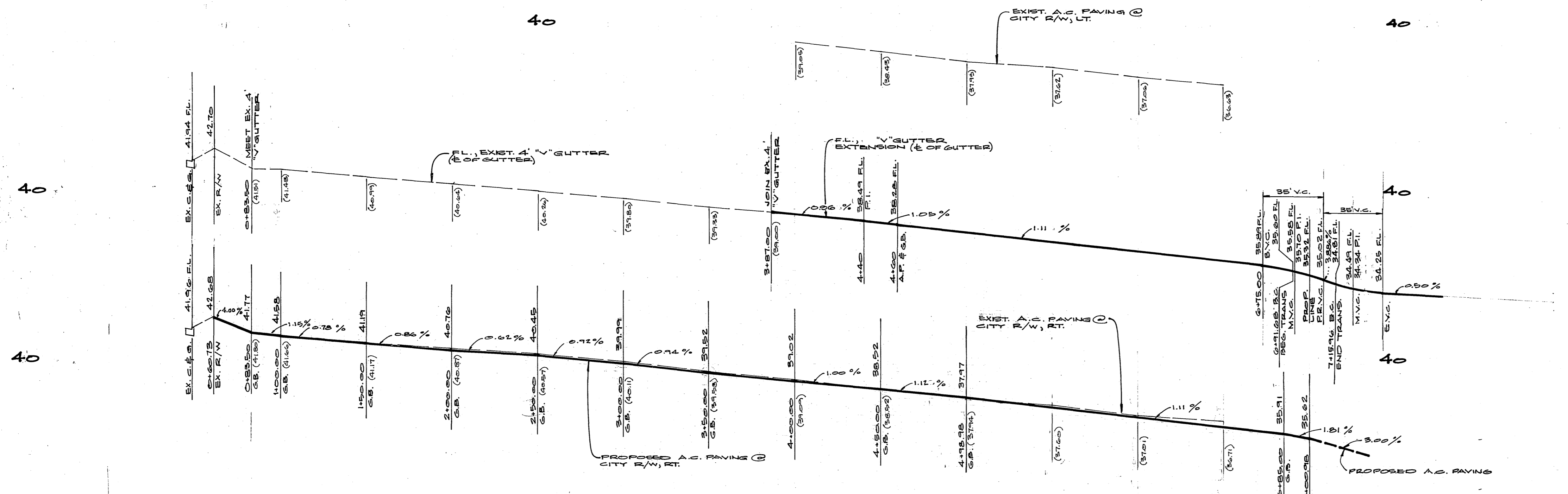

LEGEND
 E.P. - INDICATES ASPHALT ELEV. @ E.L.Y R/W
 F.L. - INDICATES FLOWLINE
 () - INDICATES EXISTING ELEVATION
 A.C. - INDICATES PROPOSED FINISH ASPHALT ELEV.

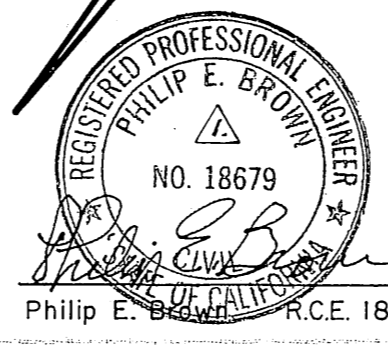
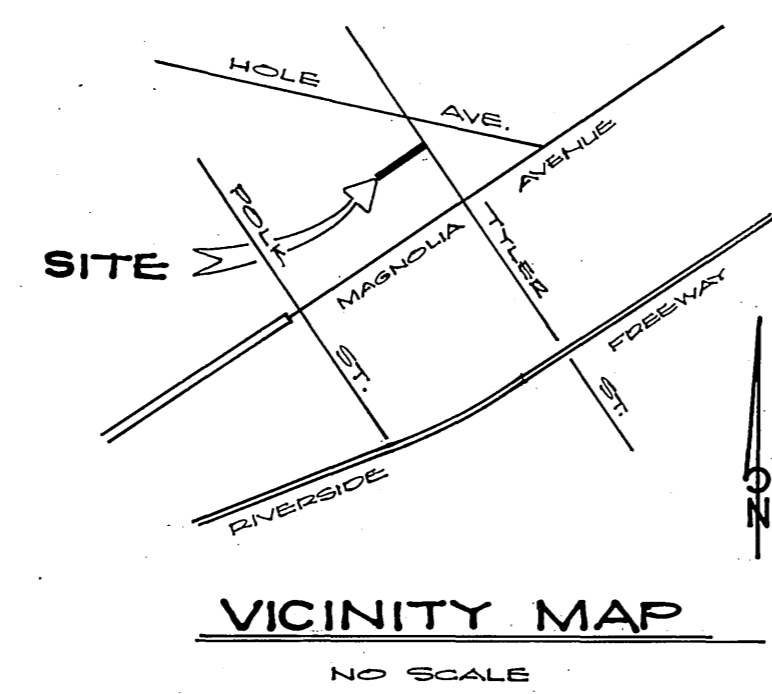

BENCH MARK
 BRASS DISK SET IN CONC. AT BACK OF SIDEWALK E.L.Y CORNER OF TYLER & MAGNOLIA.
 ELEV. = 742.243

CITY OF RIVERSIDE OVERHEAD & UNDERGROUND
 PACIFIC TELEPHONE CO.
 Chief Utilities Engineer, DATE 10-11-79
 APPROVED BY DATE [Signature] 9/17/79

ALBERT A. WEBB ASSOCIATES
 CIVIL ENGINEERS
 RIVERSIDE, CALIFORNIA
 DATE 7/18/79

CITY OF RIVERSIDE, CALIFORNIA
 DEPARTMENT OF PUBLIC WORKS
 11/5/79

ALLEY
 100'± N.W. MAGNOLIA AV., FROM TYLER ST. TO 700'± W.L.Y.
 ZONING CASE R.E. 78A
 3850 TYLER ST. BEST OBT. STORE.
 HORIZ. 1" = 40' VERT. 1" = 4'
R-2223
 73-145