

55

55

55

55

4

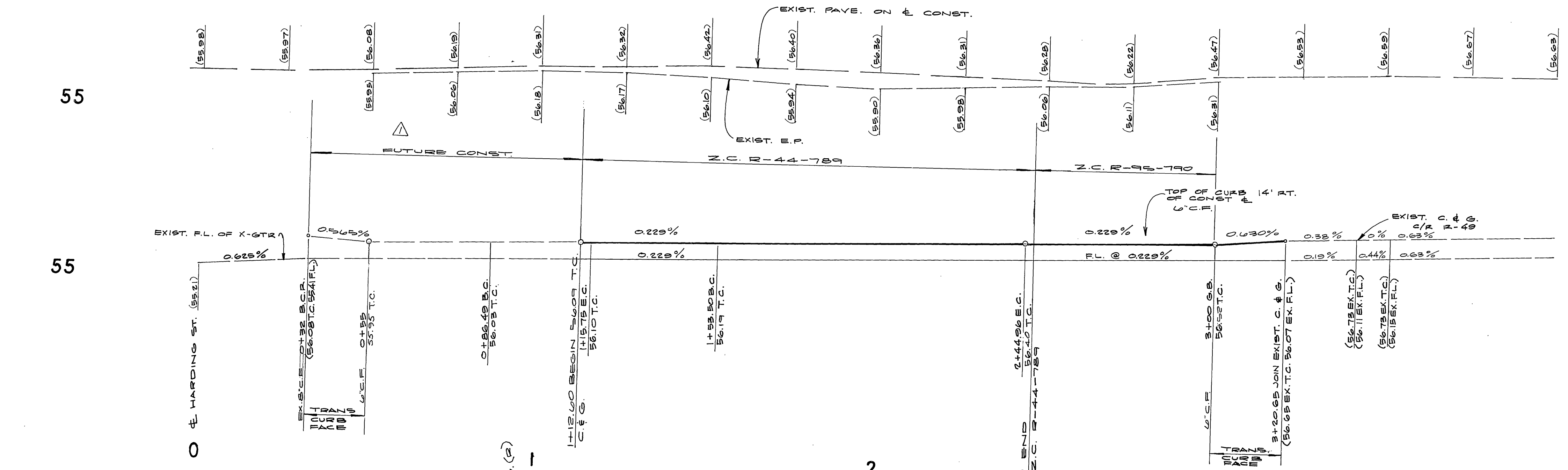

CURVE DATA			
#	Δ	R	L
1	8°23'00"	200'	23.26'
2	26°12'00"	200'	46.54'
3	8°23'00"	210'	15.39'
4	24°12'00"	190'	44.21'
5	0°54'10"	210'	1.65'

GENERAL NOTES

1. THE PRIVATE ENGINEER SIGNING THESE PLANS IS RESPONSIBLE FOR THE ACCURACY AND ACCEPTABILITY OF THE WORK HEREON. IN THE EVENT OF DISCREPANCIES ARISING DURING CONSTRUCTION, THE PRIVATE ENGINEER SHALL BE RESPONSIBLE FOR DETERMINING AN ACCEPTABLE SOLUTION AND REVISIONS TO THE PLANS FOR APPROVAL BY THE CITY.
2. IT SHALL BE THE RESPONSIBILITY OF THE CONTRACTOR TO CLEAR THE RIGHT OF WAY IN ACCORDANCE WITH THE PROVISIONS OF LAW AS IT AFFECTS EACH UTILITY INCLUDING IRRIGATION LINES AND APPURTENANCES AND AT NO COST TO THE CITY.
3. CONSTRUCTION SHALL BE IN ACCORDANCE WITH THE CITY OF RIVERSIDE, DEPARTMENT OF PUBLIC WORKS STANDARD DRAWINGS AND THE STANDARD SPECIFICATIONS FOR PUBLIC WORKS CONSTRUCTION, 1979 EDITION.
4. TRIM EDGE OF EXISTING PAVEMENT WHERE NEW PAVEMENT JOINS AS SHOWN ON PLAN.
5. CURB AND GUTTER SHALL BE STAKED WITH 3' OFFSETS AT 25' INTERVALS.
6. CURB AND GUTTER SHALL BE STAKED WITH 3' OFFSETS AT 12.5' INTERVALS AND TWO ROWS OF NO. 3 REBAR SHALL BE PLACED IN GUTTER WHERE GRADE IS LESS THAN 0.40%. PLACE 3/4" DOWEL PINS AT ALL EXPANSION JOINTS.
7. ALL FLAGGED ELEVATIONS SHALL BE STAKED IN THE FIELD BY THE PRIVATE ENGINEER.
8. ALL RELATED WORK SHALL CONFORM TO THE CITY OF RIVERSIDE, PARK AND RECREATION DEPARTMENT STANDARDS.
9. CONTACT THE PARK PROJECTS INSPECTOR A MINIMUM OF 48 HOURS IN ADVANCE AT 787-7223 TO SCHEDULE INSPECTIONS. INSPECTORS SHALL BE REQUIRED: (A) WHEN PLANT LOCATIONS HAVE BEEN SPOTTED IN THE FIELD PRIOR TO DIGGING PLANT PITS, (B) WHILE DIGGING PLANT PITS AND ALL OTHER INDICATED OR SPECIFIED WORK HAS BEEN COMPLETED FOR START OF MAINTENANCE, AND (C) WHEN MAINTENANCE/FINAL ACCEPTANCE (CONTRACTOR/DEVELOPER WILL BE RELEASED FROM MAINTENANCE ONLY UPON RECEIPT OF WRITTEN NOTIFICATION FROM THE CITY THAT THE PARK AND RECREATION DEPARTMENT IS ASSUMING MAINTENANCE RESPONSIBILITIES).
10. THE CONTRACTOR/DEVELOPER SHALL MAINTAIN ALL PLANTINGS FOR A MINIMUM PERIOD OF ONE (1) YEAR.
11. STREET TREE PLANTING SHALL BE AS FOLLOWS:

STREET NAME	BOTANICAL NAME/COMMON NAME	MIN. SIZE	APPROX. SPACING
NIXON DRIVE	LAGERSTROMIA INDICA / CRAPE MYRTLE	15G	45'
HARDING ST.	MAGNOLIA GRANDIFLORA "MAJESTIC BEAUTY" / MAGNOLIA	15G	45'
12. DEVELOPER TO GIVE CITY WATER DIVISION FIVE (5) WORKING DAYS WRITTEN NOTICE PRIOR TO START OF CONSTRUCTION AND TO ALLOW CITY TEN (10) WORKING DAYS FOR COMPLETION OF WORK. (787-7611)

CONSTRUCTION NOTES

1. CONST. CURB AND GUTTER, PER C/R STD. 200 (6" C.R.).
2. INSTALL 2 1/2" A.C. OVER 9" D.G. CRUSHED A.B. PER SR 1094. (R-115)
3. CONST. PROPERTY LINE SIDEWALK, PER C/R STD. 325. AND CURB SIDEWALK
4. PLANT STREET TREES PER CITY OF RIVERSIDE PARKS AND RECREATION STANDARDS.
5. CONST. WHEELCHAIR RAMP PER C/R STD. 304.
6. CONST. UNDERSIDEWALK DRAIN PER C/R STD. 414. 4.10

BENCH MARK:
 TOP U.S.C. # 6 BRASS CAP (TRIANGULATION STATION NAME) UNDER MONUMENT CAP IN SIDEWALK AT NORTHWEST CORNER OF BROCKTON & ARLINGTON, C/R RD. 606/69. ELEV. 843.015

TYPICAL STREET SECTION

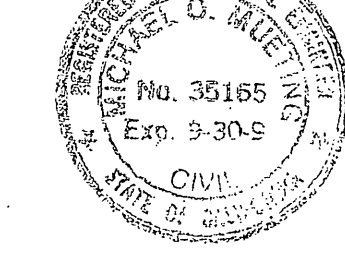

REVISION BY: **J.F. DAVIDSON ASSOCIATES, INC.**
 3880 LEON STREET, STE. 300
 RIVERSIDE, CA 92504
 DATE: 12-1-80

CITY OF RIVERSIDE
 OVERHEAD & UNDERGROUND
 CHIEF UTILITIES DATE
 ENGINEER - ELECTRIC

CITY OF RIVERSIDE
 DOMESTIC
 WATER SYSTEMS DATE
 MANAGER

Revised 411 to 410
 ADDED ST. TREES & CURRENT GENERAL NOTES FOR ST. TREES.
 ADDED PAVING, CURB & SIDEWALK (NIXON DR) SW & WC RAMP (HARDING ST) AND UNDER SIM DRAIN (NIXON DR), AND TYPICAL SECTIONS.