

STA. 0+00 EVEREST AVE
STA. 221+43 MAGNOLIA AVE.

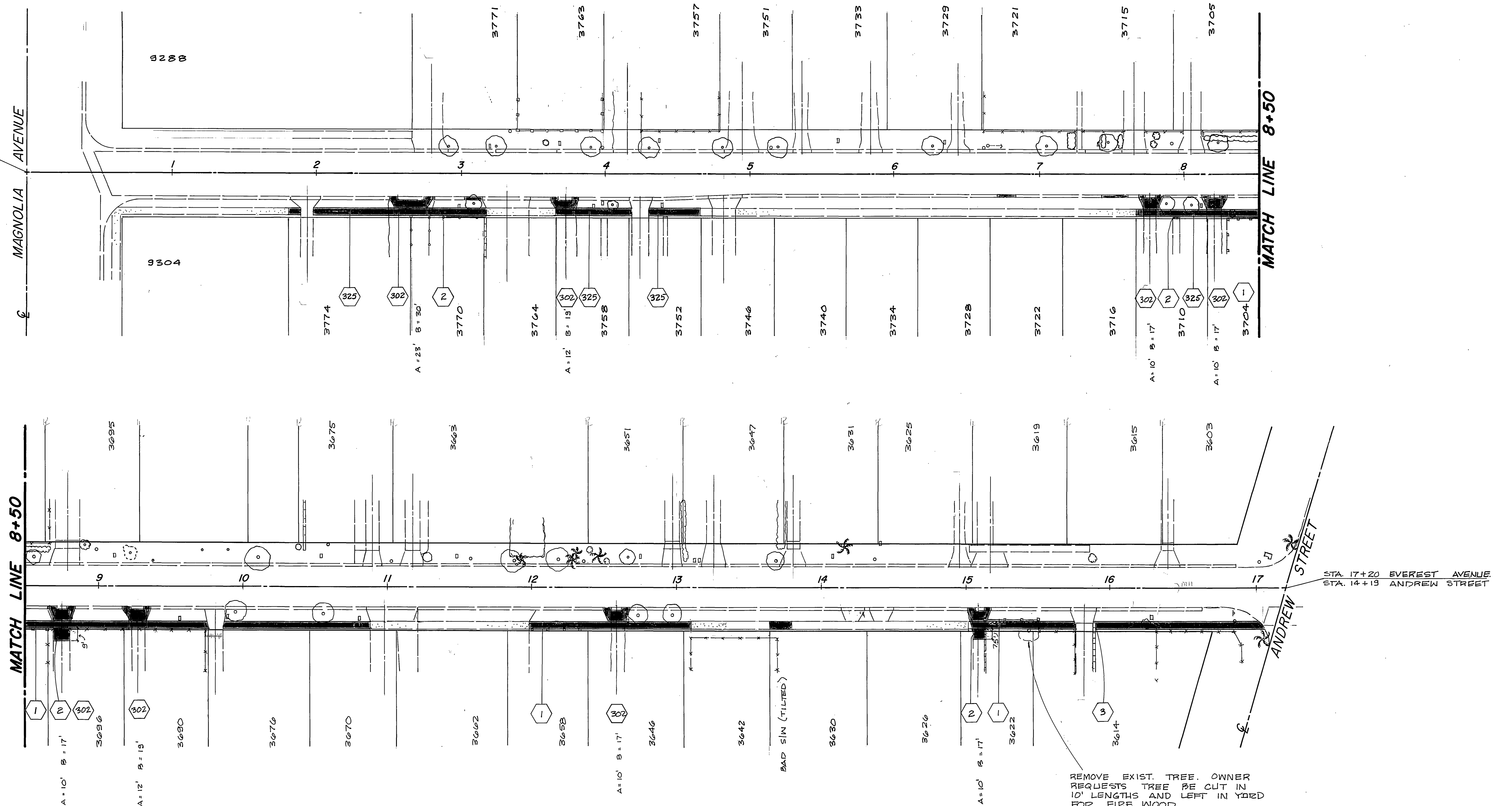
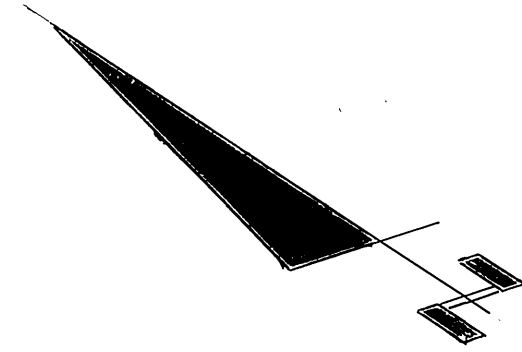

GENERAL NOTES :

- I. CONSTRUCTION SHALL BE IN ACCORDANCE WITH THE CITY OF RIVERSIDE, DEPT. OF PUBLIC WORKS, STANDARD DWGS, AND THE STANDARD SPECIFICATIONS FOR PUBLIC WORKS CONSTRUCTION, 1979 EDITION.

CONSTRUCTION NOTES :

- ① - RELOCATE FENCE (BY OWNER)
- ② - CONSTRUCT MATCH-UP CONCRETE FROM BACK OF SIDEWALK TO EXIST. PAVING.
- ③ - CONTRACTOR SHALL REMOVE THAT PORTION OF WALL WHICH IS IN THE WAY OF CONSTRUCTION
- ②00 - CONSTRUCT CURB AND GUTTER PER STD. DWG. # 200, TO MEET EXIST.
- ③02 - CONSTRUCT DRIVEWAY APPROACHES PER STD DWG #302, A AND B, AS NOTED.
- ③25 - CONSTRUCT SIDEWALK PER STD. DWG. # 325, TO MEET EXIST.

REMOVE EXIST. TREE. OWNER REQUESTS TREE BE CUT IN 10' LENGTHS AND LEFT IN YARD FOR FIRE WOOD.

CITY OF RIVERSIDE PUBLIC WORKS DEPARTMENT		HCD ARLINGTON AREA EVEREST AVENUE BETWEEN MAGNOLIA AVE. AND ANDREW STREET	INDEXED 8LD ACCOUNT NO. 15-550-539 R-2335 SHEET 1 OF 1
APPROVED PRINCIPAL ENGINEER PARK DEPARTMENT TRAFFIC DIVISION CHIEF P. W. ENGINEER	BY <i>[Signature]</i> DATE 12/23/80	APPROVED BY PUBLIC WORKS DIRECTOR <i>[Signature]</i> DATE 12/23/80	
DESIGNED BY <i>[Signature]</i> DRAWN BY <i>[Signature]</i> CHECKED BY <i>[Signature]</i>		HORIZ. SCALE: 1" = 40' VERT. SCALE: 1" =	