

NOTE: TAKE SPECIAL CARE TO EXPOSE AND/OR RELOCATE (BY OWNER) ALL UTILITIES SYSTEMS AT ADDRESSES 7338 AND 7330

VILLEGAS PARK

GENERAL NOTES :

1. CONSTRUCTION SHALL BE IN ACCORDANCE WITH STANDARD SPECIFICATIONS FOR PUBLIC WORKS CONSTRUCTION, 1979 EDITION, AND CITY OF RIVERSIDE STANDARD DRAWINGS.
2. CONSTRUCTION CONTRACTOR TO RESET ANY STREET NAME AND TRAFFIC SIGNS.
3. CONSTRUCTION CONTRACTOR TO GIVE CITY WATER DIVISION FIVE (5) WORKING DAYS WRITTEN NOTICE PRIOR TO START OF CONSTRUCTION AND TO ALLOW CITY TEN (10) WORKING DAYS FOR COMPLETION OF WORK. (TEST-TIGHT)
4. CONSTRUCTION CONTRACTOR TO ADJUST STREET LIGHT PULL BOXES AND STREET LIGHT FOUNDATION CAPS TO NEW SIDEWALK GRADE AS REQUIRED.
5. GRADING AT REAR OF S/W, IF NECESSARY, TO MEET EX. GROUND AT R/W.

CONSTRUCTION LEGEND :

- (302) CONSTRUCT DRIVEWAY APPROACH, PER STD. 302
- (304) CONSTRUCT WHEELCHAIR RAMP, PER STD. 304
- (325) CONSTRUCT SIDEWALK, PER STD. 325
- (1) REMOVE CURB AS REQUIRED AND REPLACE TO FORM DEPRESSION (S=...) AS NOTED, PER STD. 302
- (2) CONSTRUCT A.C. DWY., LOCATION AS SHOWN.
- (3) RELOCATE FENCE (BY OWNER)
- (4) ADJUST FIRE HYDRANT OR WATER METER TO GRADE (BY CITY FORCES)
- (5) ADJUST GAS VALVES (BY SO. CALIF. GAS CO.)
- (200) CONSTRUCT CURB & GUTTER, PER STD. 200
- (6) CONSTRUCT MATCH-UP CONCRETE PAVING.
- (7) REMOVE AND REPLACE SIDEWALK

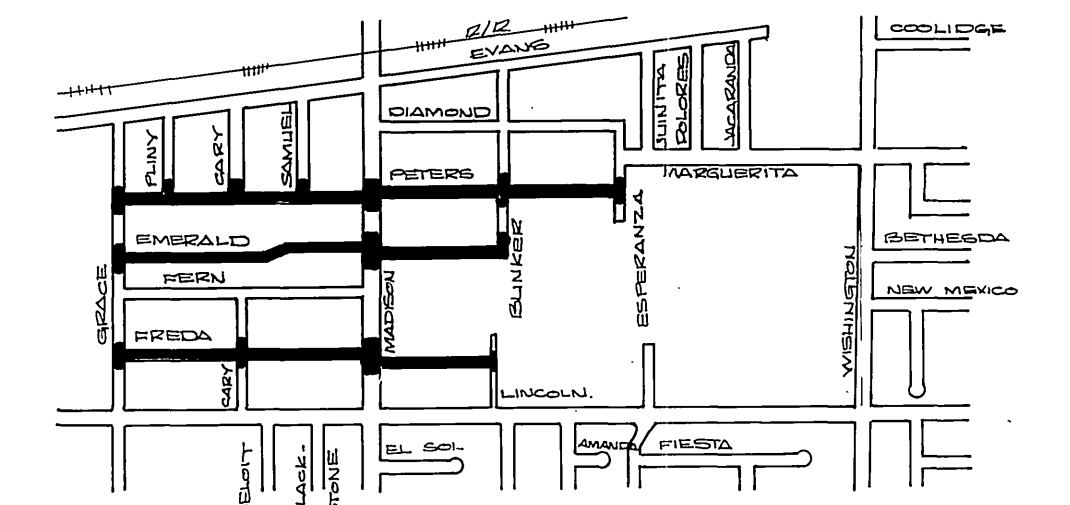

LOCATION MAP NOT TO SCALE

6-5-85
10/26/81
* AS BUILT
7 1/2
3/26

ALBERT A. WEBB ASSOCIATES CIVIL ENGINEERS RIVERSIDE, CALIFORNIA APPROVED BY: <i>[Signature]</i> DATE 10/22/80 R.E. No. 9810	CITY OF RIVERSIDE, CALIFORNIA DEPARTMENT OF PUBLIC WORKS		H.C.O. CASA BLANCA PETERS ST. EMERALD ST. FRED AVE.		ACCOUNT NO. 15-590-932 DRAWING NUMBER R-2338
	APPROVED BY: <i>[Signature]</i> DATE 10/22/80 R.E. No. 9810 W.O. 162 FOR CITY OF RIVERSIDE F.B.	DESIGNED BY: <i>[Signature]</i> DRAWN BY: <i>[Signature]</i> CHECKED BY: <i>[Signature]</i>	APPROVED BY: <i>[Signature]</i> DATE 1/29/81 DIRECTOR OF PUBLIC WORKS	CHIEF P. W. ENGR. <i>[Signature]</i> DATE 1/29/81	SHEET 1 OF 3 80-162

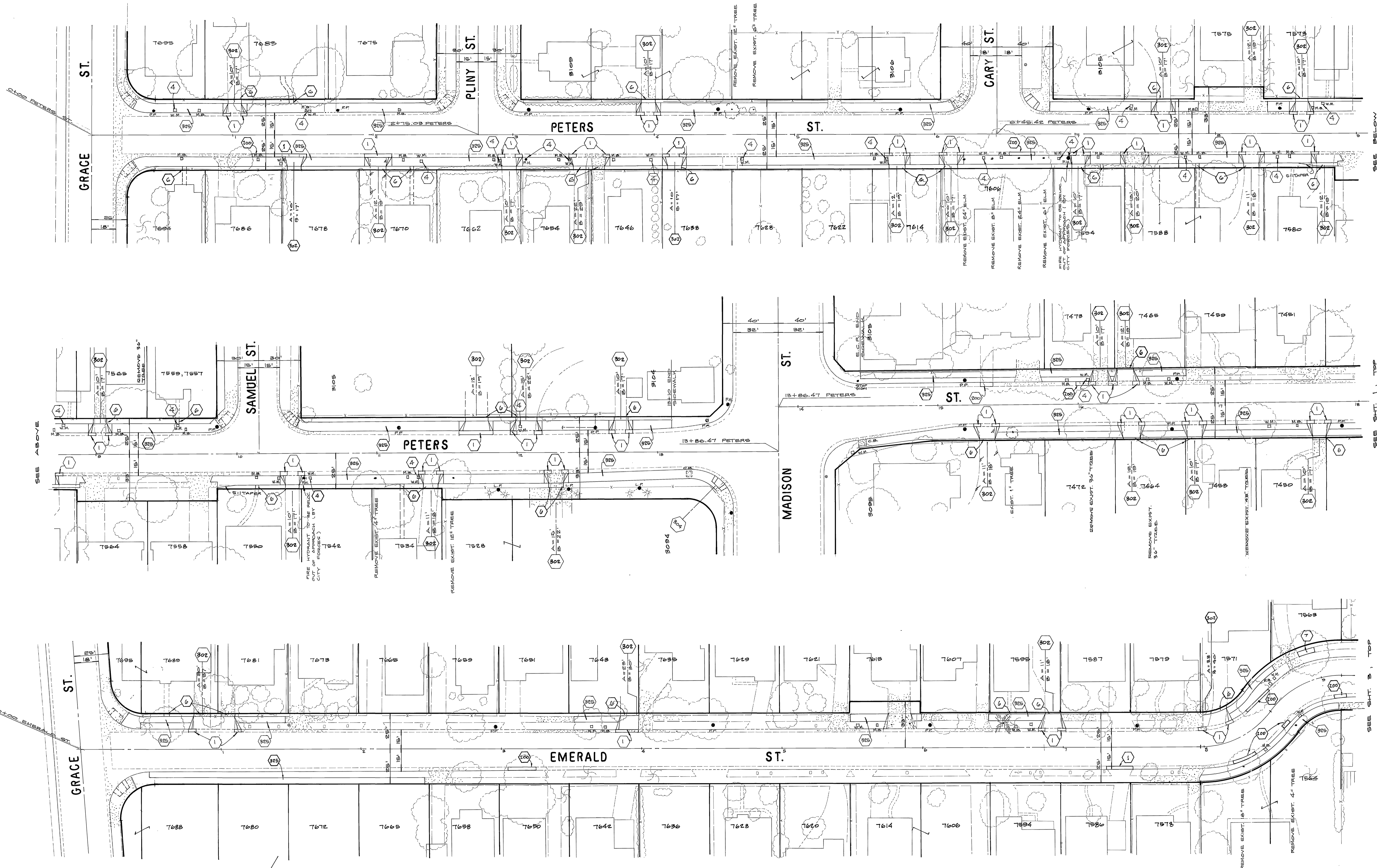

SEE BELOW

SEE SHT. 1, TOP

SEE SHT. 2, TOP

SEE SHEET 1 FOR GENERAL & CONSTRUCTION NOTES.

* AS BUILT 10/27/81 BCET

INDEXED BLD

ALBERT A. WEBB ASSOCIATES CIVIL ENGINEERS RIVERSIDE, CALIFORNIA		CITY OF RIVERSIDE, CALIFORNIA DEPARTMENT OF PUBLIC WORKS		H.C.D. SIDEWALKS PETERS ST. EMERALD ST.		ACCOUNT NO. 15-1952-532
APPROVED BY: <i>Albert A. Webb</i> DATE: 10/22/80		APPROVED BY: <i>Albert A. Webb</i> DATE: 10/22/80		DIRECTOR OF PUBLIC WORKS		DRAWING NUMBER R-2338
R.E. NO. 3876		CHIEF P.W. ENGR. <i>Albert A. Webb</i> DATE: 1/29/81		SCALE: 1" = 30'		SHEET 2 OF 3
W.O. 80-162FOR: CITY OF RIVERSIDE		DESIGNED BY: <i>Albert A. Webb</i>		CHECKED BY: <i>Albert A. Webb</i>		80-162

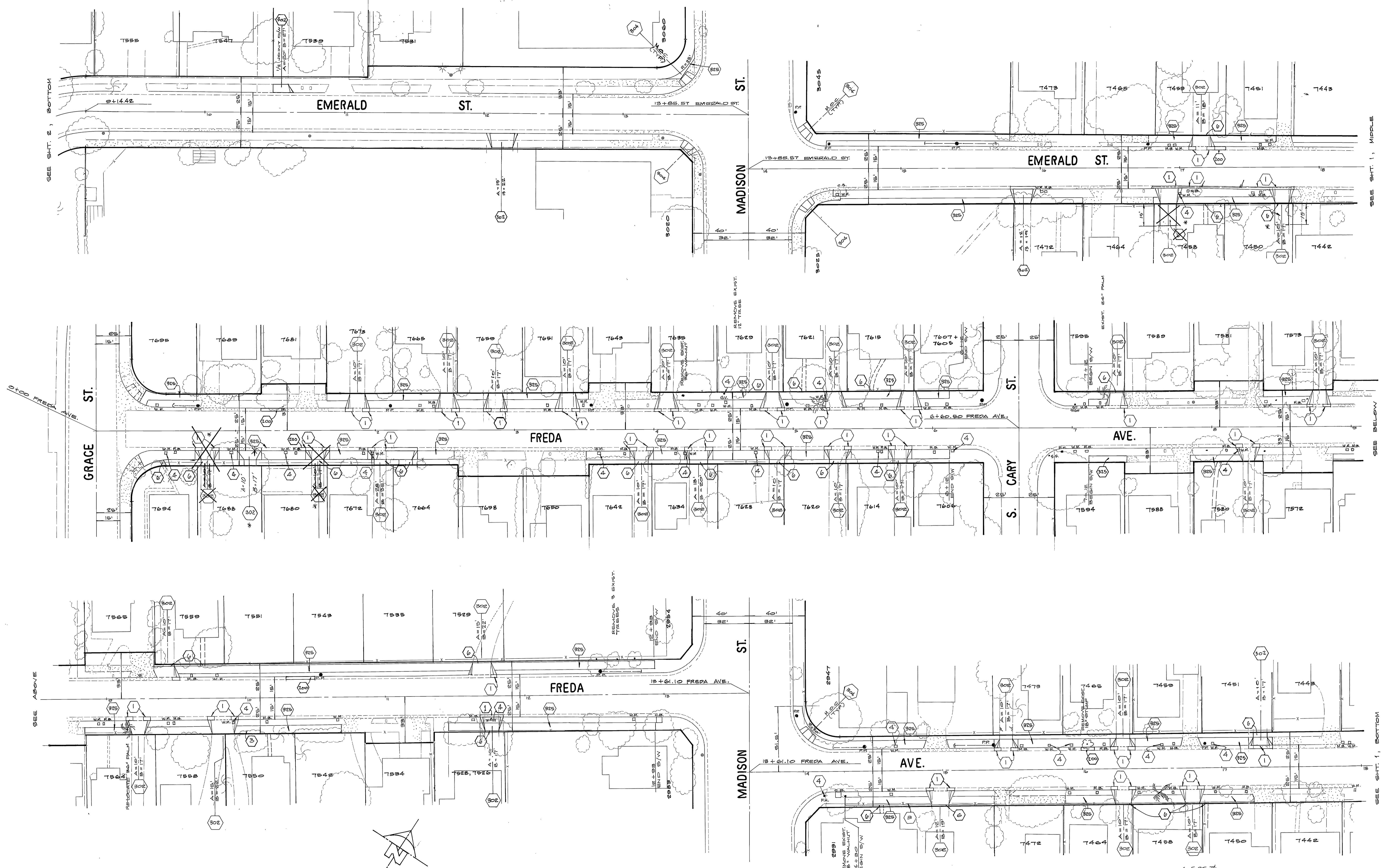

SEE SHEET 1 FOR GENERAL & CONSTRUCTION NOTES.

ALBERT A. WEBB ASSOCIATES
 CIVIL ENGINEERS
 RIVERSIDE, CALIFORNIA
 APPROVED BY: *[Signature]* DATE: 10/27/80
 R.E. No. 3878
 W.O. 80-162 FOR: CITY OF RIVERSIDE F.B.

MARK	REVISIONS	APPR.	DATE

CITY OF RIVERSIDE, CALIFORNIA
 DEPARTMENT OF PUBLIC WORKS
 APPROVED BY: *[Signature]* DATE: 10/27/80
 DIRECTOR OF PUBLIC WORKS
 CHIEF P. W. ENGR. DATE: 10/27/80

H.C.D. SIDEWALKS
 FREDA AVENUE
 EMERALD STREET
 SCALE: 1" = 30'

INDEXED BLD
 ACCOUNT NO: 550-532
 DRAWING NUMBER
 R-2338
 SHEET 3 OF 3
 80-162

4-5.85 74
 * AS BUILT 10-27-81 B&E/T

SEE SHT. 2, BOTTOM

SEE SHT. 1, MIDDLE

SEE BELOW

SEE SHT. 1, BOTTOM