

GENERAL NOTES

- IT SHALL BE THE RESPONSIBILITY OF THE CONTRACTOR TO CLEAR THE RIGHT OF WAY IN ACCORDANCE WITH THE PROVISIONS OF LAW AS IT AFFECTS EACH UTILITY INCLUDING IRRIGATION LINES AND APPURTENANCES AND AT NO COST TO THE CITY.
- CONSTRUCTION SHALL BE IN ACCORDANCE WITH THE CITY OF RIVERSIDE DEPARTMENT OF PUBLIC WORKS, STANDARD DRAWINGS, STANDARD DRAWING NO. 10 AND THE STANDARD SPECIFICATIONS FOR PUBLIC WORKS CONSTRUCTION, CURRENT EDITION.
- THE PRIVATE ENGINEER SIGNING THESE PLANS IS RESPONSIBLE FOR ASSURING AND ACCEPTABILITY OF THE WORK HEREON. IN THE EVENT OF DISCREPANCIES ARISING DURING CONSTRUCTION, THE PRIVATE ENGINEER SHALL BE RESPONSIBLE FOR DETERMINING AN ACCEPTABLE SOLUTION AND REVISING THE PLANS FOR APPROVAL BY THE CITY.
- THE DEVELOPER SHALL BE RESPONSIBLE FOR PRESERVING OR RE-ESTABLISHING AND REFERENCING SURVEY MONUMENTS DESTROYED, DISTURBED OR BURIED AS A RESULT OF CONSTRUCTION SHOWN HEREON.
- ALL FLAGGED ELEVATIONS SHALL BE STAKED IN THE FIELD BY THE PRIVATE ENGINEER.
- TRIM EDGE OF EXISTING PAVEMENT WHERE NEW PAVEMENT JOINS TO A SMOOTH, STRAIGHT LINE. CONSTRUCT MATCH-UP PAVING AS SHOWN ON PLAN AND OVERLAY PAVING AS DIRECTED IN THE FIELD TO PRODUCE A SMOOTH SECTION.
- ANY TRAFFIC CONTROL STRIPING OBLITERATED AND/OR BADLY WORN DURING CONSTRUCTION SHALL BE RESTORED BY THE CONTRACTOR WITHIN FIVE DAYS AFTER NOTIFICATIONS FROM CITY INSPECTORS.

GENERAL NOTES FOR STREET TREES

- ALL RELATED WORK SHALL CONFORM TO CITY OF RIVERSIDE, PARK AND RECREATION DEPARTMENT STANDARDS.
- CONTRACT THE PARK PROJECTS INSPECTOR A MINIMUM OF 48 HOURS IN ADVANCE AT 787-7223 TO SCHEDULE INSPECTIONS. INSPECTIONS SHALL BE REQUIRED:
  - WHEN PLANT LOCATION HAVE BEEN SPOTTED IN THE FIELD PRIOR TO DIGGING PLANT PITS.
  - WHILE DIGGING PLANT PITS AND PLANTING/RELOCATING TREES.
  - AFTER PLANTING AND ALL OTHER INDICATED OR SPECIFIED WORK HAS BEEN COMPLETED FOR START OF MAINTENANCE.
  - AT END OF MAINTENANCE/FINAL ACCEPTANCE (CONTRACTOR/DEVELOPER WILL BE RELEASED FROM MAINTENANCE ONLY UPON RECEIPT OF WRITTEN NOTIFICATION FROM THE CITY THAT THE PARK AND RECREATION DEPARTMENT IS ASSUMING MAINTENANCE RESPONSIBILITIES).
- THE CONTRACTOR/DEVELOPER SHALL MAINTAIN ALL PLANTINGS FOR A MINIMUM OF ONE (1) YEAR.
- STREET TREE PLANTING SHALL BE PITTOSPORUM UNDLATUM/VICTORIAN BOX, 15 GAL., 45' SPACING AS SHOWN, 3 REQUIRED.
- STREET TREES TO BE AUTOMATICALLY IRRIGATED.

CONSTRUCTION NOTES

- CONSTRUCT 8" P.C.C. CURB AND GUTTER TYPE I PER CITY STD. DRAWING NO. 200.
- CONSTRUCT 6" P.C.C. DRIVEWAY TYPE V PER CITY STD. DRAWING NO. 302.
- CONSTRUCT 3 1/2" P.C.C. SIDEWALK PER CITY STD. DRAWING NO. 325.
- SAW CUT AND REMOVE EXISTING AC. BERM, A.C. GUTTER, AND A.C. PAVEMENT.
- CONSTRUCT 4" A.C. PAVEMENT ON 8" AGGREGATE BASE, PER R-785.
- CONSTRUCT P.C.C. PARKWAY DRAIN, CURB OUTLET W=36" PER CITY STD. DRAWING NO. 410., OMIT FRAME AND COVER.
- VAULTS AND M.H.'S TO BE ADJUSTED TO GRADE BY UTILITY OWNERS.
- INSTALL 6" V.C.P. SEWER LATERAL
- PLANT STREET TREES TO THE SPECIFICATIONS OF THE PARK AND RECREATION DEPARTMENT.
- CONSTRUCT UNDER SIDEWALK DRAIN PER CITY STD. 411.

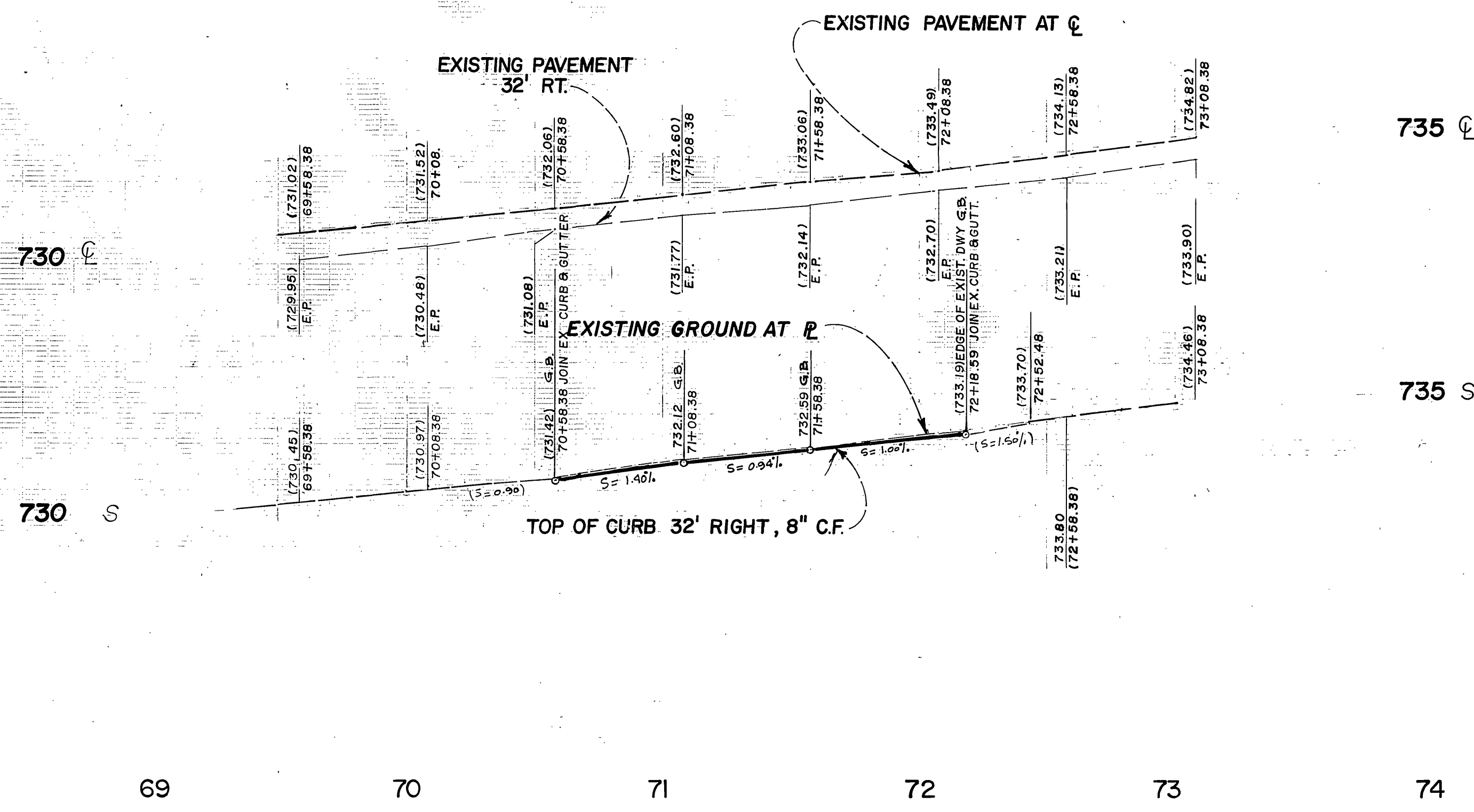
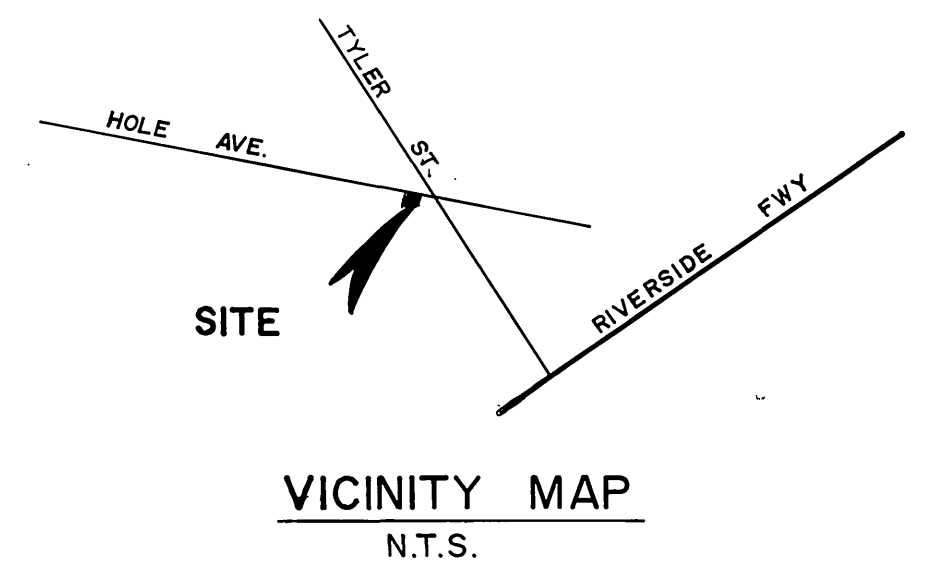

SCALE:  
 HORIZ : 1" = 40'  
 VERT : 1" = 4'

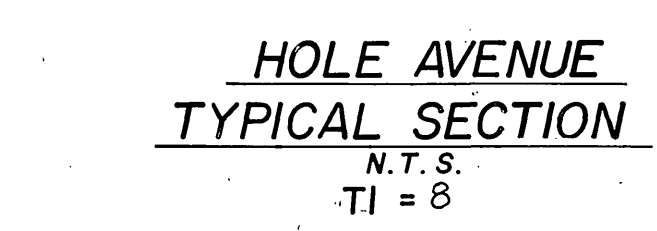
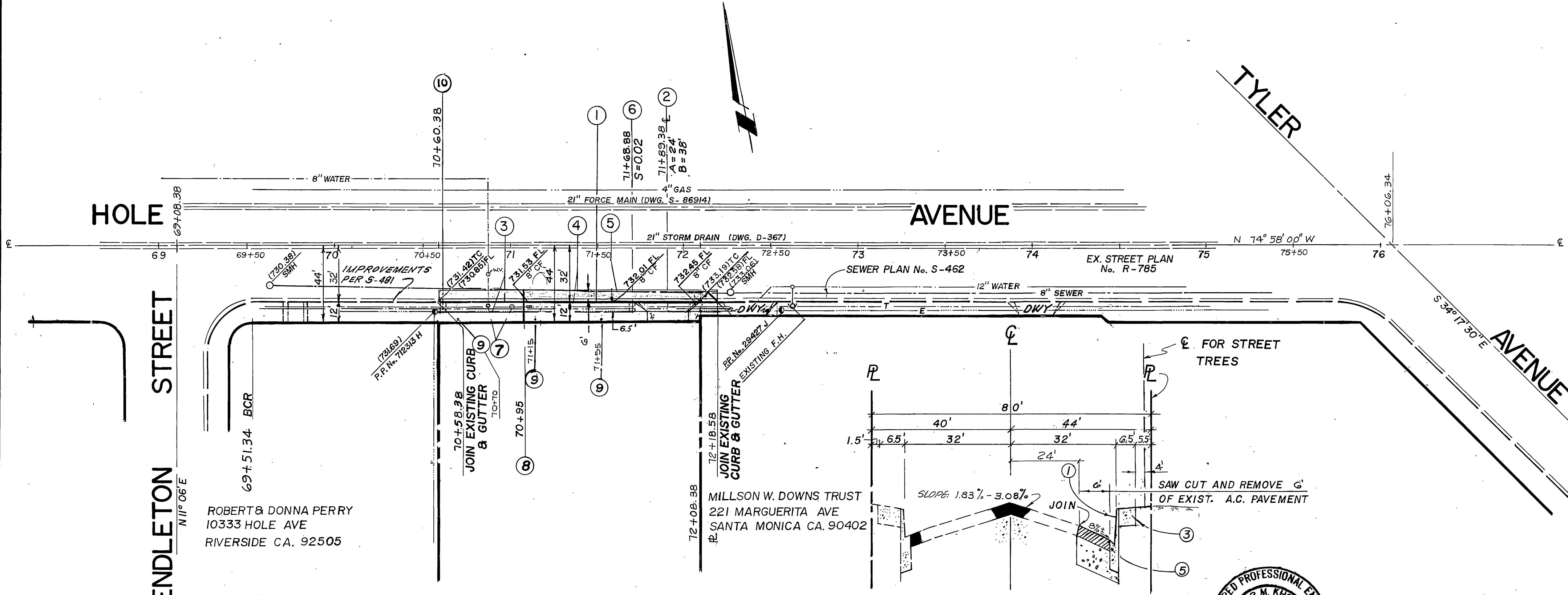

APPROVED BY: <i>Samir M. Khoury</i> WATER DEPARTMENT DATE: 1-12-87	BENCH MARK: F3-H. P.K. NAIL AND CITY ENGINEER TAG IN THE S'LY CURB OF HOLE AVENUE 165' ± W'LY OF THE P.I. OF HOLE AVENUE AND TYLER STREET, 2' N'LY OF P.P. No. 29426-J ELEV: 736.223	COORY ENGINEERING 12631 IMPERIAL HWY. BLDG. SUITE No. 124 SANTA FE SPRINGS, CA 90670 (213) 868-8266 PLANS PREPARED UNDER THE SUPERVISION OF: <i>Samir M. Khoury</i> SAMIR M. KHOURY RCE 30567 LICENSE EXPIRES 3/31/1988 DATE: 5-3-86	CITY OF RIVERSIDE PUBLIC WORKS DEPARTMENT APPROVED BY: <i>William D. Gardner</i> PUBLIC WORKS DIRECTOR DATE: 1-21-87	STREET PLAN AND PROFILE HOLE AVENUE FROM STA. 70+58.30 TO 72+18.50 W'LY TYLER AVENUE BUILDING PERMIT: 10330 HOLE AVE. SHEET 1 OF 1	ACCOUNT NO. R-2834
DESIGNED BY H.A.G., DRAWN BY L.Y.B., CHECKED BY S.M.K.			DATE: 1-21-87	HORIZ. SCALE: 1" = 40' VERT. SCALE: 1" = 4'	10330