

735

735 1/4 CROWN

735

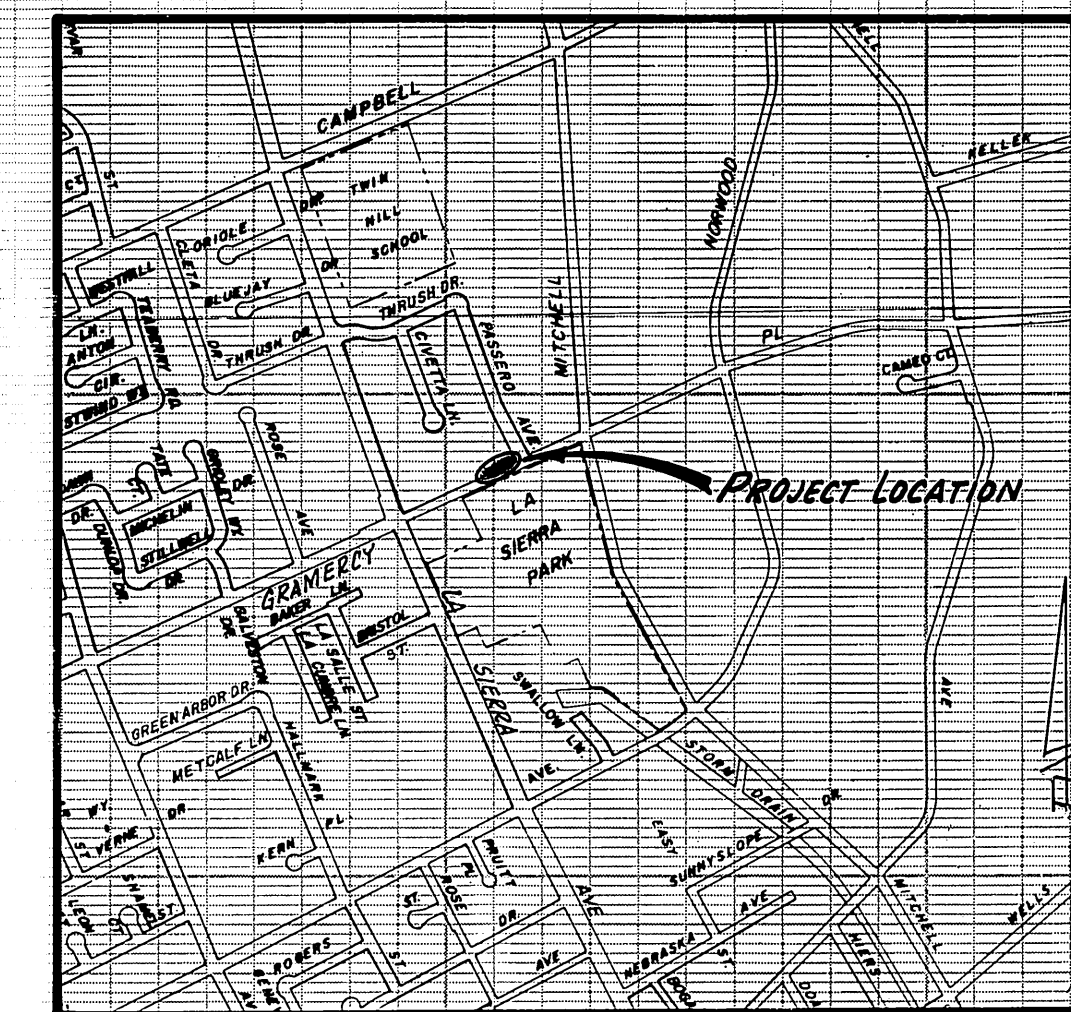

VICINITY MAP

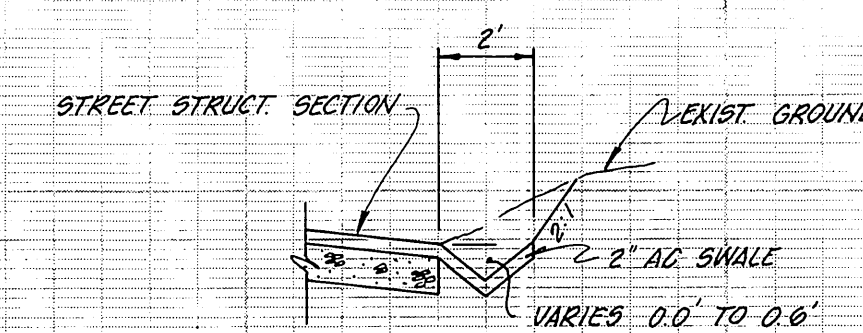
SECTION A-A
NO SCALE

BENCH MARK:

N/E END OF EXIST. CURB & GUTTER
ON GRAMERCY PLACE AND THE
INTERSECTION OF PASSERO AVE. AS
SHOWN ON R-2650 SHT. 5
ELEV. 738.56 T.C.

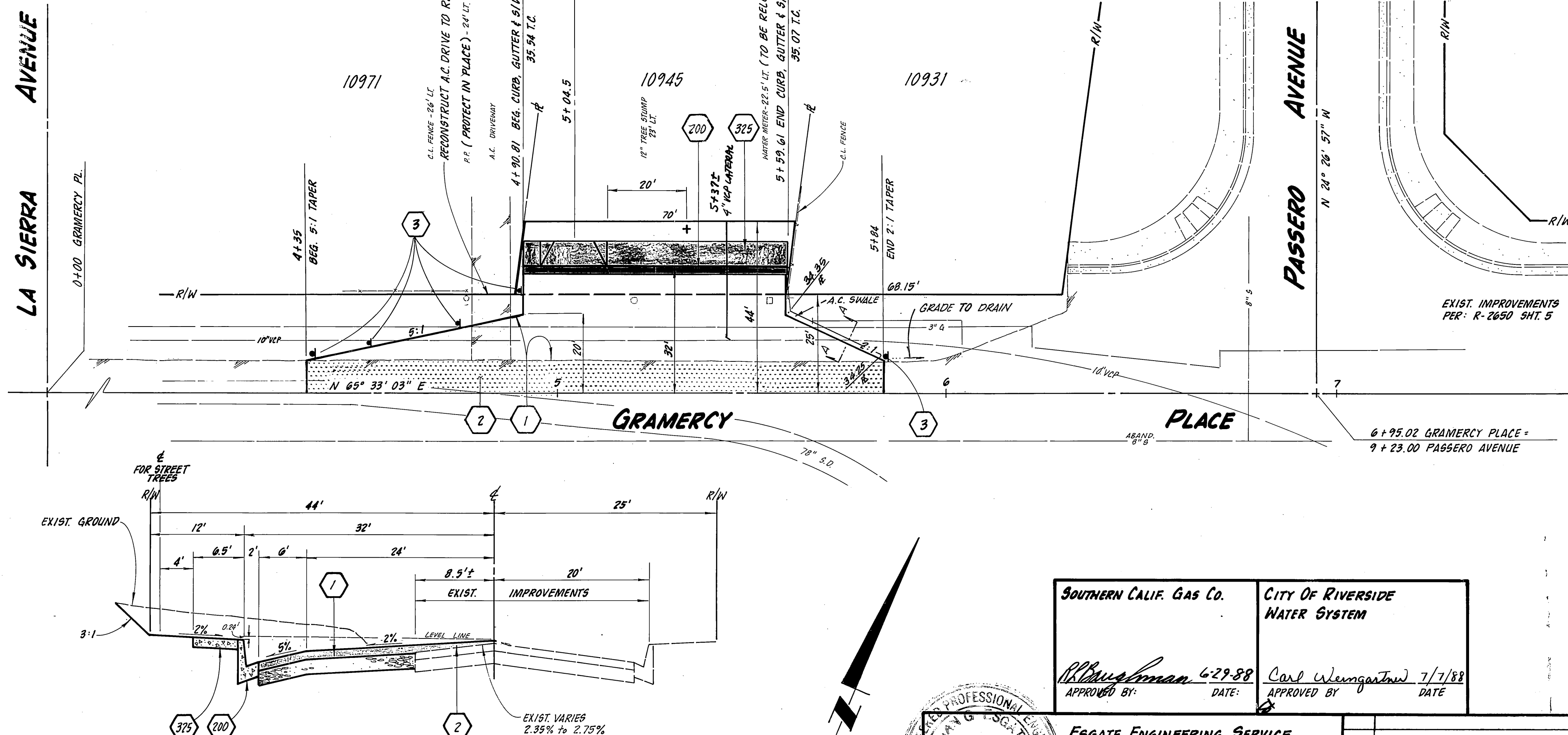

TYPICAL SECTION

NO SCALE
T.I. = 7

GENERAL NOTES

- Construction shall be in accordance with the City of Riverside Department of Public Works, Standard Drawings, Standard Drawing No. 10 and the Standard Specifications for Public Works Construction, current edition.
- It shall be the responsibility of the contractor to clear the right of way in accordance with the provisions of law as it affects each utility including irrigation lines and appurtenances and at no cost to the city.
- The private engineer signing these plans is responsible for assuring the accuracy and acceptability of the work hereon. In the event of discrepancies arising during construction, the private engineer shall be responsible for determining an acceptable solution and revising the plans for approval by the city.
- The developer shall be responsible for preserving or re-establishing and referencing survey monuments destroyed, disturbed or buried as a result of the construction shown hereon.
- All flagged elevations shall be staked in the field by the private engineer.
- Trim edge of existing pavement where new pavement joins to a smooth, straight line. Construct match-up paving as shown on the plan and overlay paving as directed in the field to produce a smooth section.
- In pavement overlay areas, distressed existing pavement shall be removed and replaced as directed by the Inspector prior to overlaying with A.C. paving.
- Curb and gutter shall be staked at 25 ft. intervals with 3 ft. offsets.
- Any traffic control striping obliterated and/or badly worn during construction shall be restored by the contractor within five (5) days after notification from the City Inspectors.
- The contractor shall call in a location request to Underground Service Alert (USA), Phone No. 1-800-422-4113, Two working days before digging. No construction permit will be issued by the Public Works Department involving excavation for underground facilities unless the applicant has been provided an inquiry identification number by U.S.A.
- The contractor shall give the City Water Department five (5) working days written notice prior to the start of construction and allow the City ten (10) working days for completion of any required work.
- FINAL STRIPING FOR TRAFFIC CONTROL AND/OR PAVEMENT MARKING TO BE THE RESPONSIBILITY OF THE DEVELOPER.
- DEVELOPER TO GIVE CITY WATER DIV. FIVE (5) WORKING DAYS WRITTEN NOTICE PRIOR TO START OF CONSTRUCTION & TO ALLOW CITY TEN (10) WORKING DAYS FOR COMPLETION OF WORK. (351-6168)

STREET TREE NOTES

- All related work shall conform to the City of Riverside, Park and Recreation Department Standards.
- Contact the Street Tree Inspector a minimum of 48 hours in advance at 351-6168 to schedule inspections. Inspections shall be required:
 - When plant locations have been spotted in the field prior to digging plant pits.
 - While digging plant pits and planting/relocating trees.
 - After planting and all other indicated or specified work has been completed for start of maintenance.
 - At end of maintenance/final acceptance (contractor/developer will be released from maintenance only upon receipt of written notification from the city that the Park and Recreation Department is assuming maintenance responsibilities).
- The Contractor/Developer shall maintain all plantings for a minimum period of one (1) year.
- Street Tree planting shall be as follows:

Street Name	Botanical Name/Common Name	Min. Size	Approx. Spacing	No. Req.
N. GRAMERCY PL.	PIRUS CALLERYANA / BRADFORD PEAR	15 GA.	45'	1
- Park and Recreation Department and Public Works Department permits are required prior to commencement of tree relocation and/or removal work. For all trees within the ultimate pavement area, backfill of all holes is to be inspected by the City for proper compaction.
- All street trees to be automatically irrigated.
- + INDICATES STREET TREE PLANTING LOCATION.

CONSTRUCTION NOTES

- CONST. 0.25' A.C. PAVING OVER 0.67' C.A.B. (REF: R-2650 & CRSR #1269).
- CONST. VARIABLE THICKNESS OVERLAY OF A.C.
- PLACE TYPE "F-1" DELINEATORS @ 20' O.C.
- CONST. CURB & GUTTER PER STD. DWG. 200, TYPE I, 8" C.F.
- CONST. D/W APPROACH PER STD. DWG. 302, A=10', B=17'.
- CONST. CURB SIDEWALK PER STD. DWG. 325.

SOUTHERN CALIF. GAS CO.

CITY OF RIVERSIDE
WATER SYSTEMAPPROVED BY: *Brian G. Esgate* DATE: 6/14/88APPROVED BY: *Carl W. Wengert* DATE: 7/1/88

ESGATE ENGINEERING SERVICE

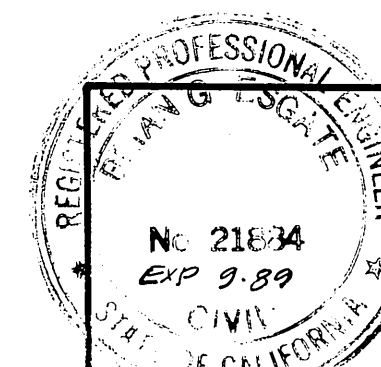
BRIAN G. ESGATE
RCE # 21884CITY OF RIVERSIDE
PUBLIC WORKS DEPARTMENT

APPROVED BY: *Brian G. Esgate* DATE: 6/14/88
PRINCIPAL ENGINEER
TRAFFIC DIVISION
DESIGNED BY: *KE* DRAWN BY: *BKP* CHECKED BY: *KE*

STREET PLAN AND PROFILE
GRAMERCY STREET WIDENING
10945 GRAMERCY PL.
(LOC. 2-825)

ACCOUNT NO.

R-2991

490'± TO 560' E'LY OF LA SIERRA AVENUE ON THE N'LY SIDE
HORIZ. SCALE: 1" = 20' VERT. SCALE: 1" = 2'

SHEET 1 OF 1

CITY TAX # 028877 EXPIRES JULY 1, 1989