

GENERAL CONSTRUCTION NOTES:

- 1 CONSTRUCTION SHALL BE IN ACCORDANCE WITH THE CITY OF RIVERSIDE STANDARD DRAWINGS AND STANDARD SPECIFICATIONS FOR PUBLIC WORKS CONSTRUCTION, 1994 EDITION.
- 2 EXISTING UTILITIES SHOWN ON THE PLAN, ARE PLOTTED FROM UTILITY RECORDS. THE CONTRACTOR IS REQUIRED TO TAKE DUE PRECAUTIONARY MEASURES TO LOCATE AND PROTECT ALL UTILITIES WHETHER OR NOT SHOWN ON THIS PLAN.
- 3 ALL STATIONS & ELEVATIONS SHOWN ON THE PLANS SHALL BE STAKED IN THE FIELD.

SPECIFIC CONSTRUCTION NOTES:

- 1 SAWCUT EXISTING PAVEMENT TO CONSTRUCT 8" HIGH MEDIAN CURB .
- 2 INSTALL 3.5" THICK AC HARDCAPING IN MEDIAN.
- 3 CROSSING GATE ARMS TO BE INSTALLED BY RAILWAY COMPANY.
- 4 WALKWAY AT THE EXISTING MEDIAN SHALL BE 3.5" PCC

CONSTRUCTION LEGEND:

- NUMBERS ABOVE 100 IN A HEXAGON ON THE PLAN REFER TO THE RESPECTIVE STANDARD DRAWING AND SHALL BE CONSTRUCTED ACCORDINGLY, UNLESS MODIFICATIONS ARE NOTED ON THE PLAN. ANY NUMBER SHOWN BELOW THE STANDARD DRAWING NUMBER INDICATES THE SPECIFIC ALTERNATE TO BE CONSTRUCTED.
- CONSTRUCT PCC WHEEL CHAIR RAMP ACCORDING TO STATE STANDARD PLAN ABB-CASE C RAMP WIDTH SHALL EXTEND TO 6 FEET FROM BACK OF CURB.
- CONSTRUCT PCC WHEEL CHAIR RAMP ACCORDING TO CITY STANDARD DWG. 304
- OVERLAY EXISTING PAVEMENT WITH VARIABLE THICKNESS AC 0.08' (MIN.).

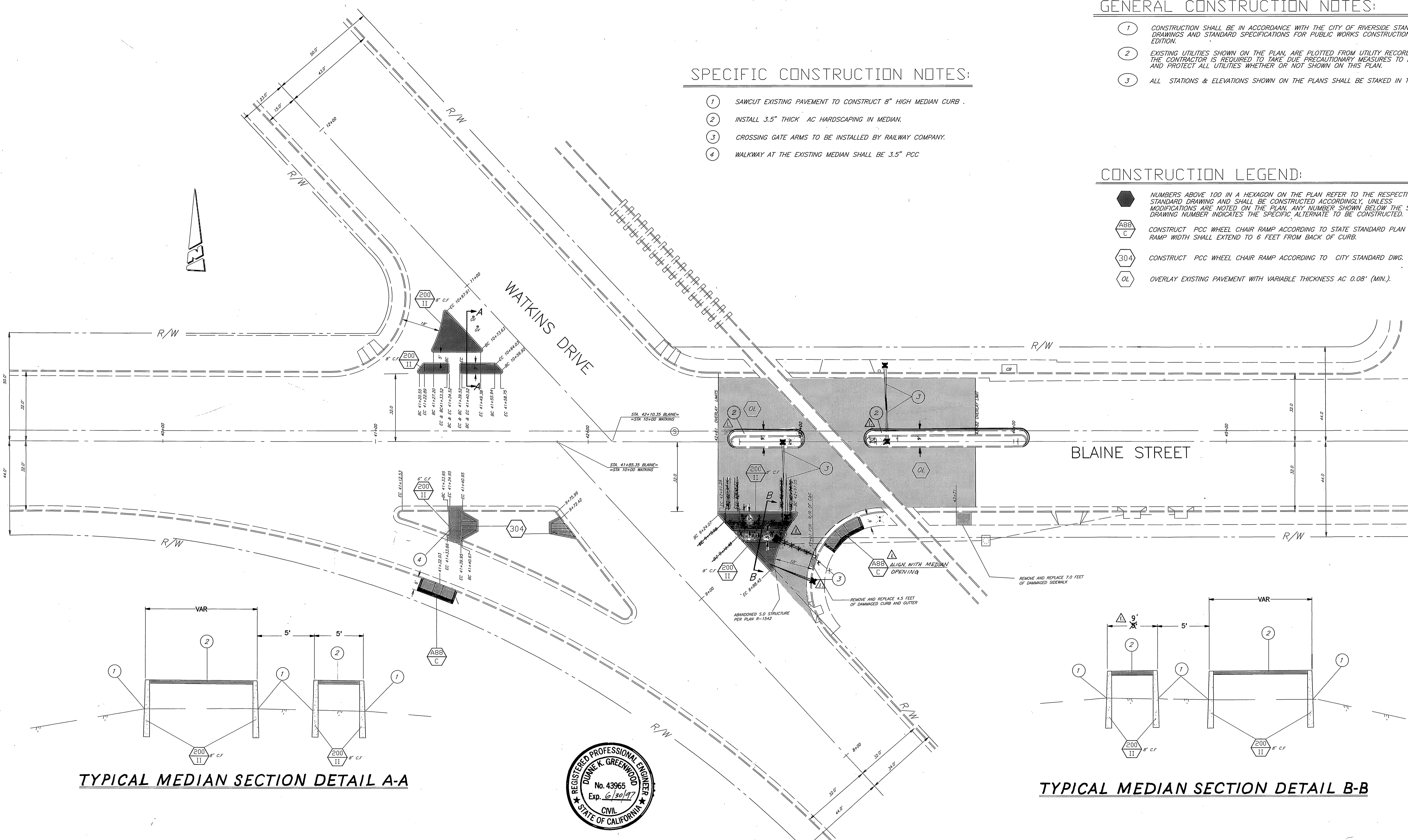

TYPICAL MEDIAN SECTION DETAIL A-A

TYPICAL MEDIAN SECTION DETAIL B-B



BENCHMARK
 B.M. TOP OF 1-1/4" I.P. (SE'LY-SIDE) CL
 INT: BLAINE ST. @ WATKINS DR. N'LY., AS
 PER CITY OF RIV. LL 42 -129.
 ELEVATION: 1093.231

IMPORTANT NOTICE
 Section 4216/4217 of the Government Code
 requires a Dig Alert Identification
 Number to be issued before a
 "Permit to Excavate" will be valid.
 For your Dig Alert I.D. Number call
 CALL TOLL FREE
 TWO WORKING DAYS BEFORE YOU DIG
 UNDERGROUND SERVICE ALERT
 1-800-227-2600

ENGINEER IN RESPONSIBLE CHARGE
 Duane K. Greenwood
 R.C.E. No. 43965 EXPIRES 06/30/97
 DATE 9/24/96

CITY OF RIVERSIDE, CALIFORNIA DEPARTMENT OF PUBLIC WORKS	
APPROVED BY: <i>[Signature]</i> DATE: 9/27/96	APPROVED BY: <i>[Signature]</i> DATE: 9/27/96
PRINCIPAL ENGINEER: <i>[Signature]</i>	DIRECTOR OF PUBLIC WORKS: <i>[Signature]</i>
P.W. INSPECTION: <i>[Signature]</i>	
TRAFFIC DIVISION: <i>[Signature]</i>	
CHEF P.W. ENGR. <i>[Signature]</i>	
PUBLIC UTILITIES: <i>[Signature]</i>	

MEDIAN CONSTRUCTION BLAINE STREET AND WATKINS DRIVE	ACCT. NO. 0430-541600-440222-35016 R-3458 SHEET 1 OF 1 FILE NAME: R3458.DWG
SCALE: 1" = 20'	

CONTRACT 7E-96-B
 INDEXED 7-10-97 4H