

PROJECT LOCATION MAP
N.T.S

GENERAL CONSTRUCTION NOTES:

- 1 CONSTRUCTION SHALL BE IN ACCORDANCE WITH THE CITY OF RIVERSIDE STANDARD DRAWINGS AND STANDARD SPECIFICATIONS FOR PUBLIC WORKS CONSTRUCTION, 2003 EDITION.
- 2 CONFLICTING UTILITIES IN THE CONSTRUCTION AREA SHALL BE RELOCATED BY OTHERS PRIOR TO CONSTRUCTION.
- 3 EXISTING UTILITIES SHOWN ON THE PLANS, ARE PLOTTED FROM UTILITY RECORDS. THE CONTRACTOR IS REQUIRED TO TAKE DUE PRECAUTIONARY MEASURES TO LOCATE AND PROTECT ALL UTILITIES WHETHER OR NOT SHOWN ON THESE PLANS.

CONSTRUCTION NOTES:

- 1 REMOVE INTERFERING PORTION (11") OF EXISTING BLOCK WALL.
- 2 RELOCATE INTERFERING BUSHES TO BEHIND PROPOSED SIDEWALK.
- 3 REMOVE INTERFERING BLOCKS OF EXISTING PLANTERS AND RELOCATE TO BEHIND PROPOSED SIDEWALK.
- 4 REMOVE AND REPLACE EXISTING CURB DRAIN (D=3").
- 5 REMOVE INTERFERING WOOD FENCE SECTION FOR SIDEWALK CONSTRUCTION.
- 6 RELOCATE EXISTING FIRE HYDRANT (BY OTHERS).
- 7 CONSTRUCT PCC RETAINING CURB (H=6" TO 18").

CONSTRUCTION LEGEND:

- NUMBERS ABOVE 100 IN A HEXAGON ON THE PLAN REFER TO THE RESPECTIVE STANDARD DRAWING AND SHALL BE CONSTRUCTED ACCORDINGLY, UNLESS MODIFICATIONS ARE NOTED ON THE PLAN. ANY NUMBER SHOWN BELOW THE STANDARD DRAWING NUMBER INDICATES THE SPECIFIC ALTERNATE TO BE CONSTRUCTED.
- CONSTRUCT PCC WHEELCHAIR RAMP PER STD. DWG 304
- CONSTRUCT PCC DRIVEWAY APPROACH PER STD. DWG 302.
- CONSTRUCT PCC SIDEWALK PER STD. DWG 325.
- REMOVE TREE AS SHOWN ON THE PLANS (BY OTHERS).

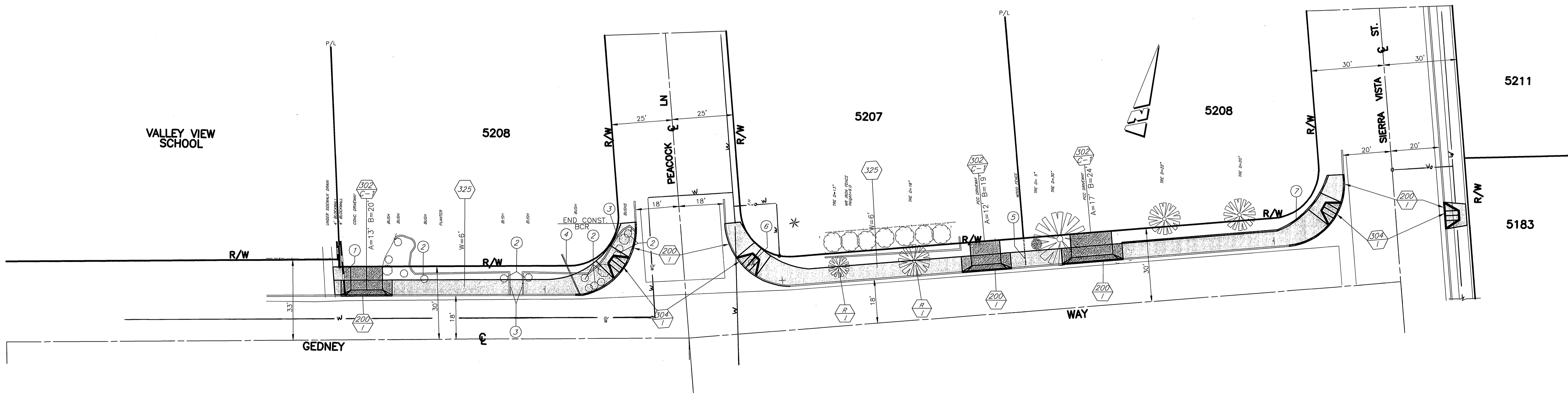

IMPORTANT NOTICE
Section 41164.1 of the Government Code requires a Dig Alert identification Number to be issued before a "Shovel to Excavate" will be voiced. For your Dig Alert ID Number call CALL TOLL FREE 48 HOURS BEFORE YOU DIG UNDERGROUND SERVICE ALERT 1-800-227-2600

ENGINEER IN RESPONSIBLE CHARGE
PHILIP HANNAWI
R.C.E. No. 44747 expires 3/31/2006
DATE 10/28/05

REGISTERED PROFESSIONAL ENGINEER
PHILIP HANNAWI
No. 44747
Exp. 3-31-2006
CIVIL
STATE OF CALIFORNIA

CITY OF RIVERSIDE, CALIFORNIA
PUBLIC WORKS DEPARTMENT

APPROVED BY	BY	DATE
DEPUTY PW DIRECTOR/ENG.	PH	10/28/05
PRINCIPAL ENGINEER		
TRAFFIC DIVISION		
SURVEYOR		
STREET SERVICES		
INSPECTION	DE	10/31/05
PARK & REC. DEPT.		

APPROVED BY
CITY ENGINEER
DATE 10/31/05

DESIGNED BY: ABE DRAWN BY: ABE CHECKED BY:

GEDNEY WAY SIDEWALK CONSTRUCTION
150' WEST OF PEACOCK LN TO SIERRA VISTA STREET

ACCT. NO.: 9586727152 440223xx
R-3893
SHEET 1 OF 1
FILE: COMMON/COMPLETE/R-3893

HORIZ. SCALE: 1" = 20' VERT. SCALE: N/A

INDEXED 2-7-06 LHH