

VICINITY MAP
N.T.S.

GENERAL CONSTRUCTION NOTES

- EXISTING UTILITIES SHOWN ON THIS PLAN ARE PLOTTED FROM UTILITY RECORDS. THE CONTRACTOR IS REQUIRED TO TAKE DUE PRECAUTIONARY MEASURES TO LOCATE AND PROTECT ALL UTILITIES WHETHER OR NOT SHOWN ON THIS PLAN. IF THE COVER OF A UTILITY IS KNOWN, IT IS SHOWN IN THE PROFILE. UTILITIES SHOWN IN THE PROFILE AS INDICATES THAT THE COVER IS UNKNOWN, BUT THE UTILITY IS NOT EXPECTED TO CONFLICT WITH THE PROPOSED IMPROVEMENTS.
- PRIME CONTRACTOR BIDDING THIS WORK SHALL HAVE A CLASS "A" OR "C-12" LICENSE.
- CONSTRUCTION SHALL BE IN ACCORDANCE WITH THE CITY OF RIVERSIDE STANDARD DWGS AND STANDARD SPECIFICATIONS FOR PUBLIC WORKS CONSTRUCTION, LATEST EDITION.

SPECIFIC CONSTRUCTION NOTES

- NUMBERS ABOVE 100 IN A HEXAGON ON THE PLAN REFER TO THE RESPECTIVE STANDARD DRAWING AND SHALL BE CONSTRUCTED ACCORDINGLY. UNLESS MODIFICATIONS ARE NOTED ON THE PLAN OR COVER SHEET. ANY NUMBER SHOWN BELOW THE STANDARD DRAWING NUMBER INDICATES THE SPECIFIC ALTERNATE TO BE CONSTRUCTED.
- ADJUST WATER METER AND VAULT TO GRADE.
- REMOVE EXISTING TREE IN CONFLICT WITH CONSTRUCTION.
- CONSTRUCT 6' WIDE PCC SIDEWALK PER STD. DWG 325.
- INSTALL CURB-1 TYPE DRIVEWAY APPROACH PER PLAN.
- REMOVE AND REPLACE BUS STOP BENCH AFTER CONSTRUCTION.
- REMOVE AND REPLACE BUS STOP SIGN AFTER CONSTRUCTION.
- REMOVE EXISTING CURB IN CONFLICT WITH CONSTRUCTION OF HANDICAP RAMP.
- RELOCATE EXISTING WATER METER AND VAULT TO WITHIN R/W AND ADJUST TO GRADE.
- CONSTRUCT PCC WHEELCHAIR RAMP PER STD. DWG 304.
- REMOVE EXISTING WALL AS SHOWN ON PLAN.
- RELOCATE EXISTING STEPS TO BEHIND THE R/W.
- RELOCATE EXISTING FENCE TO BEHIND THE R/W.
- RELOCATE EXISTING PORCH LAMP TO BEHIND THE R/W.
- RELOCATE EXISTING ROSE BUSHES TO BEHIND THE R/W.
- CONSTRUCT RETAINING WALL BEHIND R/W PER STD. DWG. 707.
- CONSTRUCT FREESTANDING CONCRETE BLOCK WALL BEHIND R/W PER STD. DWG. 704.

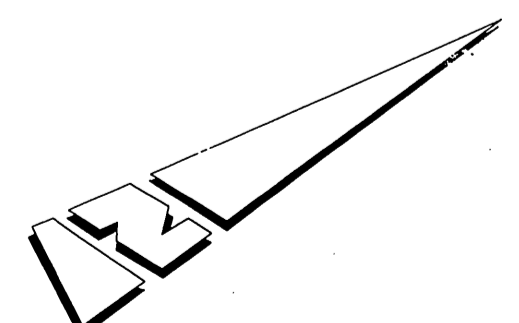
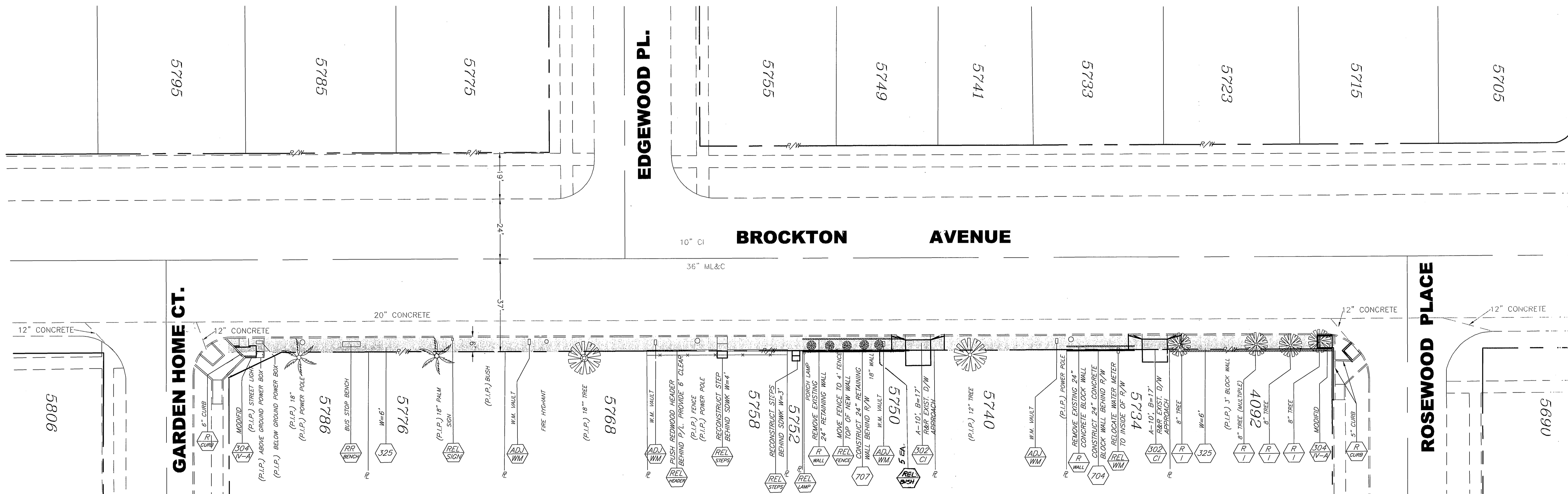

ENGINEER IN RESPONSIBLE CHARGE

 PHILIP L. HANNAWI
 R.C.E. No. 44747 expires 3/31/06
 DATE 3/14/06

REGISTERED PROFESSIONAL ENGINEER
 PHILIP L. HANNAWI
 No. 44747
 Exp. 3-31-2006
 CIVIL
 STATE OF CALIFORNIA

MARK	REVISIONS	APPR.	DATE

DESIGNED BY CS DRAWN BY CS CHECKED BY PH

CITY OF RIVERSIDE, CALIFORNIA
 PUBLIC WORKS DEPARTMENT

APPROVED BY

 PHILIP L. HANNAWI
 CIVIL ENGINEER

DATE 3/15/06

BROCKTON AVE.
 IMPROVEMENTS
 GARDEN HOME COURT TO
 ROSEWOOD PLACE

HORIZ. SCALE: 1" = 20' VERT. SCALE: N/A

ACCT. NO.: 11000-XXXX

R-3904

SHEET 1 OF 1

FILE NO.: