

GENERAL CONSTRUCTION NOTES:

- 1 THE CONTRACTOR SHALL PROVIDE AND MAINTAIN TRAFFIC AS INDICATED IN THE ASSOCIATED PROJECT SPECIAL PROVISIONS.
- 2 CONSTRUCTION SHALL BE IN ACCORDANCE WITH THE CITY OF RIVERSIDE STANDARD DRAWINGS AND STANDARD SPECIFICATIONS FOR PUBLIC WORKS CONSTRUCTION, 2012 EDITION.
- 3 EXISTING UTILITIES SHOWN ON THIS PLAN ARE PLOTTED FROM UTILITY RECORDS. THE CONTRACTOR IS REQUIRED TO TAKE DUE PRECAUTIONARY MEASURES TO LOCATE AND PROTECT ALL UTILITIES WHETHER OR NOT SHOWN ON THIS PLAN.
- 4 ALL STREET PULL BOXES, AFFECTED BY CONSTRUCTION, SHALL BE ADJUSTED TO THE PROPOSED GRADE.
- 5 PRIME CONTRACTOR BIDDING THIS WORK SHALL HAVE A CLASS "A" OR "C-12".
- 6 THE SEAM BETWEEN PASSES OF THE AC OVERLAY SHALL COINCIDE, AS CLOSE AS POSSIBLE, TO THE LANE LINES.
- 7 COLD MILLING SHALL BE AS DESCRIBED ON THE PLANS AND SPECIAL PROVISIONS OR AS DIRECTED BY THE ENGINEER.
- 8 ANY DISTRESSED EXISTING PAVEMENT SHALL BE REMOVED AND REPLACED AS DIRECTED BY THE ENGINEERING AFTER COLD-MILLING AND PRIOR TO PLACEMENT OF DGAC.
- 9 CONTRACTOR SHALL REMOVE ALL VEGETATION AND CLEAR ALL DIRT WITHIN ALL SIDEWALK PANELS WITHIN THE PROJECT LIMITS.
- 10 ALL EXISTING IMPROVEMENTS SHOWN HEREON SHALL BE PROTECTED IN PLACE UNLESS OTHERWISE NOTED.
- 11 EXISTING IRRIGATION SHALL BE PROTECTED OR MODIFIED AS NECESSARY TO CONSTRUCT NEW CONCRETE IMPROVEMENTS.
- 12 SEE STRIPING & TRAFFIC SIGNAL PLANS FOR REMOVAL, REPLACEMENT, AND RELOCATION OF EXISTING SIGNING, STRIPING, LOOPS, AND TRAFFIC EQUIPMENT.

CONSTRUCTION NOTES:

- REMOVE AND REPLACE IN KIND EXISTING FACILITY, NUMBERS ABOVE 100 IN A HEXAGON ON THE PLAN REFER TO THE RESPECTIVE STANDARD DRAWING AND SHALL BE CONSTRUCTED ACCORDINGLY. ANY NOTE SHOWN BELOW THE STANDARD DRAWING NUMBER INDICATES THE SPECIFIC TYPE, ACTION, OR MODIFICATION TO BE CONSTRUCTED. WHERE NO MODIFICATION OR TYPE IS INDICATED, THE DIMENSIONS OF NEW FACILITY SHALL BE MODIFIED AS NECESSARY, EXCLUDING ADA REQUIREMENTS, TO MATCH EXISTING FACILITY REMOVED.
- ADJ.** ADJUST TO GRADE, DESCRIPTION PER PLAN. (MH) ELECTRIC, TELEPHONE, SEWER OR STORM DRAIN. (GV) GATE VALVE. (ETS) ELECTRIC TEST STATION. (WM) WATER METER. (PB) PULLBOX. (VLT) ELECTRIC OR WATER VAULT, TYPE PER PLAN.
- PIP** PROTECT IN PLACE, DESCRIPTION PER PLAN. (MH) SEWER OR STORM DRAIN. (GV) GATE VALVE. (WM) WATER METER. (PB) PULLBOX. (SL) STREET LIGHT. (TR) TRAFFIC SIGNAL EQUIPMENT. (TRE) TREE. (DWY) DRIVEWAY. (CO) CLEANOUT. (CB) CATCH BASIN. (MED) MEDIAN.
- REM** REMOVE EXISTING IMPROVEMENT. (TR) REMOVE EXISTING TRAFFIC SIGNAL EQUIPMENT INCLUDING PULLBOX, CONDUIT, AND CONDUCTORS AS NECESSARY. (CRB) REMOVE EXISTING MEDIAN CURB AND STAMPED CONCRETE AS NECESSARY IN ORDER TO BUILD NEW MEDIAN.
- R&R DWY** RECONSTRUCT HALF OF EXISTING CONCRETE DRIVEWAY UTILIZING EXISTING WING DIMENSIONS AND SLOPES.
- 200** CONSTRUCT/RECONSTRUCT PCC CURB AND GUTTER PER CITY STANDARD 200 MATCHING THE EXISTING TYPE AND HEIGHT.
 - I-X" = TYPE I WITH X" CURB FACE.
 - II = TYPE II WITH 8" CURB FACE.
 - M1 = CONSTRUCT NEW TYPE I CURB (8") WITH CURB RADIUS OF 15'.
- 220** CONSTRUCT/RECONSTRUCT CROSS GUTTER PER CITY STANDARD 220.
- 302** CONSTRUCT/RECONSTRUCT DRIVEWAY APPROACH PER CITY STANDARD 302. ("---" AS FOLLOWS):
 - PL1= TYPE PL-I; PL2= TYPE PL-II;
 - C1= TYPE CURB-I; C2= TYPE CURB-II;
 - M1= RECONSTRUCT HALF OF TYPE CURB-1 DRIVEWAY APPROACH FROM JOINT LINES.
- 304** CONSTRUCT/RECONSTRUCT WHEELCHAIR RAMP PER CITY STANDARD 304. ("---" AS FOLLOWS):
 - I=TYPE I; II= TYPE II; III= TYPE III;
 - M1= CONSTRUCT MODIFIED TYPE III RAMP, MODIFY/EXTEND IRRIGATION AND LANDSCAPING FOR NEW RETAINING CURBS.
 - M2= CONSTRUCT TYPE II RAMP, MODIFIED TO ROTATE ALONG RETURN AS NECESSARY TO PROVIDE 4' WIDE LANDING WITHIN PUBLIC R/W AND TO CONSTRUCT RETAINING CURB TO ELIMINATE NORTHERLY WING.
- 325** CONSTRUCT/RECONSTRUCT PCC SIDEWALK PER CITY STANDARD 325.
- 405 M1** CONSTRUCT NEW CATCH BASIN TOP PER CITY STANDARD 405.
 - M1 = SAWCUT AND REMOVE THE TOP 24" OF THE EXISTING CATCH BASIN. PROTECT IN PLACE THE EXISTING R.C.P. CONNECTION AND MAINTAIN EXISTING "V" DEPTH. DOWEL INTO EXISTING BOX WALLS AND INSTALL NEW REBAR. INSTALL WITH NEW CURB AND GUTTER.
- MED** CONSTRUCT MEDIAN NOSE WITH RADIUS AS SHOWN ON PLANS. MEDIAN AT TRAUTWEIN AVENUE AND JESSE LANE SHALL BE CONSTRUCTED PER CITY STANDARD 121 (TYPE III). CONSTRUCT 3.5" THICK COLORED STAMPED CONCRETE AS SHOWN ON PLANS. COLOR AND PATTERN SHALL MATCH EXISTING MEDIAN. REMOVE AND RECONSTRUCT EXISTING STAMPED CONCRETE AS NECESSARY TO MEET EXISTING JOINS.
- CM1** 0.12' DEEP MIN. LINEAR COLD MILL OF EXISTING AC PAVEMENT. ("---" AS FOLLOWS):
 - --- = WIDTH(FEET) OF LINEAR COLD MILL AS INDICATED ON PLANS
- CM2** VARIABLE AREA COLD MILL OF EXISTING AC PAVEMENT. ("---" AS FOLLOWS):
 - --- = DEPTH(FEET) OF VARIABLE AREA COLD MILL.
- CM3** VARIABLE AREA COLD MILL OF EXISTING AC PAVEMENT AT VARIOUS DEPTHS.
 - FD = FULL DEPTH COLD MILL TO REMOVE EXISTING PAVEMENT SECTION DOWN TO BASE MATERIAL.
- DG** OVERLAY EXISTING PAVEMENT WITH DGAC PAVEMENT AS DESCRIBED. ("---" AS FOLLOWS):
 - 0.13' OR 0.25' = DEPTH (FT) OF DGAC OVERLAY BETWEEN EDGES OF PAVEMENT OR AS OTHERWISE INDICATED ON PLAN.
 - M1 = OVERLAY VARIABLE AMOUNT (0.5' MAXIMUM) OF DGAC OVERLAY FROM EASTERLY EP TO NEW CENTERLINE TO ACHIEVE 3% CROSSFALL AND TO PROVIDE A SMOOTH TRANSITION FROM INTERSECTION.
 - FD = REPLACEMENT OF EXISTING PAVEMENT SECTION WITH FULL DEPTH DGAC OVER NATIVE SOIL/BASE. NATIVE SOIL AND/OR BASE SHALL BE REMOVED AND COMPACTED AS NECESSARY TO INSTALL 0.5' MIN. REPLACEMENT PAVEMENT SECTION.
- OL 0.12** OVERLAY EXISTING PAVEMENT WITH 0.12' MIN. DEPTH (FT) ARHM OVERLAY BETWEEN EDGES OF PAVEMENT OR AS OTHERWISE INDICATED ON PLAN.
- S1** 0.88' DGAC OVER NATIVE SOIL WITH 0.12' MINIMUM DEPTH ARHM OVERLAY. EXISTING PAVEMENT AND NATIVE SOIL SHALL BE REMOVED AND COMPACTED AS NECESSARY TO INSTALL NEW 1.0' MIN. PAVEMENT SECTION. ("---" AS FOLLOWS):
 - M1 = REMOVE 805' (4,850 SF) OF EXISTING MEDIAN AND REPLACE WITH NEW PAVEMENT SECTION
 - M2 = REMOVE 50' (90 SF) OF EXISTING MEDIAN AND REPLACE WITH NEW PAVEMENT SECTION.
 - M3 = REMOVE 300' (1,120 SF) OF EXISTING MEDIAN AND REPLACE WITH NEW PAVEMENT SECTION
- SLR** CONSTRUCT TYPE II SLURRY SEAL AS INDICATED ON PLAN.
- BUS** CONSTRUCT 60' LONG BY 12' WIDE CONCRETE BUS PAD (BUS PAD WIDTH MEASURED FROM MONOLITHIC CURB FACE), UNLESS OTHERWISE INDICATED ON PLANS. BASE OR SUBGRADE OR EXISTING PAD SHALL BE REMOVED AND COMPACTED AS NECESSARY TO INSTALL BUS PAD PER DETAIL IN PART 10 OF THE SPECIFICATIONS. ENGINEER SHALL BE NOTIFIED PRIOR TO POURING NEW CONCRETE.

RIVERSIDE

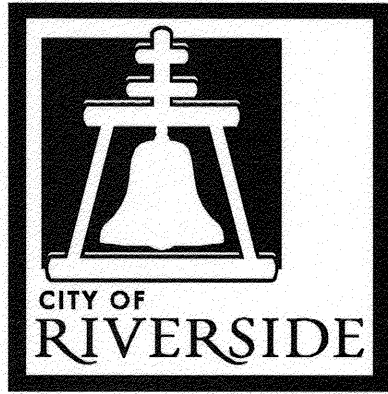

CALIFORNIA

PUBLIC WORKS DEPARTMENT

2013/2014 ARTERIAL STREETS MAINTENANCE
PHASE 2

TRAUTWEIN ROAD, COLE AVENUE,
CALIFORNIA AVENUE, AND CENTRAL AVENUE

LOCATION 1 MAP / SHEET INDEX
TRAUTWEIN ROAD (ALESSANDRO - VAN BUREN) & COLE AVENUE (VAN BUREN - KRAMERIA)
N.T.S.

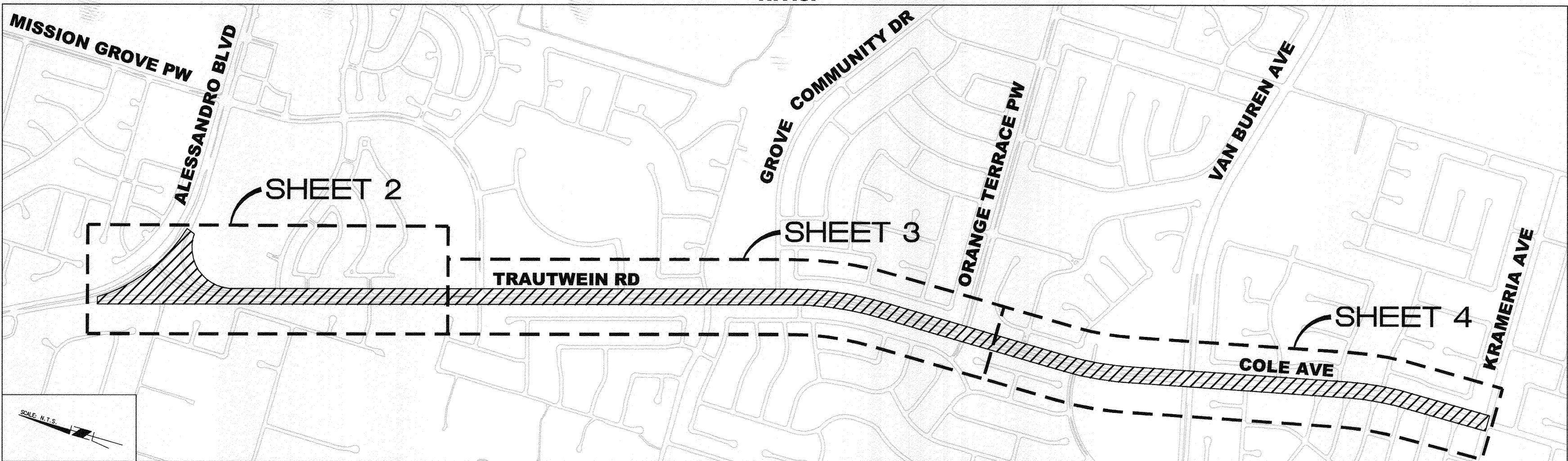

LOCATION 2 MAP / SHEET INDEX
CALIFORNIA AVENUE (TYLER - VAN BUREN)
N.T.S.

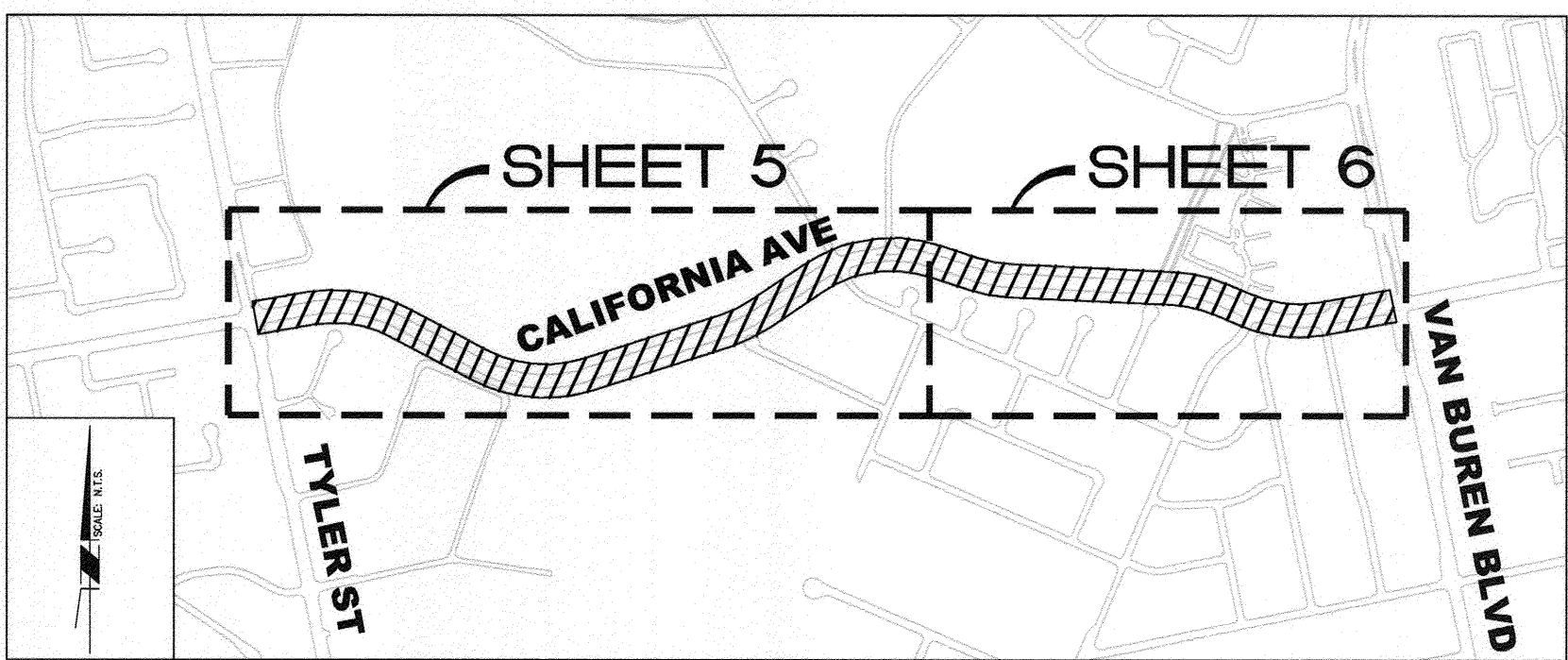

LOCATION 3 MAP / SHEET INDEX
CENTRAL AVENUE (CANYON CREST - CANYON CREEK)
N.T.S.

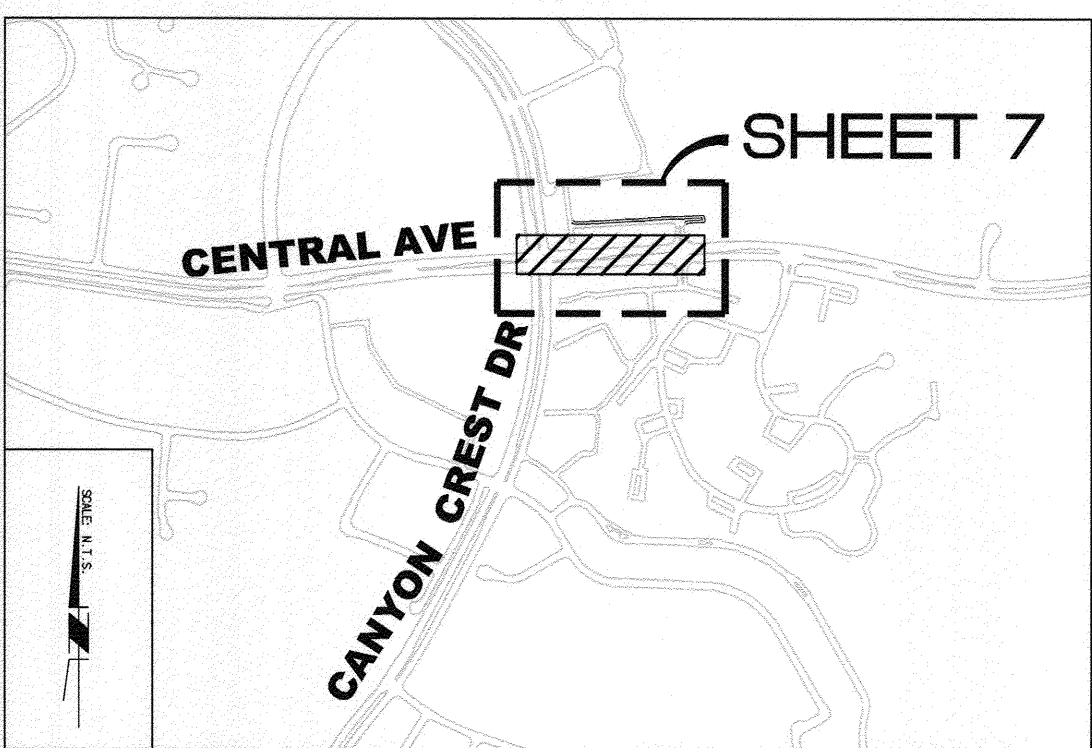

LOCATION MAP LEGEND
PROJECT LOCATION
SHEET LIMITS

CONSTRUCTION LEGEND:

- CM1 COLDMILL TYPE CM1 & 0.12' ARHM OVERLAY
- CM2/DG AND/OR OL COLDMILL TYPE CM2, NEW DGAC PAVEMENT (DEPTH PER PLAN) & 0.12' ARHM OVERLAY
- CM3/DG FULL DEPTH COLDMILL (0.50' MIN.) TYPE CM3, NEW DGAC PAVEMENT (0.50' MIN.) & 0.12' ARHM OVERLAY
- SLR TYPE II SLURRY SEAL
- S1 0.88' DGAC OVER NATIVE & 0.12' ARHM OVERLAY
- PROPOSED CONCRETE SURFACE

EXISTING TOPOGRAPHY:

- SANITARY SEWER M.H.
- STORM DRAIN M.H.
- ELECTRIC M.H.
- WATER M.H.
- GATE VALE
- ELECTRIC STRUCTURES
- FIRE HYDRANT
- ELECTROLYSIS TEST STATION
- POWER POLE/STREET LIGHT

STREET IMPROVEMENT PLAN INDEX (R-4253)

SHEET NO.	DESCRIPTION
1	TITLE SHEET AND NOTES
2	TRAUTWEIN RD (ALESSANDRO - WINDY)
3	TRAUTWEIN RD (MISSION GROVE - ORANGE TERRACE)
4	TRAUTWEIN RD/COLE AVE (MT WASTACH - KRAMERIA)
5	CALIFORNIA AVE (TYLER - 300' E/O CALMHILL)
6	CALIFORNIA AVE (300' E/O CALMHILL - VAN BUREN)
7	CENTRAL AVE (CANYON CREST - CANYON CREEK)

STRIPING PLAN INDEX (XL-716, XL-717 & XL-718)

PLAN NO.	# OF SHEETS	DESCRIPTION
XL-716	5	TRAUTWEIN RD/COLE AVE (ALESSANDRO - KRAMERIA)
XL-717	2	CALIFORNIA AVE (TYLER - VAN BUREN)
XL-718	1	CENTRAL AVE (CANYON CREST - CANYON CREEK)

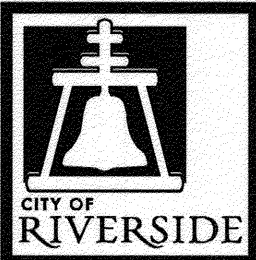

ENGINEER IN RESPONSIBLE CHARGE
Edward Lara
R.C.E. No. 63753 EXPIRES: 9-30-14
DATE March 14, 2014

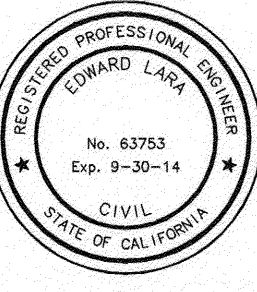

MARK	REVISIONS	APPR.	DATE
DESIGNED BY	RO	DRAWN BY	RO
CHECKED BY	EL		

CITY OF RIVERSIDE, CALIFORNIA DEPARTMENT OF PUBLIC WORKS			
APPROVED BY	BY	DATE	APPROVED BY
ENGINEERING MANAGER	Em	3-17-14	City Engineer
CONSTRUCTION ADMIN.	DC	3-18-14	
TRAFFIC DIVISION	St	3-18-14	
SURVEY	AS	3-17-14	
STREETS			

STREET MAINTENANCE		DESIGN WORK ORDER NO.: 1321927
2013/2014 ARTERIAL STREETS MAINTENANCE		CONSTR. WORK ORDER NO.: 1406215
TRAUTWEIN, COLE, CALIFORNIA, AND CENTRAL		R-4275
TITLE SHEET AND NOTES		SHEET 1 OF 7
HORIZ. SCALE: NA	VERT. SCALE: NA	FILE NAME: R4275-01.DWG

INDEXED 10-21-15 DC

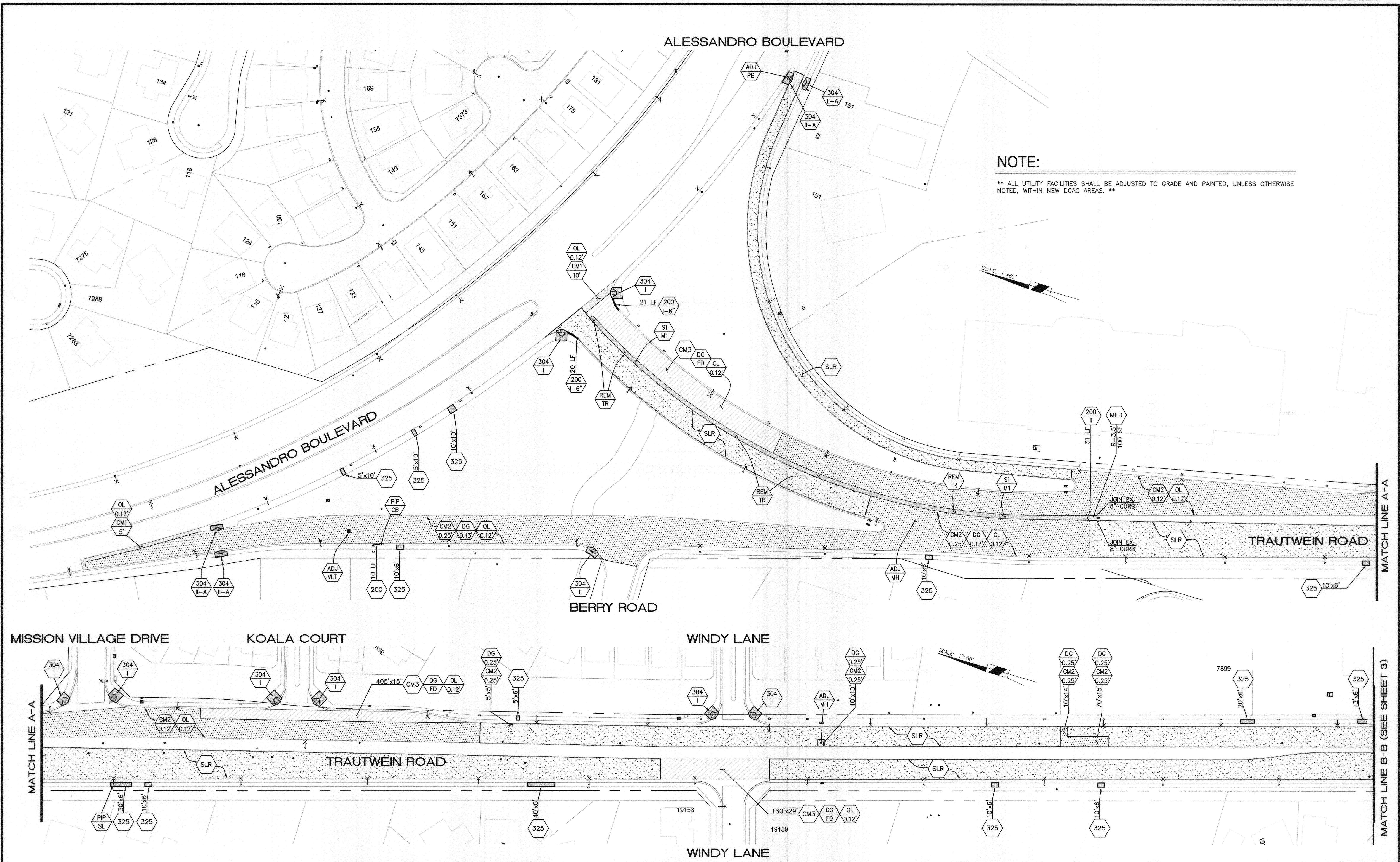

NOTE:
 ** ALL UTILITY FACILITIES SHALL BE ADJUSTED TO GRADE AND PAINTED, UNLESS OTHERWISE NOTED, WITHIN NEW DGAC AREAS. **

SCALE: 1"=60'

SCALE: 1"=60'

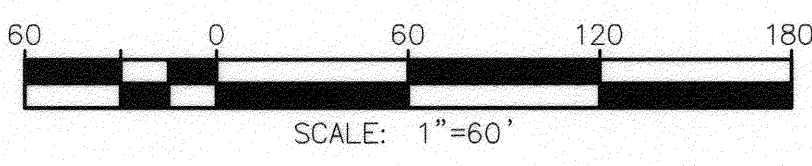

 CITY OF RIVERSIDE Under Ground Service Alert of Southern California Call: TOLL FREE 1-800-227-2600 TWO WORKING DAYS BEFORE YOU DIG	 ENGINEER IN RESPONSIBLE CHARGE Edward Lara R.C.E. No. 63753 EXPIRES: 9-30-14 DATE: March 14, 2014	CITY OF RIVERSIDE, CALIFORNIA DEPARTMENT OF PUBLIC WORKS				STREET MAINTENANCE 2013/2014 ARTERIAL STREETS MAINTENANCE TRAUTWEIN, COLE, CALIFORNIA, AND CENTRAL TRAUTWEIN RD (ALESSANDRO-WINDY) HORIZ. SCALE: 1"=60' VERT. SCALE: NA		DESIGN WORK ORDER NO.: 1321927 CONSTR. WORK ORDER NO.: 1406215 R-4275 SHEET 2 OF 7 FILE NAME: R4275-02.DWG
		APPROVED BY: <i>[Signature]</i> ENGINEERING MANAGER CONSTRUCTION ADMIN.	BY: <i>[Signature]</i> DATE: 3-13-14 3-13-14 3-13-14	APPROVED BY: <i>[Signature]</i> CITY ENGINEER DATE: 3/10/2014				
		TRAFFIC DIVISION SURVEY	160'x29' CM3 DG FD OL 0.12 19159					
		DESIGNED BY: RO DRAWN BY: RO CHECKED BY: EL						

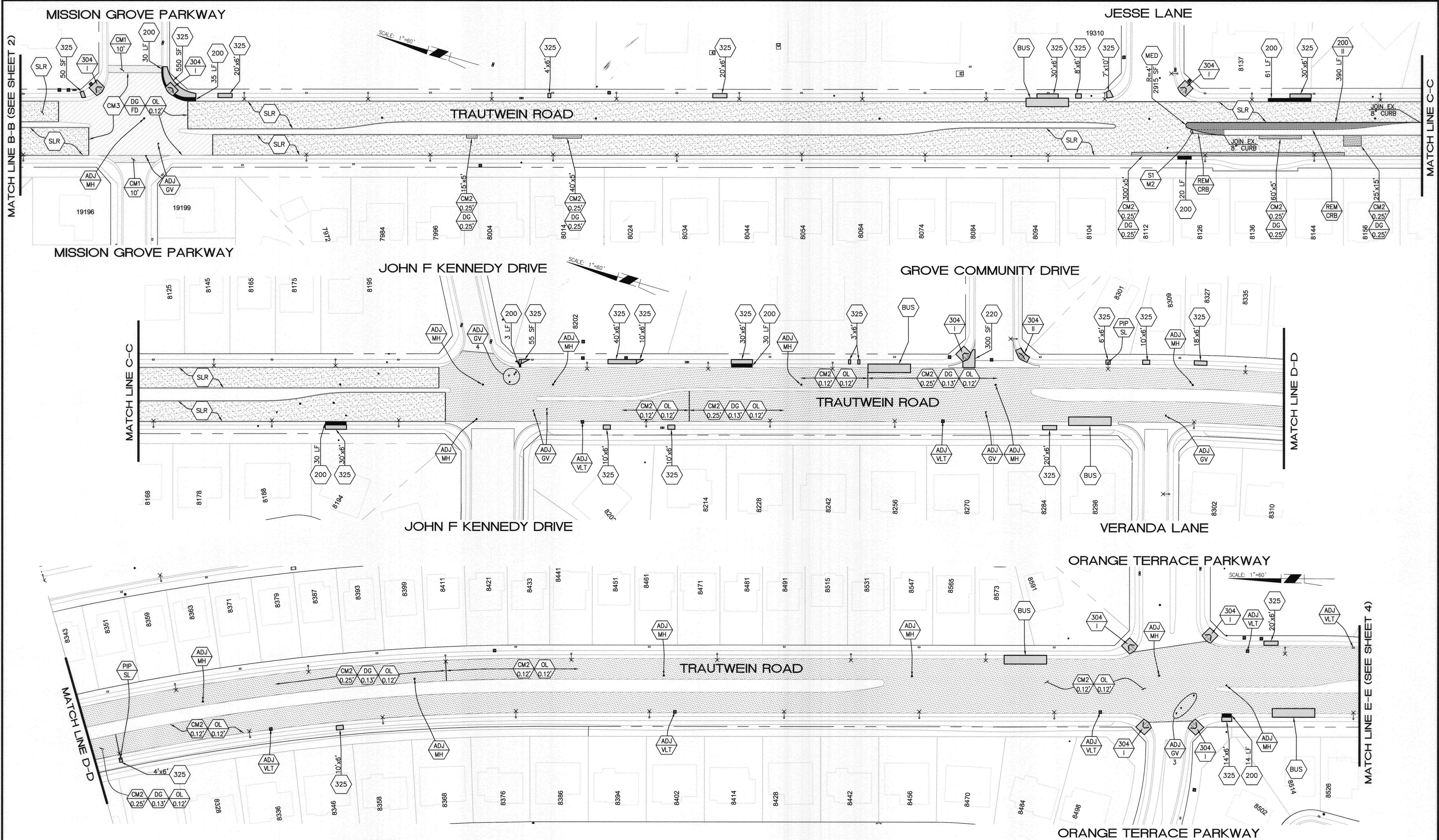

NOTE:

** ALL UTILITY FACILITIES SHALL BE ADJUSTED TO GRADE AND PAINTED, UNLESS OTHERWISE NOTED, WITHIN NEW DGAC AREAS. **

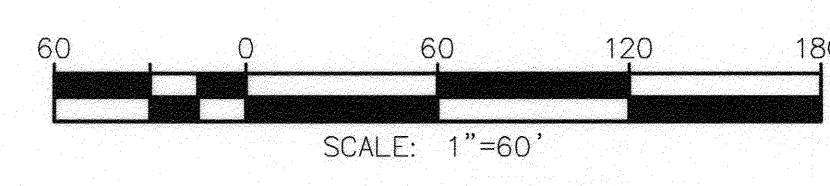

Under Ground Service Alert
of Southern California
Call: TOLL FREE
1-800
227-2600
TWO WORKING DAYS BEFORE YOU DIG

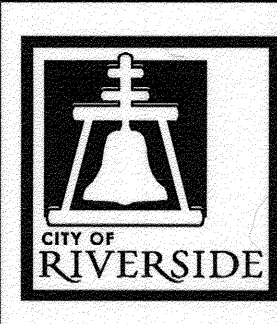

ENGINEER IN RESPONSIBLE CHARGE
Edward Lara
Edward Lara
R.C.E. No. 63753 EXPIRES: 9-30-14
DATE: *March 14, 2014*

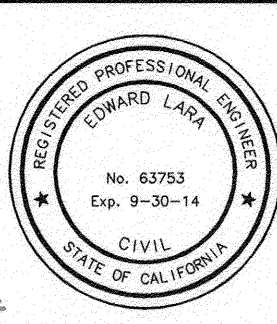

MARK	REVISIONS	APPR.	DATE

CITY OF RIVERSIDE, CALIFORNIA DEPARTMENT OF PUBLIC WORKS			
APPROVED BY	BY	DATE	APPROVED BY
ENGINEERING MANAGER	<i>DC</i>	<i>3/13/14</i>	<i>[Signature]</i>
CONSTRUCTION ADMIN.	<i>DC</i>	<i>3-18-14</i>	CITY ENGINEER
TRAFFIC DIVISION	<i>DC</i>	<i>3-18-14</i>	
SURVEY	<i>DC</i>	<i>3-17-14</i>	DATE: <i>3/20/2014</i>
STREETS			

STREET MAINTENANCE	
2013/2014 ARTERIAL STREETS MAINTENANCE	
TRAUTWEIN, COLE, CALIFORNIA, AND CENTRAL	
TRAUTWEIN RD (MISSION GROVE-ORANGE TERRACE)	
HORIZ. SCALE: 1"=60'	VERT. SCALE: NA

DESIGN WORK ORDER NO.: 1321927	CONSTR. WORK ORDER NO.: 1406215
R-4275	
SHEET 3	OF 7
FILE NAME: R4275-03.DWG	

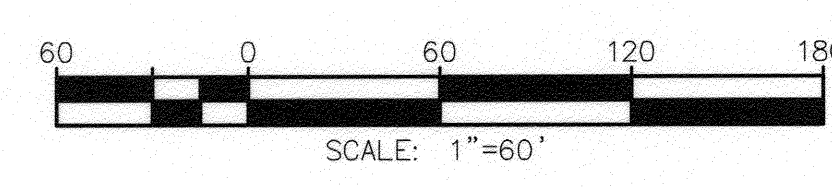
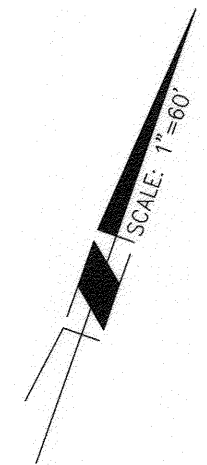
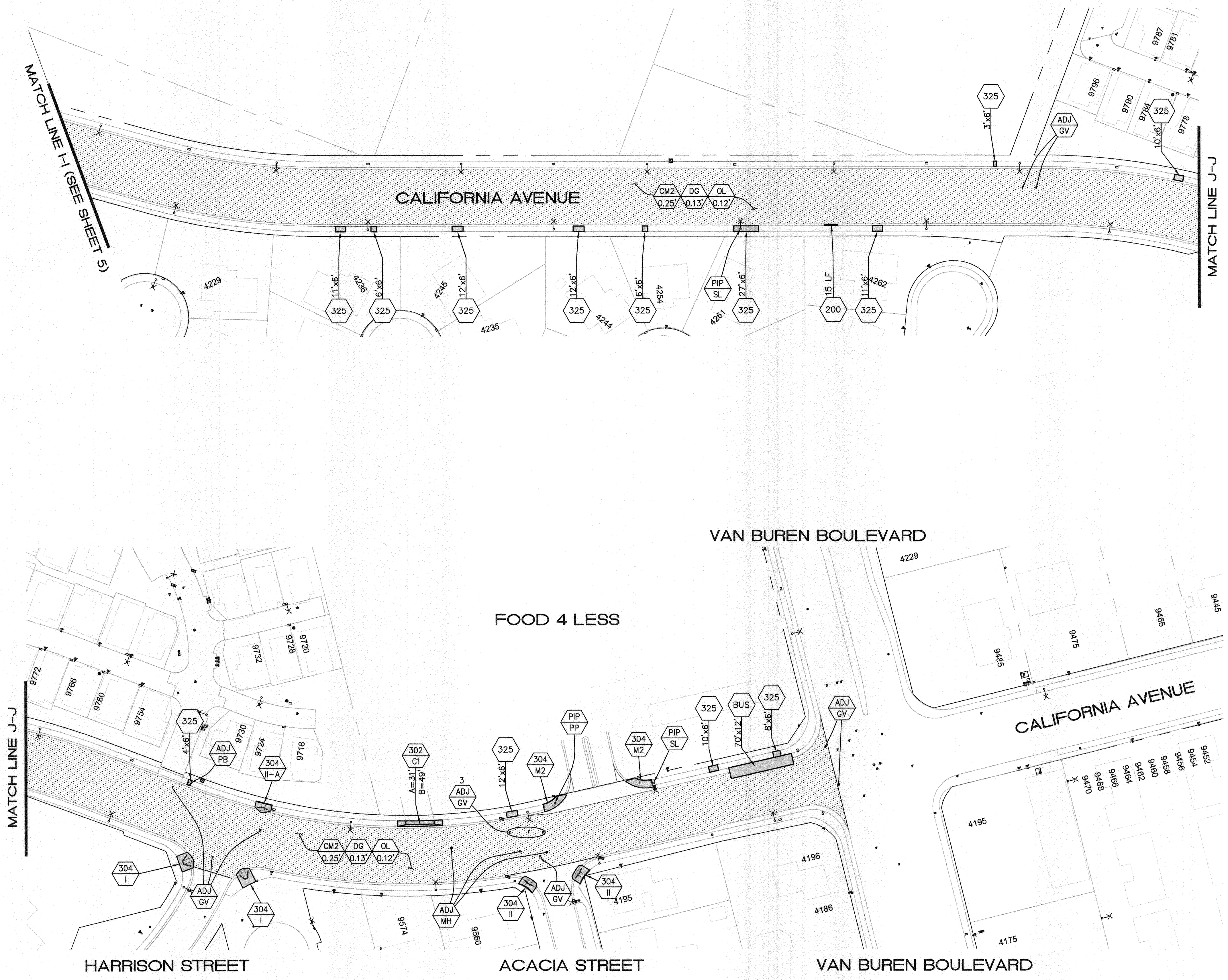

NOTE:

** ALL UTILITY FACILITIES SHALL BE ADJUSTED TO GRADE AND PAINTED, UNLESS OTHERWISE NOTED, WITHIN NEW DGAC AREAS. **

Under Ground Service Alert of Southern California
Call: TOLL FREE 1-800 227-2600
TWO WORKING DAYS BEFORE YOU DIG

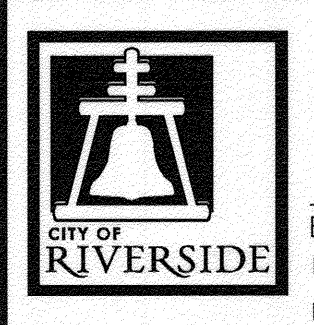

ENGINEER IN RESPONSIBLE CHARGE
Edward Lara
Edward Lara
R.C.E. No. 63753 EXPIRES: 9-30-14
DATE: March 14, 2014

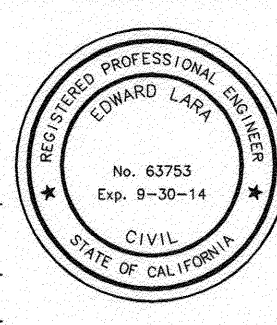

MARK	REVISIONS	APPR.	DATE

CITY OF RIVERSIDE, CALIFORNIA DEPARTMENT OF PUBLIC WORKS			
APPROVED BY	BY	DATE	APPROVED BY
ENGINEERING MANAGER	<i>Fm</i>	3/17/14	<i>David Sped</i>
CONSTRUCTION ADMIN.	<i>dc</i>	3-18-14	CITY ENGINEER
TRAFFIC DIVISION	<i>st</i>	3-18-14	
SURVEY	<i>cs</i>	3-19-14	DATE: <u>3/20/2014</u>
STREETS			

STREET MAINTENANCE
2013/2014 ARTERIAL STREETS MAINTENANCE
TRAUTWEIN, COLE, CALIFORNIA, AND CENTRAL
CALIFORNIA AVE (300' E/O CALMHILL - VAN BUREN)
HORIZ. SCALE: 1"=60' VERT. SCALE: NA

DESIGN WORK ORDER NO.: 1321927
CONSTR. WORK ORDER NO.: 1406215
R-4275
SHEET **6** OF **7**
FILE NAME: R4275-06.DWG

CANYON CREST DRIVE

DAFFODIL DRIVE
(PRIVATE)

CENTRAL AVENUE

CANYON CREST DRIVE

CANYON CREEK DRIVE
(PRIVATE)

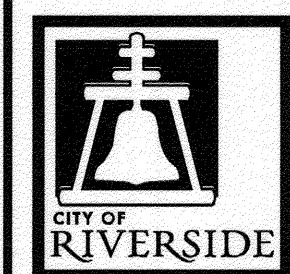
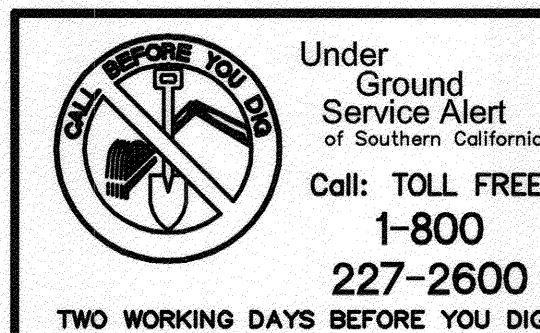
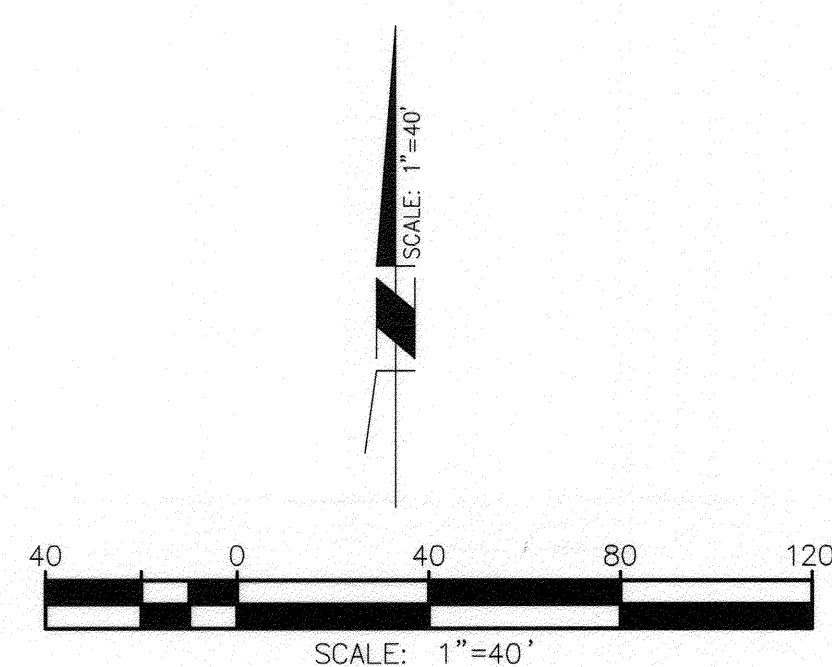

ENGINEER IN
RESPONSIBLE CHARGE
Edward Lara
Edward Lara
R.C.E. No. 63753 EXPIRES: 9-30-14
DATE *March 14, 2014*

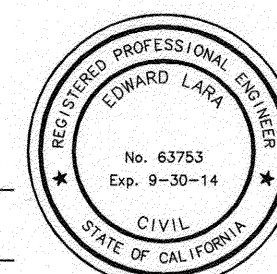

MARK	REVISIONS	APPR.	DATE
DESIGNED BY	RO	DRAWN BY	RO
CHECKED BY	EL		

CITY OF RIVERSIDE, CALIFORNIA
DEPARTMENT OF PUBLIC WORKS

APPROVED BY	BY	DATE	APPROVED BY	BY	DATE
ENGINEERING MANAGER	<i>FM</i>	<i>3-17-14</i>	CITY ENGINEER	<i>[Signature]</i>	<i>3-18-14</i>
CONSTRUCTION ADMIN.	<i>DC</i>	<i>3-18-14</i>			
TRAFFIC DIVISION	<i>SH</i>	<i>3-18-14</i>			
SURVEY	<i>CS</i>	<i>3-19-14</i>			
STREETS					

STREET MAINTENANCE
2013/2014 ARTERIAL STREETS
MAINTENANCE
TRAUTWEIN, COLE, CALIFORNIA,
AND CENTRAL
CENTRAL AVE (CANYON CREST - CANYON CREEK)
HORIZ. SCALE: 1"=40' VERT. SCALE: NA

DESIGN WORK ORDER NO.: 1321927
CONSTR. WORK ORDER NO.: 1406215
R-4275
SHEET 7 OF 7
FILE NAME: R4275-07.DWG