

GENERAL CONSTRUCTION NOTES:

- THE CONTRACTOR SHALL PROVIDE AND MAINTAIN TRAFFIC AS INDICATED IN THE ASSOCIATED PROJECT SPECIAL PROVISIONS.
- CONSTRUCTION SHALL BE IN ACCORDANCE WITH THE CITY OF RIVERSIDE STANDARD DRAWINGS AND STANDARD SPECIFICATIONS FOR PUBLIC WORKS CONSTRUCTION, 2012 EDITION.
- EXISTING UTILITIES SHOWN ON THIS PLAN ARE PLOTTED FROM UTILITY RECORDS. THE CONTRACTOR IS REQUIRED TO TAKE DUE PRECAUTIONARY MEASURES TO LOCATE AND PROTECT ALL UTILITIES WHETHER OR NOT SHOWN ON THIS PLAN.
- ALL STREET PULL BOXES, AFFECTED BY CONSTRUCTION, SHALL BE ADJUSTED TO GRADE.
- PRIME CONTRACTOR BIDDING THIS WORK SHALL HAVE A CLASS "A" OR "C-12" LICENSE.
- THE SEAM BETWEEN PASSES OF THE AC OVERLAY SHALL COINCIDE, AS CLOSE AS POSSIBLE, TO THE LANE LINES.
- COLD MILLING SHALL BE AS DESCRIBED ON THE PLANS AND SPECIAL PROVISIONS OR AS DIRECTED BY THE ENGINEER.
- ANY DISTRESSED EXISTING PAVEMENT SHALL BE REMOVED AND REPLACED AS DIRECTED BY THE ENGINEERING AFTER COLD-MILLING AND PRIOR TO PLACEMENT OF DGAC.
- CONTRACTOR SHALL REMOVE ALL VEGETATION AND CLEAR ALL DIRT WITHIN ALL SIDEWALK PANELS AND TREE WELLS WITHIN THE PROJECT LIMITS. CONTRACTOR SHALL ALSO SMOOTHLY GRADE AND COMPACT ALL TREE WELLS, AS NEEDED.
- ALL EXISTING IMPROVEMENTS SHOWN HEREON SHALL BE PROTECTED IN PLACE UNLESS NOTED.
- EXISTING IRRIGATION SHALL BE PROTECTED OR MODIFIED AS NECESSARY TO CONSTRUCT NEW CONCRETE IMPROVEMENTS.
- ALL DIMENSIONS SHOWN ADJACENT TO CURB AND GUTTER ARE TO THE FACE OF CURB.
- SEE STRIPING PLANS, XL-712 FOR ALL TRAFFIC RELATED IMPROVEMENTS.
- ALL TRAFFIC SIGNAL WORK AT THE INTERSECTION OF INDIANA AVENUE AND THE SR91 RAMPS SHALL COMPLY WITH THE 2010 CALTRANS STANDARD PLANS AND CALIFORNIA MUTCD. CONTRACTOR SHALL COORDINATE INSPECTION WITH CALTRANS PRIOR TO CONSTRUCTION.

CONSTRUCTION NOTES:

- REMOVE AND REPLACE IN KIND EXISTING FACILITY. NUMBERS ABOVE 100 IN A HEXAGON ON THE PLAN REFER TO THE RESPECTIVE STANDARD DRAWING AND SHALL BE CONSTRUCTED ACCORDINGLY. ANY NOTE SHOWN BELOW THE STANDARD DRAWING NUMBER INDICATES THE SPECIFIC TYPE, ACTION, OR MODIFICATION TO BE CONSTRUCTED. WHEN NO OPTION IS INDICATED, DIMENSIONS OF NEW FACILITY SHALL BE MODIFIED AS NECESSARY, EXCLUDING ADA REQUIREMENTS, TO MATCH EXISTING FACILITY REMOVED.
- ADJ ADJUST TO GRADE, DESCRIPTION PER PLAN; (MH) ELECTRIC, TELEPHONE, SEWER OR STORM DRAIN, (GV) GATE VALVE, (ETS) ELECTRIC TEST STATION, (WM) WATER METER, (PB) PULLBOX, (VLT) VAULT, (CATV) CABLE TV
- R&R REMOVE AND REPLACE, DESCRIPTION PER PLAN. (WM) WATER METER LID AND BOX. LID AND BOX TO BE SUPPLIED BY THE CITY OF RIVERSIDE PUBLIC UTILITIES DEPARTMENT.
- REL RELOCATE, DESCRIPTION PER PLAN. (PB) PULLBOX.
- PIP PROTECT IN PLACE, DESCRIPTION PER PLAN; (MH) SEWER OR STORM DRAIN, (GV) GATE VALVE, (WM) WATER METER, (PB) PULLBOX, (SL) STREET LIGHT, (TR) TRAFFIC SIGNAL EQUIPMENT, (TRE) TREE, (DWY) DRIVEWAY, (CB) CATCH BASIN, (MB) MAILBOX.
- 302 CONSTRUCT/RECONSTRUCT DRIVEWAY APPROACH PER CITY STANDARD:
• M1 = RECONSTRUCT 3.5' DRIVEWAY WING TO MATCH THE EXISTING WING.
• M2 = RECONSTRUCT DAMAGED PANEL IN DRIVEWAY APPROACH.
- 304 CONSTRUCT/RECONSTRUCT WHEELCHAIR RAMP PER CITY STANDARD 304:
• M1 = TYPE III RAMP MODIFIED WITH RETAINING CURB ON BOTH SIDES.
• M2 = TYPE II RAMP MODIFIED WITH RAMP LEADING TO LANDING WITH RETAINING CURB AT BACK SIDE OF RAMP AND AT THE BOTTOM OF THE RAMP.
• M3 = REPLACE RAMP PANEL ONLY AND REPLACE PER CITY STANDARD.
• M4 = TYPE I RAMP MODIFIED TO ADD RETAINING CURB AT BACK OF RAMP TO PROVIDE 4' LANDING. ADJUST EXISTING IRRIGATION/LANDSCAPE IMPROVEMENTS AS NECESSARY.
- 325 CONSTRUCT/RECONSTRUCT PCC SIDEWALK PER CITY STANDARD 325.
• M1 = PROVIDE A THICKNESS OF 6"
• M2 = CONSTRUCT AC SIDEWALK
• STP = CONSTRUCT NEW CONCRETE STEPS WITH RETAINING CURB ON BOTH SIDES
- 405 CONSTRUCT NEW CATCH BASIN TOP PER CITY STANDARD 405.
• M1 = SAWCUT AND REMOVE THE TOP 24" OF THE EXISTING CATCH BASIN. PROTECT IN PLACE THE EXISTING R.C.P. CONNECTION AND MAINTAIN EXISTING "V" DEPTH. DOWEL INTO EXISTING BOX WALLS AND INSTALL NEW REBAR. INSTALL WITH NEW CURB AND GUTTER.
- CM1 COLD MILL AT A DEPTH OF (0.12') FOR THE EXISTING AC PAVEMENT.
• XX = LENGTH (FEET) OF COLD MILL ENTIRE WIDTH OF STREET AS SHOWN ON PLAN.
- CM2 VARIABLE AREA COLD MILL OF EXISTING AC PAVEMENT. IF "CIR" NOTE ALSO INDICATED, RECYCLE REMAINING PAVEMENT BASED ON "CIR" NOTE IN LIEU OF DGAC OVERLAY.
• XX = DEPTH(FEET) OF VARIABLE AREA COLD MILL.
- CM3 FULL DEPTH COLD MILL TO REMOVE EXISTING PAVEMENT SECTION DOWN TO BASE MATERIAL.
- DG OVERLAY EXISTING PAVEMENT WITH DGAC PAVEMENT AS DESCRIBED.
• 0.13' OR 0.25' = DEPTH (FT) OF DGAC OVERLAY BETWEEN EDGES OF PAVEMENT OR AS OTHERWISE INDICATED ON PLAN.
• FD = REPLACEMENT OF EXISTING PAVEMENT SECTION WITH FULL DEPTH DGAC OVER NATIVE SOIL/BASE. NATIVE SOIL AND/OR BASE SHALL BE REMOVED AND COMPACTED AS NECESSARY TO INSTALL REPLACEMENT PAVEMENT SECTION.
- OL OVERLAY EXISTING PAVEMENT WITH 0.12' MIN. DEPTH (FT) ARHM OVERLAY BETWEEN EDGES OF PAVEMENT OR AS OTHERWISE INDICATED ON PLAN.
- HMA CONSTRUCT FULL DEPTH PAVEMENT AS DESCRIBED.
1. 0.37' = HOT MIX ASPHALT (HMA) SHALL BE TYPE C, WITH 1" AGGREGATE GRADATION AND PG 64-28 PM ASPHALT BINDER, AND CONSTRUCTED ACCORDING TO CALTRANS 2010 STANDARD SPECIFICATIONS SECTION 39 AND STANDARD SPECIAL PROVISION 39-1.23. LIFT THICKNESS SHALL BE BETWEEN 0.25' AND 0.45'.
2. PRIME COAT SHALL BE APPLIED TO THE BASE PRIOR TO PLACING THE HOT MIX ASPHALT. PRIME COAT SHALL CONFORM TO THE LATEST PROVISIONS IN CALTRANS STANDARD SPECIFICATIONS SECTION 93 AND THE STANDARD SPECIAL PROVISION 39-1.22.
3. TACK COAT SHALL BE APPLIED TO THE EXISTING PAVEMENT INCLUDING PLANED SURFACES, BETWEEN LAYERS OF HMA AND VERTICAL SURFACES OF CURBS, GUTTERS AND CONSTRUCTION JOINTS. TACK COAT MUST COMPLY WITH THE SPECIFICATIONS FOR ASPHALTIC EMULSION IN CALTRANS STANDARD SPECIFICATIONS SECTION 94, "ASPHALTIC EMULSION", OR ASPHALT BINDER IN SECTION 92, "ASPHALT".
4. RELATIVE COMPACTION OF 95 PERCENT SHALL BE OBTAINED FOR A MINIMUM DEPTH OF 2.5 FEET OF THE SUBGRADE, ACCORDING TO CALTRANS STANDARD SPECIFICATIONS 19, "EARTHWORK". CONTROLLED LOW-STRENGTH MATERIAL (CLSM) SHALL COMPLY WITH CALTRANS STANDARD SPECIFICATIONS SECTION 19-3.02F AND 19-3.03I.
5. AGGREGATE BASE SHOULD BE CONSTRUCTED ACCORDING TO CALTRANS STANDARD SPECIFICATIONS SECTION 26, "AGGREGATE BASES".
6. ASPHALT SHALL BE FEATHERED WITHIN 5' OF ALL EXISTING LONGITUDINAL CONCRETE IMPROVEMENTS SUCH AS CURB GUTTERS AND CROSS-GUTTERS.

RIVERSIDE

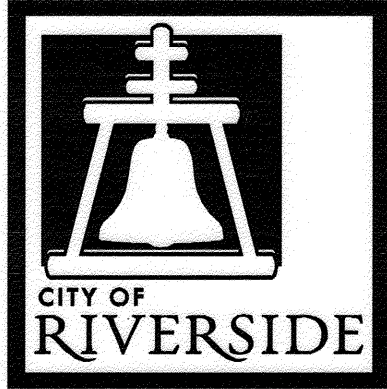

CALIFORNIA

PUBLIC WORKS DEPARTMENT

ARTERIAL STREET MAINTENANCE
INDIANA AVENUE

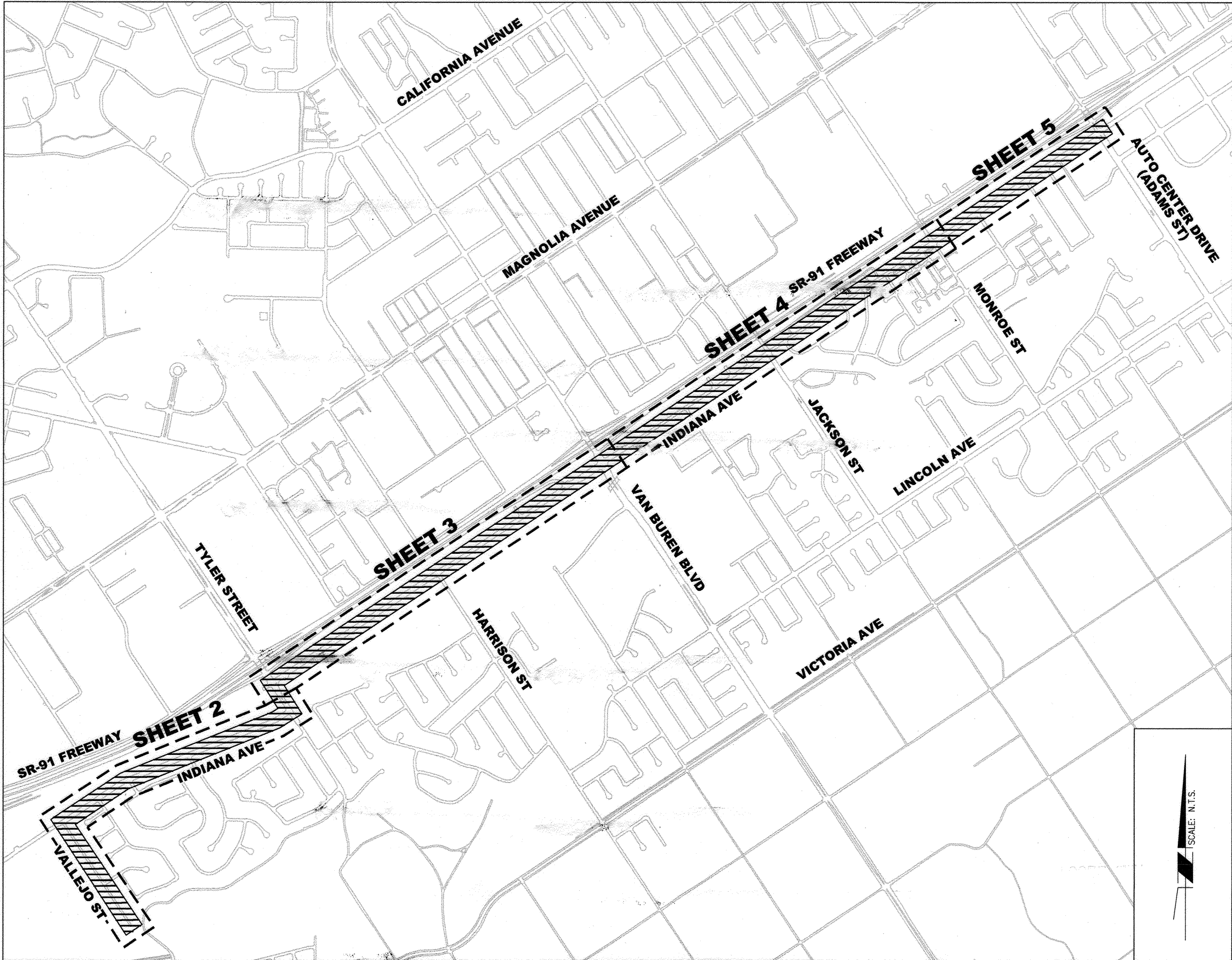

LOCATION MAP
INDIANA AVENUE (VALLEJO STREET TO AUTO CENTER DRIVE)
N.T.S.

LOCATION MAP LEGEND
PROJECT LOCATION

CONSTRUCTION LEGEND:

- CM1/OL, COLDMILL TYPE CM1, DEPTH PER PLAN NEW DGAC PAVEMENT & 0.12' DGAC
- CM2/DG AND/OR OL COLDMILL TYPE CM2, NEW DGAC PAVEMENT (DEPTH PER PLAN) & 0.12' ARHM OVERLAY
- CM2/HMA COLDMILL (0.25' MIN.) TYPE CM3, NEW HOT MIX ASPHALT, TYPE C PAVEMENT (0.25' MIN.) OVER COMPACTED NATIVE/BASE
- CM3/DG FULL DEPTH COLDMILL (0.50' MIN.) TYPE CM3, NEW DGAC PAVEMENT (0.50' MIN.) & 0.12' ARHM OVERLAY
- CIR/OL CIR PAVEMENT (0.30' MIN.) & 0.12' ARHM OVERLAY
- PROPOSED CONCRETE SURFACE

CONSTRUCTION NOTES: (CONT'D)

- RECIR 0.30' RECYCLE EXISTING PAVEMENT UTILIZING COLD IN-PLACE RECYCLING (CIR) METHOD.
• 0.30' MIN. DEPTH (FT) OF CIR AS INDICATED ON PLANS. IN AREAS WHERE THE EXISTING ASPHALT THICKNESS IS 3" OR LESS, THE CIR DEPTH SHALL EXTEND TO FULL-DEPTH. CONTRACTOR SHALL CORE DURING THE CIR PROCESS TO ENSURE WHEN FULL DEPTH IS NECESSARY, ASPHALT SHALL BE FEATHERED WITHIN 5' OF ALL EXISTING LONGITUDINAL CONCRETE IMPROVEMENTS SUCH AS CURB GUTTERS AND CROSS-GUTTERS.
- RET CRB CONSTRUCT RETAINING CURB (0"-18" MAX.) AS NECESSARY AND SHALL BE POURED MONOLITHIC WITH THE ADJOINING SIDEWALK.
- M1 MB REMOVE EXISTING MAILBOX WITH POST FROM EXISTING SIDEWALK PANEL. DISCARD POT WITH OLD SIDEWALK PANEL AND INSTALL EXISTING MAILBOX INTO NEW SIDEWALK WITH NEW POST TO MATCH EXISTING IF NECESSARY.
- M2 MB REPLACE EXISTING MAILBOX POST IN KIND (MATERIAL AND PAINT COLOR).
- CLF 4' INSTALL APPROX. 30' OF NEW 4' HIGH CHAIN LINK FENCE FROM WESTERLY PROPERTY LINE TO EX. TREE. INSTALL AN ADDITIONAL 4' OF NEW 4' HIGH CHAIN LINK FENCE STARTING FROM THE OPPOSITE SIDE OF THE TREE TOWARD THE DRIVEWAY ALONG THE PROPERTY LINE.
- GRD DRT GRADE EXISTING SOIL FROM BACK OF NEW SIDEWALK AT A 2:1 SLOPE AS NECESSARY.
- FIL DRT BACKFILL EXISTING SOIL TO GRADE AFTER REMOVAL OF CONCRETE SIDEWALK.
- BUS CONSTRUCT 60" LONG BY 12" WIDE CONCRETE BUS PAD (BUS PAD WIDTH MEASURED FROM MONOLITHIC CURB FACE), UNLESS OTHERWISE INDICATED ON PLANS. BASE OR SUBGRADE OR EXISTING PAD SHALL BE REMOVED AND COMPACTED AS NECESSARY TO INSTALL BUS PAD PER DETAIL IN PART 10 OF THE SPECIFICATIONS. ENGINEER SHALL BE NOTIFIED PRIOR TO POURING NEW CONCRETE.
- INS RMP EXISTING RAMP TO BE CHECKED BY A CALTRANS ADA INSPECTOR FOR COMPLIANCE AND POSSIBLE REPLACEMENT BY THE CONTRACTOR.
- REM BSH EXISTING BUSHES AT 9426 INDIANA AVENUE TO BE REMOVED BACK TO THE PROPERTY LINE

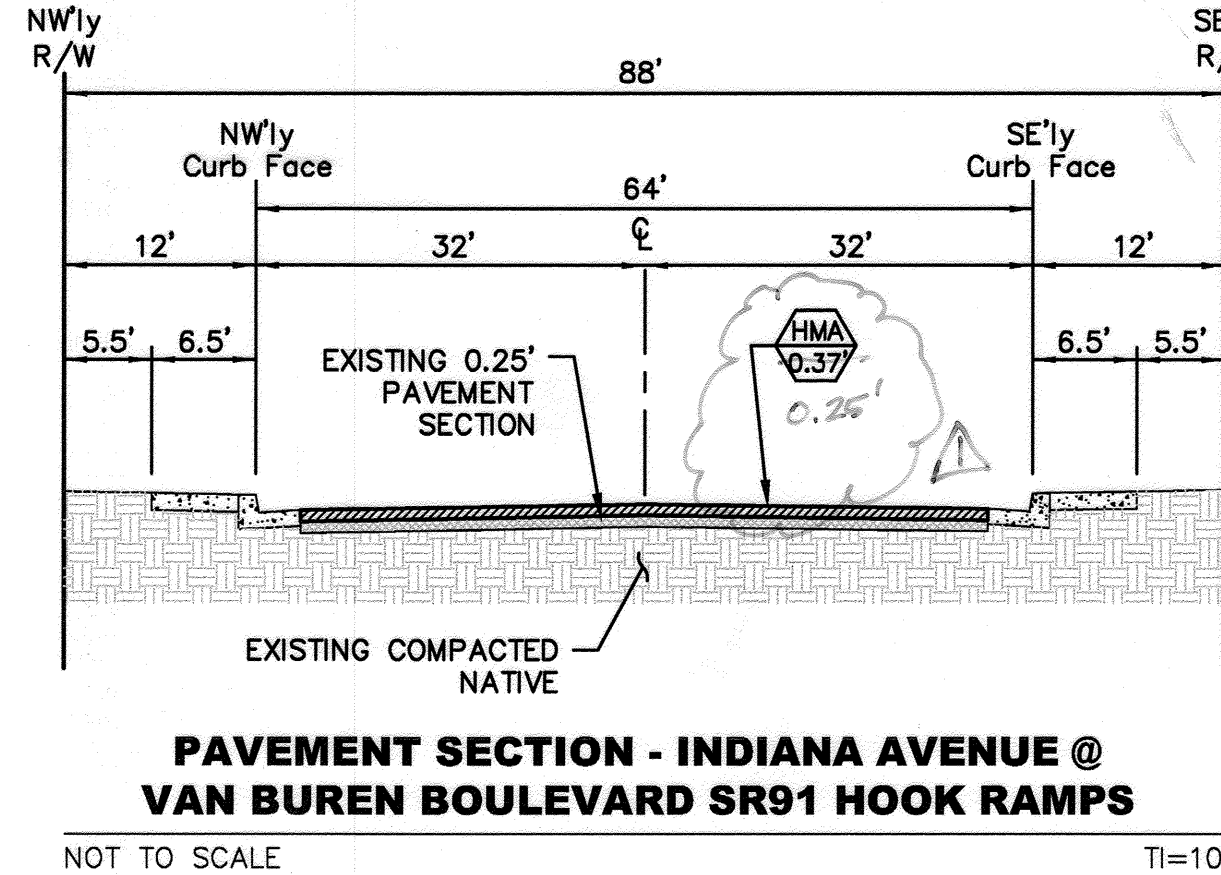

STREET PLAN INDEX (R-4277)

SHEET NO.	DESCRIPTION
1	TITLE SHEET AND CONSTRUCTION NOTES
2	INDIANA AVENUE (VALLEJO STREET - TYLER STREET)
3	INDIANA AVENUE (TYLER STREET - VAN BUREN BOULEVARD)
4	INDIANA AVENUE (GIBSON STREET - MONROE STREET)
5	INDIANA AVENUE (BERNARD STREET - AUTO CENTER DRIVE)

STRIPING PLAN INDEX (XL-712)

SHEET NO.	DESCRIPTION
1	INDIANA AVENUE (VALLEJO STREET - ERIE DRIVE)
2	INDIANA AVENUE (ERIE DRIVE - TYLER STREET)
3	INDIANA AVENUE (TYLER STREET - HARRISON STREET)
4	INDIANA AVENUE (HARRISON STREET - VAN BUREN BOULEVARD)
5	INDIANA AVENUE (VAN BUREN BOULEVARD - JACKSON STREET)
6	INDIANA AVENUE (JACKSON STREET - MONROE STREET)
7	INDIANA AVENUE (MONROE STREET - AUTO CENTER DRIVE)

CALTRANS ENCROACHMENT PERMIT #08-14-N-MC-0036

Under Ground Service Alert of Southern California
Call: TOLL FREE 1-800-227-2600
TWO WORKING DAYS BEFORE YOU DIG

ENGINEER IN RESPONSIBLE CHARGE
Edward Lara
R.C.E. No. 63753 EXPIRES: 9-30-16
DATE: August 7, 2015

REVISIONS
1. REVISE HOT MIX NOTE & SECTION
DATE: 8/14/15

CITY OF RIVERSIDE, CALIFORNIA
DEPARTMENT OF PUBLIC WORKS
APPROVED BY: [Signature]
DATE: 8/19/15
CONSTRUCTION ADMIN. [Signature]
DATE: 8-7-15
TRAFFIC DIVISION [Signature]
DATE: 8-3-15

STREET MAINTENANCE
ARTERIAL STREET MAINTENANCE
INDIANA AVENUE
TITLE SHEET AND NOTES
HORIZ. SCALE: N/A VERT. SCALE: N/A

DESIGN WORK ORDER NO.: 1403303
CONSTR. WORK ORDER NO.: 1403304
R-4277
SHEET 1 OF 5
FILE NAME: R4277-01.DWG

As-BUILT 7-19-18

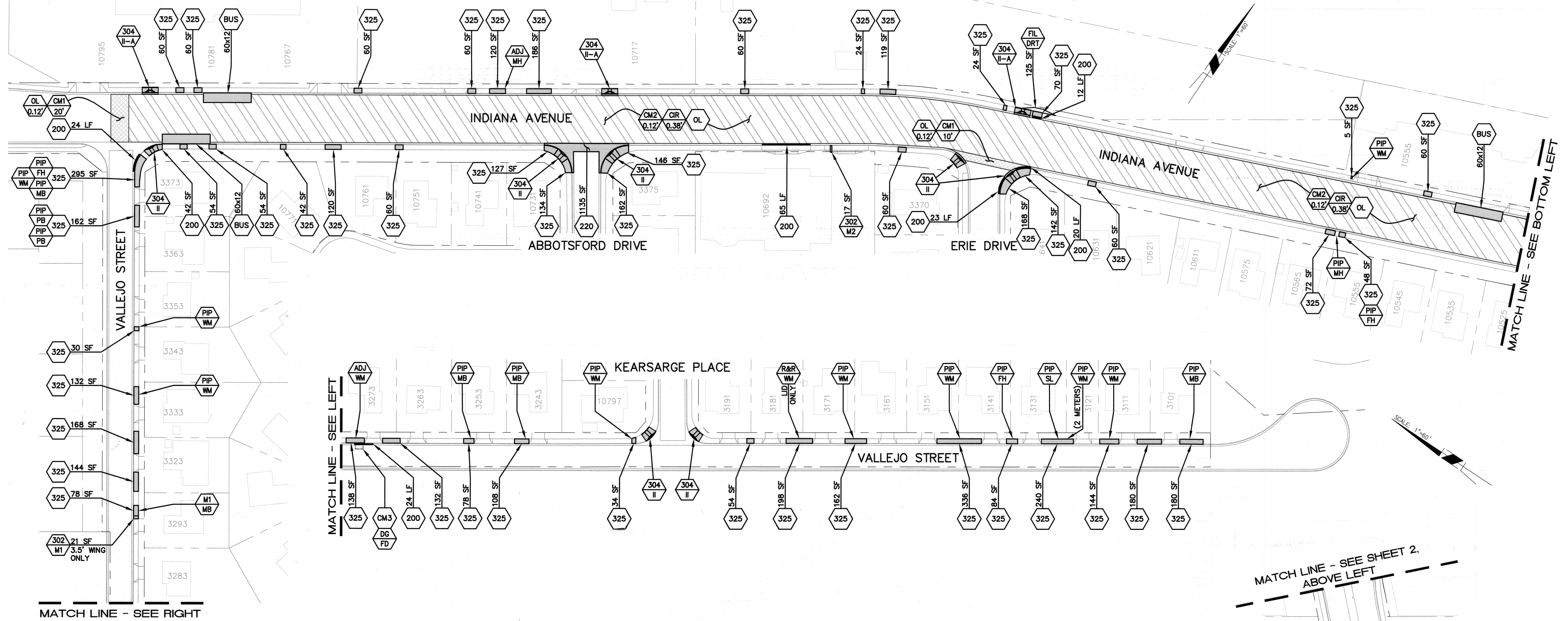

NOTE: CONTRACTOR SHALL ADJUST ALL UTILITY COVERS TO GRADE WITHIN THE PROJECT LIMITS AS INDICATED IN THE SPECIAL PROVISIONS.

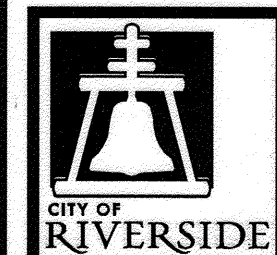
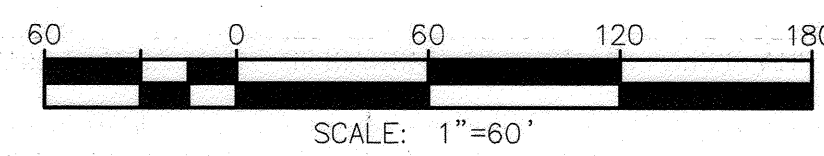
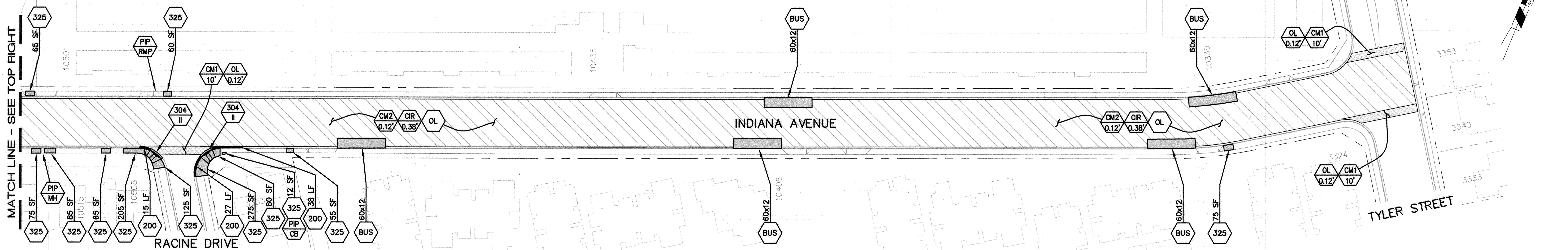

ENGINEER IN RESPONSIBLE CHARGE
Edward Lara
Edward Lara
R.C.E. No. 63753 EXPIRES: 9-30-16
DATE: August 7, 2015

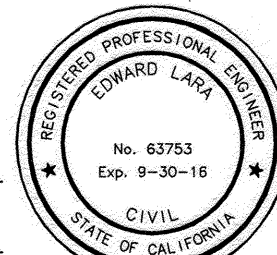

MARK	REVISIONS	APPR.	DATE
DESIGNED BY	DMC	DRAWN BY	DMC
CHECKED BY	EL		

CITY OF RIVERSIDE, CALIFORNIA DEPARTMENT OF PUBLIC WORKS			
APPROVED BY	BY	DATE	APPROVED BY
ENGINEERING MANAGER	<i>DMC</i>	8/10/15	<i>DMC</i>
CONSTRUCTION ADMIN.	<i>DMC</i>	8-7-15	CITY ENGINEER
TRAFFIC DIVISION	<i>DMC</i>	8-7-15	
STREETS DIVISION			
SURVEY			

CALTRANS ENCROACHMENT PERMIT #08-14-N-MC-0036	
STREET MAINTENANCE	DESIGN WORK ORDER NO.: 1403303
ARTERIAL STREET MAINTENANCE	CONSTR. WORK ORDER NO.: 1403304
INDIANA AVENUE	R-4277
VALLEJO ST TO TYLER ST	SHEET 2 OF 5
HORIZ. SCALE: 1"=60'	FILE NAME: R4277-02.DWG

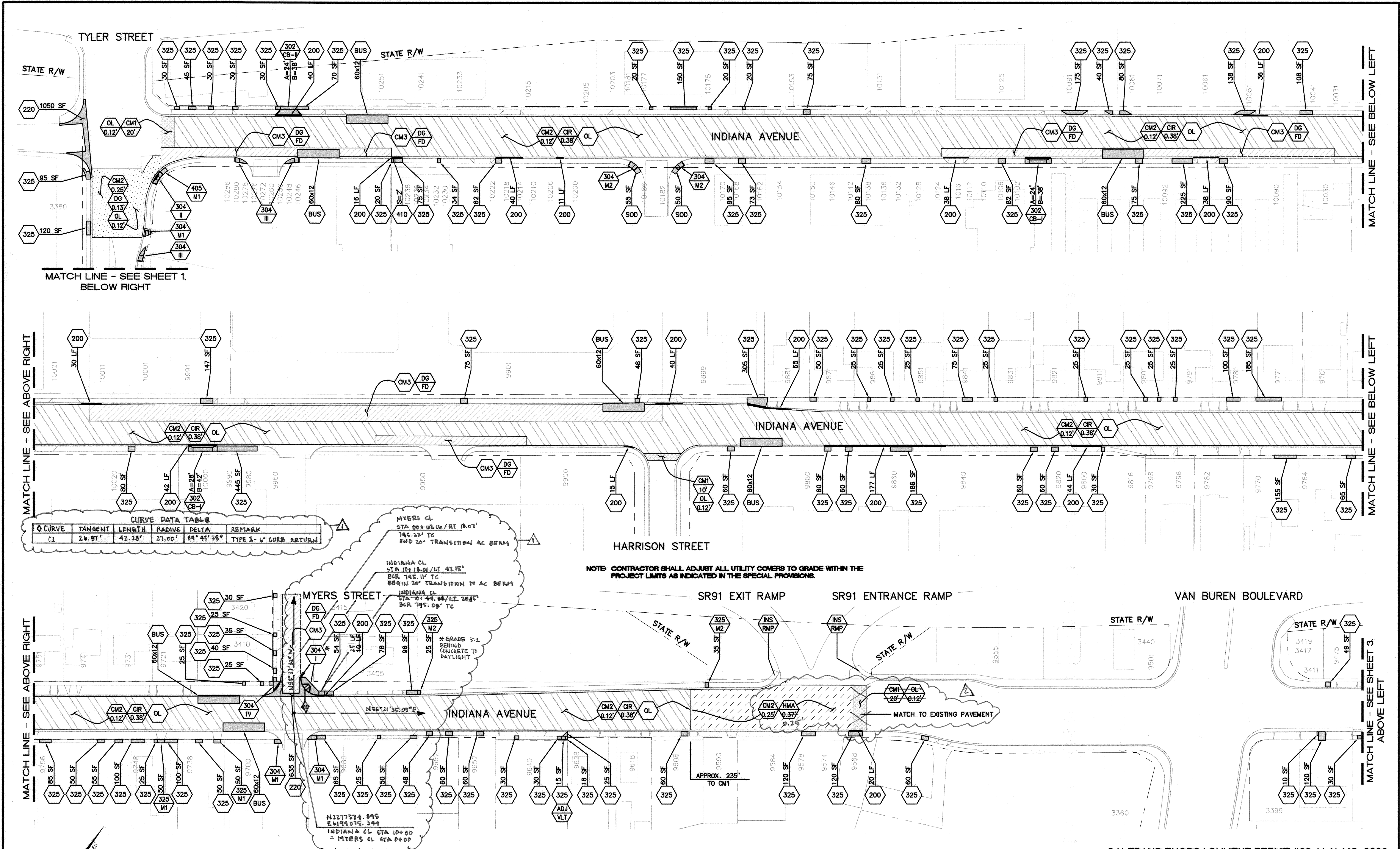

CURVE DATA TABLE				
CURVE	TANGENT	LENGTH	RADIUS	DELTA
C1	26.81'	42.28'	27.00'	89°43'38"
REMARK: TYPE 1-4" CURB RETURN				

MYERS CL
STA 10+00.00 / LT 18.01'
BGR 195.11' TC
END 20' TRANSITION AC BEAM

INDIANA CL
STA 10+00.00 / LT 47.15'
BGR 195.11' TC
BEGIN 20' TRANSITION TO AC BEAM

INDIANA CL
STA 10+44.88 / LT 20.15'
BGR 195.08' TC

* GRADE 3:1
BEHIND CONCRETE TO
DAYLIGHT

N22°17'34"E
E61°49'05"S 344'

INDIANA CL STA 10+00
= MYERS CL STA 0+00

NOTE: CONTRACTOR SHALL ADJUST ALL UTILITY COVERS TO GRADE WITHIN THE PROJECT LIMITS AS INDICATED IN THE SPECIAL PROVISIONS.

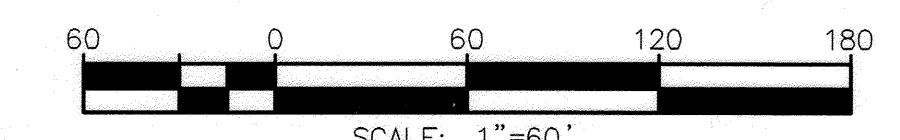

Under Ground Service Alert of Southern California
Call: TOLL FREE 1-800 227-2600
TWO WORKING DAYS BEFORE YOU DIG

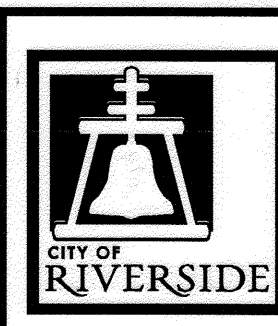

ENGINEER IN RESPONSIBLE CHARGE
Edward Lara
Edward Lara
R.C.E. No. 63753 EXPIRES: 9-30-16
DATE: August 7, 2015

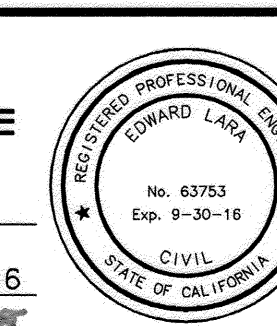

DESIGNED BY	DMC	DRAWN BY	DMC	CHECKED BY	EL
APPROVED BY	ENGINEERING MANAGER	BY	FM	DATE	8/10/15
APPROVED BY	CONSTRUCTION ADMIN.	BY	DC	DATE	8-7-15
APPROVED BY	TRAFFIC DIVISION	BY	R.H.	DATE	8-7-15

CITY OF RIVERSIDE, CALIFORNIA
DEPARTMENT OF PUBLIC WORKS

APPROVED BY: [Signature]
DATE: 8/14/2015

APPROVED BY: [Signature]
DATE: 8/14/2015

STREET MAINTENANCE
ARTERIAL STREET MAINTENANCE
INDIANA AVENUE
TYLER ST TO VAN BUREN BLVD
HORIZ. SCALE: 1"=60' VERT. SCALE:

DESIGN WORK ORDER NO.: 1403303
CONSTR. WORK ORDER NO.: 1403304
R-4277
SHEET 3 OF 5
FILE NAME: R4277-03.DWG

CALTRANS ENCROACHMENT PERMIT #08-14-N-MC-0036

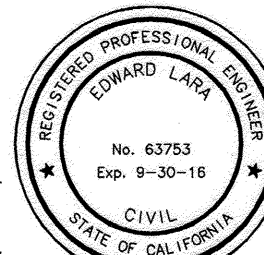
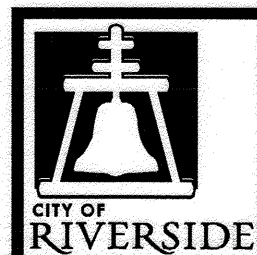
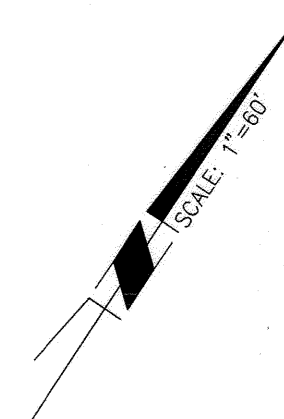
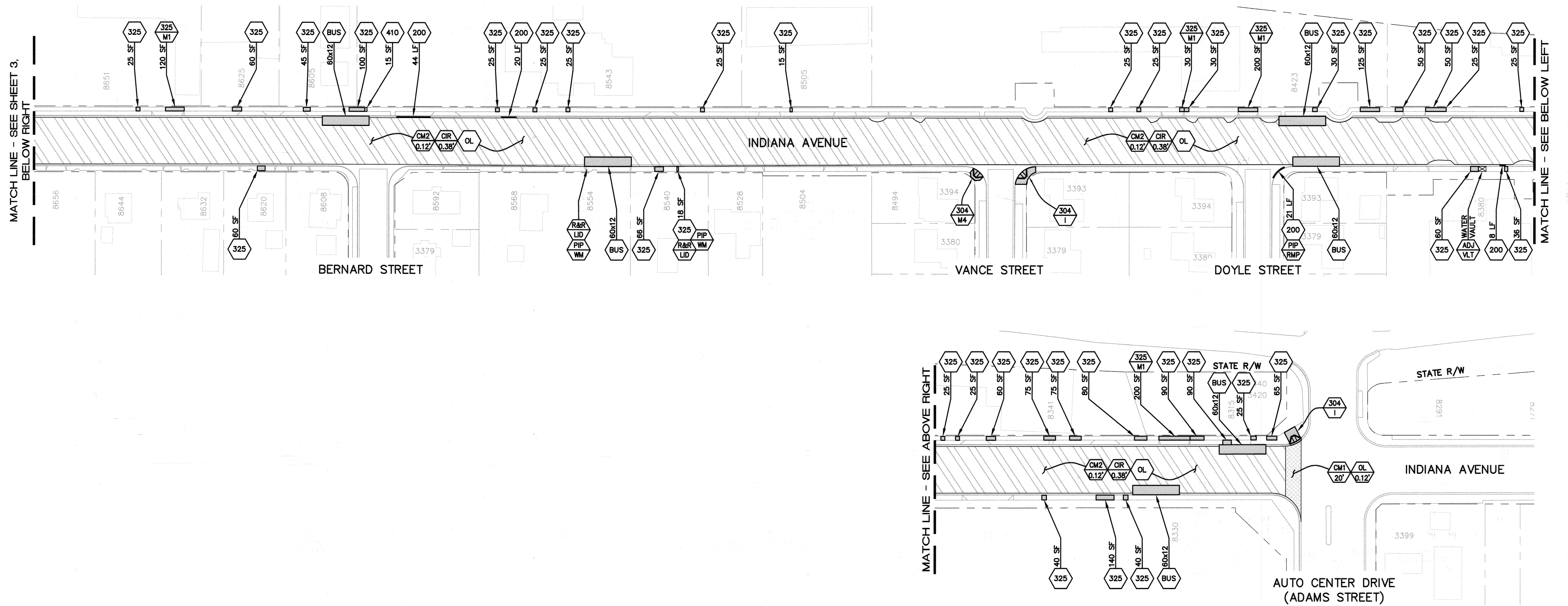

CITY OF RIVERSIDE, CALIFORNIA DEPARTMENT OF PUBLIC WORKS			
APPROVED BY	BY	DATE	APPROVED BY
ENGINEERING MANAGER	<i>FM</i>	<i>8/19/15</i>	<i>[Signature]</i>
CONSTRUCTION ADMIN.	<i>DC</i>	<i>8-2-15</i>	CITY ENGINEER
TRAFFIC DIVISION	<i>J.H.</i>	<i>8-2-15</i>	
STREETS DIVISION			DATE <i>8/14/2015</i>
SURVEY			