

PROFILE SCALE
 HORZ: 1" = 20'
 VERT: 1" = 2'

CONSTRUCTION NOTES

1. CONSTRUCT COMMERCIAL DRIVEWAY APPROACH PER CITY OF RIVERSIDE STD. DWG. NO. 302.
2. CONSTRUCT CROSS GUTTER PER CITY OF RIVERSIDE STD. DWG. NO. 220 (W=6').
3. CONSTRUCT 6" CURB & GUTTER PER CITY OF RIVERSIDE STD. DWG. NO. 200 TYPE 1.
- 3A. CONSTRUCT 8" CURB & GUTTER PER CITY OF RIVERSIDE STD. DWG. NO. 200 TYPE 1.
4. CONSTRUCT CONCRETE SIDEWALK PER CITY OF RIVERSIDE STD. DWG. NO. 325.
5. NOTE NOT USED.
6. CONSTRUCT PEDESTRIAN RAMP PER CITY OF RIVERSIDE STD. DWG. NO. 304 TYPE 2.
7. CONSTRUCT PEDESTRIAN RAMP PER CITY OF RIVERSIDE STD. DWG. NO. 304 TYPE 3.
8. CONSTRUCT PEDESTRIAN RAMP PER CITY OF RIVERSIDE STD. DWG. NO. 304 TYPE 5.
9. CONSTRUCT SAWCUT, COLD PLANE AND OVERLAY PER DETAIL ON SHEET 1.
10. CONSTRUCT 5:1 TAPER TO EXISTING.
11. NOTE NOT USED.
12. NOTE NOT USED.
13. NOTE NOT USED.
14. CONSTRUCT 1" A.C. OVER 1/2" CLASS 2 AGGREGATE BASE.
15. CONSTRUCT 10' TRANSITION FROM 6" TO 8" CURB AND GUTTER.
16. REMOVE AND RELOCATE PER PLAN.
17. NOTE NOT USED.
18. PROTECT IN PLACE PER PLAN.
19. TO BE REMOVED PER PLAN.
20. INSTALL RETRO REFLECTIVE HYDRANT MARKER.
21. FILL AND REPAIR CONCRETE WHERE WATER METER BOXES ARE REMOVED.
22. CONSTRUCT ASPHALT CONCRETE BERM PER CITY OF RIVERSIDE STD. DWG. NO. 250.
23. CONSTRUCT BARRICADE PER CITY OF RIVERSIDE STD. DWG. NO. 180.
24. INSTALL CHANNELIZERS PER CALTRANS STD. DWG. NO. A73C.
25. PROTECT IN PLACE EXISTING DRIVEWAY.

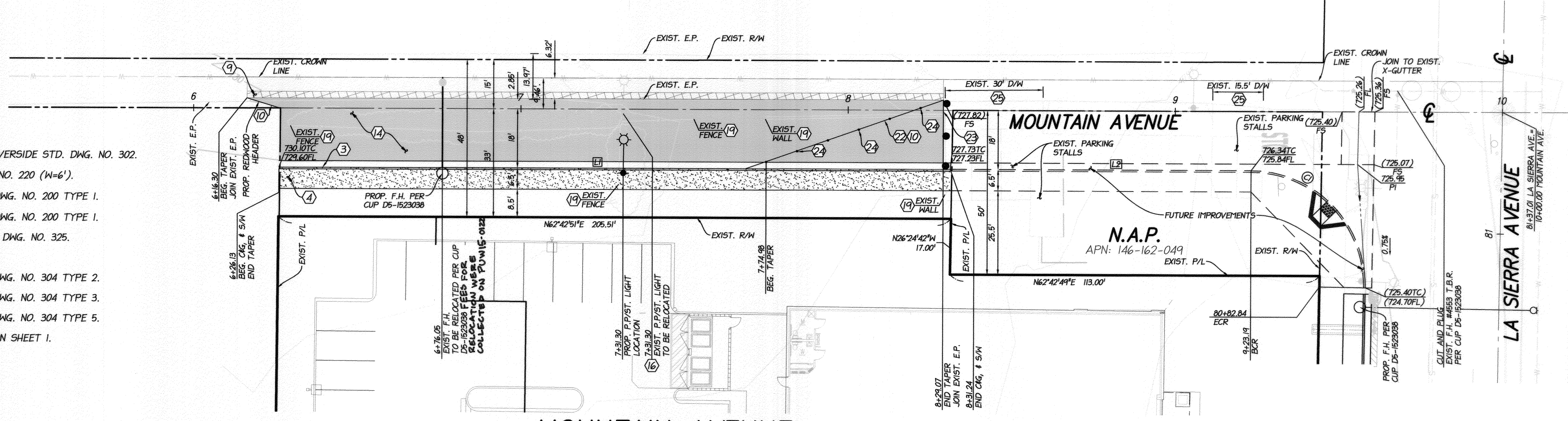

MOUNTAIN AVENUE
 FOR REFERENCE ONLY. MOUNTAIN AVENUE TO BE
 CONSTRUCTED BY OTHERS

HATCH LEGEND

- PROPOSED AC PAVEMENT
- PROPOSED CONCRETE SIDEWALK
- PROPOSED SAWCUT
- PROPOSED OVERLAY

CURVE TABLE

CURVE #	LENGTH	RADIUS	DELTA	TAN
C1	55.51'	35.00'	90°52'29"	35.54'

LINE TABLE

LINE #	BEARING	DISTANCE
L1	N62°42'49"E	205.11
L2	N62°42'49"E	91.95

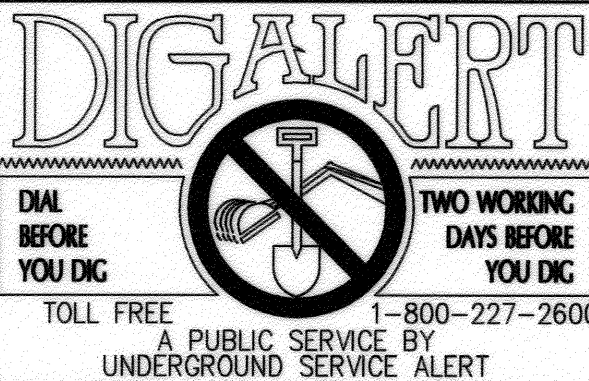
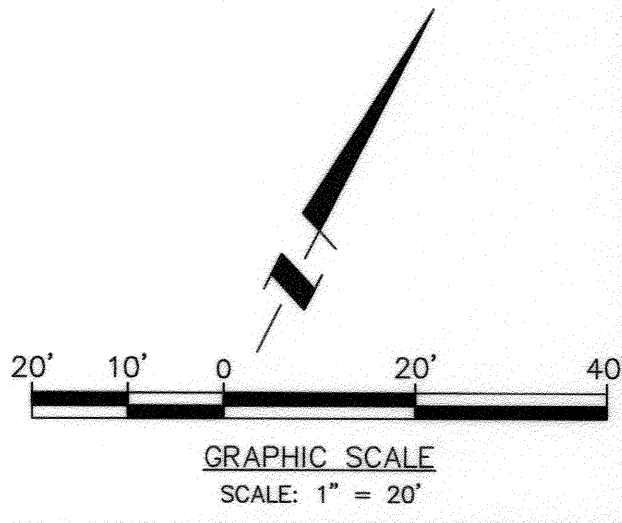

BENCHMARK: F2-03 1988 ELEV. = 725.201

CITY OF RIVERSIDE
 FOUND P.K. NAIL AND CITY ENGINEER TAG
 "F2-03" IN THE MOST SOUTHERLY CURB
 RETURN AT PIERCE STREET AND GOLDEN
 AVENUE.

CITY OF RIVERSIDE PUBLIC UTILITIES
 DEPARTMENT-ELECTRIC OVERHEAD & UNDERGROUND
 APPROVED BY: *[Signature]* DATE: 10/15/15
 ELECTRIC ENGINEERING

CITY OF RIVERSIDE PUBLIC UTILITIES
 WATER DEPARTMENT REVIEW FOR WATER CONFLICTS
 APPROVED BY: *[Signature]* DATE: 10/15/15
 WATER ENGINEERING



CITY BUSINESS CERTIFICATE NO. 0021337, EXP. 10/31/2015
PSOMAS
 1500 IOWA AVENUE, SUITE 210
 RIVERSIDE, CA 92507
 (951) 787-8421 WWW.PSOMAS.COM
 PREPARED BY: *[Signature]* R.C.E. NO. 42110
 DATE: 10/15/15

MARK DESIGNED BY: *[Signature]* REVISIONS: *[Signature]* APPR. DATE: *[Signature]*
 DRAWN BY: *[Signature]* CHECKED BY: *[Signature]*

**CITY OF RIVERSIDE, CALIFORNIA
 PUBLIC WORKS DEPARTMENT**
 APPROVED BY: *[Signature]* BY DATE: 10/15/15
 ENGINEERING MANAGER: *[Signature]* TRAFFIC ENGINEERING: *[Signature]*
 CITY ENGINEER/PW DIRECTOR: *[Signature]* DATE: 10/15/15

**CITY OF RIVERSIDE
 STREET IMPROVEMENT PLAN
 4920 LA SIERRA AVENUE
 PLAN AND PROFILE**

PW15-0284
 R-4348
 SHEET 2 OF 3
 J.N. 4MCKO10200

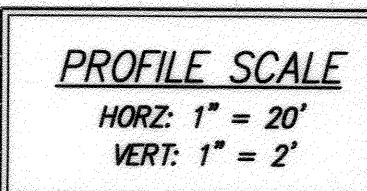

MOUNTAIN AVENUE

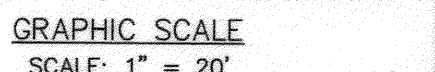

<i>CURVE #</i>	<i>LENGTH</i>	<i>RADIUS</i>	<i>DELTA</i>	<i>TAN</i>
<i>C1</i>	<i>58.72'</i>	<i>35.00'</i>	<i>96°07'04"</i>	<i>38.95'</i>
<i>C2</i>	<i>53.73'</i>	<i>35.00'</i>	<i>87°57'55"</i>	<i>33.78'</i>
<i>C3</i>	<i>55.18'</i>	<i>35.00'</i>	<i>90°19'44"</i>	<i>35.20'</i>
<i>C4</i>	<i>54.78'</i>	<i>35.00'</i>	<i>89°40'16"</i>	<i>34.80'</i>