

GENERAL NOTES:

- NO PERSON SHALL PERFORM ANY CONSTRUCTION ACTIVITY OR INSTALL ANY OBJECTS WITHIN THE PUBLIC RIGHTS-OF-WAY OR EASEMENTS OF THE CITY OF RIVERSIDE WITHOUT A VALID CONSTRUCTION PERMIT OR, A STREET OPENING PERMIT OR AN ENCROACHMENT PERMIT ISSUED BY THE CITY'S PUBLIC WORKS DEPARTMENT.
- IT SHALL BE THE RESPONSIBILITY OF THE CONTRACTOR TO CLEAR THE RIGHT OF WAY IN ACCORDANCE WITH THE PROVISIONS OF LAW AS IT AFFECTS EACH UTILITY INCLUDING IRRIGATION LINES AND APPURTENANCES AND AT NO COST TO THE CITY.
- CONSTRUCTION SHALL BE IN ACCORDANCE WITH THE CITY OF RIVERSIDE DEPARTMENT OF PUBLIC WORKS, STANDARD DRAWINGS, ITS SUPPLEMENTAL NOTES AND THE STANDARD SPECIFICATIONS FOR PUBLIC WORKS CONSTRUCTION, CURRENT EDITION.
- THE PRIVATE ENGINEER SIGNING THESE PLANS IS RESPONSIBLE FOR ASSURING THE ACCURACY AND ACCEPTABILITY OF THE WORK HEREON. IN THE EVENT OF DISCREPANCIES ARISING DURING CONSTRUCTION, THE PRIVATE ENGINEER SHALL BE RESPONSIBLE FOR DETERMINING AN ACCEPTABLE SOLUTION AND REVISING THE PLANS FOR APPROVAL BY THE CITY.
- QUANTITIES SHOWN ARE FOR INFORMATION ONLY AND THE CITY OF RIVERSIDE IS NOT RESPONSIBLE FOR THEIR ACCURACY.
- THE DEVELOPER SHALL BE RESPONSIBLE FOR PRESERVING OR RE-ESTABLISHING AND REFERENCING SURVEY MONUMENTS DESTROYED, DISTURBED, OR BURIED AS A RESULT OF CONSTRUCTION SHOWN HEREON.
- SEE "STREET LIGHTING PLANS" FOR QUANTITY AND LOCATION OF REQUIRED STREET LIGHTS.
- ALL FLAGGED ELEVATIONS SHALL BE STAKED IN THE FIELD BY THE PRIVATE ENGINEER.
- WHERE NEW PAVEMENT IS TO JOIN EXISTING PAVEMENT, THE EDGE OF THE EXISTING PAVEMENT SHALL BE TRIMMED IN A SMOOTH STRAIGHT LINE. CONSTRUCT MATCH-UP PAVING AS SHOWN ON THE PLANS AND OVERLAY PAVING AS DIRECTED IN THE FIELD TO PRODUCE A SMOOTH SECTION.
- CONSTRUCT DRIVEWAY APPROACHES PER STANDARD DRAWING 302. EXACT SIZE AND LOCATION TO BE STAKED AS SHOWN PRIOR TO CONSTRUCTION OF THE CURB AND GUTTER.
- ALL OVERHANGING TREE LIMBS THAT ARE LESS THAN 14' ABOVE THE STREET GRADE SHALL BE TRIMMED BACK.
- ON ALL AREAS WITHIN THE PUBLIC RIGHT-OF-WAY WHERE THE FILL IS ONE (1) FOOT OR GREATER, A LETTER WILL BE REQUIRED FROM THE SOILS ENGINEER, CERTIFYING THE COMPACTION OF THE FILL BELOW SUB-GRADE, PRIOR TO ISSUANCE OF THE CONSTRUCTION PERMIT/CUT SHEETS.
- ANY TRAFFIC CONTROL STRIPING OBLITERATED AND/OR BADLY WORN DURING CONSTRUCTION SHALL BE RESTORED BY THE CONTRACTOR WITHIN FIVE DAYS AFTER NOTIFICATION FROM THE CITY INSPECTORS.
- FINAL STRIPING FOR TRAFFIC CONTROL AND/OR PAVEMENT MARKING TO BE THE RESPONSIBILITY OF THE DEVELOPER.
- THE CONTRACTOR SHALL CALL IN A LOCATION REQUEST TO UNDERGROUND SERVICE ALERT (USA), PHONE # 1-800-227-2600, TWO WORKING DAYS BEFORE DIGGING. NO CONSTRUCTION PERMIT WILL BE ISSUED BY THE PUBLIC WORKS DEPARTMENT INVOLVING EXCAVATION FOR UNDERGROUND FACILITIES UNLESS THE APPLICANT HAS BEEN PROVIDED AN INQUIRY IDENTIFICATION NUMBER BY USA.
- THE CONTRACTOR SHALL ARRANGE FOR A SOIL TEST TO BE MADE BY A SOILS ENGINEER AFTER THE STREETS HAVE BEEN PREPARED TO ROUGH GRADE AND PRIOR TO CURB AND GUTTER CONSTRUCTION. DEPTH OF BASE MATERIAL AND A.C. PAVING SHALL BE DETERMINED BY THE CITY OF RIVERSIDE DESIGN STANDARDS AND TEST PROCEDURES.
- ALL TRAFFIC SIGNS SHALL BE INSTALLED PRIOR TO OPENING THE STREETS TO TRAFFIC.
- THE CONTRACTOR SHALL COORDINATE TRENCHING FOR CABLE TELEVISION WITH OTHER TRENCHING WITHIN THE SUBDIVISION.
- IN PAVEMENT OVERLAY AREAS, ANY DISTRESSED EXISTING PAVEMENT SHALL BE REMOVED AND REPLACED AS DIRECTED BY THE INSPECTOR PRIOR TO OVERLAY WITH A.C. PAVING.

PRIVATE ENGINEER'S NOTES:

- UNLESS SPECIFIED IN THE PROJECT SPECIFIC CONSTRUCTION DOCUMENTS, ALL CONSTRUCTION SHOWN HEREON SHALL BE IN ACCORDANCE WITH THE GOVERNING AGENCY ADOPTED VERSION OF THE UNIFORM BUILDING CODE, THE "STANDARD SPECIFICATIONS FOR PUBLIC WORKS CONSTRUCTION" (CURRENT EDITION) AND THE "STANDARD PLANS FOR PUBLIC WORKS CONSTRUCTION" (CURRENT EDITION).
- THE EXISTENCE AND LOCATION OF ANY UNDERGROUND UTILITY PIPES OF STRUCTURES SHOWN ON THESE PLANS WERE OBTAINED BY A SEARCH OF AVAILABLE RECORDS. THESE LOCATIONS ARE APPROXIMATE AND SHALL BE CONFIRMED IN THE FIELD BY THE CONTRACTOR, SO THAT ANY NECESSARY ADJUSTMENTS CAN BE MADE IN ALIGNMENT AND/OR GRADE OF THE PROPOSED IMPROVEMENTS. THE CONTRACTOR IS REQUIRED TO TAKE DUE PRECAUTIONARY MEASURES TO PROTECT ANY UTILITY LINES SHOWN AND ANY OTHER LINES NOT OF RECORD OR NOT SHOWN ON THESE PLANS.
- PRIOR TO CONSTRUCTION, THE CONTRACTOR SHALL VERIFY THE HORIZONTAL AND VERTICAL POSITION OF ALL POINTS OF CONNECTION TO EXISTING STRUCTURES. THIS SHALL INCLUDE BOTH ABOVE GROUND AND BELOW GROUND POINTS OF CONNECTION. THE ENGINEER SHALL BE NOTIFIED OF ANY DISCREPANCIES PRIOR TO BEGINNING CONSTRUCTION.
- NO PORTION OF ANY PAVEMENT SURFACE WITHIN THE DISABLED PARKING SPACES OR ACCESS AISLES SHALL EXCEED 2% GRADIENT IN ANY DIRECTION. NO PORTION OF THE PATH OF TRAVEL SHALL EXCEED 5% GRADIENT EXCEPT AT DESIGNATED RAMPS WHICH SHALL NOT EXCEED 8.33% GRADIENT. NO PORTION OF THE PATH OF TRAVEL SHALL EXCEED 2% CROSS-FALL GRADIENT. THE ENGINEER SHALL BE NOTIFIED OF ANY DISCREPANCIES PRIOR TO BEGINNING CONSTRUCTION.
- THICKNESS OF PAVEMENT AND BASE MATERIAL SHOWN HEREON IS PRELIMINARY ONLY. FINAL PAVEMENT SECTION TO BE DETERMINED BY SOILS TEST AND RECOMMENDED BY THE SOILS ENGINEER UPON COMPLETION OF ROUGH GRADING.
- CONSTRUCTION CONTRACTOR AGREES THAT IN ACCORDANCE WITH GENERALLY ACCEPTED CONSTRUCTION PRACTICES, CONSTRUCTION CONTRACTOR WILL BE REQUIRED TO ASSUME SOLE AND COMPLETE RESPONSIBILITY FOR JOB SITE CONDITIONS DURING THE COURSE OF CONSTRUCTION OF THE PROJECT, INCLUDING SAFETY OF ALL PERSONS AND PROPERTY; THAT THIS REQUIREMENT SHALL BE MADE TO APPLY CONTINUOUSLY AND NOT BE LIMITED TO NORMAL WORKING HOURS.
- THE PRIVATE ENGINEER SIGNING THESE PLANS IS RESPONSIBLE FOR ASSURING THE ACCURACY AND ACCEPTABILITY OF THE DESIGN HEREON. IN THE EVENT OF DISCREPANCIES ARISING AFTER APPROVAL OR DURING CONSTRUCTION, THE PRIVATE ENGINEER SHALL BE RESPONSIBLE FOR DETERMINING AN ACCEPTABLE SOLUTION AND REVISING THE PLANS ACCORDINGLY.

STORM DRAIN CONSTRUCTION NOTES

1. INSTALL 12" RCP STORM DRAIN PIPE. D-LOAD=1600, BEDDING CASE 2. PER CITY OF RIVERSIDE STD. DWG. NO. 462.

2. INSTALL JUNCTION STRUCTURE B PER RIVERSIDE STD. DWG. 421. A=45', B=12', C=2.55', D=12', E=2.05', L=2.4' 1 EA.

3. INSTALL JUNCTION STRUCTURE B PER RIVERSIDE STD. DWG. 421. A=80', B=12', C=1.44', D=12', E=0.90', L=1.7' 2 EA.

4. INSTALL JUNCTION STRUCTURE NO. 4, CASE 1 PER RIVERSIDE STD. DWG. 423. CONTRACTOR SHALL COORDINATE WITH BUILDING CONTRACTOR FOR THE EXACT LOCATION OF ROOF DRAIN LATERALS. 3 EA.

QUANTITIES

184 L.F.

1 EA.

2 EA.

3 EA.

TELEPHONE NUMBERS

EMERGENCY
RIVERSIDE POLICE DEPARTMENT(951) 787-7411
RIVERSIDE FIRE DEPARTMENT(951) 826-5321
GOODHEW AMBULANCE.....(951) 684-5520
RIVERSIDE COMMUNITY HOSPITAL.....(951) 788-3000
RIVERSIDE GENERAL HOSPITAL.....(951) 351-0425

UTILITIES
UNDERGROUND SERVICE ALERT.....(800) 227-2600
CITY OF RIV. ELEC. OPERATIONS CONTROL CTR.....(951) 687-0791
SOUTHERN CALIFORNIA GAS (DISTRIBUTION).....(800) 227-2600
CITY OF RIV. PUBLIC UTIL. CUSTOMER SERVICES.....(800) 782-0330
PACIFIC BELL.....(800) 227-2600
AMERICAN TELEPHONE & TELEGRAPH.....(951) 381-7380
CHARTER COMMUNICATION CABLE.....(951) 688-9012
CITY OF RIV. WATER OPERATIONS EMERGENCIES.....(951) 782-0330

OTHERS
RIVERSIDE PUBLIC WORKS DEPARTMENT.....(951) 826-5341
R.F. DICKSON STREET SWEEPING.....(800) 841-7994
WESTERN WASTE.....(951) 737-0343
RIVERSIDE DIAL-A-RIDE (SUPERVISOR).....(951) 275-9620
US POSTAL SERVICE.....(951) 737-0451
RIVERSIDE UNIFIED SCHOOL DISTRICT.....(951) 788-7134
RIVERSIDE TRANSITAGENCY.....(951) 684-0850

CITY OF RIVERSIDE
ALLEY IMPROVEMENT PLANS
3675 UNIVERSITY AVENUE

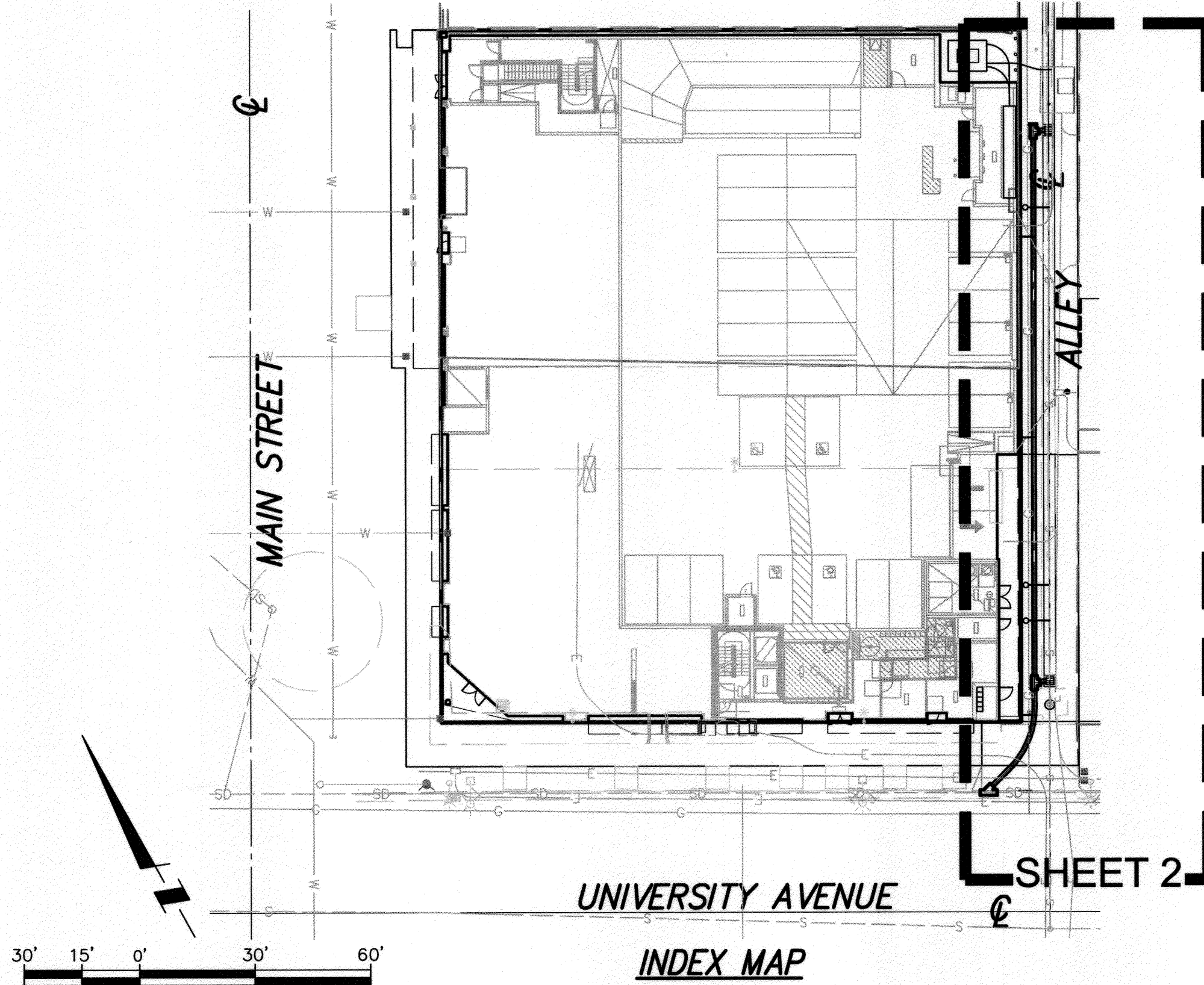

LEGEND

- EXISTING CONTOUR MAJOR
- PROPOSED CONTOUR MAJOR
- EXISTING CONTOUR MINOR
- PROPOSED CONTOUR MINOR
- PROPOSED LOT LINE
- EXISTING LOT LINE
- EXISTING RIGHT OF WAY
- PROPOSED RIGHT OF WAY
- CENTERLINE EXISTING
- EXISTING CURB
- PROPOSED CURB
- EXISTING SIDEWALK
- PROPOSED SIDEWALK
- EXISTING SEWER
- PROPOSED SEWER
- EXISTING WATER
- PROPOSED WATER
- PROPOSED FENCE
- PROPOSED FLOW LINE
- PROPOSED BLOCK WALL
- EXISTING ELEC. CONDUIT
- PROPOSED LANDSCAPE
- PROPOSED AC PAVEMENT
- PROPOSED CONCRETE SIDEWALK

- M.H.
- S.F.
- F.L.
- F.S.
- F.G.
- C/L
- R/W
- P/L
- D/W
- F.F.
- PAD
- T.C.
- S/W
- P.E.
- INV.
- E.G.
- N.G.
- T.B.R.
- P.I.P.
- D.F.
- C.F.
- ELL
- C.O.
- SHR
- ADJ.
- WPJ
- SSPWC
- SPPWC
- MANHOLE
- SQUARE FEET
- FLOW LINE ELEVATION
- FINISH SURFACE ELEVATION
- FINISH GRADE ELEVATION
- CENTERLINE
- RIGHT OF WAY
- PROPERTY LINE
- DRIVEWAY
- FINISH FLOOR ELEVATION
- PAD ELEVATION
- TOP OF CURB
- SIDEWALK
- PAD ELEVATION
- INVERT OF PIPE ELEVATION
- EXISTING GROUND
- NATURAL GROUND
- TO BE REMOVED
- PROTECT IN PLACE
- DEEPEENED FOOTING
- CURB FACE
- ELBOW
- CLEAN OUT
- SEWER LINE
- ADJUST
- WEAKENED PLANE JOINT
- STANDARD SPECIFICATIONS FOR PUBLIC WORKS
- CONSTRUCTION
- STANDARD PLANS FOR PUBLICS WORKS CONSTRUCTION

CONSTRUCTION NOTES

1. CONSTRUCT 3.5" A.C. OVER 9.5" CLASS 2 AGGREGATE BASE. FINAL SECTION SHALL BE DETERMINED BY THE SOILS ENGINEER AT THE COMPLETION OF ROUGH GRADE. R-VALUE=25. V-GUTTER SHALL HAVE THE SAME BASE AS AC PAVEMENT. 1,554 S.F.

2. CONSTRUCT ALLEY SECTION TYPE I PER CITY OF RIVERSIDE STD. DWG. NO. 110. V-GUTTER SHALL HAVE THE SAME BASE AS CONCRETE PAVEMENT. 1,838 S.F.

3. CONSTRUCT ALLEY SECTION TYPE I PER CITY OF RIVERSIDE STD. DWG. NO. 110 WITH CONCRETE PAVEMENT PER CONSTRUCTION NOTE 10. V-GUTTER SHALL HAVE THE SAME BASE AS CONCRETE PAVEMENT. 1,091 S.F.

4. CONSTRUCT DRIVEWAY APPROACH PER CITY OF RIVERSIDE DWG. STD. NO. 302 TYPE I. (MODIFIED) WITH CONCRETE PAVEMENT PER CONSTRUCTION NOTE 10. 174 S.F.

5. INSTALL 3'X3' CATCH BASIN WITH TRAFFIC GRATE PER DETAIL ON SHEET 2. 1 EA.

6. INSTALL 2'X2' CATCH BASIN WITH TRAFFIC GRATE PER DETAIL ON SHEET 2. 1 EA.

7. INSTALL 6" VCP SEWER LATERAL PER CITY OF RIVERSIDE DWG. STD. NO. 562. CONTRACTOR SHALL COORDINATE WITH BUILDING CONTRACTOR FOR THE EXACT LOCATION OF SEWER CLEANOUT. 20 L.F.

8. INSTALL SEWER CLEANOUT PER CITY OF RIVERSIDE DWG. STD. NO. 560. CONTRACTOR SHALL COORDINATE WITH BUILDING CONTRACTOR FOR THE EXACT LOCATION OF SEWER CLEANOUT. 3 EA.

9. EXISTING MANHOLE TO BE ADJUSTED TO GRADE. CONTRACTOR SHALL NOTIFY THE MANHOLE OWNER BEFORE ADJUSTING MANHOLE. 2 EA.

10. CONSTRUCT 7" THICK PCC CONCRETE OVER 8" CLASS 2 AGGREGATE BASE. FINAL SECTION SHALL BE DETERMINED BY THE SOILS ENGINEER. 1,381 S.F.

11. CONCRETE SLAB PER ARCHITECT PLANS. 383 S.F.

12. CONTRACTOR SHALL ADJUST GAS VALVE TO GRADE. CONTRACTOR TO RELOCATE THE GAS VALVE, IF CONFLICT WITH PROPOSED STORM DRAIN. 2 EA.

13. CONSTRUCT UTILITY 4" CONCRETE SLAB PER ARCHITECT PLANS.

14. INSTALL PIPE BOLLARD PER ARCHITECT PLANS.

15. EXISTING ELECTRICAL CONDUIT TO BE ABANDONED PER ELECTRICAL PLANS.

16. SHR. C.O. TO BE ADJ. TO GRADE. CONTRACTOR TO RELOCATE THE C.O. VALVE, IF CONFLICT WITH PROPOSED STORM DRAIN. 2 EA.

17. CONSTRUCT WPJ ON CONCRETE PAVEMENT, SIDEWALK AND V-GUTTER PER SPPWC STD. PLAN 112-2 AND SPPWC SPECIFICATIONS. JOINTS IN PAVEMENT AND V-GUTTER SHALL BE ALIGNED AND SHALL BE CONSTRUCTED SEPARATELY.

QUANTITIES

- 1,554 S.F. SPPWC

- 1,838 S.F. SPPWC

- 1,091 S.F. SPPWC

- 174 S.F. SPPWC

- 1 EA. SPPWC

- 1 EA. SPPWC

- 20 L.F. SPPWC

- 3 EA. SPPWC

- 2 EA. SPPWC

- 1,381 S.F. SPPWC

- 383 S.F. SPPWC

- 2 EA. SPPWC

- 2 EA. SPPWC

- 2 EA. SPPWC

- 2 EA. SPPWC

- 2 EA. SPPWC

- 2 EA. SPPWC

- 2 EA. SPPWC

- 2 EA. SPPWC

- 2 EA. SPPWC

- 2 EA. SPPWC

- 2 EA. SPPWC

- 2 EA. SPPWC

- 2 EA. SPPWC

- 2 EA. SPPWC

- 2 EA. SPPWC

- 2 EA. SPPWC

- 2 EA. SPPWC

- 2 EA. SPPWC

- 2 EA. SPPWC

- 2 EA. SPPWC

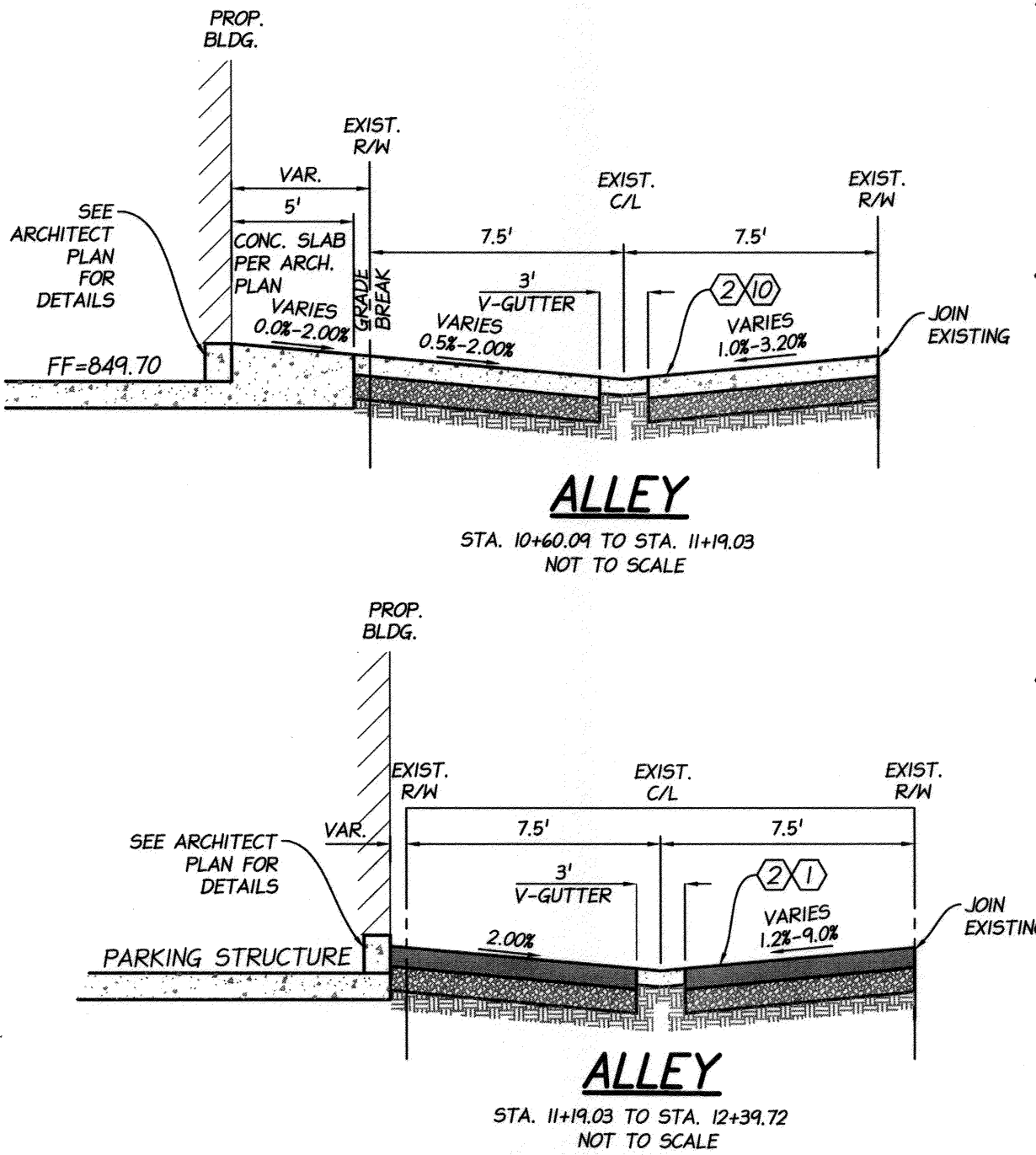

VICINITY MAP

THOMAS GUIDE - PAGE 685, H-3 (2005 EDITION)
SECTION 23 TOWNSHIP 2 SOUTH RANGE 5 WEST
NOT TO SCALE

OWNER/DEVELOPER

RATKOVICH PROPERTIES, LLC
2465 CAMPUS DRIVE, THIRD FLOOR
IRVINE, CA 92612
TEL: (562) 537-1002
CONTACT: ROB DODMAN

ENGINEER

PSOMAS
1500 IOWA AVENUE, SUITE 210
RIVERSIDE, CA 92507
PHONE: (951) 787-8421
FAX: (951) 682-3379

ARCHITECT

DESIGN ARC, INC.
2558 OVERLAND AVENUE, LOS ANGELES, CA, 90064
PHONE: (310) 204-8950
EMAIL: AALPER@DESIGNARC.NET

TOPOGRAPHY SOURCE

EXISTING TOPOGRAPHY IS BASED UPON A FIELD SURVEY BY
PSOMAS
1500 IOWA AVENUE, RIVERSIDE, CA 92507
PH: (951) 787-8421
PERFORMED ON JUNE 2015

SOILS ENGINEER

SALEM ENGINEERING GROUP, INC.
11650 MISSION PARK DR. #108
RANCHO CUCAMONGA, CA 91730
PH: (909) 980-6455
FX: (909) 980-6435

LEGAL DESCRIPTION

PARCEL 1 213-271-005
THAT CERTAIN REAL PROPERTY IN THE CITY OF
RIVERSIDE, COUNTY OF RIVERSIDE, STATE OF CALIFORNIA,
DESCRIBED AS FOLLOWS:

PARCEL 1 OF CITY OF RIVERSIDE CERTIFICATE OF
COMPLIANCE P14-0748 FOR LOT MERGER, RECORDED
OCTOBER 3, 2014 AS DOCUMENT NO. 2014-0377741,
OFFICIAL RECORDS OF RIVERSIDE COUNTY, CALIFORNIA.

SHEET INDEX

SHEET 1 TITLE SHEET
SHEET 2 ALLEY & STORM DRAIN PLAN



BENCHMARK: Z1-RESET 1988 ELEV.= 860.090
CITY OF RIVERSIDE
A STANDARD U.S.C. & G.S. BRASS DISK CEMENTED IN A DRILL HOLE AT THE ENTRANCE TO THE RIVERSIDE MUNICIPAL MUSEUM BUILDING, ABOUT 4' HIGHER THAN THE STREET IT IS 41.6' SOUTH OF A CONCRETE LAMP POST, 16.5' EAST OF THE CENTER OF THE ENTRANCE INTO THE BUILDING, 3.3' WEST OF THE MOST EASTERLY ONE OF 6 COLUMNS, 3.3' EAST OF THE SECOND COLUMN FROM THE EAST AND 6' SOUTH OF THE NORTH EDGE OF THE ARCHWAY.

CITY OF RIVERSIDE PUBLIC UTILITIES
DEPARTMENT-ELECTRIC OVERHEAD & UNDERGROUND
APPROVED BY: *[Signature]* 9-13-14
ELECTRIC ENGINEERING

CITY OF RIVERSIDE PUBLIC UTILITIES
WATER DEPARTMENT REVIEW FOR WATER CONFLICTS
APPROVED BY: *[Signature]* 9/13/2014
WATER ENGINEERING

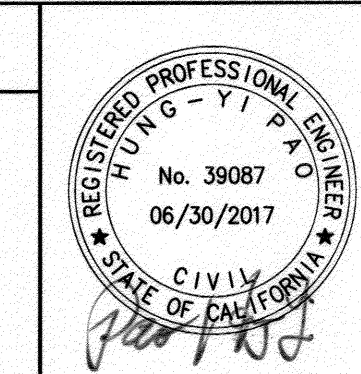

CITY BUSINESS CERTIFICATE NO. 0021337, EXP. 10/31/2016
PSOMAS
1500 IOWA AVENUE, SUITE 210
RIVERSIDE, CA 92507
(951) 787-8421 WWW.PSOMAS.COM
PREPARED BY: *[Signature]* R.C.E. NO. 83557
DATE: 9/13/2014

MARK DESIGNED BY: _____ DRAWN BY: _____ CHECKED BY: _____
REVISIONS: _____
APPR. DATE: _____

CITY OF RIVERSIDE, CALIFORNIA
PUBLIC WORKS DEPARTMENT
APPROVED BY: _____ BY DATE: _____
ENGINEERING MANAGER: *[Signature]* 9/13/14
TRAFFIC ENGINEERING: *[Signature]* 9/13/14
CITY ENGINEER/PW DIRECTOR: _____
DATE: 9/24/14

CITY OF RIVERSIDE
ALLEY IMPROVEMENT PLAN
3675 UNIVERSITY AVENUE
TITLE SHEET
HORIZ. SCALE: AS NOTED VERT. SCALE: AS NOTED

PW15-0702
R-4369
SHEET 1 OF 2
J.N. 4RAT010100

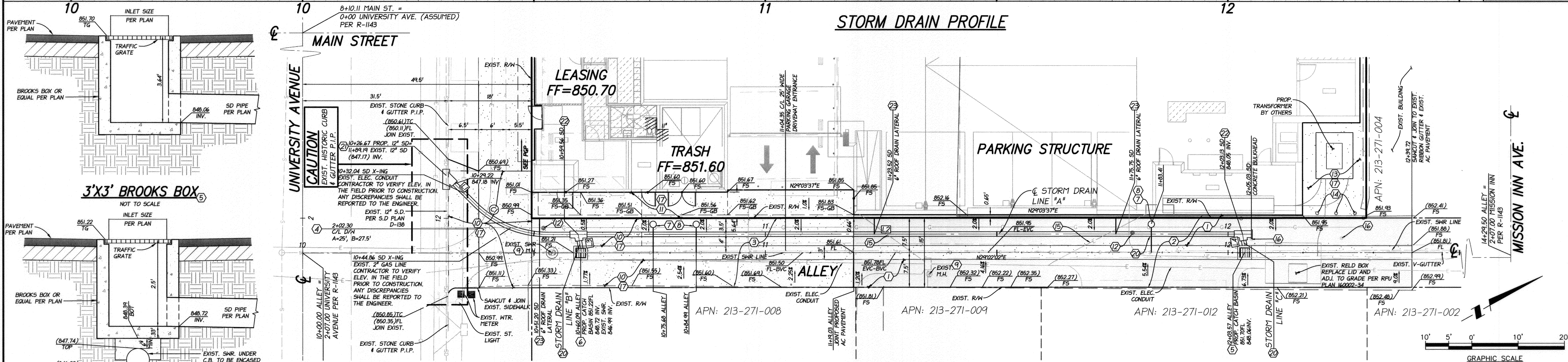
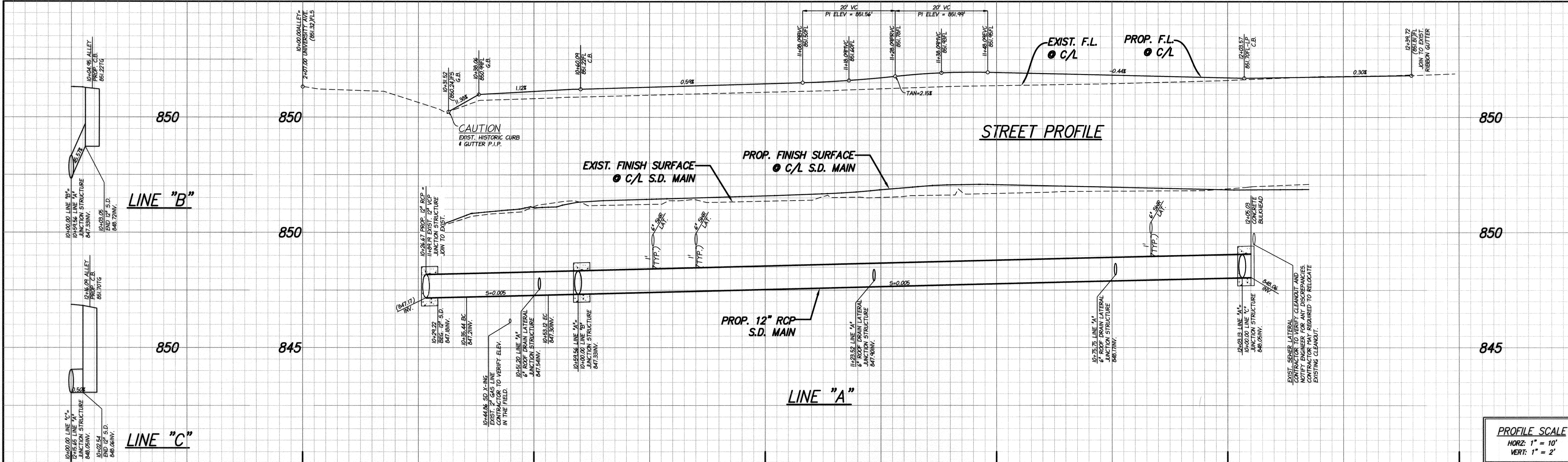

3'x3' BROOKS BOX

NOT TO SCALE

2'x2' BROOKS BOX

NOT TO SCALE

LINE TABLE

LINE #	BEARING	DISTANCE
L1	N74° 03' 37"E	6.22'
L2	N29° 02' 02"E	151.91'
L3	S70° 54' 48"W	3.05'
L4	S70° 54' 48"W	2.54'

CURVE TABLE

CURVE #	LENGTH	RADIUS	DELTA
C1	17.68'	22.50'	45°01'36"

CONSTRUCTION NOTES

CONSTRUCT 3.5" A.C. OVER 9.5" CLASS 2 AGGREGATE BASE. FINAL SECTION SHALL BE DETERMINED BY THE SOILS ENGINEER AT THE COMPLETION OF ROUGH GRADE. R-VALUE=25. V-GUTTER SHALL HAVE THE SAME BASE AS AC PAVEMENT.

CONSTRUCT ALLEY SECTION TYPE I PER CITY OF RIVERSIDE STD. DWG. NO. 110. V-GUTTER SHALL HAVE THE SAME BASE AS CONCRETE PAVEMENT.

CONSTRUCT ALLEY SECTION TYPE I PER CITY OF RIVERSIDE STD. DWG. NO. 110 WITH CONCRETE PAVEMENT PER CONSTRUCTION NOTE 10. V-GUTTER SHALL HAVE THE SAME BASE AS CONCRETE PAVEMENT.

CONSTRUCT DRIVEWAY APPROACH PER CITY OF RIVERSIDE STD. DWG. NO. 302 TYPE I. (MODIFIED) WITH CONCRETE PAVEMENT PER CONSTRUCTION NOTE 10.

INSTALL 3'x3' CATCH BASIN WITH TRAFFIC GRATE PER DETAIL ON SHEET 2.

INSTALL 2'x2' CATCH BASIN WITH TRAFFIC GRATE PER DETAIL ON SHEET 2.

INSTALL 6" VCP SEWER LATERAL PER CITY OF RIVERSIDE STD. DWG. NO. 562. CONTRACTOR SHALL COORDINATE WITH BUILDING CONTRACTOR FOR THE EXACT LOCATION OF SEWER CLEANOUT.

INSTALL SEWER CLEANOUT PER CITY OF RIVERSIDE STD. DWG. NO. 560. CONTRACTOR SHALL COORDINATE WITH BUILDING CONTRACTOR FOR THE EXACT LOCATION OF SEWER CLEANOUT.

EXISTING MANHOLE TO BE ADJUSTED TO GRADE. CONTRACTOR SHALL NOTIFY THE MANHOLE OWNER BEFORE ADJUSTING MANHOLE.

CONSTRUCT 7" THICK PCC CONCRETE OVER 8" CLASS 2 AGGREGATE BASE. FINAL SECTION SHALL BE DETERMINED BY THE SOILS ENGINEER.

CONTRACTOR SHALL ADJUST GAS VALVE TO GRADE. CONTRACTOR TO RELOCATE THE GAS VALVE, IF CONFLICT WITH PROPOSED STORM DRAIN.

CONSTRUCT UTILITY 4" CONCRETE SLAB PER ARCHITECT PLANS.

INSTALL PIPE BOLLARD PER ARCHITECT PLANS.

EXISTING ELECTRICAL CONDUIT TO BE ABANDONED PER ELECTRICAL PLANS.

SHR. C.O. TO BE ADJ. TO GRADE. CONTRACTOR TO RELOCATE THE C.O. VALVE, IF CONFLICT WITH PROPOSED STORM DRAIN.

CONSTRUCT MPJ ON CONCRETE PAVEMENT, SIDEWALK AND V-GUTTER PER SPPWC STD. PLAN 112-2 AND SPPWC SPECIFICATIONS. JOINTS IN PAVEMENT AND V-GUTTER SHALL BE ALIGNED AND SHALL BE CONSTRUCTED SEPARATELY.

STORM DRAIN CONSTRUCTION NOTES

INSTALL 12" RCP STORM DRAIN PIPE. D-LOAD=1600, BEDDING CASE 2 PER CITY OF RIVERSIDE STD. DWG. NO. 452.

INSTALL JUNCTION STRUCTURE B PER RIVERSIDE STD. DWG. 421. A=45", B=12", C=2.55', D=12", E=2.05', L=2.4'

INSTALL JUNCTION STRUCTURE B PER RIVERSIDE STD. DWG. 421. A=80", B=12", C=1.44', D=12", E=0.90', L=1.7'

INSTALL JUNCTION STRUCTURE NO. 4, CASE I PER RIVERSIDE STD. DWG. 423. CONTRACTOR SHALL COORDINATE WITH BUILDING CONTRACTOR FOR THE EXACT LOCATION OF ROOF DRAIN LATERALS.