

STREET GENERAL NOTES - CITY

- NO PERSON SHALL PERFORM ANY CONSTRUCTION ACTIVITY OR INSTALL ANY OBJECTS WITHIN THE PUBLIC RIGHTS-OF-WAY OR EASEMENTS OF THE CITY OF RIVERSIDE WITHOUT A VALID CONSTRUCTION PERMIT OR, A STREET OPENING PERMIT OR AN ENCROACHMENT PERMIT ISSUED BY THE CITY'S PUBLIC WORKS DEPARTMENT.
- IT SHALL BE THE RESPONSIBILITY OF THE CONTRACTOR TO CLEAR THE RIGHT OF WAY IN ACCORDANCE WITH THE PROVISIONS OF LAW AS IT AFFECTS EACH UTILITY INCLUDING IRRIGATION LINES AND APPURTENANCES AND AT NO COST TO THE CITY.
- CONSTRUCTION SHALL BE IN ACCORDANCE WITH THE CITY OF RIVERSIDE DEPARTMENT OF PUBLIC WORKS, STANDARD DRAWINGS, ITS SUPPLEMENTAL NOTES AND THE STANDARD SPECIFICATIONS FOR PUBLIC WORKS CONSTRUCTION, CURRENT EDITION.
- THE PRIVATE ENGINEER SIGNING THESE PLANS IS RESPONSIBLE FOR ASSURING THE ACCURACY AND ACCEPTABILITY OF THE WORK HEREON. IN THE EVENT OF DISCREPANCIES ARISING DURING CONSTRUCTION, THE PRIVATE ENGINEER SHALL BE RESPONSIBLE FOR DETERMINING AN ACCEPTABLE SOLUTION AND REVISING THE PLANS FOR APPROVAL BY THE CITY.
- QUANTITIES SHOWN ARE FOR INFORMATION ONLY AND THE CITY OF RIVERSIDE IS NOT RESPONSIBLE FOR THEIR ACCURACY.
- THE DEVELOPER SHALL BE RESPONSIBLE FOR PRESERVING OR RE-ESTABLISHING AND REFERENCE SURVEY MONUMENTS DESTROYED, DISTURBED OR BURIED AS A RESULT OF CONSTRUCTION SHOWN HEREON.
- THE CONTRACTOR IS RESPONSIBLE FOR INSTALLATION OF STREET LIGHTS AND UNDERGROUND ELECTRIC UTILITY FACILITIES. CONTACT RIVERSIDE PUBLIC UTILITIES 90 DAYS IN ADVANCE OF CONSTRUCTION TO OBTAIN APPROVED STREET LIGHT AND ELECTRIC PLANS.
- ALL FLAGGED ELEVATIONS SHALL BE STAKED IN THE FIELD BY THE PRIVATE ENGINEER.
- WHERE NEW PAVEMENT IS TO JOIN THE EXISTING PAVEMENT, THE EDGE OF THE EXISTING PAVEMENT SHALL BE TRIMMED IN A SMOOTH AND STRAIGHT LINE AND SHALL RECEIVE HEADER CUTS. CONSTRUCT MATCH-UP PAVING AS SHOWN ON THE PLANS AND OVERLAY PAVING AS DIRECTED IN THE FIELD TO PRODUCE A SMOOTH SECTION.
- CONSTRUCT DRIVEWAY APPROACHES PER STANDARD DRAWING 302, EXACT SIZE AND LOCATION TO BE STAKED BY THE PRIVATE ENGINEER PRIOR TO CONSTRUCTION OF THE CURB AND GUTTER.
- THE SUBDIVIDER SHALL ARRANGE FOR A SOIL TEST TO BE MADE BY A SOILS ENGINEER AFTER THE STREETS HAVE BEEN PREPARED TO ROUGH GRADE AND PRIOR TO CURB AND GUTTER CONSTRUCTION. DEPTH OF BASE MATERIAL AND A.C. PAVING SHALL BE DETERMINED BY THE CITY OF RIVERSIDE DESIGN STANDARDS AND TEST PROCEDURES.
- ALL OVERHANGING TREE LIMBS THAT ARE LESS THAN 14' ABOVE THE STREET GRADE SHALL BE TRIMMED BACK.
- THE DEVELOPER AND/OR CONTRACTOR SHALL CONTACT THE STREET DIVISION (351-6127) TO PICK UP ANY EXISTING STD. 180 BARRICADES THAT ARE BEING REMOVED. THE CITY'S INSPECTOR WILL MAKE THE FINAL DETERMINATION ON WHETHER A BARRICADE CAN BE RELOCATED.
- ON ALL AREAS WITHIN PUBLIC RIGHT OF WAY WHERE THE FILL IS ONE (1) FOOT OR GREATER, A LETTER WILL BE REQUIRED FROM THE SOILS ENGINEER, CERTIFYING THE COMPACTION OF THE FILL BELOW SUBGRADE, PRIOR TO ISSUANCE OF THE CONSTRUCTION PERMIT/CUT SHEETS.
- ALL TRAFFIC SIGNS SHALL BE INSTALLED PRIOR TO OPENING THE STREETS TO TRAFFIC.
- ANY TRAFFIC CONTROL STRIPING OBLITERATED AND/OR BADLY WORN DURING CONSTRUCTION SHALL BE RESTORED BY THE CONTRACTOR WITHIN FIVE DAYS AFTER NOTIFICATION FROM THE CITY INSPECTORS.
- FINAL STRIPING FOR TRAFFIC CONTROL AND/OR PAVEMENT MARKING TO BE THE RESPONSIBILITY OF THE DEVELOPER.
- THE CONTRACTOR SHALL CALL IN A LOCATION REQUEST TO UNDERGROUND SERVICE ALERT (USA), PHONE #1-800-227-2600, TWO WORKING DAYS BEFORE DIGGING. NO CONSTRUCTION PERMIT WILL BE ISSUED BY THE PUBLIC WORKS DEPARTMENT INVOLVING EXCAVATION FOR UNDERGROUND FACILITIES UNLESS THE APPLICANT HAS BEEN PROVIDED AN INQUIRY IDENTIFICATION NUMBER BY U.S.A.
- THE SEWER CONTRACTOR SHALL ADJUST MANHOLES TO FINAL GRADE AFTER PAVING IS COMPLETED.
- BEFORE THE RIP-RAP AT THE OUTLET OF ANY DRAINAGE STRUCTURE IS ACCEPTED BY THE CITY, IT SHALL BE TESTED UNDER FLOWS AS CLOSE AS POSSIBLE TO DESIGN CONDITIONS WITH WATER OBTAINED FROM FIRE HYDRANTS IN THE IMMEDIATE AREA.
- IN PAVEMENT OVERLAY AREAS, ANY DISTRESSED EXISTING PAVEMENT SHALL BE REMOVED AND REPLACED AS DIRECTED BY THE INSPECTOR PRIOR TO OVERLAYING WITH A.C. PAVING.
- THE CONTRACTOR SHALL COORDINATE TRENCHING FOR CABLE TELEVISION WITH OTHER TRENCHING WITHIN THE PROJECT LIMITS.
- CITY FORCES WILL NOT ADJUST WATER VALVES. ALL WATER VALVE CANS TO BE ADJUSTED TO GRADE BY CONTRACTOR.

PUBLIC UTILITIES DEPARTMENT NOTE

WORK CONTAINED WITHIN THESE PLANS SHALL NOT COMMENCE UNTIL A CONSTRUCTION PERMIT HAS BEEN OBTAINED FROM THE CITY OF RIVERSIDE PUBLIC WORKS DEPARTMENT.

ENCROACHMENT NOTE

WORK CONTAINED WITHIN THESE PLANS SHALL NOT COMMENCE UNTIL A CONSTRUCTION PERMIT HAS BEEN OBTAINED FROM THE CITY OF RIVERSIDE PUBLIC WORKS DEPARTMENT.

CONTACT INFO

**RIVERSIDE PUBLIC UTILITIES
ELECTRICAL DIVISION**
FOR STREET LIGHTS, OVERHEAD &
UNDERGROUND FACILITIES
STEVE JOHAL
PH. NO. (951)826-5830
3901 ORANGE STREET
RIVERSIDE, CA 92501

CITY WATER DEPARTMENT NOTE

A MINIMUM COVER OF 24" SHALL BE MAINTAINED ABOVE ALL WATER LINES DURING ALL EXCAVATION, BACKFILL AND COMPACTION ACTIVITIES DURING STREET IMPROVEMENTS. CONTACT TONY REDMAN AT (951) 826-2126, IF COVER IS REDUCED BEYOND THIS OR FOR ANY OTHER QUESTIONS REGARDING THIS REQUIREMENT.

PROFESSIONAL ENGINEER'S NOTICE
TO CONTRACTOR

ALL CONTRACTORS AND SUBCONTRACTORS PERFORMING WORK SHOWN ON OR RELATED TO THESE PLANS SHALL CONDUCT THEIR OPERATIONS SO THAT ALL EMPLOYEES ARE PROVIDED A SAFE PLACE TO WORK AND THE PUBLIC IS PROTECTED. ALL CONTRACTORS AND SUBCONTRACTORS SHALL COMPLY WITH THE "OCCUPATIONAL SAFETY AND HEALTH REGULATIONS" OF THE U.S. DEPARTMENT OF LABOR AND THE STATE OF CALIFORNIA DEPARTMENT OF INDUSTRIAL RELATIONS "CONSTRUCTION SAFETY ORDERS." THE CIVIL ENGINEER SHALL NOT BE RESPONSIBLE IN ANY WAY FOR THE CONTRACTORS AND SUBCONTRACTORS COMPLIANCE WITH SAID REGULATIONS AND ORDERS.

CONTRACTOR FURTHER AGREES THAT HE SHALL ASSUME SOLE AND COMPLETE RESPONSIBILITY FOR JOB-SITE CONDITIONS DURING THE COURSE OF CONSTRUCTION OF THIS PROJECT, INCLUDING SAFETY OF ALL PERSONS AND PROPERTY, THAT THIS REQUIREMENT SHALL APPLY CONTINUOUSLY AND NOT BE LIMITED TO NORMAL WORKING HOURS, AND THAT THE CONTRACTOR SHALL DEFEND, INDEMNIFY AND HOLD THE OWNER AND THE CIVIL ENGINEER HARMLESS FROM ANY AND ALL LIABILITY, REAL OR ALLEGED, IN CONNECTION WITH THE PERFORMANCE OF WORK ON THIS PROJECT, EXCEPTING FOR LIABILITY ARISING FROM THE SOLE NEGLIGENCE OF THE OWNER OR ENGINEER.

THE EXISTENCE AND APPROXIMATE LOCATIONS OF ANY UNDERGROUND UTILITIES OR STRUCTURES SHOWN ON THESE PLANS ARE OBTAINED BY A SEARCH OF THE AVAILABLE RECORDS. THE CIVIL ENGINEER ASSUMES NO LIABILITY AS TO THE EXACT LOCATION OF SAID LINES NOR FOR UTILITY OR IRRIGATION LINES WHOSE LOCATIONS ARE NOT SHOWN. THE CONTRACTOR SHALL BE RESPONSIBLE FOR NOTIFYING ALL UTILITY AND IRRIGATION COMPANIES FOR ANY DAMAGE OR PROTECTION TO THESE LINES.

LEGEND:

ADA	AMERICAN DISABILITIES ACT	TW	TOP OF WALL
AC	ASPHALT TO CONCRETE	UB	UTILITY BOX
B STR	BIKE LANE STRIP	US	UTILITY SLAB
BFD	BACK FLOW DEVICE	USWB	UNDER SIDEWALK DRAIN
BSW	BACK OF SIDEWALK	UTIL	UTILITY VAULT
CFL	CHAIN LINK FENCE	UV	UTILITY VALVE
CONC	CONCRETE	WM	WATER METER
CO	CLEAN OUT	WV	WATER VALVE
COR	CORNER	600	60 PENNY NAIL
CP MX	CONTROL POINT MARKER X		BACK FLOW DEVICE
DI	DRAIN INLET	+	FIRE HYDRANT
DNK	DRIVEWAY MARK X		MANHOLE AS NOTED
ECC	EDGE OF CONCRETE		POWER POLE
ELEC	ELECTRIC		SIGN
FCE	FENCE MOW STRIP		TREE
FF	FINISHED FLOOR		CONTROL POINT
FH	FIRE HYDRANT		
FL	FLOWLINE		
PP	POWER POLE		
FSC	FINISH CONCRETE SURFACE		
FSXC	RAMP LANDING		
GL	GUTTER LINE		
IVC	IRRIGATION CONTROL VALVE		
L/A	LANDSCAPED AREA		
MN	MAGNAIL		
NG	NATURAL GROUND		
PP	POWER POLE		
RGL	RIBBON GUTTER LIP		
RGR	RIBBON GUTTER		
SB	SPEED BUMP		
SCD	SEWER CLEANOUT		
SGDI	STEEL GRATE DROP INLET		
SW	SIDEWALK		
TC	TOP OF CURB		
TP	TOP OF PAVEMENT		
TS	TOP OF SLOPE		
TSP	TRAFFIC SIGNAL LIGHT		

CONSTRUCTION NOTES AND QUANTITY ESTIMATES

- CONSTRUCT 6" PCC CURB & GUTTER (TYPE 1) PER RIV. CITY STD. DWG. 200 100 L.F.
- CONSTRUCT PCC SIDEWALK PER RIV. CITY STD. DWG. 325 (WIDTH PER PLAN) 410 S.F.
- SAWCUT, REMOVE & DISPOSE OF EXISTING CURB & GUTTER, SIDEWALK AND/OR DRIVEWAY 1127 L.F.
- SAWCUT, REMOVE & DISPOSE OF EXISTING AC/AB 202 S.F.
- INSTALL FULL DEPTH AC AS REQUIRED TO MATCH EXISTING TOP OF PAVEMENT AND GUTTER LIP 105 S.F.
- JOIN & MATCH EXISTING FINISH SURFACE FLUSH 1 L.S.
- PROTECT IN PLACE 2 E.A.
- INSTALL NEW TURF AND RECONFIGURE EXISTING SPRINKLERS TO PROVIDE FULL COVERAGE ON EXIST & NEW TURF 1 L.S.
- CONSTRUCT PARKWAY DRAIN (TYPE-2) PER RIV. CITY STD. DWG. 410, S=24" 1 E.A.

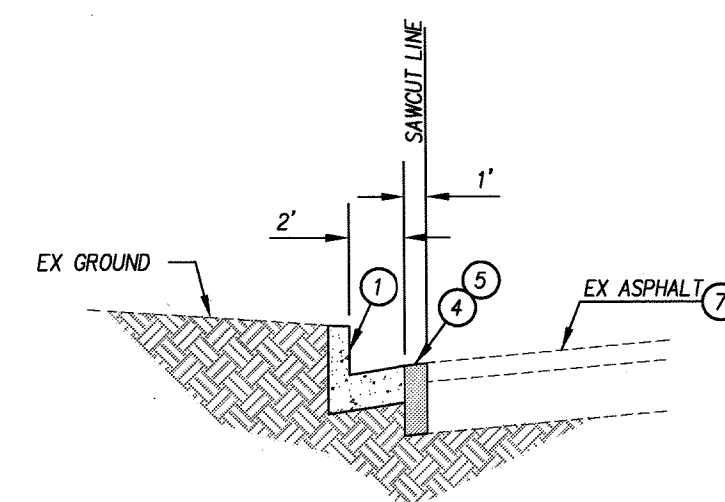
SECTION 'A'-A'
NOT TO SCALE

5+68.53 C/L LA SIERRA AVE =
10+00.00 C/L COLLETT AVE

COLLETT AVE

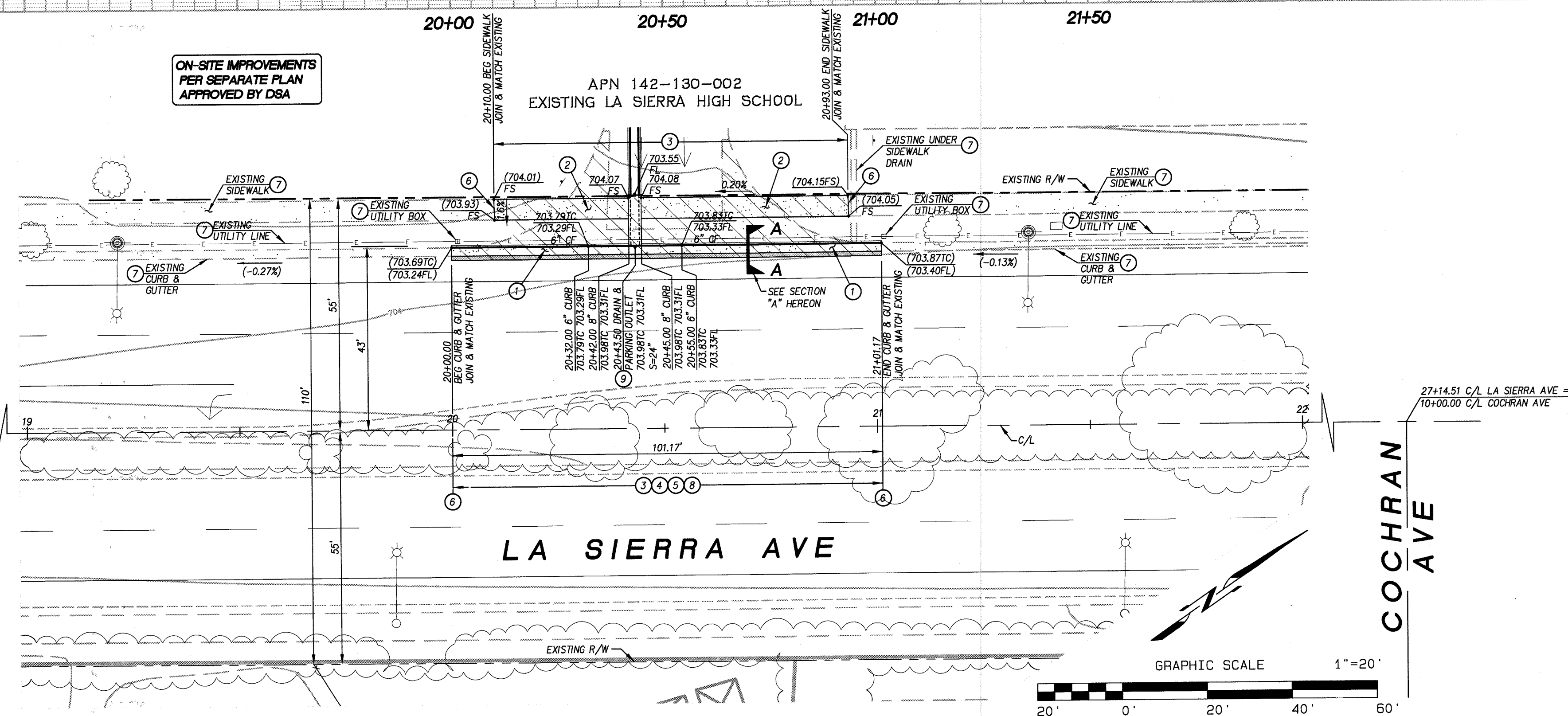

GRAPHIC SCALE 1"=20'
20' 0' 20' 40' 60'

WDID#	PW 16-0816
ACCT. NO.	R-4404
SHEET	1 OF 1
EPIC WORK ORDER:	104.06

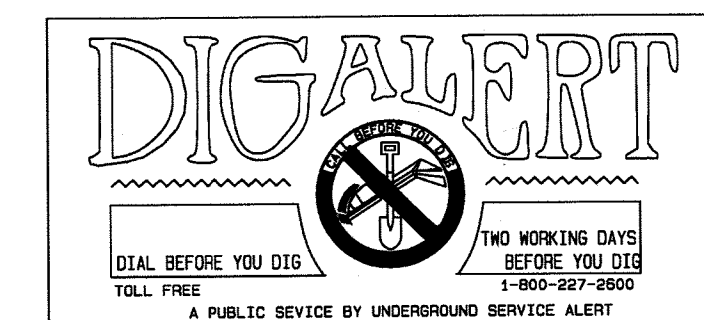

**CITY OF RIVERSIDE
PUBLIC UTILITIES DEPARTMENT - ELECTRIC**
APPROVED BY: [Signature] 5-8-17
DATE: 5-8-17

**CITY OF RIVERSIDE
PUBLIC UTILITIES DEPARTMENT - WATER**
APPROVED BY: [Signature] 5/5/17
DATE: 5/5/17

EPIC ENGINEERS
CIVIL ENGINEERING PLANNING
101 E. REDLANDS BLVD.
SUITE 140
REDLANDS, CA 92373
TELE 909-792-5989 FAX 909-792-8889

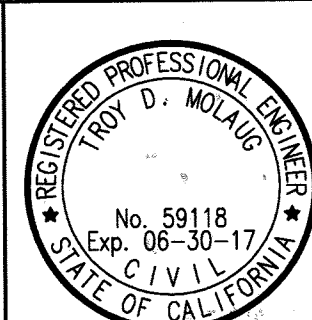

MARK	REVISIONS	APPR.	DATE

**CITY OF RIVERSIDE, CALIFORNIA
PUBLIC WORKS DEPARTMENT**
APPROVED BY: [Signature] 5-8-17
DATE: 5-16-17

**LA SIERRA AVE
TITLE SHEET
AND PLAN SHEET**
STREET IMPROVEMENT PLAN
HORIZONTAL SCALE: 1" = 20' VERTICAL SCALE: 1" = 4'