

#### GRADATION REQUIREMENTS

SCREEN SIZE (INCHES)	PERCENTAGE PASSING
8	100
6	50-85
4	0-50

#### NOTE:

ROCK MUST BE CLEAN SMOOTH AND OBTAINED FROM SINGLE SOURCE. MORTAR MUST COMPLY WITH SECTION 201-5 OF THE STANDARD SPECIFICATIONS. DO NOT USE FILTER FABRIC. ROCK MUST BE PLACED WHILE CONCRETE IS STILL PLASTIC. REMOVE CONCRETE ADHERING TO THE EXPOSED SURFACES OF THE ROCK. LOOSE ROCKS OR ROCKS WITH A GAP GREATER THAN 3/8 INCH MUST BE RESET BY AN AUTHORIZED METHOD. THE ROCK GAP IS MEASURED FROM THE EDGE OF THE ROCK TO THE SURROUNDING CONCRETE BEDDING.

#### ROCK BLANKET

NOT TO SCALE

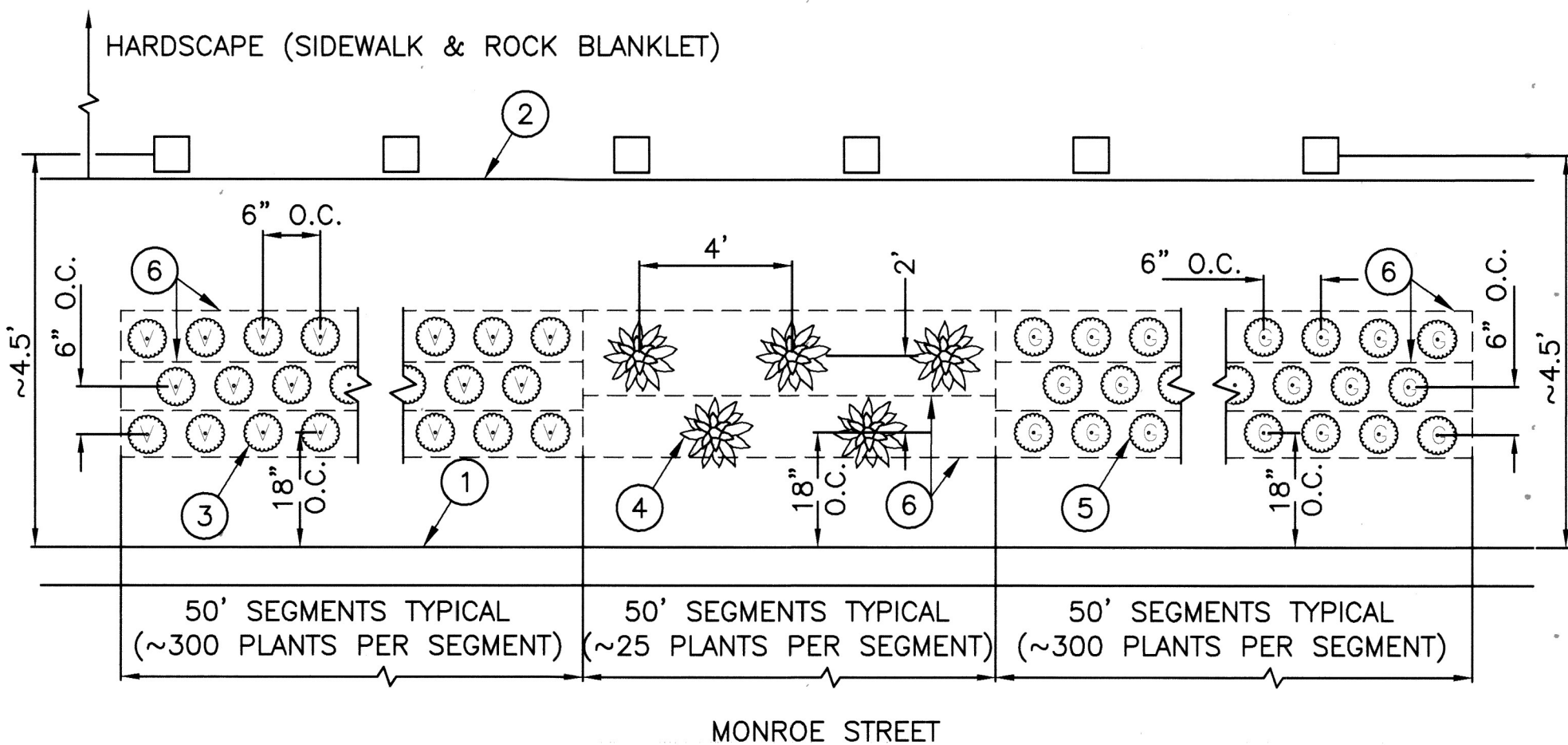
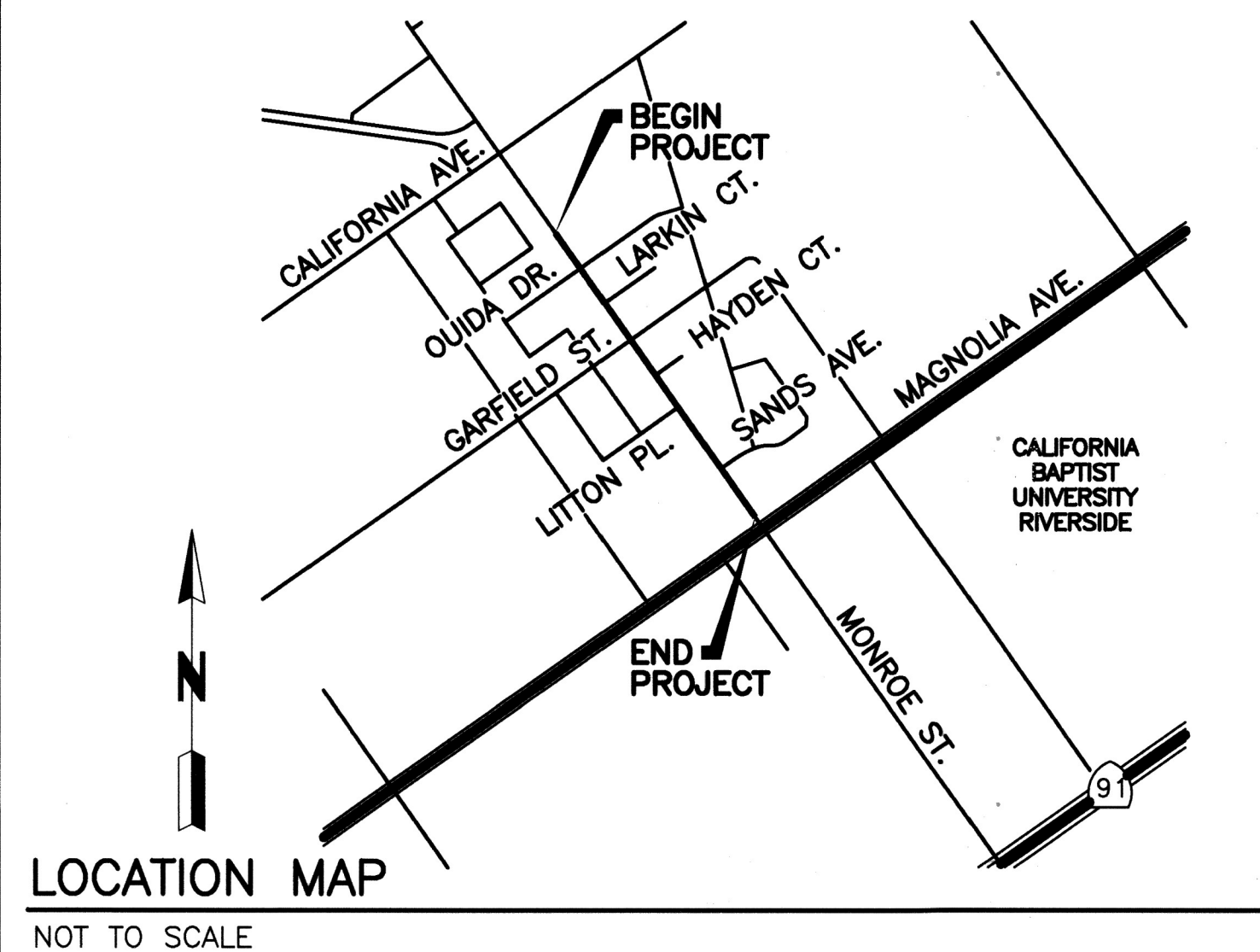

#### NOTES:

- EXISTING CURB
- EXISTING FENCE
- PURPLE VERBENA
- ORANGE DAYLILY
- SILVER LEAF TRAILING GAZANIA
- DRIP LINES TO BE INSTALLED IN BETWEEN AND AROUND PLANTS

#### PLANTING SPACING DIAGRAM - SEGMENTS 2 & 3 WEST SIDE ONLY

NOT TO SCALE

#### BENCHMARK:

P.K. NAIL & TAG IN THE MOST WESTERLY CURB RETURN OF MONROE STREET AND GARFIELD STREET.

NAVD 29

ELEVATION: 760.163

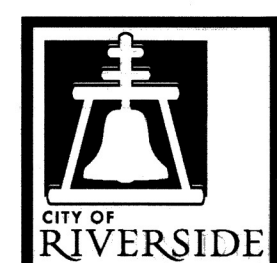

#### ENGINEER IN RESPONSIBLE CHARGE

Swetaben C. Patel  
R.C.E. No. 72032 EXPIRES: 6-30-18  
DATE: 12/21/17



MARK	REVISIONS	APPR.	DATE

#### CITY OF RIVERSIDE, CALIFORNIA DEPARTMENT OF PUBLIC WORKS

APPROVED BY	BY	DATE	APPROVES BY
ENGINEERING MANAGER			
CONSTRUCTION ADMIN.	S.H.	12-27-17	CITY ENGINEER
TRAFFIC DIVISION			
STREETS DIVISION			
SURVEY			

MEDIAN IMPROVEMENTS	DESIGN WORK ORDER NO.: 1804007 CONSTR. WORK ORDER NO.: 1804009
2017/2018 ARTERIAL AND MINOR STREETS MAINTENANCE, PHASE 1 GENERAL NOTES AND INDEX MAP <b>MONROE STREET</b>	<b>R-4420L</b> SHEET 1 OF 5 FILE NAME:

#### GENERAL NOTES FOR PUBLIC LANDSCAPES:

- ALL RELATED WORK SHALL CONFORM TO THE CITY OF RIVERSIDE PUBLIC WORKS DEPARTMENT STANDARDS AND SPECIFICATIONS FOR PLANTING AND IRRIGATION WORK. (SECTIONS 02441 AND 02483)
- A "PUBLIC LANDSCAPE" PERMIT, AS ISSUED BY THE PUBLIC WORKS DEPARTMENT IS REQUIRED. CONTACT THE PUBLIC WORKS LANDSCAPE INSPECTOR AT (951) 351-6313 TO SCHEDULE A PRE-CONSTRUCTION MEETING AND TO OBTAIN THE PERMIT.
- WHEN CALLING FOR INSPECTIONS, CONTACT THE PUBLIC WORKS LANDSCAPE INSPECTOR A MINIMUM OF 48 HOURS IN ADVANCE TO SCHEDULE AN INSPECTION. A WRITTEN APPROVAL WILL BE PROVIDED ON THE PUBLIC LANDSCAPE PERMIT CARD FOR EACH STAGE OF INSPECTION. A VERBAL APPROVAL WILL NOT BE ACCEPTABLE. INSPECTIONS ARE REQUIRED PER THE STANDARD SPECIFICATIONS, AND INCLUDE BUT ARE NOT NECESSARILY LIMITED TO THE FOLLOWING:
  - AFTER COMPLETION OF FINAL GRADING AND WHEN ALL UTILITY SERVICES HAVE BEEN MARKED, BUT PRIOR TO INITIATING ANY LANDSCAPE WORK WITHIN THE PUBLIC RIGHT OF WAY.
  - AT TIME OF INSTALLATION OF IRRIGATION SLEEVES AND CONSTANT PRESSURE MAINLINES, BUT PRIOR TO BACKFILL OF TRENCHES FOR SAME (NOTE: MAINLINES MUST BE PRESSURE TESTED IN THE PRESENCE OF THE PUBLIC WORKS LANDSCAPE INSPECTOR).
  - AT TIME OF INSTALLATION OF IRRIGATION VALVES, LATERALS AND HEADS.
  - FOR SPOTTING OF ALL TREES PRIOR TO DIGGING PLANTING PITS.
  - WHILE DIGGING PLANT PITS AND PLANTING/ RELOCATING TREES.
  - AFTER PLANTING AND ALL OTHER INDICATED OR SPECIFIED WORK HAS BEEN COMPLETED, FOR START OF MAINTENANCE.
  - AT SUBSTANTIAL COMPLETION OF THE PROJECT FOR CITY'S ACCEPTANCE TO START THE REQUIRED MAINTENANCE PERIOD.
  - AT THE END OF THE MAINTENANCE PERIOD, THE CONTRACTOR/DEVELOPER SHALL CALL THE PUBLIC WORKS LANDSCAPE INSPECTOR AT THE NUMBER LISTED ABOVE FOR A FINAL ACCEPTANCE INSPECTION IN ORDER TO BE RELEASED FROM MAINTENANCE. CONTRACTOR'S BOND WILL NOT BE RELEASED UNTIL AFTER CITY'S ISSUANCE OF WRITTEN NOTIFICATION THAT THE PROJECT HAS PASSED FINAL INSPECTION AND THE PUBLIC WORKS DEPARTMENT IS ASSUMING MAINTENANCE RESPONSIBILITIES.
- THE CONTRACTOR SHALL BE RESPONSIBLE TO ACCEPTABLY MAINTAIN ALL PLANTINGS FOR A MINIMUM OF 1 YEAR AS SPECIFIED IN THE BID DOCUMENTS.
- CONTRACTOR SHALL KEEP EXISTING IRRIGATION SYSTEMS OPERATIONAL AND SHALL BE RESPONSIBLE FOR REPLACING ANY DEAD PLANTS AND TREES AND/OR ANY PLANTS DUE TO VANDALISM, THEFT, AND CAR ACCIDENTS AT THE CONTRACTOR'S EXPENSE.
- RECYCLED WATER PIPE SHALL BE PURPLE COLOR CODED INTEGRALLY STAMPED OR MARKED AS "CAUTION-RECYCLED WATER-DO NOT DRINK" AND "PELIGRO: AGUA IMPURA-NO BEBER" OR USE VINYL WRAP OR USE RECYCLED WATER WARNING TAPE. ALL VALVE, AIR/VACUUM RELIEF, AND FLUSH VALVE BOXES ARE TO BE PURPLE. NETA-FIM DRIP TUBING IS TO BE COLORED CODED RECLAIMED.

#### PLANTING NOTES:

- ALL PLANTINGS ARE TO BE PLANTED IN A TRIANGLE SPACING. AMENDMENT IS TO BE INSTALLED IN PLANTERS BEFORE PLANTING IS INSTALLED IN CONJUNCTION WITH RECOMMENDATION ON SOILS REPORT.
- CONTRACTOR SHALL NOTIFY THE LANDSCAPE INSPECTOR TO SITE CONDITIONS WHICH PREVENT INSTALLATION PER PLANS IN A REASONABLE MANNER.
- CONTRACTOR SHALL BE LIABLE FOR REMOVING AND RE-INSTALLING ALL IRRIGATION EQUIPMENT AND RE-PLANTING AREAS WHICH ARE NOT INSTALLED PER PLAN/SPECIFICATIONS.
- IRRIGATION SHALL BE INSTALLED AFTER THE PLACEMENT OF CONCRETE IMPROVEMENTS. DRIP IRRIGATION IS TO BE INSTALLED AFTER PLANTS ARE INSTALLED. SHRUBS SHALL BE PLANTED AFTER THE IRRIGATION COVERAGE TEST HAS BEEN APPROVED BY THE PUBLIC WORKS LANDSCAPE INSPECTOR. (REFER TO SPECIFICATIONS)
- PLACE SHRUBS PER PLAN AND BETWEEN IRRIGATION DRIP LINES.
- INSTALL SHREDDED MULCH IN ALL SHRUB AREAS AT A DEPTH OF 2" UNLESS OTHERWISE INDICATED ON THE PLANS.
- THE CONTRACTOR IS RESPONSIBLE FOR ALL REPAIRS AND/OR REPLACEMENT OF ANY DAMAGED LANDSCAPE AREAS BEYOND THE LIMIT OF WORK, AS A DIRECT RESULT OF THE LANDSCAPE CONSTRUCTION BY THE CONTRACTOR AND/OR BY HIS SUB-CONTRACTOR. REPLACEMENT ITEMS SHALL BE AN EXACT DUPLICATE OF THE ORIGINAL WORK, UNLESS OTHERWISE APPROVED BY THE CITY.
- CLEAN-UP SHALL TAKE PLACE ON A DAILY BASIS UNLESS OTHERWISE APPROVED BY THE PUBLIC WORKS LANDSCAPE INSPECTOR.
- THE PLANTING PLANS ARE ONLY ACCURATE FOR THE PLANTING LOCATION AND PLANT SIZE. THE CONTRACTOR SHALL VERIFY ALL QUANTITIES.
- REPLACEMENT OF DAMAGED OR DESTROYED PLANTINGS SHALL TAKE PLACE WITHIN 48 HOURS OF NOTIFICATION BY THE PUBLIC WORKS LANDSCAPE INSPECTOR, OR SAID REPLACEMENT ITEMS SHALL BE DEDUCTED FROM THE CONTRACTOR'S FINAL BILLING.
- A SITE SHALL BE PRE-SELECTED BY THE PUBLIC WORKS LANDSCAPE INSPECTOR FOR PLANT DELIVERY AND APPROVAL FOR MIXING OF BACKFILL.
- MAINTENANCE PERIOD SHALL BE ONE YEAR (365) CONSECUTIVE CALENDAR DAYS FOR TREES AND SHRUBS FROM DATE OF ACCEPTANCE. MAINTENANCE SHALL INCLUDE WEEKLY WEED AND RODENT ABATEMENT PROCEDURES INCLUDING FOLIAR APPLICATION OF CHELATED IRON AND TRACE MINERALS 90 DAYS APART.
- ALL PLANTING AND IRRIGATION WORK SHALL BE GUARANTEED AGAINST ANY AND ALL POOR, INADEQUATE OR INFERIOR MATERIALS AND/OR WORKMANSHIP FOR A PERIOD OF ONE (1) YEAR FOLLOWING THE DATE OF PROJECT ACCEPTANCE.

#### IRRIGATION CONSTRUCTION NOTES:

- CONTRACTOR TO KEEP AND USE ALL EXISTING IRRIGATION METERS AND BACKFLOW PREVENTORS. INSTALL RAINBIRD XCZ-100-PRB-COM PRESSURE REGULATOR VALVES. ALL VALVES TO EQUIP AIR/VACUUM RELIEF AND FLUSH VALVES. ALL VALVES TO BE INSTALLED WITH PLASTIC VALVE BOXES. ALL VALVES TO HAVE HUNTER NODE BATTERY PACK IRRIGATION CONTROLLERS. DRIP IRRIGATION TO BE NETA-FIM 0.6 GPH AT 12 INCH SPACED EMITTERS.
- ALL IRRIGATION LINES TO BE INSTALLED UNDER HARDSCAPE AREAS SHALL BE INSTALLED IN SCH. 40 P.V.C. SLEEVES. MINIMUM SLEEVE SIZE SHALL BE TWICE THE DIAMETER OF THE IRRIGATION PIPE SIZE.
- ALL IRRIGATION CONTROL WIRES TO BE INSTALLED UNDER HARDSCAPE AREAS SHALL BE INSTALLED IN A MINIMUM OF 1" SCH. 40 P.V.C. SLEEVE.
- ALL IRRIGATION VALVES, BALL VALVES, QUICK COUPLERS AND BOXES ARE TO BE LOCATED IN PLANTING AREAS.

#### MAINTENANCE NOTE:

CITY WILL BE RESPONSIBLE FOR THE ULTIMATE OPERATION AND MAINTENANCE OF THE LANDSCAPE AND HARDSCAPE.

As Built 5/08/23 P.O.



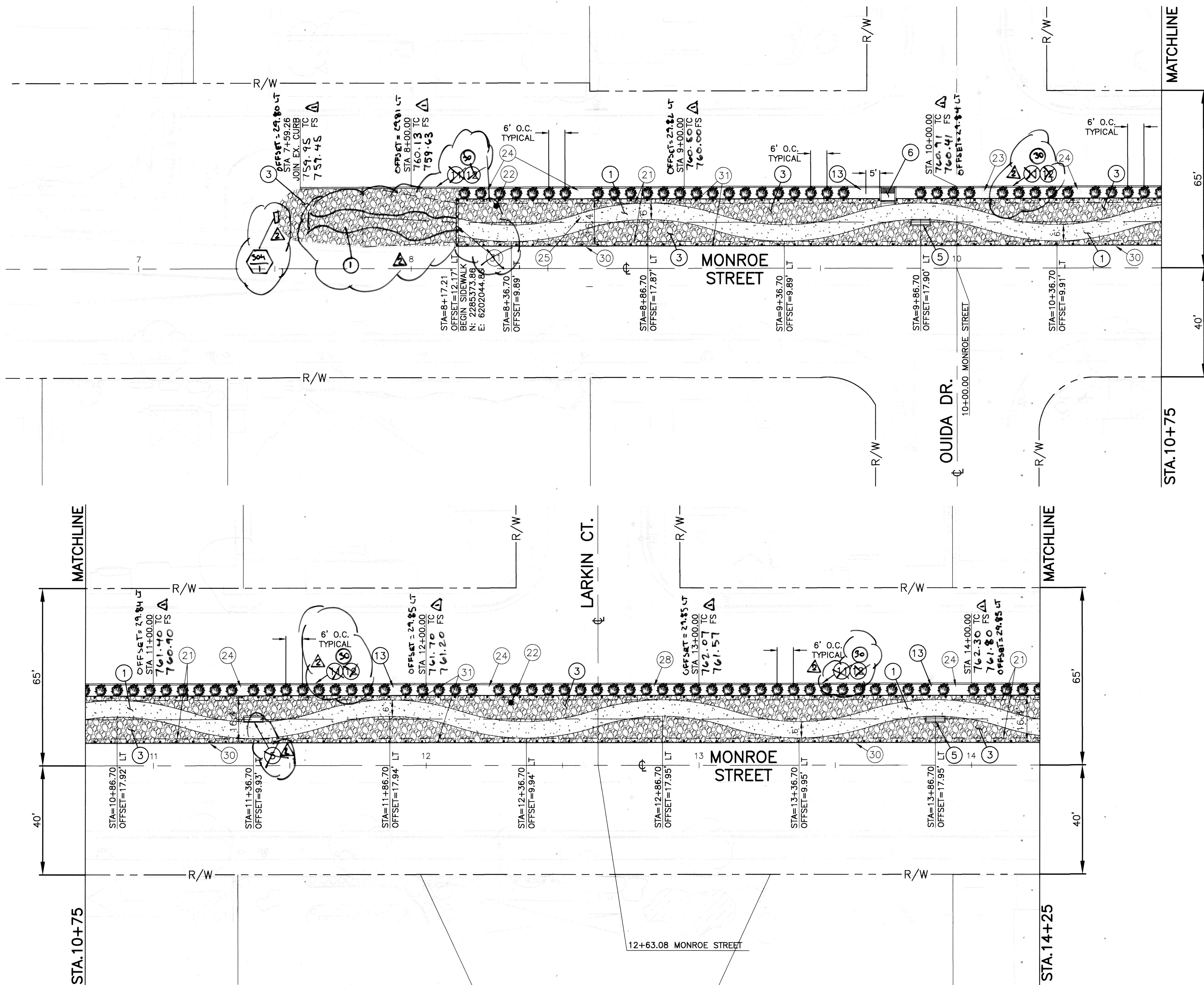

### HARDSCAPE CONSTRUCTION NOTES

- ① CONSTRUCT 6 FOOT WIDE 4" THICK STAMPED CONCRETE SIDEWALK PER RIVERSIDE STD NO. 325 OVER 1" SAND BED OVER EXISTING RCB. SCOFIELD INTEGRAL COLOR CORONADO BUFF (SG237-2) AND LITOTEX PAVECRAFTERS SANDSTONE RANDOM INTERLOCKING STAMP PATTERN (435 A RANDOM A) OR APPROVED EQUAL. REFER TO DETAIL SHEET 5 FOR MEANDERING LAYOUT.
- ③ CONSTRUCT ROCK BLANKET OVER 1" SAND BED OVER EXISTING RCB PER DETAIL ON SHEET 1 AND SPECIAL PROVISIONS.
- ⑤ FURNISH AND INSTALL THOMAS STEELE METAL BENCH (CRB-5 61") PER SPECIAL PROVISIONS OR APPROVED EQUAL. TO BE INSTALLED OVER A 48" WIDE BY 78" LONG BY 4" THICK STAMPED CONCRETE PAD PER CONSTRUCTION NOTE NUMBER ONE.
- ⑥ CONSTRUCT PEDESTRIAN RAMP PER CITY OF RIVERSIDE STD NO. 304, MODIFIED PER DETAIL 6 ON SHEET 5.
- ⑪ SAWCUT, REMOVE AND LEGALLY DISPOSE OF EXISTING CONCRETE CURB, TO INCLUDE ADJACENT 1 FOOT STRIP OF ASPHALT PAVEMENT.
- ⑫ CONSTRUCT 6" C.F. TYPE II CURB ONLY PER CITY OF RIVERSIDE STD. DWG. NO. 200.
- ⑬ ADJUST STREETLIGHT POLE STANDARD TO NEW CURB HEIGHT.

### REFERENCE NOTES

- ⑳ PROTECT IN PLACE EXISTING 14'x5' REINFORCED CONCRETE BOX (RCB) STORM DRAIN.
- ㉑ PROTECT IN PLACE EXISTING STORM DRAIN MANHOLE
- ㉒ PROTECT IN PLACE EXISTING IRRIGATION METER AND BACKFLOW PREVENTER. IRRIGATION POINT OF CONNECTION.
- ㉓ PROTECT IN PLACE EXISTING POWER POLES.
- ㉔ PROTECT IN PLACE EXISTING LIGHT BOOMS OVER PROPOSED IMPROVEMENTS.
- ㉕ PROTECT IN PLACE EXISTING STREET LIGHTS AND POSTS.
- ㉖ PROTECT IN PLACE EXISTING ELECTRICAL PULL BOX.
- ㉗ PROTECT IN PLACE CURB/CURB AND GUTTER.
- ㉘ PROTECT IN PLACE PLASTIC SPLIT RAIL FENCE.

### HARDSCAPE LEGEND

- NEW 4" THICK STAMPED CONCRETE SIDEWALK.
- CALTRANS STANDARD ROCK BLANKET.

### PLANTING LEGEND

SYMBOL	COMMON NAME	SIZE	MINIMUM HEIGHT	SPACING
	PHOTINIA HEDGE	5 GAL.	5'	6'
	PURPLE VERBENA	18"x18" FLATS	-	6"
	ORANGE DAYLILY	1 GAL.	-	4'
	GAZANIA	18"x18" FLATS	-	6"

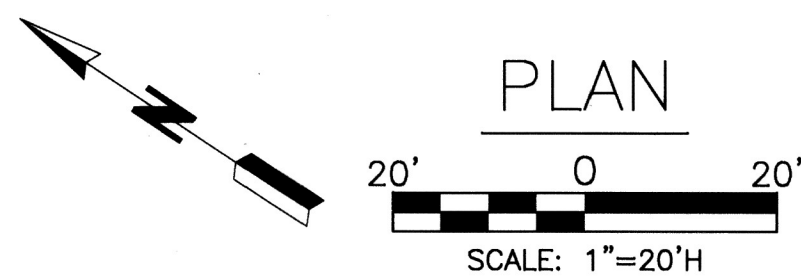

As BUILT 5/08/23 B.O

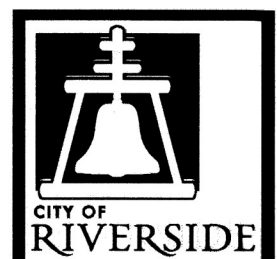

**ENGINEER IN RESPONSIBLE CHARGE**  
 S. H. Patel  
 Swetaben C. Patel  
 R.C.E. No. 72032 EXPIRES: 6-30-18  
 DATE 12/21/17

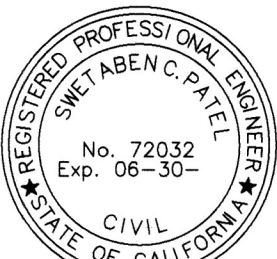

ADD T/C/FS STATION & Elevation	ADD PER / Sidewalk
DESIGNED BY: AR	DRAWN BY: AR
CHECKED BY: SP	

CITY OF RIVERSIDE, CALIFORNIA DEPARTMENT OF PUBLIC WORKS			
APPROVED BY	BY	DATE	APPROVED BY
ENGINEERING MANAGER	S.H.	12-27-17	CITY ENGINEER
CONSTRUCTION ADMIN.		12-27-17	
TRAFFIC DIVISION			
STREETS DIVISION			
SURVEY			

MEDIAN IMPROVEMENTS
2017/2018 ARTERIAL AND MINOR STREETS MAINTENANCE, PHASE 1 STA. 7+50 TO STA. 14+25
MONROE STREET
HORIZ. SCALE: PER PLAN   VERT. SCALE: N/A

DESIGN WORK ORDER NO.: 1804007
CONSTR. WORK ORDER NO.: 1804009
<b>R-4420L</b>
SHEET <b>2</b> OF <b>5</b>
FILE NAME:



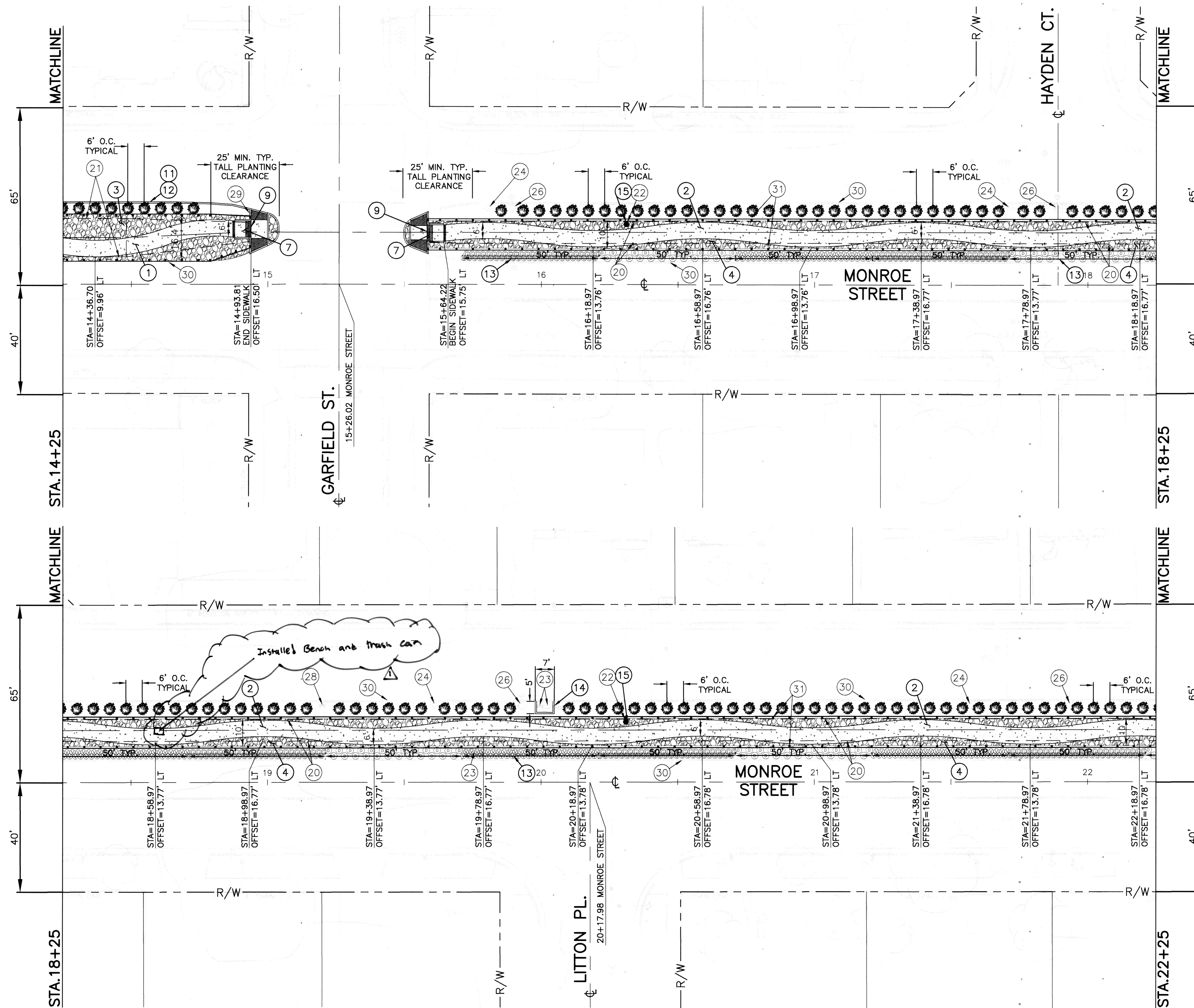



## HARDSCAPE CONSTRUCTION NOTES

- ① CONSTRUCT 6 FOOT WIDE 4" THICK STAMPED CONCRETE SIDEWALK PER RIVERSIDE STD NO. 325 OVER 1" SAND BED OVER EXISTING RCB. SCOFIELD INTEGRAL COLOR CORONADO BUFF (SG237-2) AND LITHOTEX PAVECRAFTERS SANDSTONE RANDOM INTERLOCKING STAMP PATTERN (435 A RANDOM A) OR APPROVED EQUAL. REFER TO DETAIL SHEET 5 FOR MEANDERING LAYOUT.
- ② CONSTRUCT 6 FOOT WIDE 4" THICK STAMPED INTEGRAL COLOR CONCRETE SIDEWALK PER RIVERSIDE STD NO. 325. SCOFIELD INTEGRAL COLOR CORONADO BUFF (SG237-2) AND LITHOTEX PAVECRAFTERS SANDSTONE RANDOM INTERLOCKING STAMP PATTERN (435 A RANDOM A) OR APPROVED EQUAL. REFER TO DETAIL SHEET 5 FOR MEANDERING LAYOUT.
- ③ CONSTRUCT ROCK BLANKET OVER 1" SAND BED OVER EXISTING RCB PER DETAIL ON SHEET 1 AND SPECIAL PROVISIONS.
- ④ CONSTRUCT ROCK BLANKET PER DETAIL ON SHEET 6 AND SPECIAL PROVISIONS.
- ⑦ CONSTRUCT PEDESTRIAN RAMP PER CITY OF RIVERSIDE STD NO. 304, MODIFIED PER DETAIL 7 & 8 ON SHEET 5.
- ⑨ REMOVE AND DISPOSE 6 FOOT TALL CHAIN LINK FENCE BARRICADE.
- ~~⑪ SAWCUT, REMOVE AND LEGALLY DISPOSE OF EXISTING CONCRETE CURB, TO INCLUDE ADJACENT 1 FOOT STRIP OF ASPHALT PAVEMENT.~~
- ~~⑫ CONSTRUCT 6" C.F. TYPE II CURB ONLY PER CITY OF RIVERSIDE STD. DWG. NO. 200.~~
- ⑬ ADJUST STREETLIGHT POLE STANDARD TO NEW CURB HEIGHT.
- ⑭ CONSTRUCT 18" C.F. TYPE II RETAINING CURB PER CITY OF RIVERSIDE STD. DWG. NO. 200.
- ⑮ ADJUST STORM DRAIN MANHOLE FRAME AND COVER TO PROPOSED GRADE.

## REFERENCE NOTES

- ⑳ PROTECT IN PLACE EXISTING 8'x4' REINFORCED CONCRETE BOX (RCB) STORM DRAIN.
- ㉑ PROTECT IN PLACE EXISTING 14'x5' REINFORCED CONCRETE BOX (RCB) STORM DRAIN.
- ㉒ PROTECT IN PLACE EXISTING STORM DRAIN MANHOLE.
- ㉓ PROTECT IN PLACE EXISTING IRRIGATION METER AND BACKFLOW PREVENTER. IRRIGATION POINT OF CONNECTION.
- ㉔ PROTECT IN PLACE EXISTING POWER POLES.
- ㉕ PROTECT IN PLACE EXISTING STREET LIGHTS AND POSTS.
- ㉖ PROTECT IN PLACE EXISTING ELECTRICAL PULL BOX.
- ㉗ PROTECT IN PLACE EXISTING SIGN.
- ㉘ PROTECT IN PLACE CURB/CURB AND GUTTER.
- ㉙ PROTECT IN PLACE PLASTIC SPLIT RAIL FENCE.

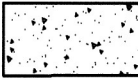
## HARDSCAPE LEGEND

-  NEW 4" THICK STAMPED CONCRETE SIDEWALK.
-  CALTRANS STANDARD ROCK BLANKET.

## PLANTING LEGEND

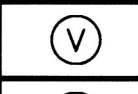
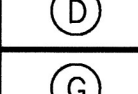
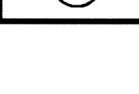
SYMBOL	COMMON NAME	SIZE	MINIMUM HEIGHT	SPACING
	PHOTINIA HEDGE	5 GAL.	5'	6'
	PURPLE VERBENA	18"x18" FLATS	-	6"
	ORANGE DAYLILY	1 GAL.	-	4'
	GAZANIA	18"x18" FLATS	-	6"

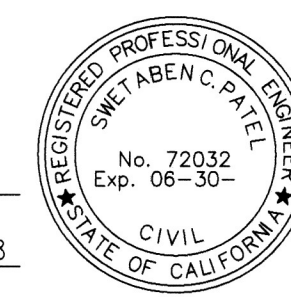
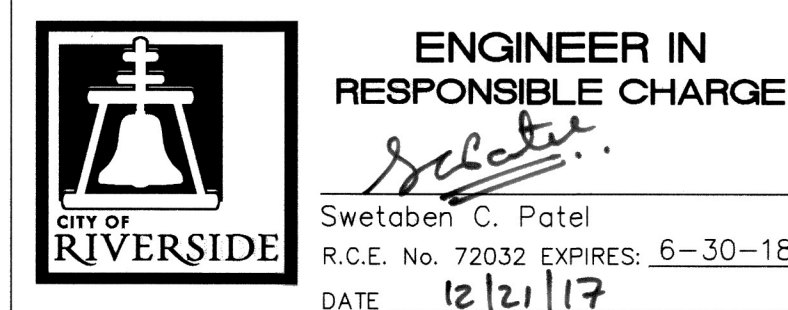
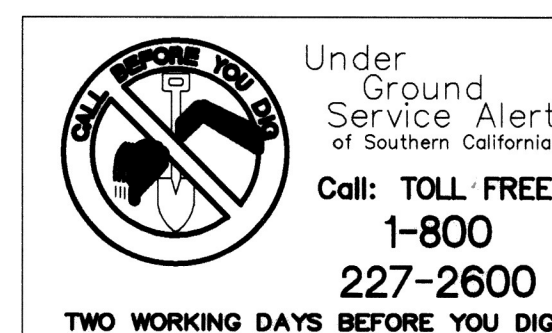
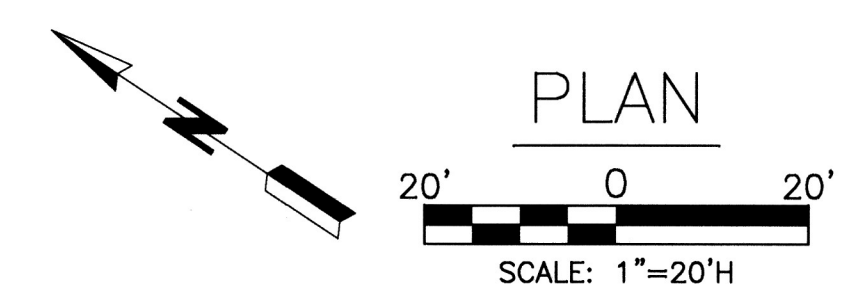

MARK	REVISIONS	APPR.	DATE
1	Installed Bench & trash can	AR	12-27-17

CITY OF RIVERSIDE, CALIFORNIA DEPARTMENT OF PUBLIC WORKS			
APPROVED BY	BY	DATE	APPROVED BY
ENGINEERING MANAGER	S.H.	12-27-17	CHIEF ENGINEER
CONSTRUCTION ADMIN.	S.H.	12-27-17	
TRAFFIC DIVISION	S.H.	12-27-17	
STREETS DIVISION	S.H.	12-27-17	
SURVEY	S.H.	12-27-17	

MEDIAN IMPROVEMENTS		DESIGN WORK ORDER NO.: 1804007 CONSTR. WORK ORDER NO.: 1804009
2017/2018 ARTERIAL AND MINOR STREETS MAINTENANCE, PHASE 1 STA. 14+25 TO STA. 22+25		R-4420L SHEET 3 OF 5
MONROE STREET		FILE NAME:
HORIZ. SCALE: PER PLAN	VERT. SCALE: N/A	

As B.O.I. 5/08/23 B.O.



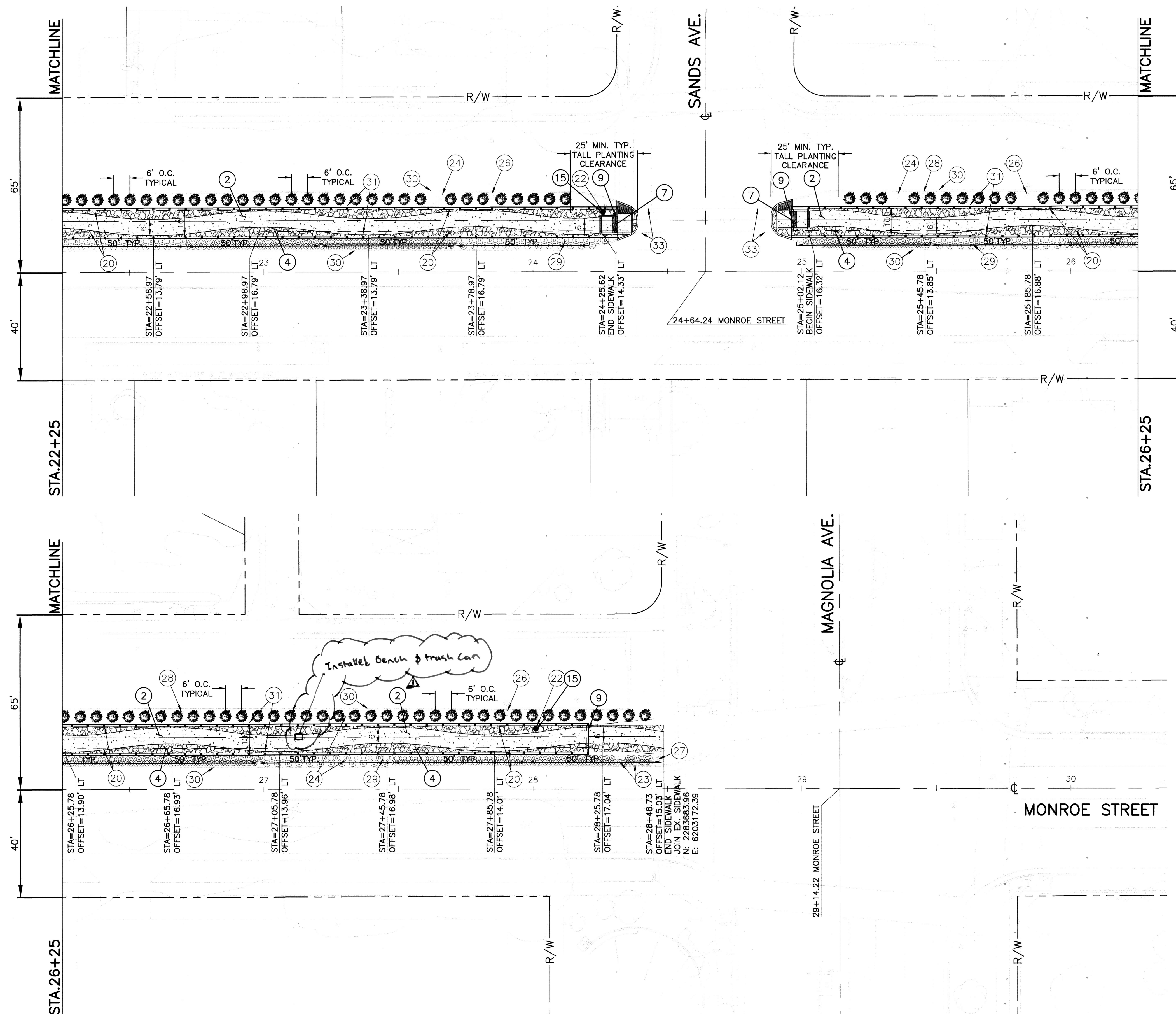

## HARDSCAPE CONSTRUCTION NOTES

- ② CONSTRUCT 6 FOOT WIDE 4" THICK STAMPED INTEGRAL COLOR CONCRETE SIDEWALK PER RIVERSIDE STD NO. 325, SCOFIELD INTEGRAL COLOR CORONADO BUFF (SG237-2) AND LITHOTEX PAVECRAFTERS SANDSTONE RANDOM INTERLOCKING STAMP PATTERN (435 A RANDOM A) OR APPROVED EQUAL. REFER TO DETAIL SHEET 5 FOR MEANDERING LAYOUT.
- ④ CONSTRUCT ROCK BLANKET PER DETAIL ON SHEET 1 AND SPECIAL PROVISIONS.
- ⑦ CONSTRUCT PEDESTRIAN RAMP PER CITY OF RIVERSIDE STD NO. 304, MODIFIED PER DETAIL 7 & 8 ON SHEET 5.
- ⑨ REMOVE AND DISPOSE 6 FOOT TALL CHAIN LINK FENCE BARRICADE.
- ⑮ ADJUST STORM DRAIN MANHOLE FRAME AND COVER TO PROPOSED GRADE.

## REFERENCE NOTES

- ⑳ PROTECT IN PLACE EXISTING 8'x4' REINFORCED CONCRETE BOX (RCB) STORM DRAIN.
- ㉒ PROTECT IN PLACE EXISTING STORM DRAIN MANHOLE.
- ㉓ PROTECT IN PLACE EXISTING IRRIGATION METER AND BACKFLOW PREVENTER, IRRIGATION POINT OF CONNECTION.
- ㉔ PROTECT IN PLACE EXISTING POWER POLES.
- ㉖ PROTECT IN PLACE EXISTING STREET LIGHTS AND POSTS.
- ㉗ PROTECT IN PLACE EXISTING TRAFFIC SIGNAL FACILITIES.
- ㉘ PROTECT IN PLACE EXISTING ELECTRICAL PULL BOX.
- ㉙ PROTECT IN PLACE EXISTING SIGN.
- ㉚ PROTECT IN PLACE CURB/CURB AND GUTTER.
- ㉛ PROTECT IN PLACE PLASTIC SPLIT RAIL FENCE.
- ㉜ PROTECT IN PLACE TOP OF EXISTING 8'x4' EXPOSED REINFORCED CONCRETE BOX.

## HARDSCAPE LEGEND

- NEW 4" THICK STAMPED CONCRETE SIDEWALK.
- CALTRANS STANDARD ROCK BLANKET.

## PLANTING LEGEND

SYMBOL	COMMON NAME	SIZE	MINIMUM HEIGHT	SPACING
	PHOTINIA HEDGE	5 GAL.	5'	6'
	PURPLE VERBENA	18"x18" FLATS	—	6"
	ORANGE DAYLILY	1 GAL.	—	4'
	GAZANIA	18"x18" FLATS	—	6"

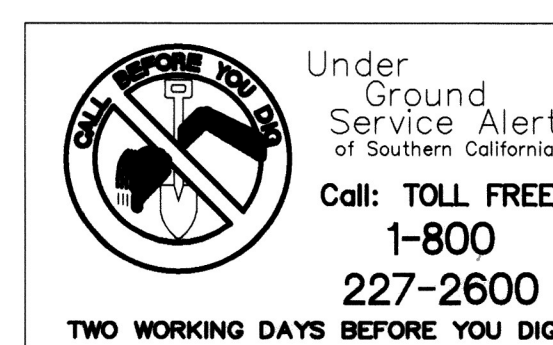
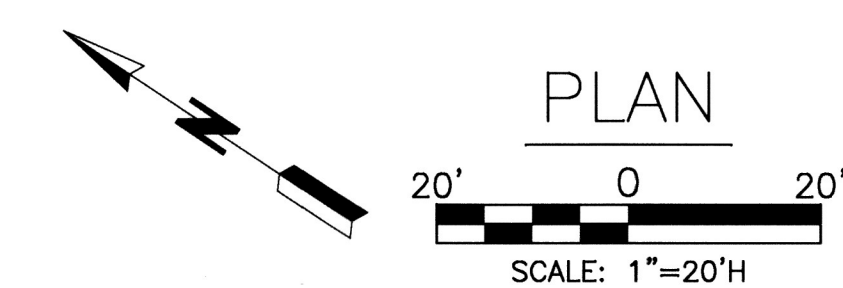

**ENGINEER IN RESPONSIBLE CHARGE**  
 Swetaben C. Patel  
 R.C.E. No. 72032 EXPIRES: 6-30-18  
 DATE: 12/21/17

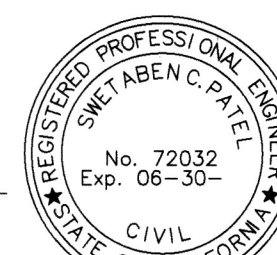

MARK	REVISIONS	APPR.	DATE
1	Install Bench & trash can	SP	12-21-17

CITY OF RIVERSIDE, CALIFORNIA DEPARTMENT OF PUBLIC WORKS			
APPROVED BY	BY	DATE	APPROVED BY
ENGINEERING MANAGER	S.H.	12-22-17	CITY ENGINEER
CONSTRUCTION ADMIN.	S.H.	12-22-17	
TRAFFIC DIVISION	S.H.	12-22-17	
STREETS DIVISION	S.H.	12-22-17	
SURVEY	S.H.	12-22-17	

MEDIAN IMPROVEMENTS	
2017/2018 ARTERIAL AND MINOR STREETS MAINTENANCE, PHASE 1	
STA. 22+25 TO STA. 28+48.73	
MONROE STREET	
HORIZ. SCALE: PER PLAN	VERT. SCALE: N/A

DESIGN WORK ORDER NO.: 1804007	CONSTR. WORK ORDER NO.: 1804009
R-4420L	
SHEET 4 OF 5	
FILE NAME:	



