

# RIVERSIDE

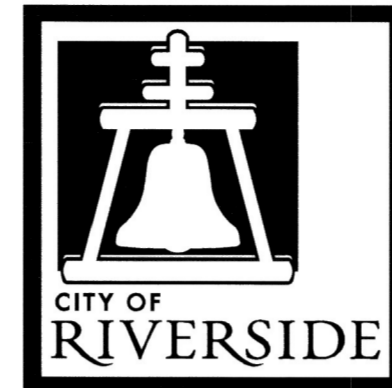

# CALIFORNIA

## GENERAL CONSTRUCTION NOTES:

- THE CONTRACTOR SHALL PROVIDE AND MAINTAIN TRAFFIC CONTROL AS INDICATED IN THE ASSOCIATED PROJECT SPECIAL PROVISIONS.
- CONSTRUCTION SHALL BE IN ACCORDANCE WITH THE CITY OF RIVERSIDE STANDARD DRAWINGS AND STANDARD SPECIFICATIONS FOR PUBLIC WORKS CONSTRUCTION, 2012 EDITION.
- EXISTING UTILITIES SHOWN ON THIS PLAN ARE PLOTTED FROM UTILITY RECORDS. THE CONTRACTOR IS REQUIRED TO TAKE DUE PRECAUTIONARY MEASURES TO LOCATE AND PROTECT ALL UTILITIES WHETHER OR NOT SHOWN ON THIS PLAN.
- CONFLICTING UTILITIES SHOWN WITHIN CONSTRUCTION AREA WILL BE RELOCATED PRIOR TO CONSTRUCTION.
- ALL STREET PULL BOXES, AFFECTED BY CONSTRUCTION, SHALL BE ADJUSTED TO THE PROPOSED GRADE.
- THE SEAM BETWEEN PASSES OF THE AC OVERLAY SHALL COINCIDE, AS CLOSE AS POSSIBLE, TO THE LANE LINES.
- COLD MILLING SHALL BE AS DESCRIBED ON THE PLANS AND SPECIAL PROVISIONS OR AS DIRECTED BY THE ENGINEER.
- ANY DISTRESSED EXISTING PAVEMENT SHALL BE REMOVED AND REPLACED AS DIRECTED BY THE ENGINEER AFTER COLD-MILLING AND PRIOR TO PLACEMENT OF DGAC.
- CONTRACTOR SHALL REMOVE ALL VEGETATION WITHIN ALL SIDEWALK PANELS WITHIN THE PROJECT LIMITS.
- ALL EXISTING IMPROVEMENTS SHOWN HEREON SHALL BE PROTECTED IN PLACE UNLESS OTHERWISE NOTED.
- EXISTING IRRIGATION SHALL BE PROTECTED OR MODIFIED AS NECESSARY TO CONSTRUCT NEW CONCRETE IMPROVEMENTS.
- ALL FENCE POSTS SHALL BE PROTECTED OR MODIFIED AS NECESSARY IF POST FOUNDATION IS WITHIN A SIDEWALK PANEL THAT HAS BEEN CALLED OUT FOR REPLACEMENT.

## CONSTRUCTION NOTES:

- REMOVE AND REPLACE IN KIND EXISTING FACILITY, NUMBERS ABOVE 100 IN A HEXAGON ON THE PLAN REFER TO THE RESPECTIVE STANDARD DRAWING AND SHALL BE CONSTRUCTED ACCORDINGLY. ANY NOTE SHOWN BELOW THE STANDARD DRAWING NUMBER INDICATES THE SPECIFIC TYPE, ACTION, OR MODIFICATION TO BE CONSTRUCTED. WHERE NO MODIFICATION OR TYPE IS INDICATED, THE DIMENSIONS OF NEW FACILITY SHALL BE MODIFIED AS NECESSARY, EXCLUDING ADA REQUIREMENTS, TO MATCH EXISTING FACILITY REMOVED.
- ADJUST TO GRADE, DESCRIPTION PER PLAN. (MH)=SEWER OR STORM DRAIN MANHOLE; (GV)=GATE VALVE.
- PROTECT IN PLACE, DESCRIPTION PER PLAN. (WM)=WATER METER; (PB)=PULL BOX; (DWY)=DRIVEWAY; (UTL)=UTILITY CABINETS; (CG)=CROSS GUTTER.
- PROVIDE VARIABLE DEPTH COLDMILLING TO TRANSITION FROM 0.12' AT GUTTER LIP/JOINT TO 0' DEPTH AT THE 5'-10' MILL WIDTH INDICATED.
- REMOVE ALL AC AND SUBGRADE FOR FULL STREET WIDTH. REMOVAL OF BASE/SUBGRADE MAY BE NECESSARY TO PROVIDE 0.33' OF FRAC OVER EXISTING COMPACTED BASE/SUBGRADE.
- OVERLAY AREA WITH DGAC AT A DEPTH PER PLAN.
- OVERLAY AREA WITH FIBER REINFORCED ASPHALT CONCRETE (FRAC) AT A DEPTH PER PLAN.
- M1 = REMOVE AND REPLACE EXISTING PEDESTRIAN RAMP PER CITY STANDARD 304, TYPE 3, MODIFIED WITH RETAINING CURB ON BOTH SIDES OF THE RAMP.
- CONSTRUCT SIDEWALK PER CITY STANDARD 325, WITH A DEPTH OF 6".
- REPLACE AC DRIVEWAY MONOLITICALLY, IN KIND, MATCHING THE CURB DEPRESSION WITH THE EXISTING GATE OPENING.
- CONTRACTOR SHALL COORDINATE WITH RIVERSIDE PUBLIC UTILITIES DEPARTMENT TO PROVIDE ACCESS FOR THE MODIFICATION OF THE EXISTING WATER METER. CONTRACTOR SHALL RE-CONNECT THE SERVICE ON THE PRIVATE SIDE OF THE METER.

## EXISTING TOPOGRAPHY:

- SANITARY SEWER M.H.      GATE VALVE
- STORM DRAIN M.H.      ELECTRICAL TEST STATION (GAS)
- ELECTRIC M.H.      FIRE HYDRANT
- WATER M.H.      WATER METER

## SHEET INDEX:

SHEET NO.	DESCRIPTION
1	TITLE SHEET/LOCATION MAP
2	MAINTENANCE PLAN
3	SIGNAL/SIGNING/STRIPING PLAN

# PUBLIC WORKS DEPARTMENT

## 2019/2020 CDBG - WARD 6

### STREET IMPROVEMENTS FOR

#### MINNIER AVENUE FROM HOLE AVENUE TO LA SIERRA AVENUE, AND WHITFORD AVENUE FROM LA SIERRA AVENUE TO MINNIER AVENUE

## A HUD FUNDED PROJECT

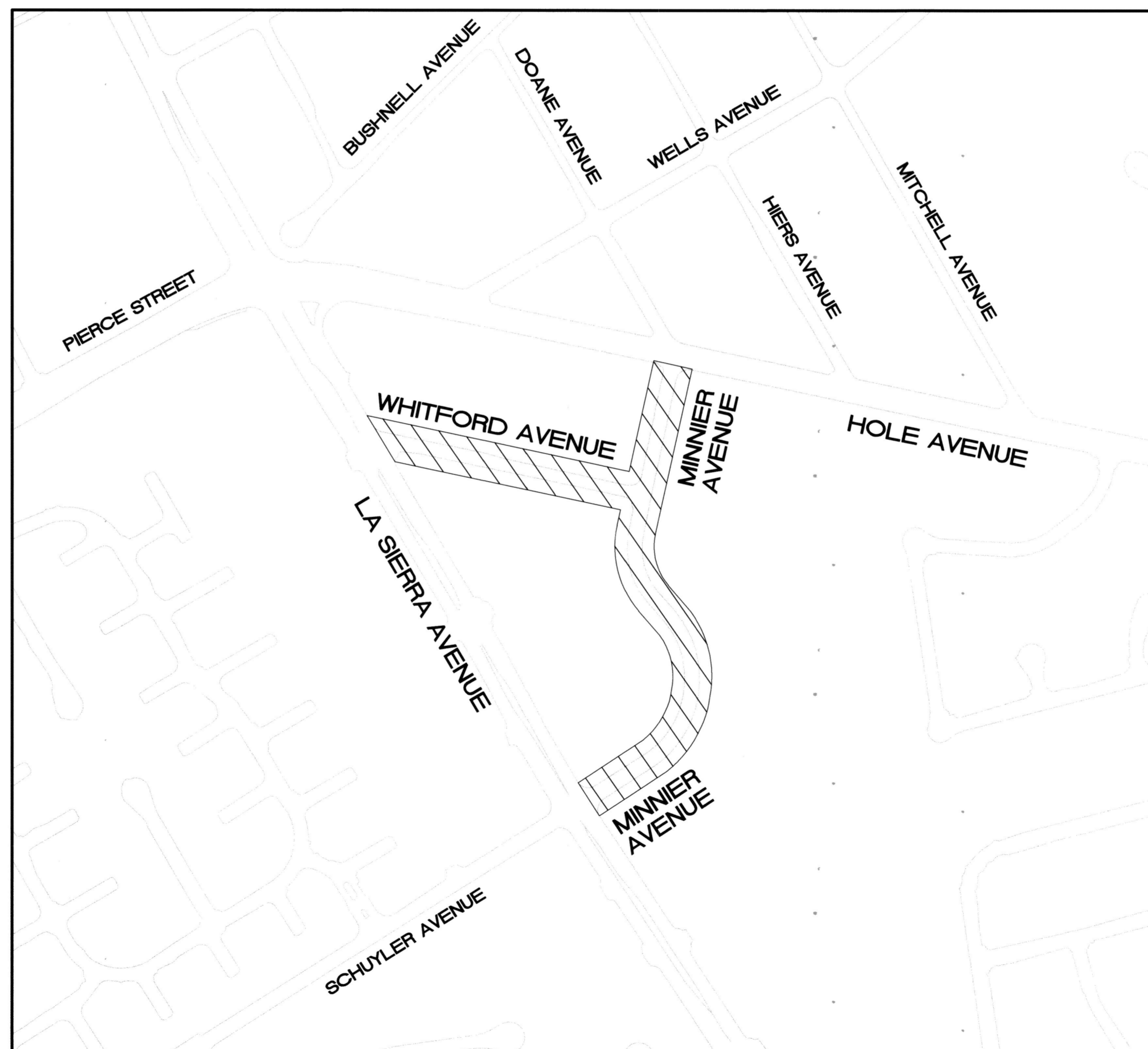

LOCATION MAP  
NTS

## SIGNING/STRIPING GENERAL NOTES:

- SIGNING AND STRIPING INSTALLATIONS SHALL CONFORM TO THE 2014 CALIFORNIA MANUAL ON UNIFORM TRAFFIC CONTROL DEVICES (CA MUTCD), THE STATE OF CALIFORNIA DEPARTMENT OF TRANSPORTATION (CALTRANS) STANDARD PLANS AND SPECIFICATIONS DATED 2018, AND ALL ADDENDUMS THERETO, AND THE CITY OF RIVERSIDE PUBLIC WORKS DEPARTMENT STANDARD DRAWINGS, CURRENT EDITION.
- ALL STRIPING, MARKINGS, AND LEGENDS SHALL BE REFLECTORIZED THERMOPLASTIC UNLESS OTHERWISE NOTED. THE CONTRACTOR SHALL PROVIDE AND INSTALL RAISED PAVEMENT MARKERS FOR ALL STRIPING. STRIPING, MARKINGS AND LEGENDS SHALL CONFORM TO THE LATEST CALTRANS STANDARD PLANS A20A THRU A20D AND A24A THRU A24E.
- PRIOR TO FINAL ACCEPTANCE OF STREET IMPROVEMENTS, ALL PAVEMENT STRIPING AND STENCILING WITHIN THE PERIMETER OF THE CONSTRUCTION AREA SHALL BE RESTORED TO LIKE NEW CONDITION, IN A MANNER MEETING THE APPROVAL OF THE CITY OF RIVERSIDE.
- THE CONTRACTOR SHALL RE-STRIP EXISTING STRIPING AND CURB MARKINGS OBLITERATED BY NEW CONSTRUCTION, WHETHER OR NOT SHOWN ON THE PLANS FOR REPLACEMENT, AT NO COST TO THE CITY.
- AT LOCATIONS WHERE EXISTING PAINTED CURB IS TO BE RECONSTRUCTED, THE CONTRACTOR SHALL PAINT THE NEW CURB AS SHOWN ON THE PLANS WITHIN 10 WORKING DAYS OF CURB CONSTRUCTION OR AS DIRECTED BY ENGINEER. THE PAINT SHALL BE WATER-BASED WITH 2-YEAR GUARANTEE AGAINST COLOR FADING. PRIOR TO THE START OF CONSTRUCTION, THE CONTRACTOR SHALL SUBMIT TO THE CITY WRITTEN PROOF OF THE MANUFACTURER'S 2-YEAR GUARANTEE.
- ALL NEW STRIPING SHALL BE "CAT TRACKED" AND APPROVED BY THE ENGINEER PRIOR TO FINAL INSTALLATION. THE CONTRACTOR SHALL NOTIFY THE ENGINEER AFTER COMPLETING LAYOUT AND AT LEAST 3 WORKING DAYS BEFORE COMMENCING INSTALLATION OF STRIPING, MARKINGS AND MARKERS.
- TRAFFIC SIGN FACE SHALL BE 3M DIAMOND GRADE DG3 REFLECTIVE SHEETING (ASTM XI) OR APPROVED EQUAL WITH PROTECTIVE GRAFFITI OVERLAY FILM OR AS OTHERWISE NOTED.
- SIGNS SHALL BE STANDARD SIZE UNLESS NOTED OTHERWISE. PRIOR TO INSTALLATION, NEW SIGNS SHALL BE APPROVED BY THE CITY OF RIVERSIDE. EXACT LOCATIONS OF SIGNS SHALL BE DETERMINED BY THE CITY ENGINEER.
- ALL EXISTING SIGNS AND POSTS TO BE REMOVED SHALL BE DELIVERED TO THE CITY OF RIVERSIDE SIGN DEPARTMENT.
- STRIPING SHALL BE APPLIED WITHIN 48 HOURS OF SURFACE COURSE REPLACEMENT ON STREETS OPEN TO THE PUBLIC. IN NO CASE SHALL A NEWLY PAVED STREET OPEN TO THE PUBLIC BE LEFT UNSTRIPED OVER A WEEKEND OR HOLIDAY.
- CONTRACTOR SHALL INSTALL NEW SIGN(S) AND/OR POST(S) PER CITY OF RIVERSIDE STANDARD DRAWING No. 664, SEE SPECIFICATIONS.
- CONTRACTOR SHALL INSTALL NEW STREET NAME SIGNS AND POST PER CITY OF RIVERSIDE STANDARD DRAWING No. 662, SEE SPECIFICATIONS.
- ALL CONFLICTING STRIPING, PAVEMENT MARKINGS, LEGENDS, AND RAISED PAVEMENT MARKERS SHALL BE REMOVED EVEN IF NOT SHOWN ON PLANS. REMOVALS OF PAINTED STRIPING, PAVEMENT MARKINGS AND LEGENDS SHALL BE DONE BY WET SANDBLASTING. REMOVALS OF THERMOPLASTIC STRIPING, PAVEMENT MARKINGS AND LEGENDS SHALL BE REMOVED BY WET SANDBLASTING, GRINDING OR OTHER APPROVED METHOD AND SHALL NOT DAMAGE THE PAVEMENT. "BLACK OUT" OF EXISTING DELINEATION IS NOT PERMITTED. ALL DAMAGED PAVEMENT DUE TO REMOVALS SHALL BE REPAIRED AS NECESSARY TO MAINTAIN A SMOOTH AND UNIFORM SURFACE OR AS DIRECTED BY THE ENGINEER. ALL STRIPING REMOVALS AND LEGENDS SHALL BE "FOG SEALED".

## TRAFFIC SIGNAL GENERAL NOTES:

- ALL ITEMS FURNISHED AND ALL WORK TO BE DONE SHALL CONFORM TO THE REQUIREMENTS OF: THE STATE OF CALIFORNIA, DEPARTMENT OF TRANSPORTATION (CALTRANS) STANDARD PLANS AND SPECIFICATIONS, DATED 2018; THE CALIFORNIA MANUAL ON UNIFORM TRAFFIC CONTROL DEVICES ADOPTED 2014; AND THE SPECIAL PROVISIONS.
- THE CONTRACTOR SHALL OBTAIN ALL NECESSARY PERMITS TO NOTIFY ALL AFFECTED AGENCIES AND THE RIVERSIDE UTILITY COMPANIES A MINIMUM OF 48 HOURS PRIOR TO START OF CONSTRUCTION.
- UNLESS SHOWN OTHERWISE, INDUCTIVE LOOPS SHALL BE MODIFIED TYPE "D" & TYPE "E" WITH 10', 15' AND 30' SPACING IN THE DIRECTION OF TRAVEL. NECESSARY STRIPING SHALL BE LOCATED PRIOR TO POSITIONING LOOPS. LOOPS SHALL BE SEALED WITH HOT MELT SEALANT. SEE DETAIL.

## LEGEND:

- COLDMILL - CM1 (0.12') + DGAC PAVEMENT (0.12') OR FIBER REINFORCED ASPHALT CONCRETE - FRAC (0.12')
- PROPOSED PCC
- COLDMILL - CM3 (4" MIN.) + FIBER REINFORCED ASPHALT CONCRETE - FRAC (4")
- DGAC PAVEMENT (0.12')

	<b>ENGINEER IN RESPONSIBLE CHARGE</b> <i>Edward Lara</i> Edward Lara R.C.E. No. 63753 EXPIRES: 9-30-22 DATE: September 11, 2020		<b>CITY OF RIVERSIDE, CALIFORNIA</b> <b>DEPARTMENT OF PUBLIC WORKS</b>	<b>STREET IMPROVEMENTS</b> 2019/2020 CDBG - WARD 6 MINNIER AVENUE FROM HOLE AVENUE TO LA SIERRA AVENUE AND WHITFORD AVENUE FROM LA SIERRA AVENUE TO MINNIER AVENUE	DESIGN WORK ORDER NO.: 2028127 CONSTR. WORK ORDER NO.: 2028128 <b>R-4517</b>
	DESIGNED BY: DC    DRAWN BY: DC    CHECKED BY: EL	APPROVED BY: <i>EM</i> DATE: 9.15.20 CONSTRUCTION ADMIN. <i>PC</i> DATE: 9.14.20 TRAFFIC DIVISION <i>NM</i> DATE: 9.14.20 STREETS SERVICES <i>CS</i> DATE: 9/17/20 SURVEYOR	APPROVED BY: <i>[Signature]</i> DATE: 9.16.2020 CITY ENGINEER	TITLE SHEET/LOCATION MAP HORIZ. SCALE: N/A    VERT. SCALE: N/A	SHEET <b>1</b> OF <b>3</b> FILE NAME: R4517-1.DWG

AS BUILT 5/10/23 B.O



# SIGNING/STRIPING NOTES:

- (IS) INSTALL NEW TRAFFIC SIGN(S) ON NEW POST PER CITY STANDARD 662/664. NEW SIGNS TO BE MOUNTED ON EXISTING STREET LIGHTS SHALL BE STRAP MOUNTED (SUPPLIED BY CONTRACTOR)
- (RS) REMOVE AND SALVAGE EXISTING TRAFFIC SIGN TO CITY YARD.
- (RL) RELOCATE TRAFFIC SIGN(S) AND INSTALL NEW POST.
- 1 INSTALL TYPE "D & E" DETECTOR LOOPS, SEE DETAIL. DETECTOR LOOP CHANNELS ARE AS FOLLOWS:  
1. THRU LANE - TYPE "E" = 416U; TYPE "D" = 416L  
2. LEFT TURN LANE - TYPE "E" = 7J5U; TYPE "D" = 7J5L
- 2 SPLICE NEW TO EXISTING CONDUCTORS
- 3 INSTALL WHITE CONTINENTAL CROSSWALK, TO ALIGN WITH BOTH PEDESTRIAN RAMPS. SEE DETAIL.
- 4 INSTALL SOLID WHITE "STOP" LEGEND
- 5 INSTALL 75' DETAIL 38, AND TYPE IV ARROWS
- 6 INSTALL 50' DETAIL 22
- 7 INSTALL DETAIL 22
- 8 INSTALL 12" SOLID WHITE LIMIT LINE AND "STOP" LEGEND, LOCATION VERIFIED BY ENGINEER

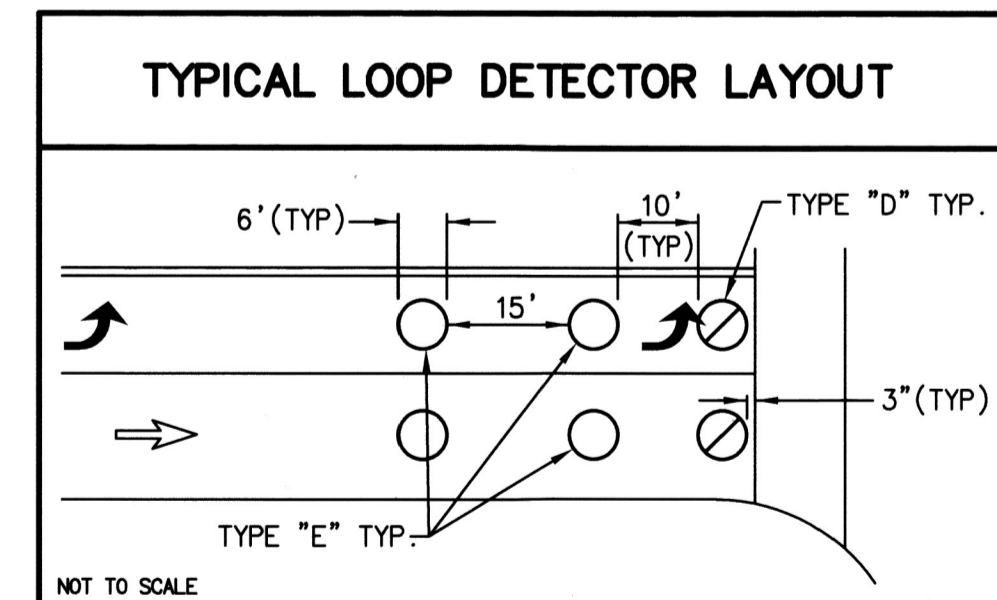
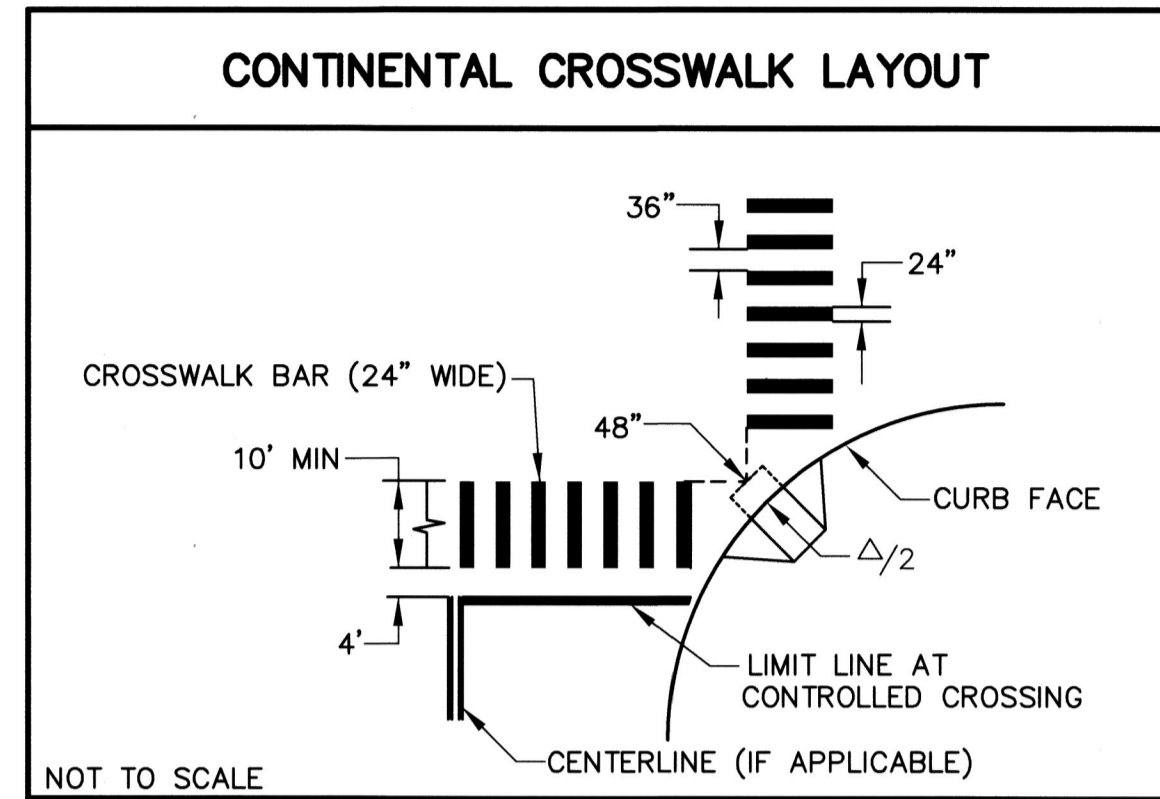

SEE STANDARD DWG NO. 670 FOR TYPE "D" LOOP CONFIGURATION

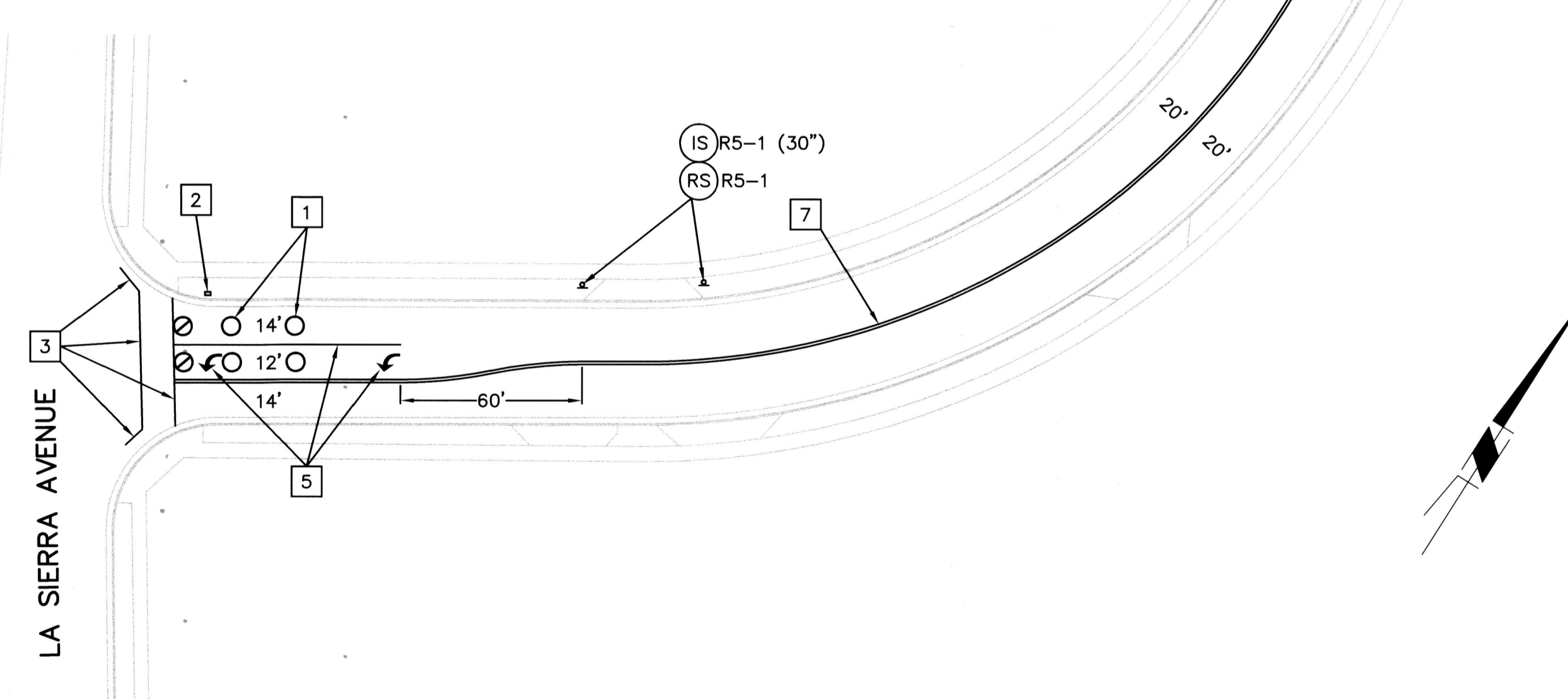
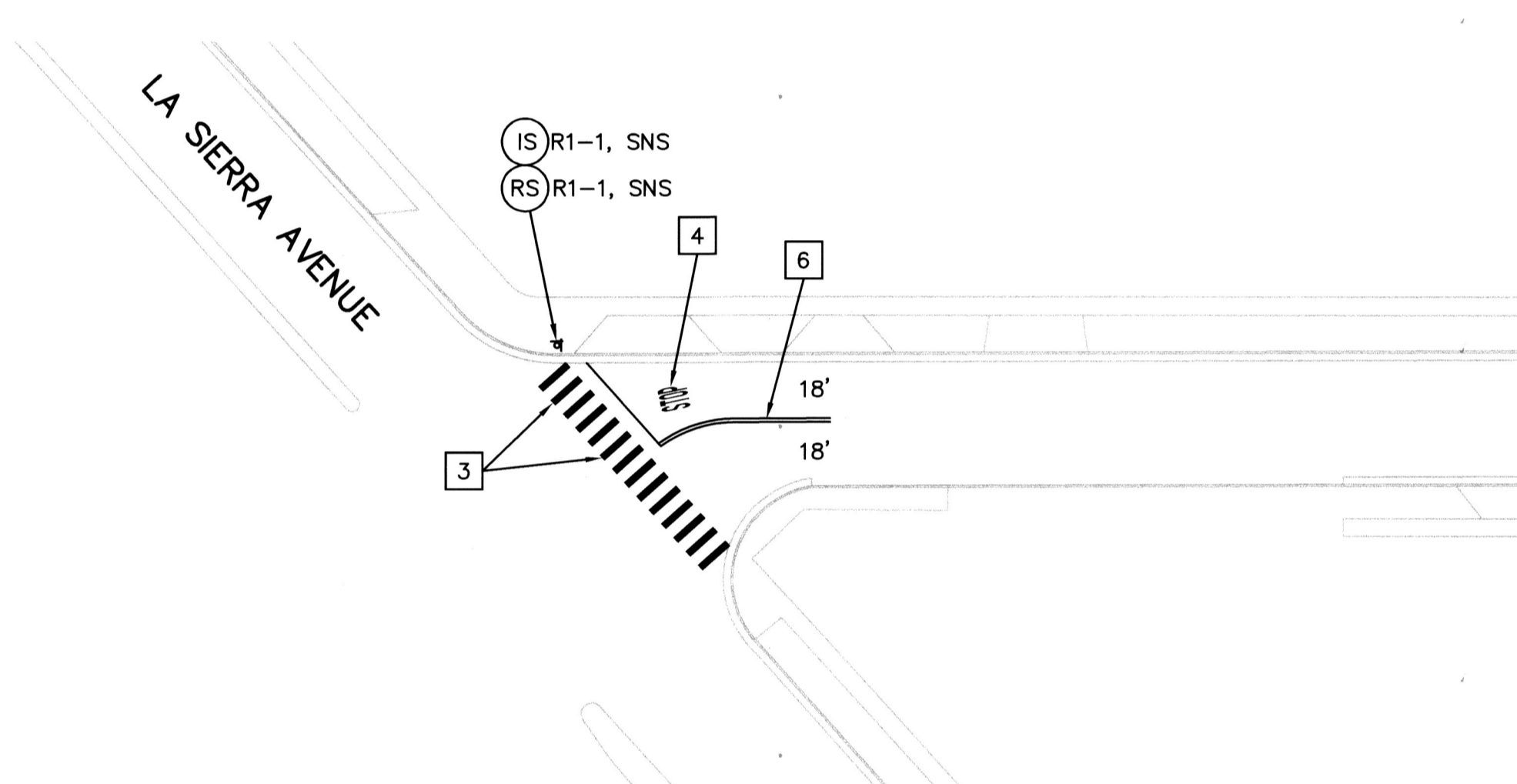
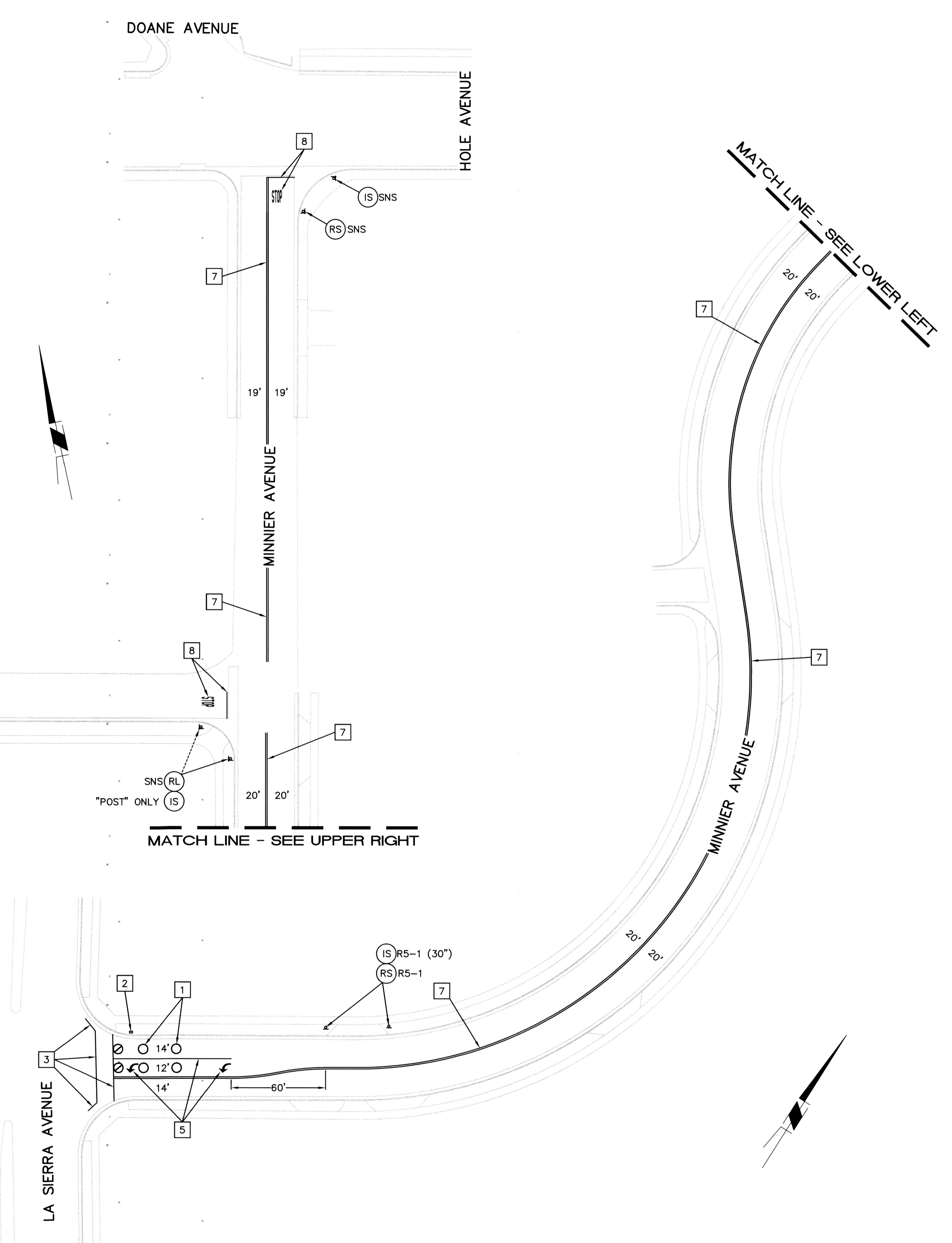
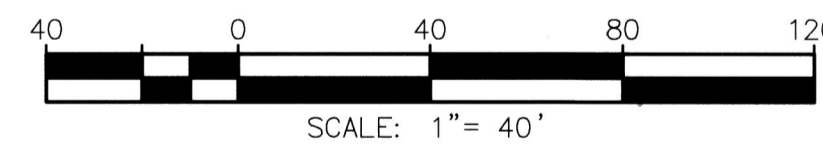

*As Built 5/10/23 B.0*

 <b>CITY OF RIVERSIDE</b>	<b>ENGINEER IN RESPONSIBLE CHARGE</b>  Nathan Mustafa R.C.E. No. 83654 EXPIRES: 3-31-21 DATE 9/14/20		<b>CITY OF RIVERSIDE, CALIFORNIA</b> <b>DEPARTMENT OF PUBLIC WORKS</b>	<b>STREET IMPROVEMENTS</b> 2019/2020 CDBG - WARD 6 MINNIER AVENUE FROM HOLE AVENUE TO LA SIERRA AVENUE AND WHITFORD AVENUE FROM LA SIERRA AVENUE TO MINNIER AVENUE <b>SIGNAL/SIGNING/STRIPING PLAN</b> HORIZ. SCALE: 1"=40'   VERT. SCALE: N/A	DESIGN WORK ORDER NO.: 2028127 CONSTR. WORK ORDER NO.: 2028128 <b>R-4517</b> SHEET <u>3</u> OF <u>3</u> FILE NAME: R4517-3.DWG
	APPROVED BY:  DATE: 9-15-20 ENGINEERING MANAGER: <i>EM</i> CONSTRUCTION ADMIN.: <i>DC</i> DATE: 9-14-20 TRAFFIC DIVISION: <i>NM</i> DATE: 9-14-20 STREETS SERVICES: <i>ES</i> DATE: 9-14-20 SURVEYOR: <i>ES</i> DATE: 9-14-20	MARK: _____ REVISIONS: _____ APPR. DATE: _____ DESIGNED BY: <i>DC</i> DRAWN BY: <i>DC</i> CHECKED BY: <i>NM</i>	APPROVED BY:  DATE: 9-15-20 CITY ENGINEER: _____ DATE: <i>Set. 16, 2020</i>		