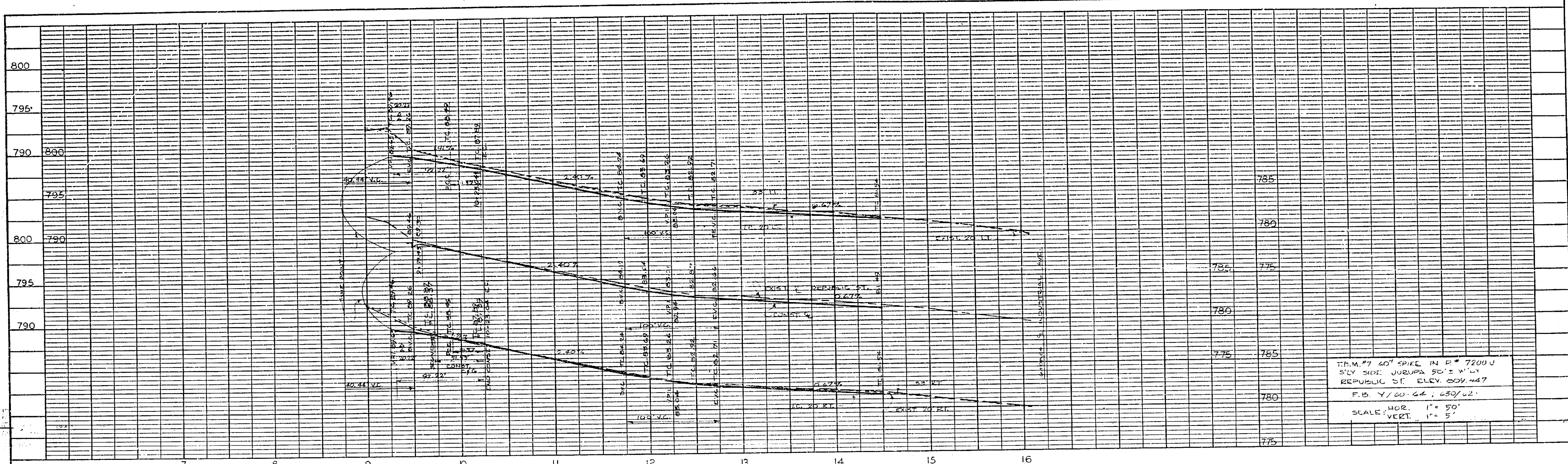
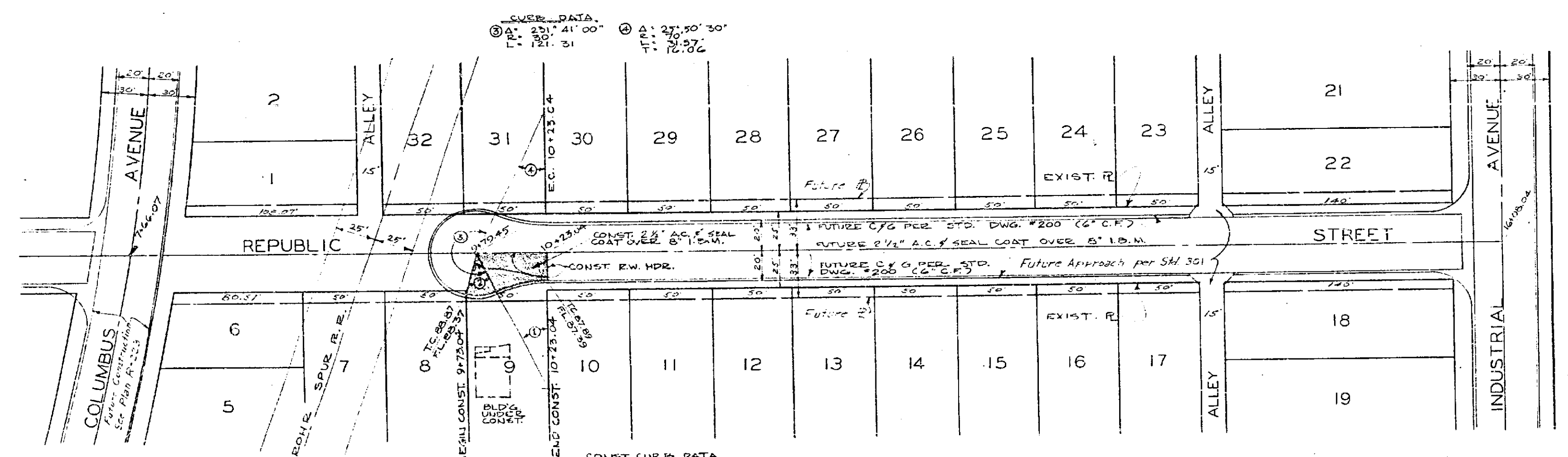

PLATE 1 PLAN-PROFILE
 CLEARANCE PAPER CO. S. CAL.
 NO. 10001



TR.M. #7 40' SPIKE IN P. # 7200 J
 S'LY SIDE JURUPA 50' S. W. L. 1
 REPUBLIC ST. ELEV. 804.447
 F.B. 4/60-64, 65/62.
 SCALE: HOR. 1" = 50'
 VERT. 1" = 5'

NO.	DATE	DESCRIPTION



SCALE: 1" = 50'

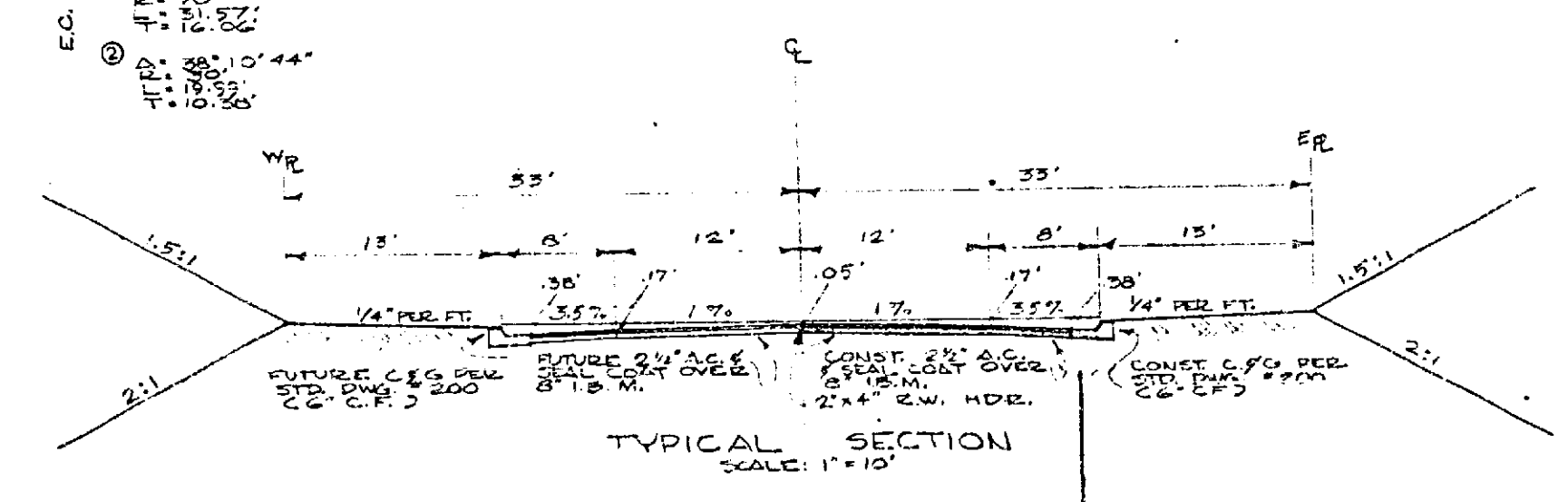

NOTE:
 1. CONSTRUCTION SHALL BE IN ACCORDANCE WITH STANDARD SPECIFICATIONS FOR HIGHWAYS AND BRIDGES, 1962 EDITION, AS AMENDED BY THE CALIFORNIA DEPARTMENT OF PUBLIC WORKS.
 2. DRIVEWAY APPROACHES SHALL CONFORM WITH THE LOW SIDE FOR A CURB AND SIDEWALK.

REVISIONS		CITY OF RIVERSIDE CALIFORNIA DEPARTMENT OF PUBLIC WORKS	
MARK	DATE	DESCRIPTION	
		REPUBLIC STREET COLUMBUS AVE. TO INDUSTRIAL AVE.	
DESIGNED BY	CHECKED BY	APPROVED BY	R-491 SHEET 1 OF 1
DRAWN BY		DIRECTOR OF PUBLIC WORKS	
RECOMMENDED BY	ASSISTANT CITY ENGINEER	DATE 7-9-67	

NO.	DATE	DESCRIPTION