

- General Notes:**
1. The contractor is required to take due precautionary measures to protect the utilities or structures shown and any other utilities or structures of the site. It shall be the contractor's responsibility to verify the owners of the utilities or structures concerned before starting work.
  2. All work and materials shall comply with the Specifications No. 461 and Standards of the City of Riverside Dept. of Public Works.
  3. Prime coat, seal coat and binder are required.
  4. The City of Riverside will take a soil test to determine the requirements on imported base material after the street has been prepared for rough grade.
  5. Trim edge of paving to a clean straight line. Construct rough tie paving as shown and overlay existing paving as directed in the field to produce a smooth crown section.
  6. Abandoned irrigation line to be removed or crushed. No box to be removed.
  7. A soil test will be taken by the developer, the results of which shall be verified by the Public Works Department prior to the determining of the thickness of the imported base material and the A.C. paving.

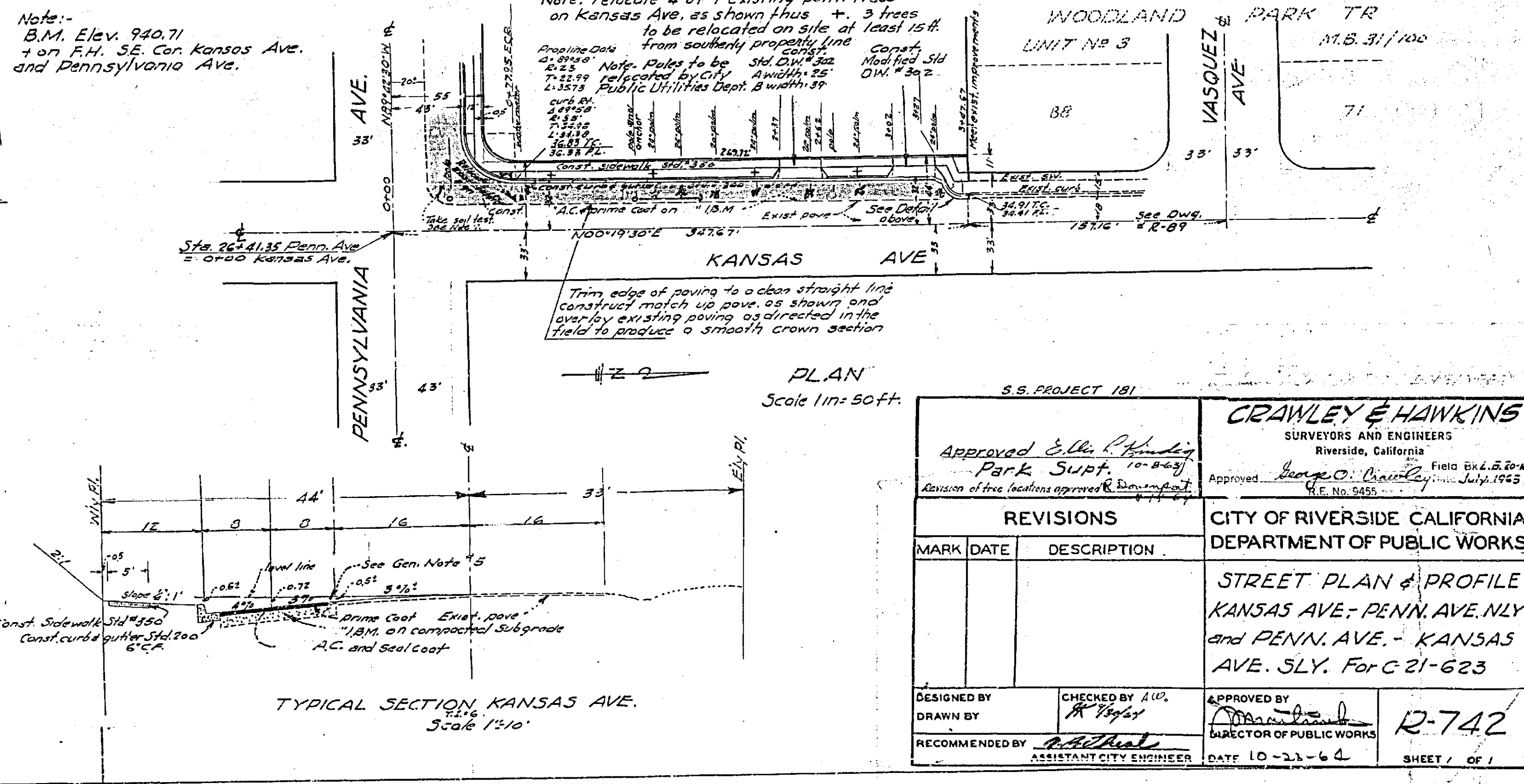
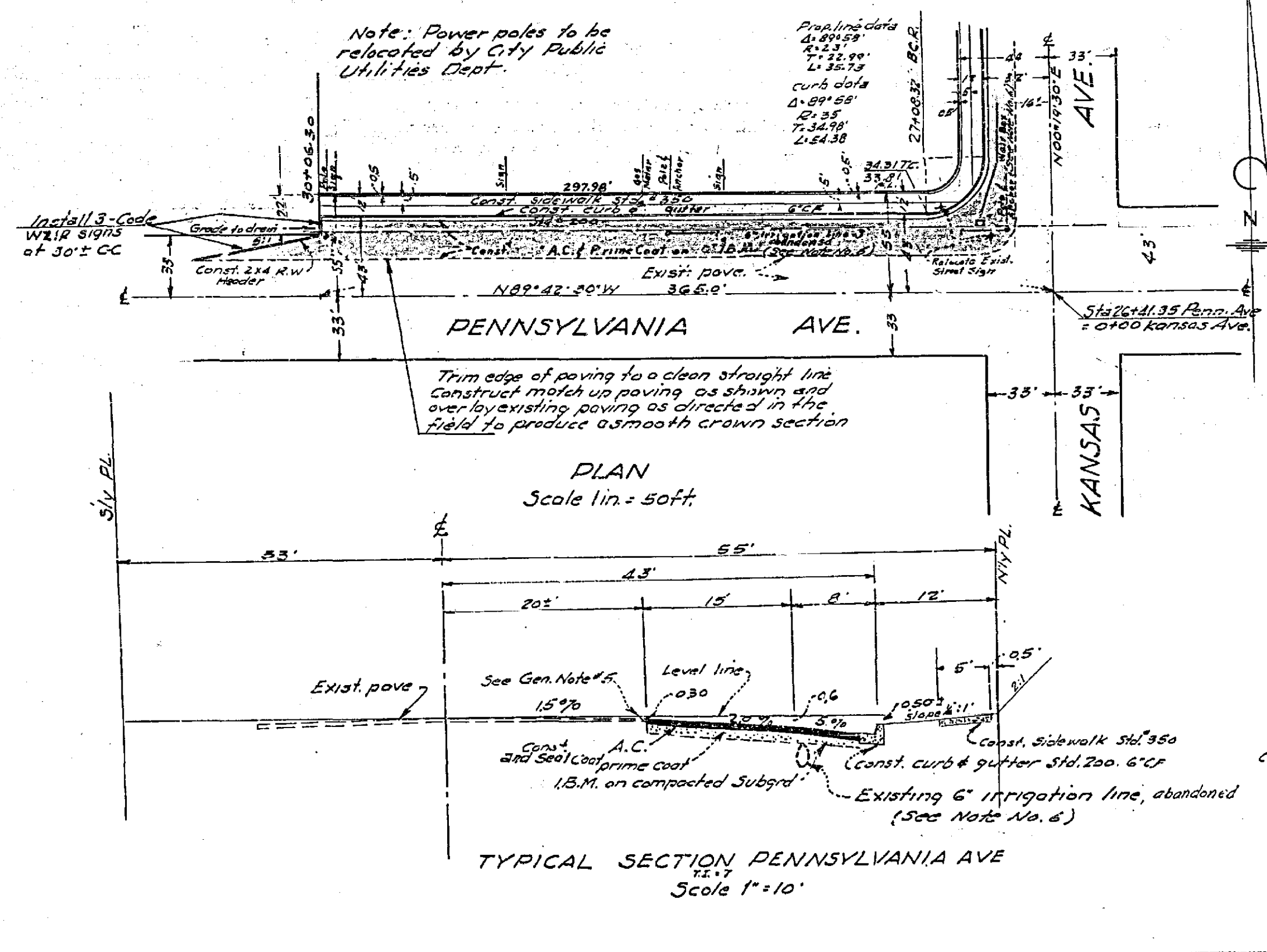

S.S. PROJECT 181

**CRAWLEY & HAWKINS**  
SURVEYORS AND ENGINEERS  
Riverside, California

Approved: *E. O. ...*  
Park Supt. 10-1-64

Approved: *George O. ...*  
City Engineer July 1965  
C.E. No. 5455

REVISIONS	
MARK	DATE DESCRIPTION

CITY OF RIVERSIDE CALIFORNIA  
DEPARTMENT OF PUBLIC WORKS

**STREET PLAN & PROFILE  
KANSAS AVE - PENN. AVE. NLY  
and PENN. AVE. - KANSAS  
AVE. SLY. For C-21-623**

DESIGNED BY: *R. ...*  
DRAWN BY: *R. ...*  
RECOMMENDED BY: *R. ...*  
ASSISTANT CITY ENGINEER

CHECKED BY: *R. ...*  
DIRECTOR OF PUBLIC WORKS

APPROVED BY: *R. ...*  
DIRECTOR OF PUBLIC WORKS

DATE 10-21-64

SHEET 1 OF 1

R-742