

TRANSIT & SWING TIES

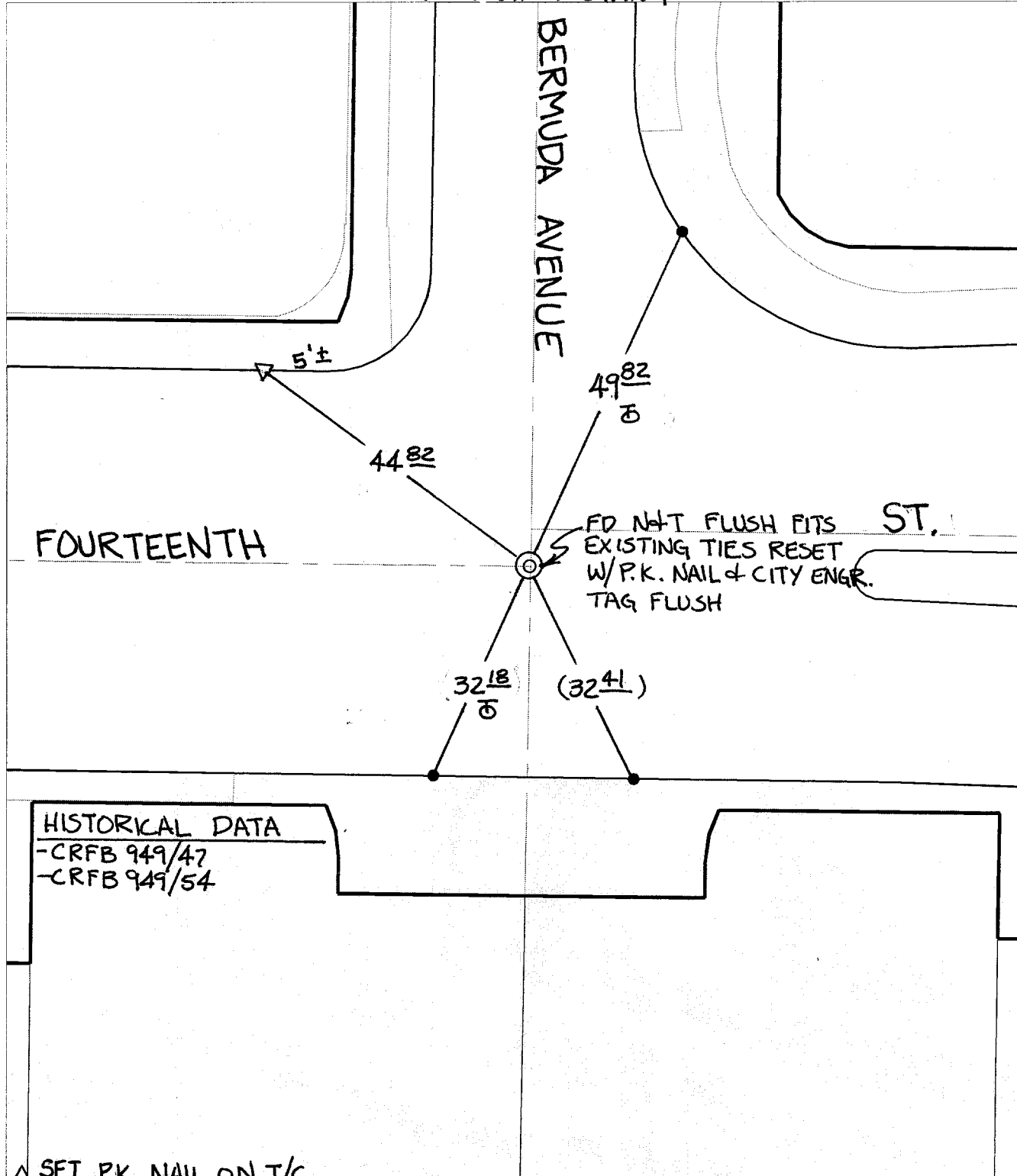

HISTORICAL DATA

- CRFB 949/47
- CRFB 949/54

△ SET P.K. NAIL ON T/C

× FD. Ramset Nail on T/C

■ FD. "C" Nail on T/C

● FD. LD. & TK. on T/C

○ Set LD. & TK. on T/C

P.K. and City Engineer tag to be set @ surface after street construction is complete. (If possible)

Scale: 1" = 20'

Date: 02/19/02

Drawn by: survey

F.B.:

TR-Sec: T2SR5W-25

OFFICIAL TIE PLAT

CITY OF RIVERSIDE

These ties are for the purpose of perpetuating the found monumentation. No claim is made as to the relationship of the points or lines shown hereon to true boundary locations.



Sheet 1 of 1

Cadme MB: 40-3

Street:
C10034

TIF
14TH ST.

X-Street:
OFFICIAL USE ONLY

BERMUDA AVE.