

CREST AVENUE
AT
17 B.C. SLY RANDOLPH

Street: CREST
17 B.C. SLY RANDOLPH
OFFICIAL USE ONLY
X-Street: 17 B.C. SLY RANDOLPH

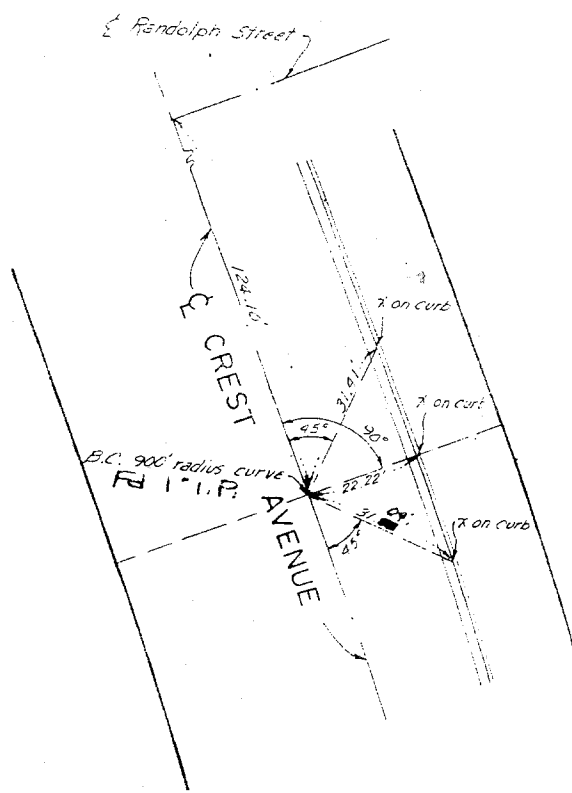

CENTERLINE TIES
TRACT 3780
M.B. 59/69-70, Riverside County, Calif.

MAXWELL & KING
Civil Engineers and Land Surveyors
422 West 16th St., San Bernardino, California 92405
SCALE: 1" = 30'
DATE: 6-17-69

JOB NO. 68-3-4
DWG. NO. A-6.3

- ✕ FD. Ramset Nail on T/C
- FD. LD. & TK. on T/C
- FD. "C" Nail on T/C
- Set LD. & TK. on T/C

Scale:
Date:
Drawn by:
W.O.:
F.B.:

OFFICIAL TIE PLAT
CITY OF RIVERSIDE

These ties are for the purpose of perpetuating the found monumentation. No claim is made as to the relationship of the points or lines shown hereon to true boundary locations.

Sheet 1 of 1
File No.: