

Street: **Sierra Vista**
10021 TIF

X-Street: **Gramercy**
 OFFICIAL USE ONLY

Gramercy Pl.

HISTORICAL DATA RECOVERED TIES FB 988/21 FB 717/41 TR 2360 (MB 44/41)	TRANSIT SWING TIES FB 977/51	GRAMERCY PLACE @ SIERRA VISTA MARCH 19 1976 CREW: THORP ALLEN
---------------------------------------------------------------------------------------------	----------------------------------------	-------------------------------------------------------------------------------------

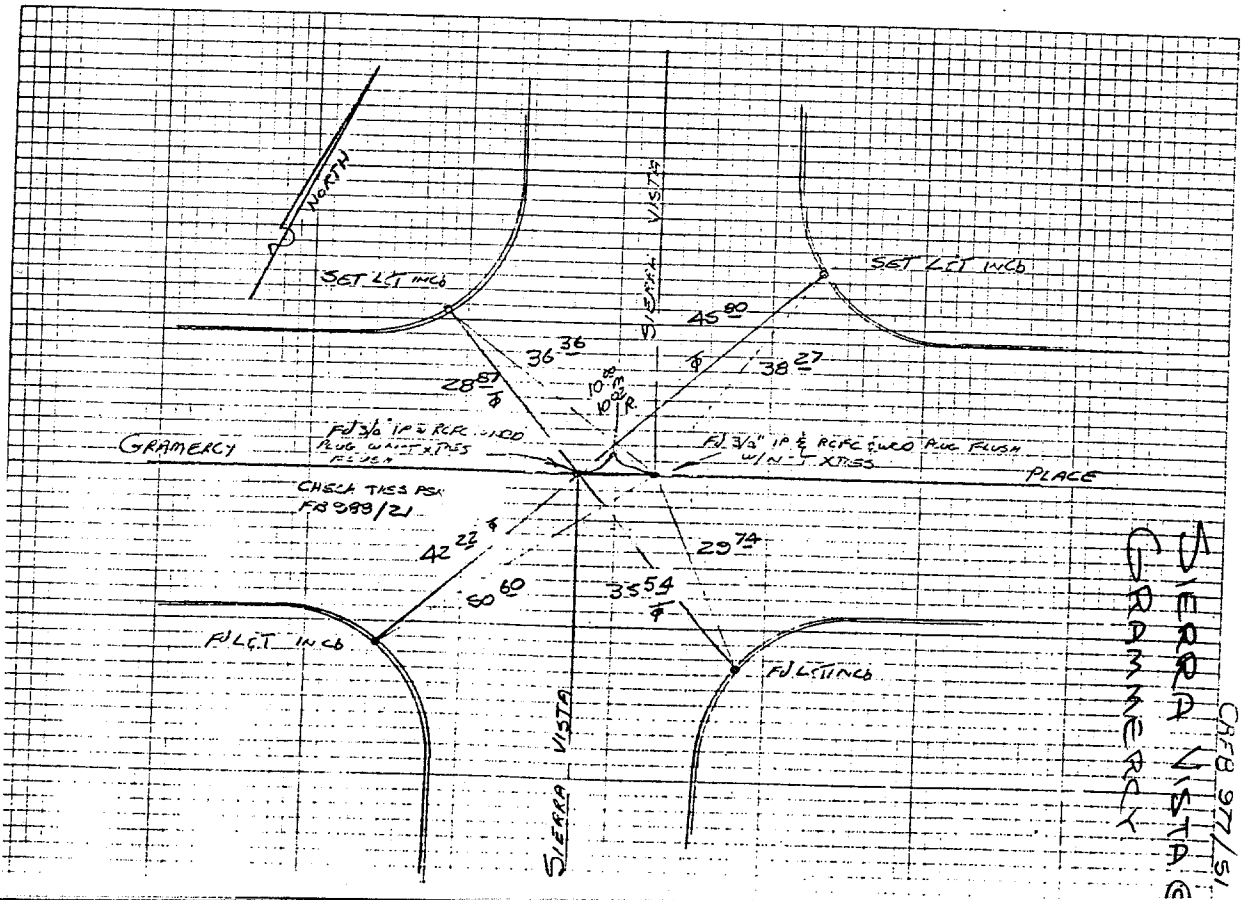

SIERRA VISTA
 GRAMERCY
 FB 977/51

- ✕ FD. Ramset Nail on T/C
- FD. LD. & TK. on T/C
- FD. "C" Nail on T/C
- Set LD. & TK. on T/C

Scale:
 Date:
 Drawn by:
 W.O.:
 F.B.:

OFFICIAL TIE PLAT
CITY OF RIVERSIDE

These ties are for the purpose of perpetuating the found monumentation. No claim is made as to the relationship of the points or lines shown hereon to true boundary locations.

Sheet 1 of 1
 File No.: