

11001.TIF

Street: PALM AVE

X-Street: OFFICIAL USE ONLY

BANDINI AVE

SWING TIES

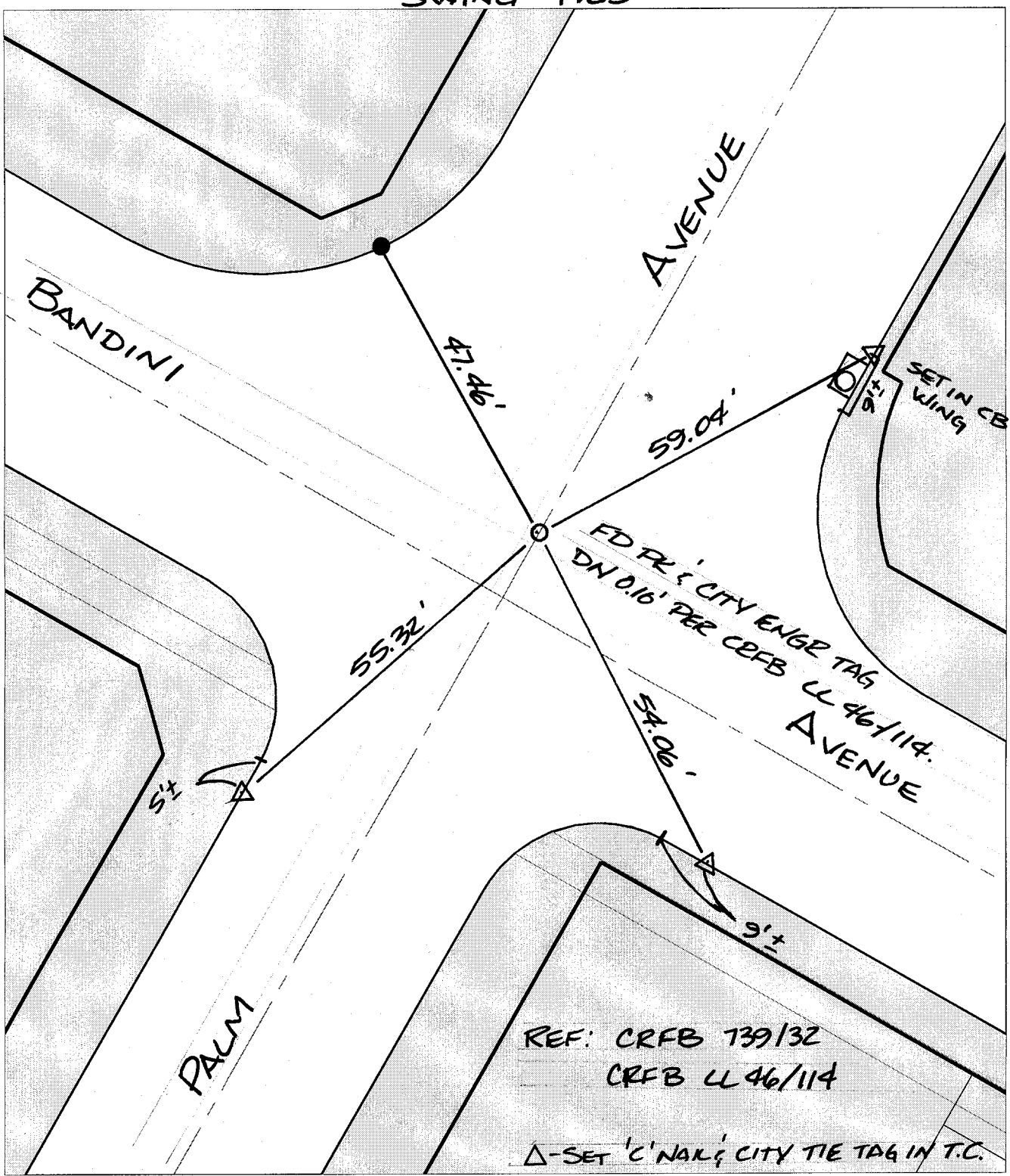

REF: CRFB 739/132  
 CRFB LL 46/114

Δ-SET 'C' NAIL & CITY TIE TAG IN T.C.

- ✕ FD. Ramset Nail on T/C    ● FD. LD. & TK. on T/C    P.K. and City Engineer tag to be set @ surface after street construction is complete. (If possible)
- FD. "C" Nail on T/C    ○ Set LD. & TK. on T/C

Scale: 1" = 20'  
 Date: 12/19/03  
 Drawn by: scurtis  
 F.B.:  
 TR-Sec: -

**OFFICIAL TIE PLAT**  
**CITY OF RIVERSIDE**

*These ties are for the purpose of perpetuating the found monumentation. No claim is made as to the relationship of the points or lines shown hereon to true boundary locations.*

Sheet 1 of 1  
 Cadme MB: 38-4