

11043.TIF

Street: GLEN AIRE AVENUE  
X-Street: WEST VIEW DRIVE  
OFFICIAL USE ONLY

SWING TIE

REF.: TR 8146 TIE SHT. FB. 838032/61

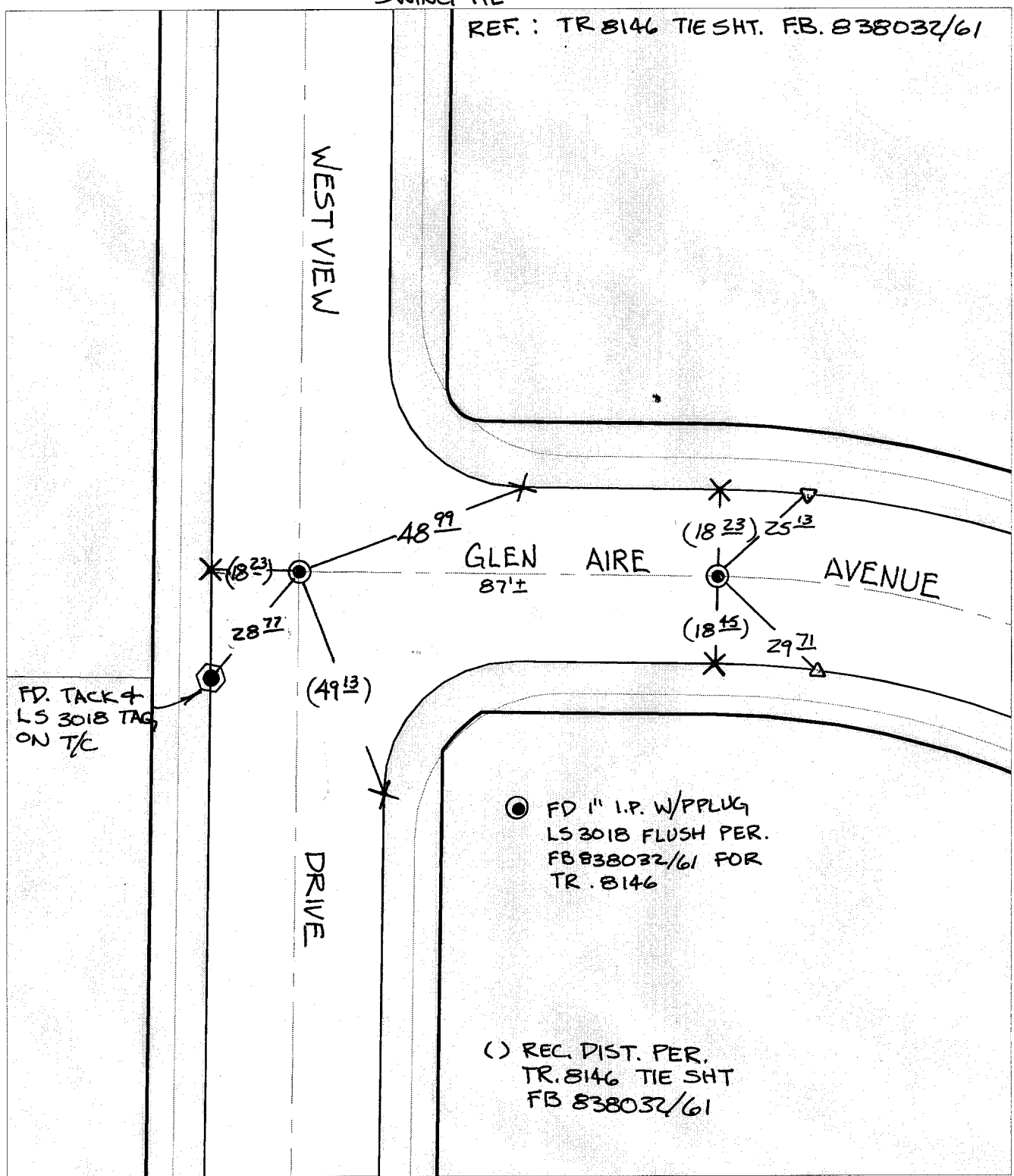

- ✕ FD. Ramset Nail on T/C
- FD. LD. & TK. on T/C
- FD. "C" Nail on T/C
- Set LD. & TK. on T/C

P.K. and City Engineer tag to be set @ surface after street construction is complete. (If possible)

Scale: 1" = 30'  
 Date: 07/10/02  
 Drawn by: Survey  
 F.B.:  
 TR-Sec: T3SR4W-6

**OFFICIAL TIE PLAT**  
**CITY OF RIVERSIDE**

*These ties are for the purpose of perpetuating the found monumentation. No claim is made as to the relationship of the points or lines shown hereon to true boundary locations.*

Sheet 1 of 1  
 Cadme MB: 71-1