

SURVEY OF TRACT 21403 & TIES  
 FOR BROCK W.O.No. 127 DATE 3-13-27  
 SURVEY PARTY MCKEE CLOVER, HOPKINS, PEARL REF. \_\_\_\_\_ A.M. \_\_\_\_\_

COLE AVE.

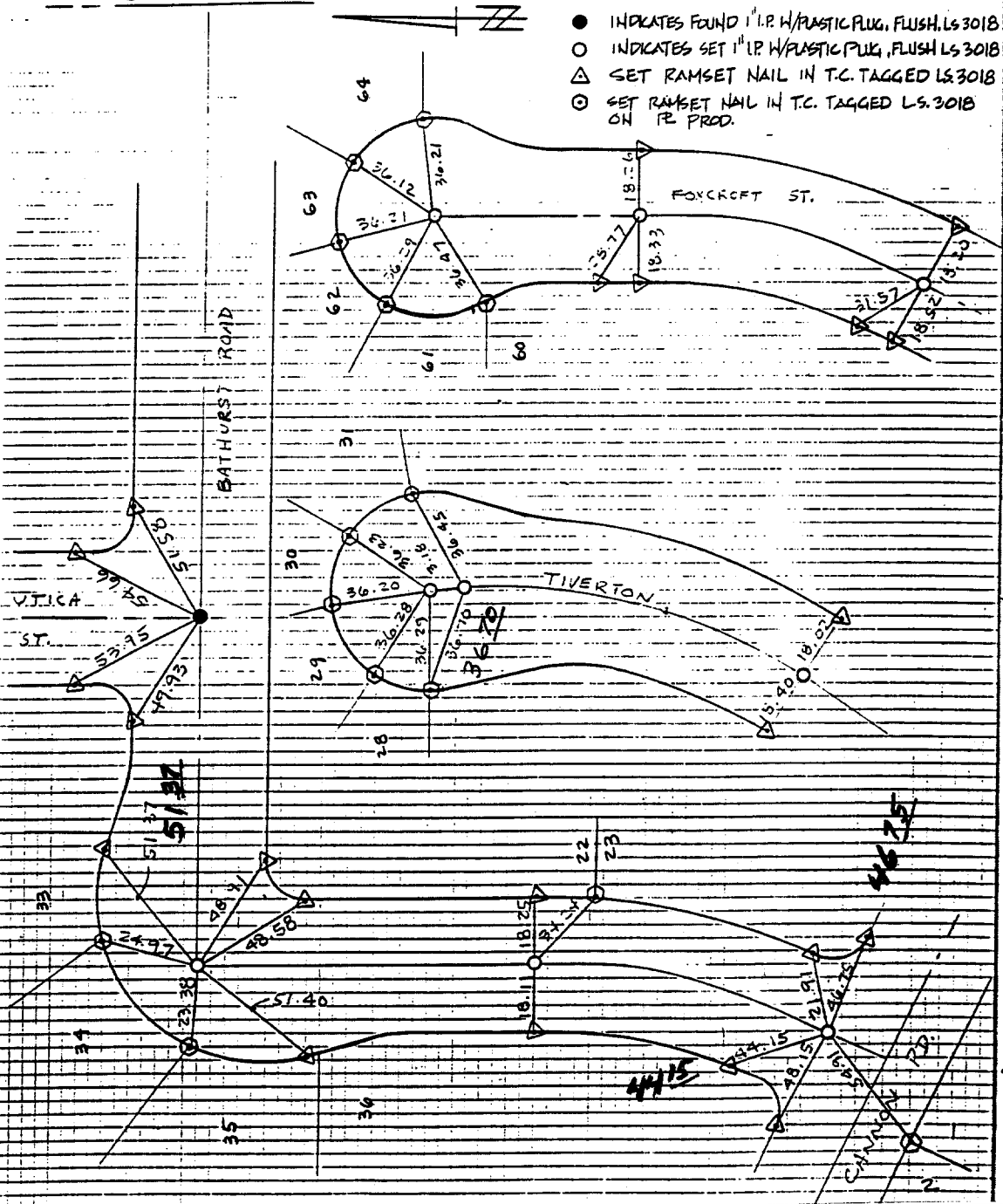

- INDICATES FOUND 1" I.P. W/PLASTIC PLUG, FLUSH LS 3018
- INDICATES SET 1" I.P. W/PLASTIC PLUG, FLUSH LS 3018
- △ SET RAMSET NAIL IN T.C. TAGGED LS 3018
- ⊙ SET RAMSET NAIL IN T.C. TAGGED LS 3018 ON RE PROD.

- ⊗ FD. Ramset Nail on T/C
- FD. LD. & TK. on T/C
- FD. "C" Nail on T/C
- Set LD. & TK. on T/C

SURVEY NOTES

118.71 F

Street: CANNON RD.

X-Street: BATHURST RD.

OFFICIAL USE ONLY

Scale: \_\_\_\_\_  
 Date: \_\_\_\_\_  
 Drawn by: \_\_\_\_\_  
 W.O.: \_\_\_\_\_  
 F.B.: \_\_\_\_\_

## OFFICIAL TIE PLAT

### CITY OF RIVERSIDE

*These ties are for the purpose of perpetuating the found monumentation. No claim is made as to the relationship of the points or lines shown hereon to true boundary locations.*

Sheet 1 of 1  
 File No.: \_\_\_\_\_