

13770 TIE

Street: CAMPBELL AVE.

X-Street: OFFICIAL USE ONLY

JONES AVE.

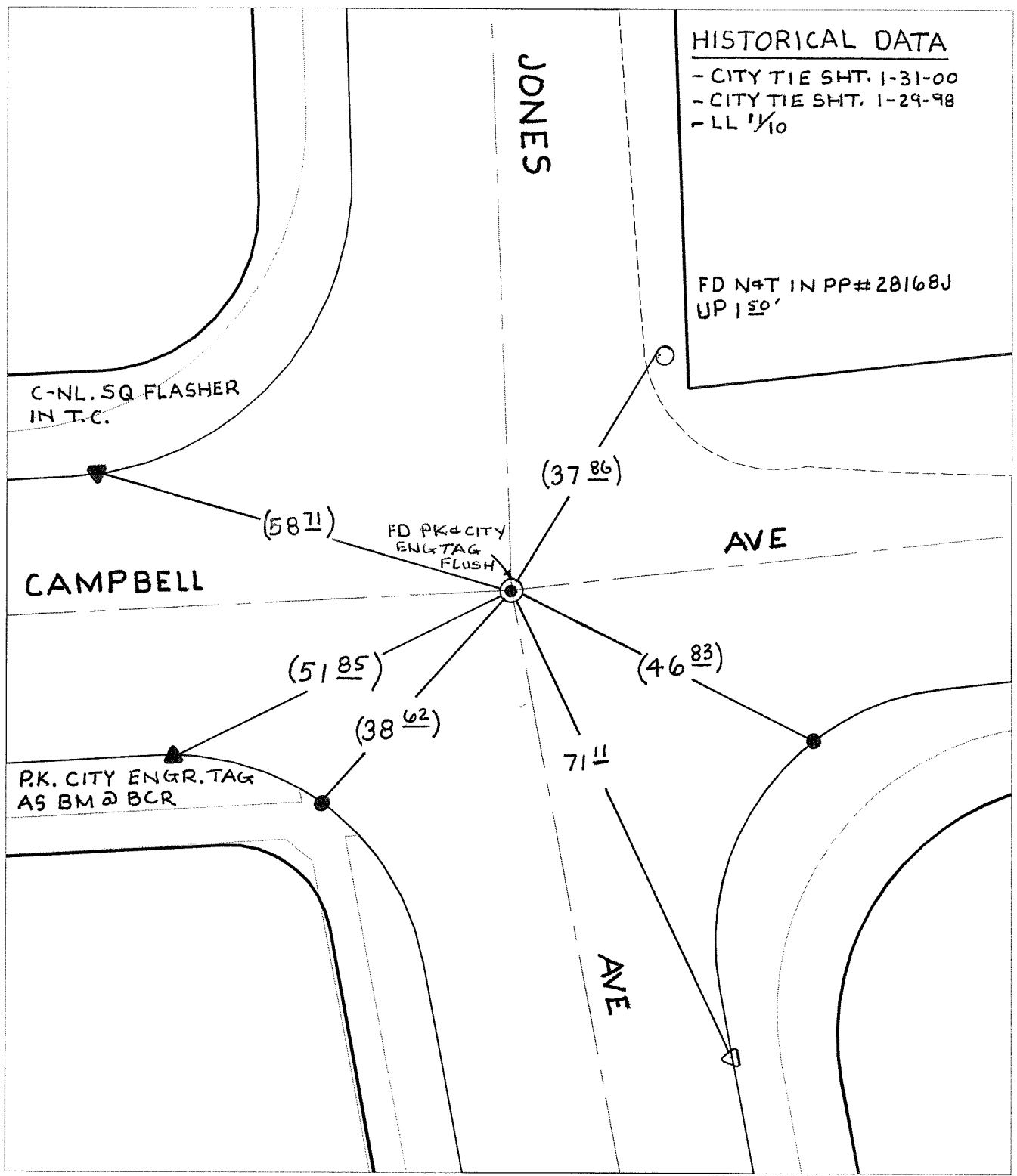

**HISTORICAL DATA**  
 - CITY TIE SHT. 1-31-00  
 - CITY TIE SHT. 1-29-98  
 - LL 1/10

FD N&T IN PP# 28168J  
 UP 150'

C-NL. SQ FLASHER  
 IN T.C.

FD PK & CITY  
 ENGR TAG  
 FLUSH

CAMPBELL

AVE

P.K. CITY ENGR. TAG  
 AS BM @ BCR

AVE

- ✕ FD. Ramset Nail on T/C
  - FD. LD. & TK. on T/C
  - Set LD. & TK. on T/C
  - FD. "C" Nail on T/C
- P.K. and City Engineer tag to be set @ surface after street construction is complete. (If possible)*

Scale: 1" = 20'  
 Date: 06/12/08  
 Drawn by: DBueno  
 F.B.:  
 TR-Sec: T3SR6W-2

**OFFICIAL TIE PLAT**  
**CITY OF RIVERSIDE**

*These ties are for the purpose of perpetuating the found monumentation. No claim is made as to the relationship of the points or lines shown hereon to true boundary locations.*



Sheet 1 of 1  
 Cadme MB: 49-7