

# SWING TIES

REF: 13151.TIF

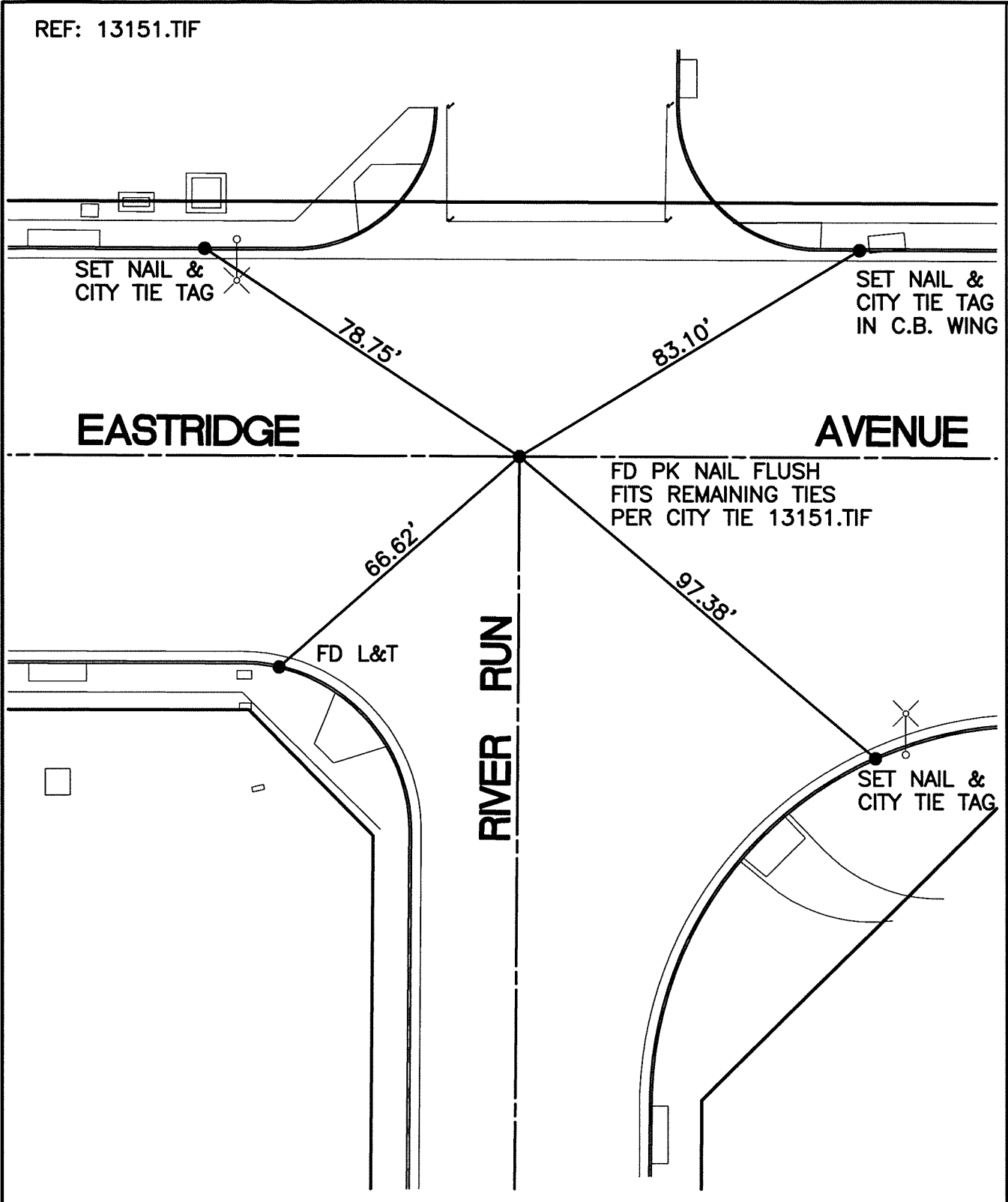

13991.TIF  
 STREET: EASTRIDGE AVENUE  
 X-STREET: RIVER RUN  
 OFFICIAL USE ONLY

SCALE: 1"=30'  
 DATE: 7/05/12  
 DRAWN BY: CURT  
 F.B.:  
 SEC: 3 & 9 T.3S.,R.4W

**OFFICIAL TIE PLAT**  
 CITY OF RIVERSIDE

THESE TIES ARE FOR THE PURPOSE OF PERPETUATING THE FOUND MONUMENTATION. NO CLAIM IS MADE AS THE RELATIONSHIP OF THE POINTS OR LINES SHOWN HEREON TO TRUE BOUNDARY LOCATIONS

SHEET 1 OF 1