

SWING TIES

14001.71/F

HISTORICAL DATA
CRFB 852/41

STREET: MERRILL AVENUE
X-STREET: DE ANZA AVENUE
OFFICIAL USE ONLY

- =FOUND LEAD & TACK ON T/C
- △ =SET C_NAIL & CITY TIE TAG ON T/C

FD RAILROAD SPIKE WITH
PUNCH MARK DN 0.35'
FITS REMAINING TIES
PER CRFB 852/41

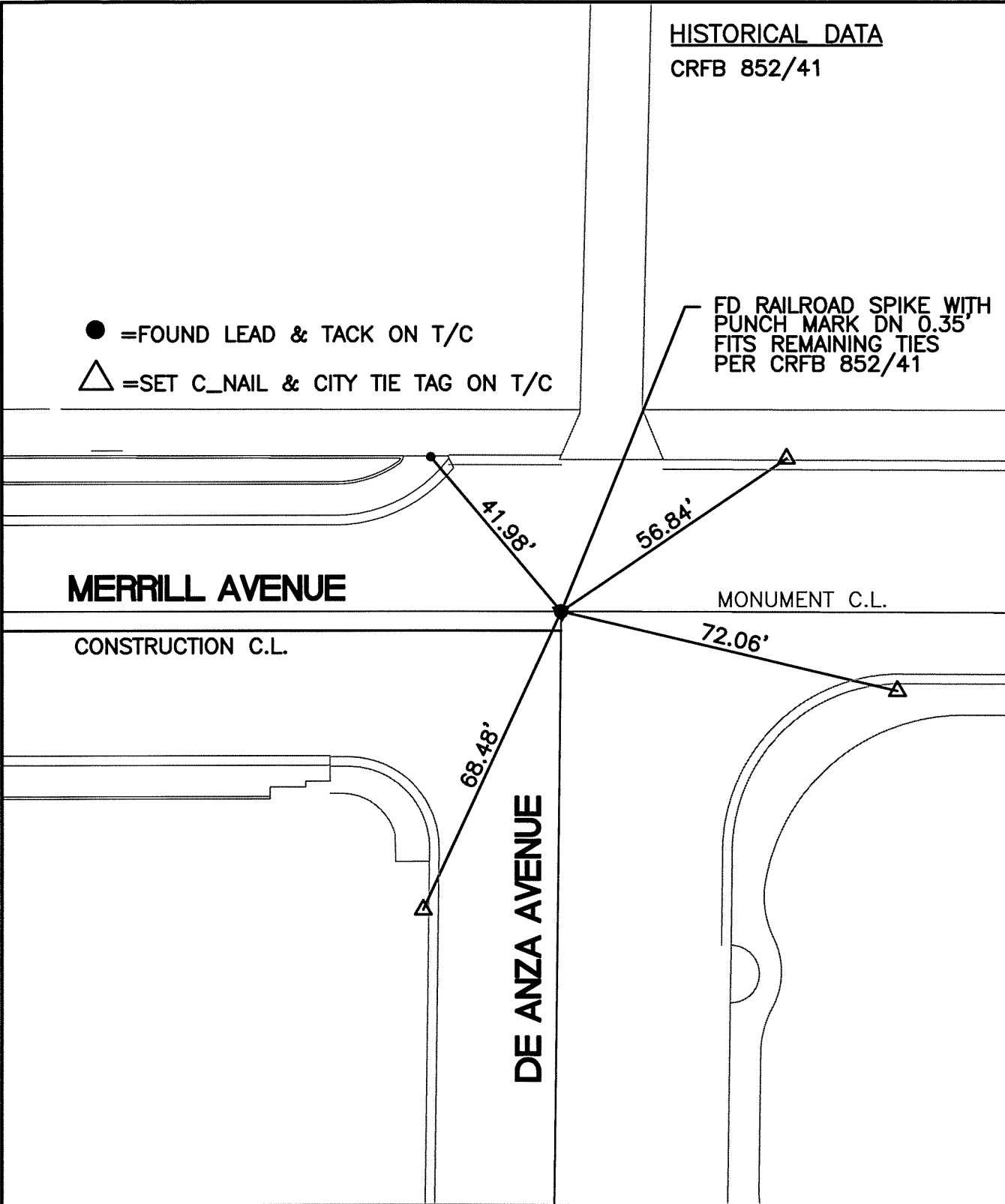

SCALE: 1"=30'

DATE: 5/07/12

DRAWN BY: B DURENTE

F.B.:SEE HISTORICAL DATA

SEC: 34 T.2S.,R.5W

OFFICIAL TIE PLAT CITY OF RIVERSIDE

THESE TIES ARE FOR THE PURPOSE OF PERPETUATING THE FOUND MONUMENTATION. NO CLAIM IS MADE AS THE RELATIONSHIP OF THE POINTS OR LINES SHOWN HEREON TO TRUE BOUNDARY LOCATIONS



SHEET 1 OF 1