

# SWING TIES

14069.TIF

REF: 9778.TIF  
CRFB 703/46-47

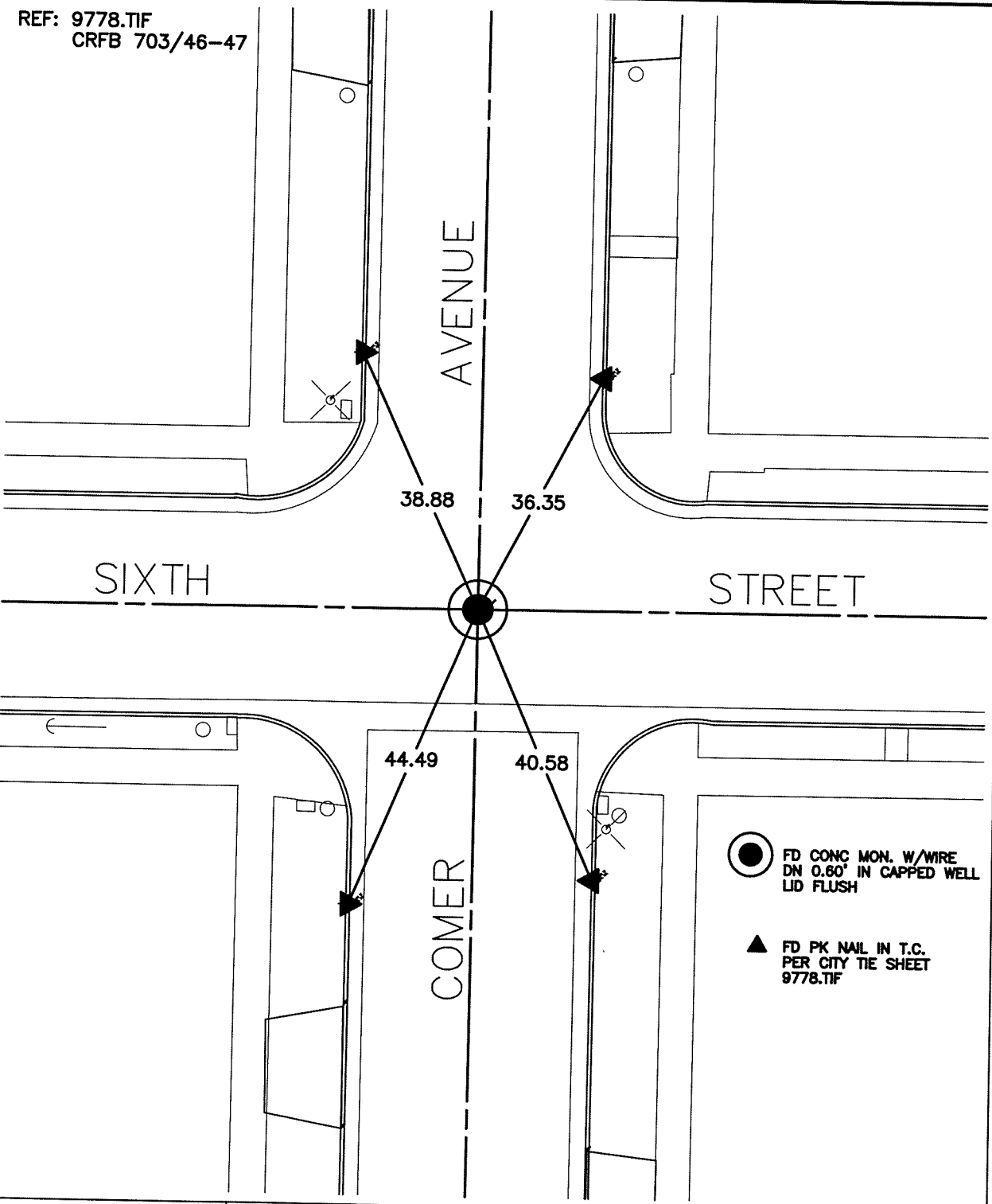

STREET: COMER AVENUE

OFFICIAL USE ONLY

X-STREET: SIXTH STREET

● FD CONC MON. W/WIRE  
DN 0.60' IN CAPPED WELL  
LID FLUSH

▲ FD PK NAIL IN T.C.  
PER CITY TIE SHEET  
9778.TIF

SCALE: 1"=20'  
DATE: 02/10/10  
DRAWN BY: L. Harris  
F.B.:  
SEC. 24 T.2S.,R.5W

## OFFICIAL TIE PLAT CITY OF RIVERSIDE

THESE TIES ARE FOR THE PURPOSE OF PERPETUATING THE FOUND MONUMENTATION. NO CLAIM IS MADE AS THE RELATIONSHIP OF THE POINTS OR LINES SHOWN HEREON TO TRUE BOUNDARY LOCATIONS

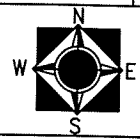

SHEET 1 OF 1

Cadme MB: 40-2