

CENTRAL AVE

X-Street: AVONDALE WY
OFFICIAL USE ONLY

4

HISTORICAL DATA
FB 225/435

TRANSIT TIES

CREW:
STEELE
FRYE
NEW
SEPT 16, '71
FB 352/66

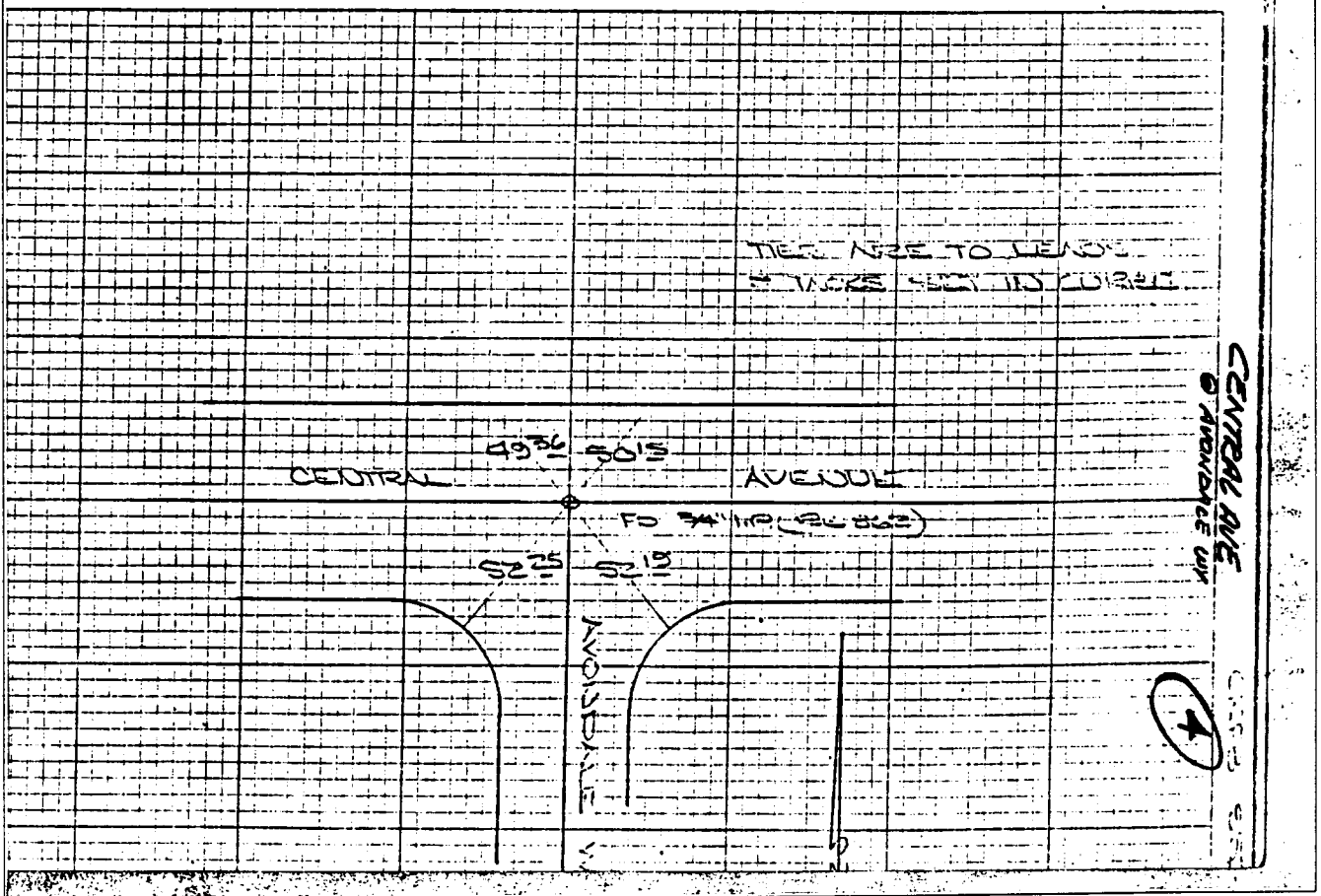

✕ FD. Ramset Nail on T/C
 ■ FD. "C" Nail on T/C

● FD. LD. & TK. on T/C
 ○ Set LD. & TK. on T/C

Scale:
 Date:
 Drawn by:
 W.O.:
 F.B.:

OFFICIAL TIE PLAT

CITY OF RIVERSIDE

These ties are for the purpose of perpetuating the found monumentation. No claim is made as to the relationship of the points or lines shown hereon to true boundary locations.

Sheet 1 of 1
 File No.: