

Street: ARCHWAY

X-Street: LUTHER

17

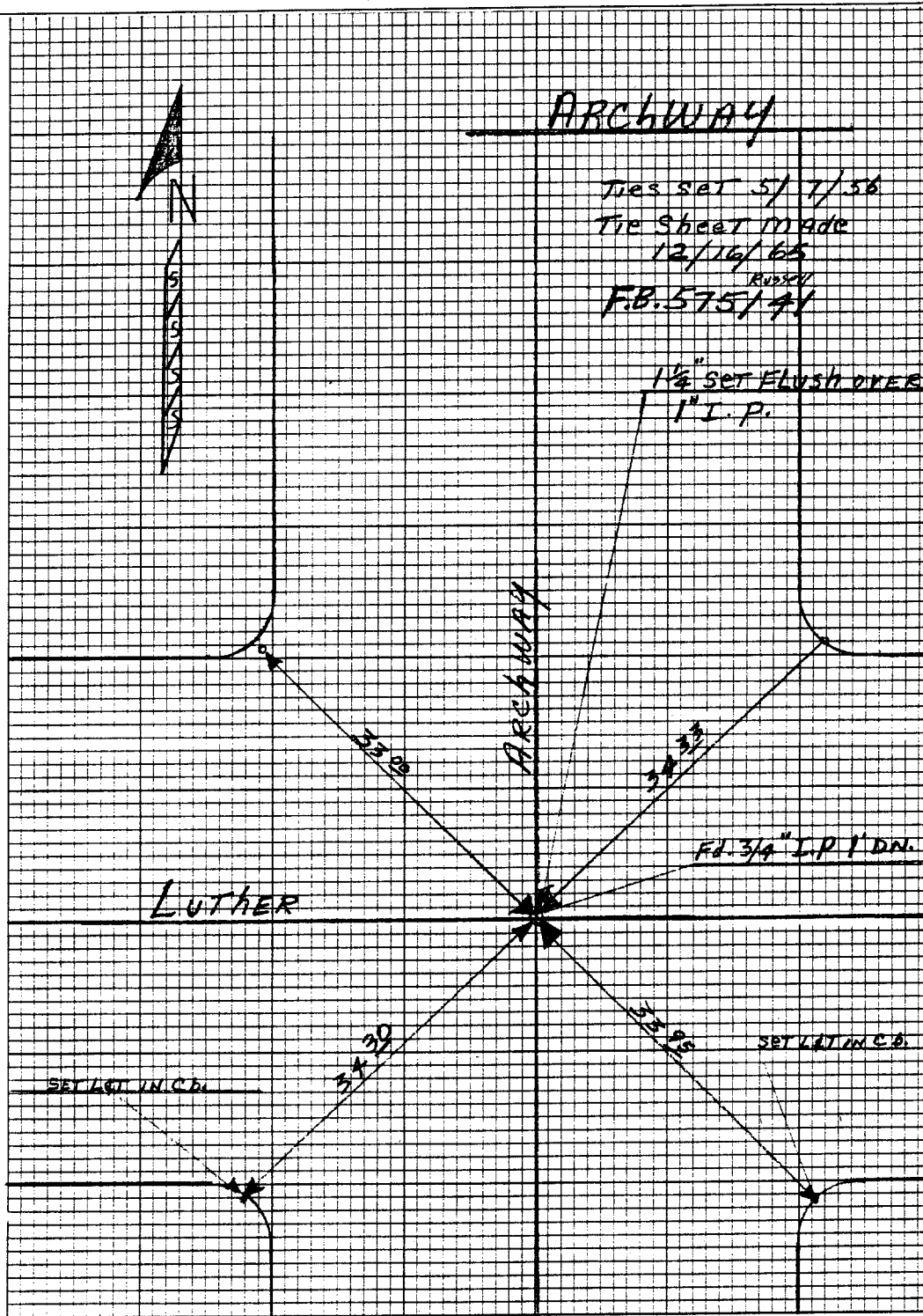

Ties SET 5/ 1/56  
Tie Sheet made  
12/16/65  
RUSSELL  
F.B. 575/41

1 1/4" SET FLUSH OVER  
1" I.P.

FD. 3/4" I.P. 1 DN.

SET 1/4" IN C.B.

SET 1/4" IN C.B.

ARCHWAY #17  
@ Luther

- × FD. Ramset Nail on T/C
- FD. LD. & TK. on T/C
- FD. "C" Nail on T/C
- Set LD. & TK. on T/C

## OFFICIAL TIE PLAT

### CITY OF RIVERSIDE

*These ties are for the purpose of perpetuating the found monumentation. No claim is made as to the relationship of the points or lines shown hereon to true boundary locations.*

Scale: \_\_\_\_\_  
 Date: \_\_\_\_\_  
 Drawn by: \_\_\_\_\_  
 W.O.: \_\_\_\_\_  
 F.B.: \_\_\_\_\_

Sheet 1 of 1  
File No.: \_\_\_\_\_