

Street: LA SIERRA AVE

OFFICIAL USE ONLY

X-Street: Schuyler

LA SIERRA AVENUE AT SCHUYLER STREET	
HISTORICAL DATA CR 980/79	TRANSIT TIES
	CREW: STEELE LEWING AILED APRIL 23 75 CS 580/79

CRFB 980/79 4-23-75

FD "PK" NAIL # CITY ENGINEER  
TAG PER FB. 080/74. REPLACE  
WITH 60" SPK # CITY ENGINEER  
TAG SET IN CEMENT. TIES ARE  
TO LEADS # TACKS SET IN  
CURB RETURNS

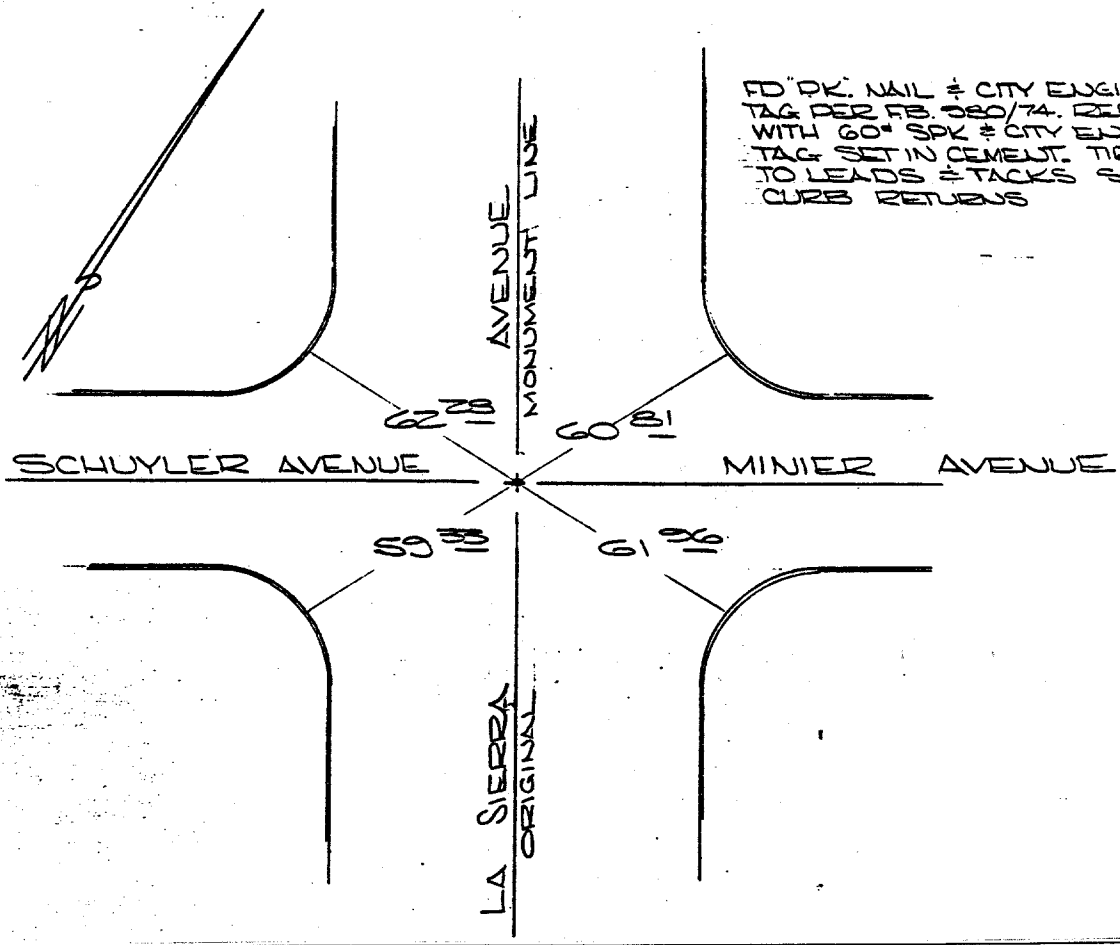

- ✕ FD. Ramset Nail on T/C
- FD. LD. & TK. on T/C
- FD. "C" Nail on T/C
- Set LD. & TK. on T/C

Scale:  
Date:  
Drawn by:  
W.O.:  
F.B.:

**OFFICIAL TIE PLAT**  
**CITY OF RIVERSIDE**

*These ties are for the purpose of perpetuating the found monumentation. No claim is made as to the relationship of the points or lines shown hereon to true boundary locations.*

Sheet 1 of 1  
File No.: