

Street: Palm Ave  
6621.71E

X-Street: BEATTY DR.

OFFICIAL USE ONLY

PALM AVE  
 AT BEATTY DR

HISTORICAL DATA

FB 23/1-3

TRANSIT TIES

CREW

FRYC

NEW

FB 955/11

JAN. 14, 1972

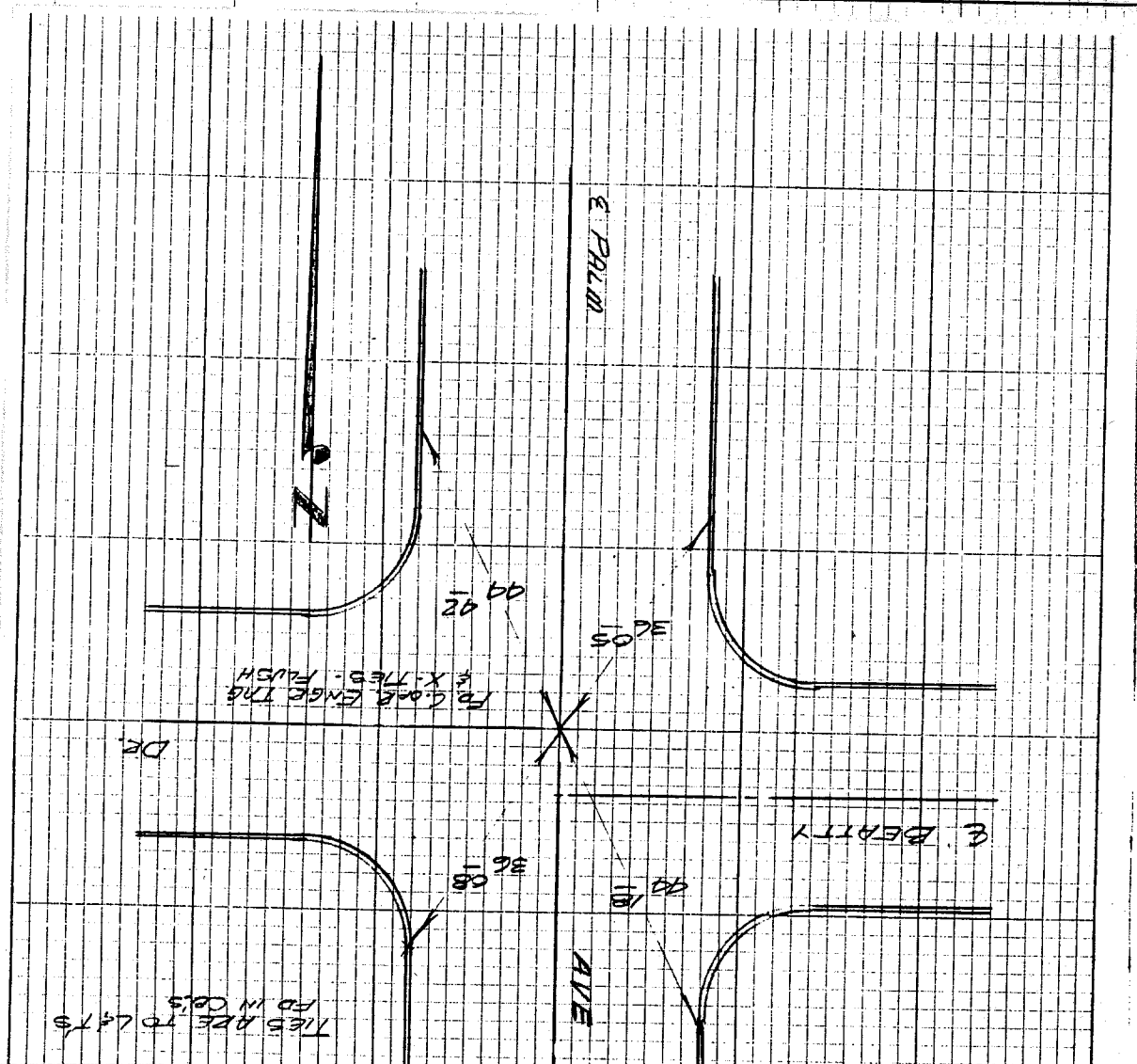

✕ FD. Ramset Nail on T/C  
 ■ FD. "C" Nail on T/C

● FD. LD. & TK. on T/C  
 ○ Set LD. & TK. on T/C

Scale:  
 Date:  
 Drawn by:  
 W.O.:  
 F.B.:

# OFFICIAL TIE PLAT

## CITY OF RIVERSIDE

*These ties are for the purpose of perpetuating the found monumentation. No claim is made as to the relationship of the points or lines shown hereon to true boundary locations.*

Sheet 1 of 1  
 File No.: