

Street: SANDTRACK
 7131.77E
 X-Street:
 OFFICIAL USE ONLY
 E.C. N. OF CAULFIELD

Scale: 1" = 20'

Date: 10/21/98

Drawn by: scurtis

W.O.:

F.B.:

OFFICIAL THE PLAT

CITY OF RIVERSIDE

These ties are for the purpose of perpetuating the found monumentation. No claim is made as to the relationship of the points or lines shown hereon to true boundary locations.

Sheet 1 of 1

File No.:



- × FD. Ramset Nail on T/C
- FD. "C" Nail on T/C
- FD. LD. & TK. on T/C
- Set LD. & TK. on T/C

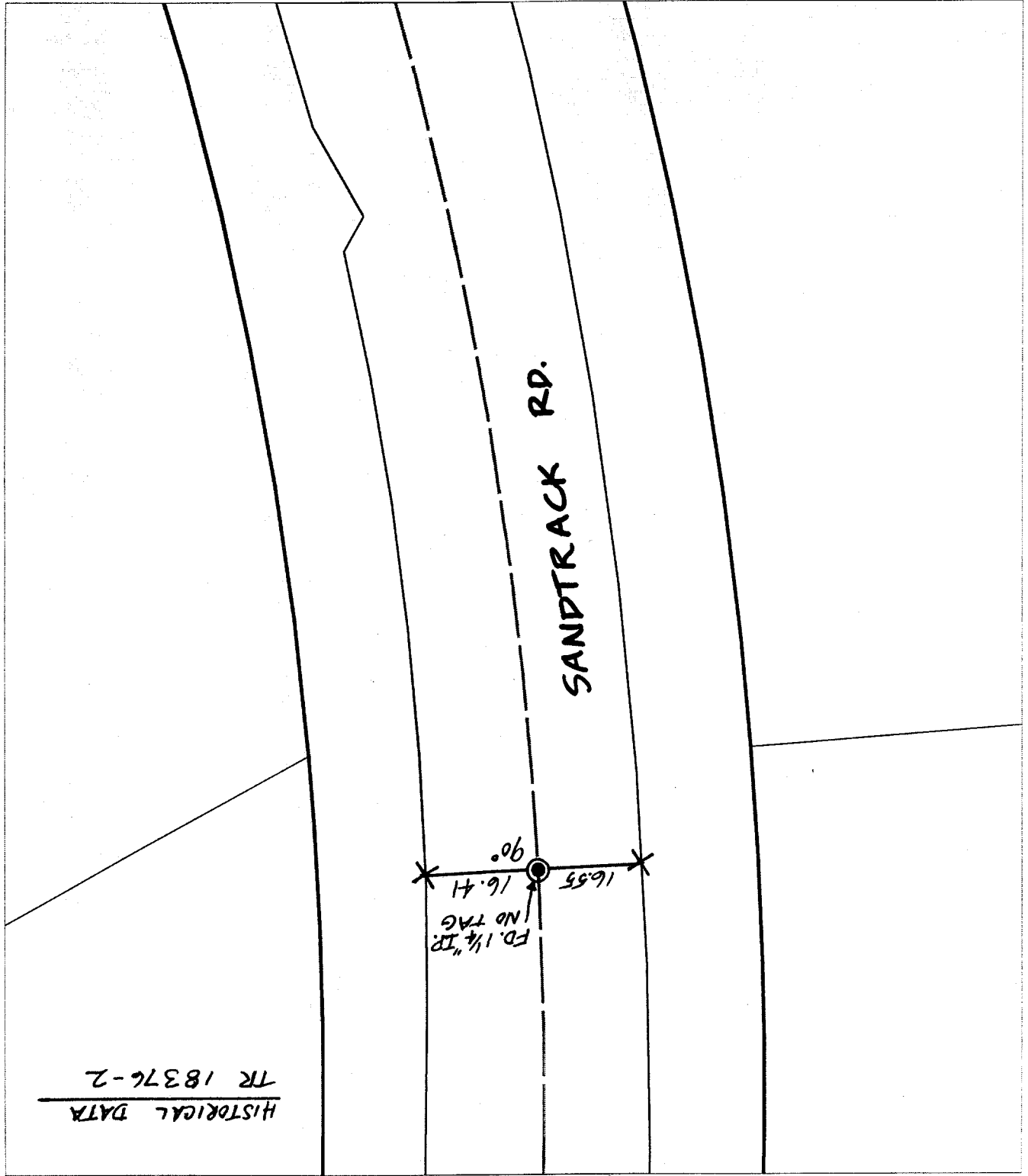

TRANSIT TIES

HISTORICAL DATA
 TR 18376-2